

FOR SALE | BUILD-TO-SUIT OFFICE

505 Sable Oaks Drive | South Portland, ME



RARE LARGE FLOORPLATE SUBURBAN OPPORTUNITY

- Up to 45,000± SF of Class A build-to-suit office
- Campus-like setting with easy access to major roads and amenities in the Maine Mall area
- Large floorplates offered here are indeed a rarity in the Greater Portland area's downtown and suburban office markets
- Located 2± miles from the Jetport and nearly midpoint to the west of I-95 Exits 45 & 46

SALE PRICE: \$1,950,000



JOE MALONE, CCIM
207.773.2554 D
207.233.8000 C
joe@malonecb.com



JENNIFER SMALL
207.772.6871 D
207.233.6872 C
jennifer@malonecb.com

MALONE COMMERCIAL BROKERS
5 Moulton Street • Suite 3
Portland, ME 04101
207.772.2422 • malonecb.com

PROPERTY SUMMARY

505 Sable Oaks Drive | South Portland, ME



OWNER: Soley Oaks LLC

LOT SIZE: 4.99± AC in a campus-like environment

BUILDING SIZE: Up to 45,000± SF

STORIES: Three (3)

PARKING: 225 spaces (5 spaces per 1,000 SF)

FRONTAGE: 535'± on Sable Oaks Drive

ZONING: PO - Professional Office



CONCEPTUAL SKETCH

THE LARGE FLOORPLATE

As mentioned earlier, the large floorplate offered is a rarity in the Greater Portland office market, especially in the suburban category. The landlord is well-experienced in build-to-suit development, working with tenants across a variety of commercial property types and sectors over many years.

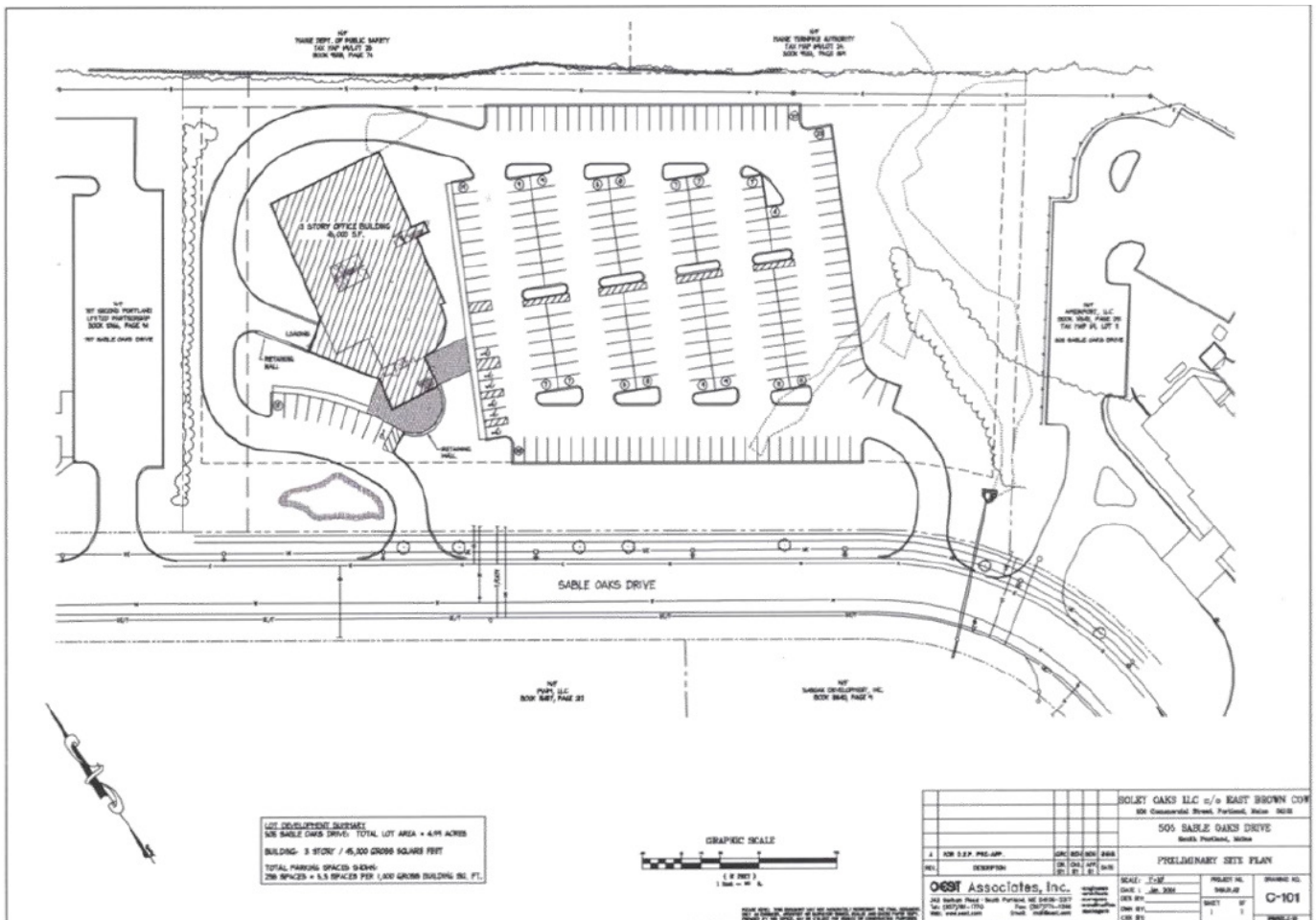

FOR SALE | BUILD-TO-SUIT OFFICE

505 Sable Oaks Drive | South Portland, ME



This document has been prepared by Malone Commercial Brokers for advertising and general information only. Malone Commercial Brokers makes no guarantees, representations or warranties of any kind, expressed or implied, regarding, but not limited to, warranties of content, accuracy, and reliability. Any interested party should undertake their own inquiries as to the accuracy of the information. Malone Commercial Brokers excludes unequivocally all informed or implied terms, conditions and warranties arising out of this document and excludes all liability for loss and damages there from. All data is subject to change of price, error, omissions, other conditions or withdrawal without notice. Malone Commercial Brokers is acting as the Seller's/Lessor's agent in the marketing of this property.



JOE MALONE, CCIM
207.773.2554 D
207.233.8000 C
joe@malonecb.com



JENNIFER SMALL
207.772.6871 D
207.233.6872 C
jennifer@malonecb.com

MALONE COMMERCIAL BROKERS
5 Moulton Street • Suite 3
Portland, ME 04101
207.772.2422 • malonecb.com