

380

**CLIFFWOOD PARK ST
BREA, CA**



FOR SALE

32,000 Sq. Ft. Freestanding Industrial Building

Voit
REAL ESTATE SERVICES

HV HEFNER
VERNICK
TEAM

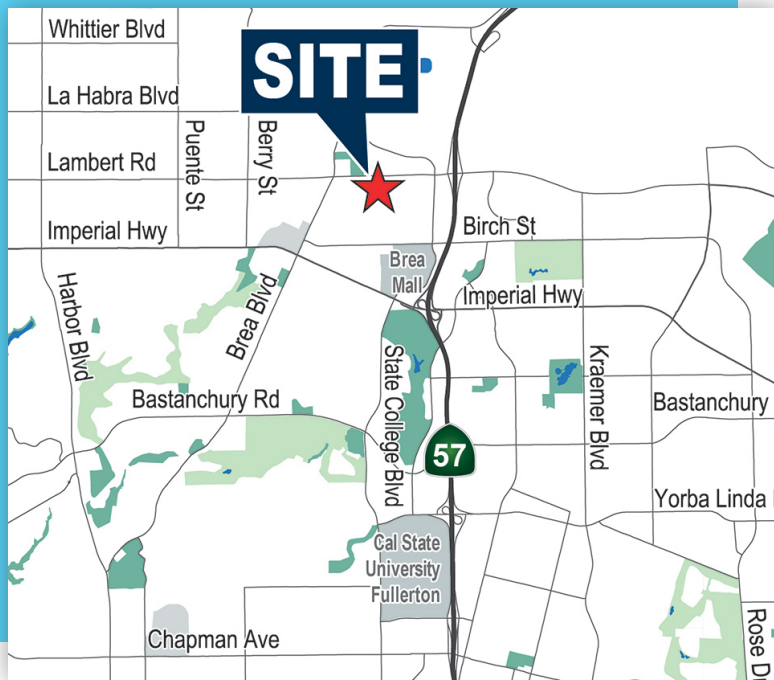

PROPERTY FEATURES

- » ±32,000 Sq. Ft. Freestanding Industrial Building
- » ±1.39 Acre Land Parcel
- » ±22,479 Sq. Ft. Warehouse
- » ±9,557 Sq. Ft. of Two-Story Office Space
- » ±24' Warehouse Clearance
- » One (1) Ground Level Loading Door (Expandable)
- » Truck Well Possible
- » Fully Fire Sprinklered
- » Fenced Yard Area, Corner Location
- » ±2.00/1,000 Sq. Ft. Parking Ratio

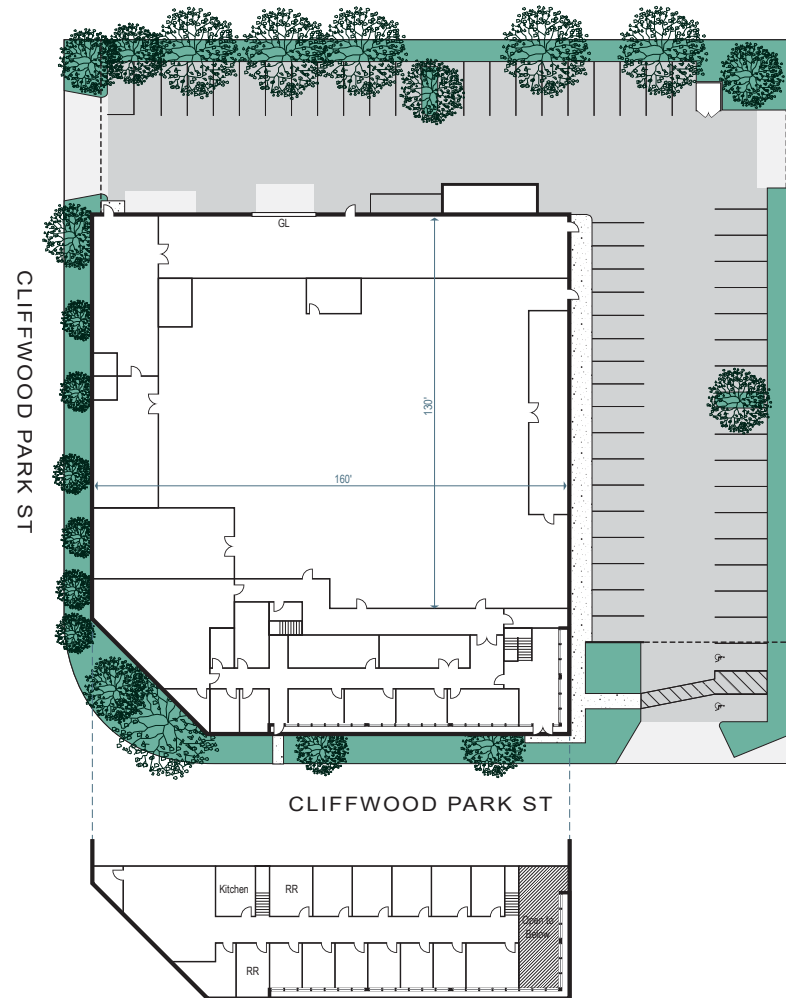

Second Floor

- » Large Power Service - ±1,600 Amps, 480 Volt Service Panel (verify)
- » Excellent Location Near Brea Mall & Brea Marketplace
- » Immediate Access to 57 Freeway 1/2 Mile East

[View Property Video](#)



Note: Site Plan Not to Scale.

PROPERTY FEATURES



380

CLIFFWOOD PARK ST
BREA, CA

Cliffwood Park St

Cliffwood Park St

MIKE HEFNER, SIOR

Executive Vice President

714.935.2331

mhefner@voitco.com

Lic. #00857352

BRENDEN HEFNER

Senior Associate

714.935.2326

bhefner@voitco.com

Lic #02114046

NICK DIGIOVANNI

Associate

714.935.2350

ndigiovanni@voitco.com

Lic #02213131

Voit

REAL ESTATE SERVICES



**HEFNER
VERNICK
TEAM**

2400 E. Katella Avenue, Suite 750
Anaheim, CA 92806
714.978.7880 | 714.978.9431 Fax
www.voitco.com

Licensed as Real Estate Brokers by the CA DRE. ©2025 Voit Real Estate Services, Inc. All Rights Reserved. Lic. #01991785 The information contained herein has been obtained from sources we deem reliable. While we have no reason to doubt its accuracy, we do not guarantee it.