



13943 Toepperwein Rd

SAN ANTONIO, TX



OFFERING MEMORANDUM

KW COMMERCIAL
1717 N Loop 1604 E
San Antonio, TX 78232

PRESENTED BY:

PATRICIA CHAVEZ, CCIM, TACS, ABR, MRP
Director For KW Commercial
O: 210.264.2087
patriciachavez@kw.com
TX #498385

Table Of Contents

CONFIDENTIALITY & DISCLAIMER

All materials and information received or derived from Patricia Chavez - KW - San Antonio its directors, officers, agents, advisors, affiliates and/or any third party sources are provided without representation or warranty as to completeness, veracity, or accuracy, condition of the property, compliance or lack of compliance with applicable governmental requirements, developability or suitability, financial performance of the property, projected financial performance of the property for any party's intended use or any and all other matters.

Neither Patricia Chavez - KW - San Antonio its directors, officers, agents, advisors, or affiliates makes any representation or warranty, express or implied, as to accuracy or completeness of the any materials or information provided, derived, or received. Materials and information from any source, whether written or verbal, that may be furnished for review are not a substitute for a party's active conduct of its own due diligence to determine these and other matters of significance to such party. Patricia Chavez - KW - San Antonio will not investigate or verify any such matters or conduct due diligence for a party unless otherwise agreed in writing.

EACH PARTY SHALL CONDUCT ITS OWN INDEPENDENT INVESTIGATION AND DUE DILIGENCE.

Any party contemplating or under contract or in escrow for a transaction is urged to verify all information and to conduct their own inspections and investigations including through appropriate third party independent professionals selected by such party. All financial data should be verified by the party including by obtaining and reading applicable documents and reports and consulting appropriate independent professionals. Patricia Chavez - KW - San Antonio makes no warranties and/or representations regarding the veracity, completeness, or relevance of any financial data or assumptions. Patricia Chavez - KW - San Antonio does not serve as a financial advisor to any party regarding any proposed transaction. All data and assumptions regarding financial performance, including that used for financial modeling purposes, may differ from actual data or performance. Any estimates of market rents and/or projected rents that may be provided to a party do not necessarily mean that rents can be established at or increased to that level. Parties must evaluate any applicable contractual and governmental limitations as well as market conditions, vacancy factors and other issues in order to determine rents from or for the property.

Legal questions should be discussed by the party with an attorney. Tax questions should be discussed by the party with a certified public accountant or tax attorney. Title questions should be discussed by the party with a title officer or attorney. Questions regarding the condition of the property and whether the property complies with applicable governmental requirements should be discussed by the party with appropriate engineers, architects, contractors, other consultants and governmental agencies. All properties and services are marketed by Patricia Chavez - KW - San Antonio in compliance with all applicable fair housing and equal opportunity laws.



TABLE OF CONTENTS

PROPERTY INFORMATION	3
PROPERTY SUMMARY	4
PROPERTY DETAILS	5
PROPERTY PHOTOS	6
LOCATION INFORMATION	7
REGIONAL MAP	8
LOCATION MAP	9
AERIAL MAP	10

13943 TOEPPERWEIN RD

PROPERTY INFORMATION

1

PROPERTY SUMMARY

PROPERTY DETAILS

PROPERTY PHOTOS

Property Summary



PROPERTY DESCRIPTION

Do you own and/or operate an Auto Service / Auto Repair / Auto Collision business and are looking for a shop to expand into? Do you have a fleet of vehicles that need to be stored securely? This 8400 Square Foot shop has one air conditioned office and restroom with 13 grade level drive-in bays. This shop is located off of Toepperwein Rd between Interstate 35 and Lookout Rd. Has parking ever been an issue? This 1.563 acre property has LOTS of surface parking for plenty of vehicles. This shop comes equipped with 5 Automotive 2 Post Car Lifts, with the lifting capacity of 10,000 lbs. Dual electrical panels are 3 phase with a transformer. One is a 480/277 High-leg Delta and the other is a 208/120 Single Phase. This flagged shaped lot offers a tenant and their customers 2 entrance/exits off Toepperwein Rd and/or Topper Pass. Base Rent is \$13.2 PSF + \$3.56 NNN PSF = \$16.76 SF/yr annually or \$11,732.00 Monthly

PROPERTY HIGHLIGHTS

OFFERING SUMMARY

Lease Rate:	\$13.20 SF/yr (NNN)
Available SF:	8,400 SF
Lot Size:	1.563 Acres
Building Size:	8,400 SF

DEMOGRAPHICS	0.3 MILES	0.5 MILES	1 MILE
Total Households	262	1,003	4,073
Total Population	810	3,070	11,866
Average HH Income	\$77,911	\$79,242	\$83,340



Property Details

Lease Rate **\$13.20 SF/YR**

LOCATION INFORMATION

Street Address 13943 Toepperwein Rd
 City, State, Zip San Antonio, TX 78233
 County Bexar
 Cross-Streets Toepperwein & Lookout Rd.
 Side of the Street Southwest
 Signal Intersection No
 Road Type Paved
 Nearest Highway Interstate 35
 Nearest Airport San Antonio International

BUILDING INFORMATION

Building Size 8,400 SF
 Occupancy % 0.0%
 Ceiling Height 16 ft
 Office Space 300 SF
 Number of Floors 1
 Average Floor Size 8,400 SF
 Year Built 2017
 Construction Status Existing
 Framing Steel
 Condition Excellent

PROPERTY INFORMATION

Property Type Auto Repair
 Property Subtype Flex Space
 Zoning C-3
 Lot Size 1.563 Acres
 APN # 140490020020
 Lot Frontage 200 ft
 Lot Depth 300 ft
 Corner Property No
 MLS # 1782747
 Power No
 Rail Access No

PARKING & TRANSPORTATION

Street Parking No
 Parking Type Surface
 Number of Parking Spaces 50

UTILITIES & AMENITIES

Security Guard No
 Handicap Access Yes
 Freight Elevator No
 HVAC Office only, Window Unit
 Leed Certified No
 Restrooms 1



Property Photos

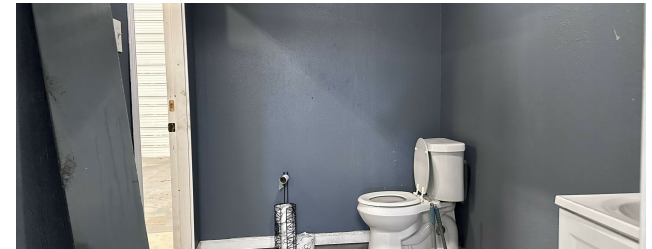
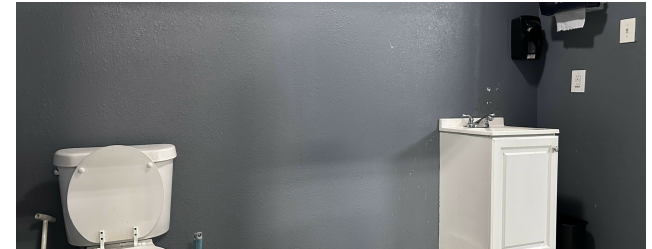
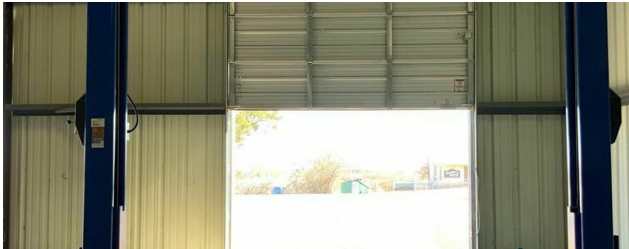

13943 TOEPPERWEIN RD

LOCATION INFORMATION

2

REGIONAL MAP

LOCATION MAP

AERIAL MAP

Regional Map



Location Map

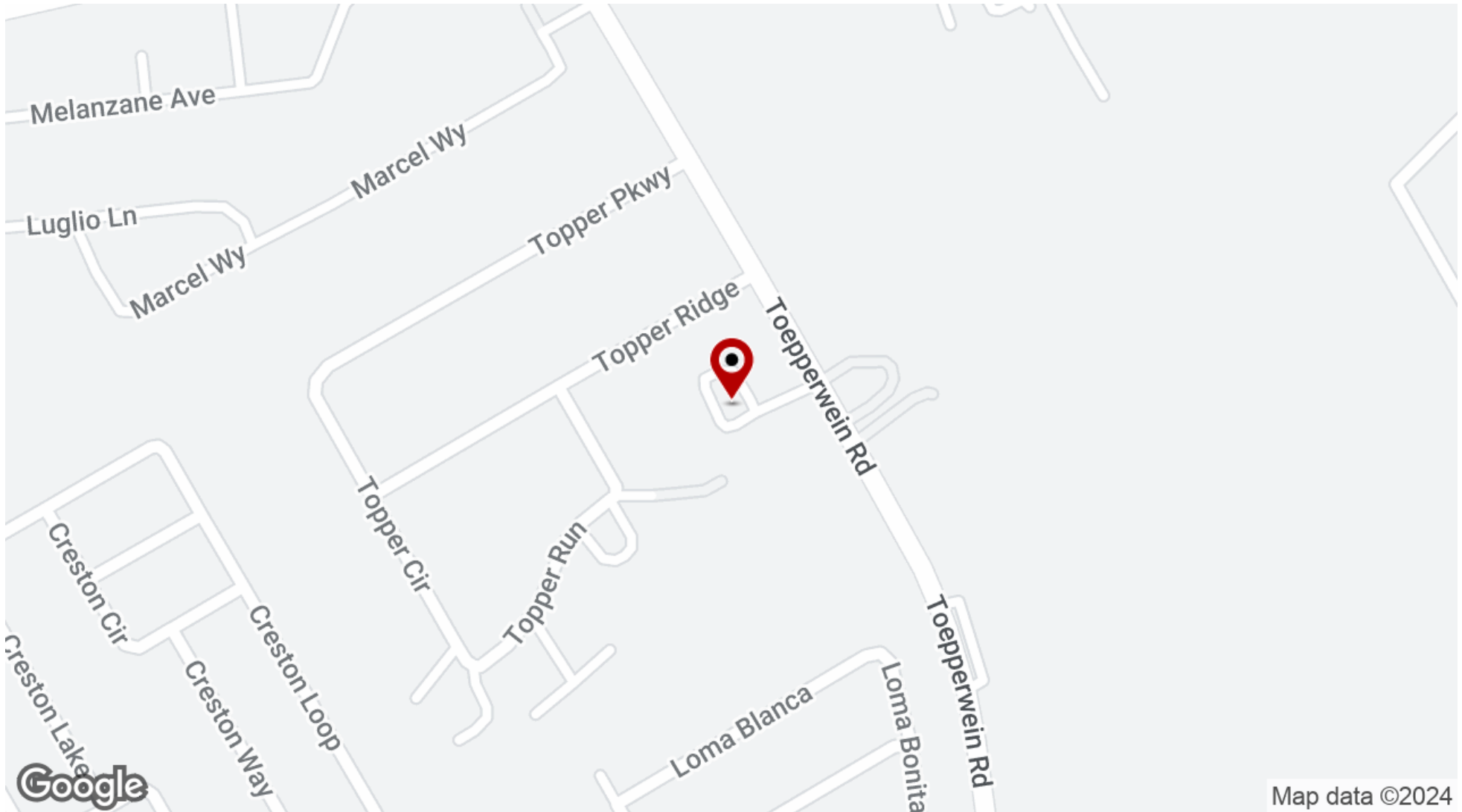

Aerial Map

