



Working Together
for You.

Robert Pettit

Direct (225) 769-0405
Email Robert@waterspettit.com

Geordy Waters CCIM

Direct (225) 769-0405
Email Geordy@waterspettit.com

**Waters & Pettit
Commercial Real Estate**

8054 Summa Avenue, Suite E
Baton Rouge, LA 70809

Retail/Restaurant/Office Space For Lease

OVERVIEW

1509 GOVERNMENT STREET, BATON ROUGE, LA

ELECTRIC DEPOT



Phase I of the revitalization of the old Entergy power plant on Government Street in Baton Rouge's Mid-City is complete. Over 35,000 square feet of retail, restaurant, entertainment, & living space has been leased. Come be a part of this unique "social space" known as ELECTRIC DEPOT - the premier redevelopment project in the Capital Region.

In addition to a vibrant tenant mix, Electric Depot has a central green area for guests to gather, relax, and enjoy periodic outdoor events (music, markets, yoga...).

Phase II to include approximately 100 residential units, is currently in the planning process and anticipated to be completed in 2021.

Current tenant list includes:

Red Stick Social (Opened 4/2019):

A multi-level 25,000 square foot entertainment venue with bowling alleys, live music, private party spaces, restaurant & bar.

City Roots (Opened 12/2019):

A new coffee concept by Matt Saurage of Community Coffee - on site coffee bean roasting, handcrafted coffees, nitro-coffees, draft lattes, teas and weekly coffee tastings.

BÖRU (Opening 2/2020):

An exciting new Japanese ramen and poke eatery operated by the owners of Ichiban Japanese Grill & Sushi Bar.

Achroma (opened 9/2019):

A photography studio and art gallery.

Blue Corn Tequila & Tacos (opening 8/2020):

2nd location for this popular traditional Mexican restaurant

Contact listing broker today for more information and to schedule a tour of Electric Depot...

PHASE I -

Building A:	-25,000-SF (LEASED)
Building B:	*4,570 SF
Building C:	3,908 SF + Patio
Building D:	3,366-SF (LEASED)
Lease Rate:	\$24-\$29 PSF, NNN

**Minimum leaseable area is 700+/- Sq ft*

Even though obtained from sources deemed reliable, no warranty or representation, expressed or implied is made as to the accuracy of the information herein, and it is subject to errors, omissions, change of price, rental or other conditions, withdrawal without notice, and to any special listing conditions imposed by our principals.



Ph (225) 769-0405 waterspettit.com facebook.com/WatersPettit



Retail/Restaurant/Office Space For Lease

PHOTOS

1509 GOVERNMENT STREET, BATON ROUGE, LA

ELECTRIC DEPOT

Working Together
for You.

Robert Pettit

Direct (225) 769-0405

Email Robert@waterspettit.com

Geordy Waters CCIM

Direct (225) 769-0405

Email Geordy@waterspettit.com

Waters & Pettit Commercial Real Estate

8054 Summa Avenue, Suite E
Baton Rouge, LA 70809

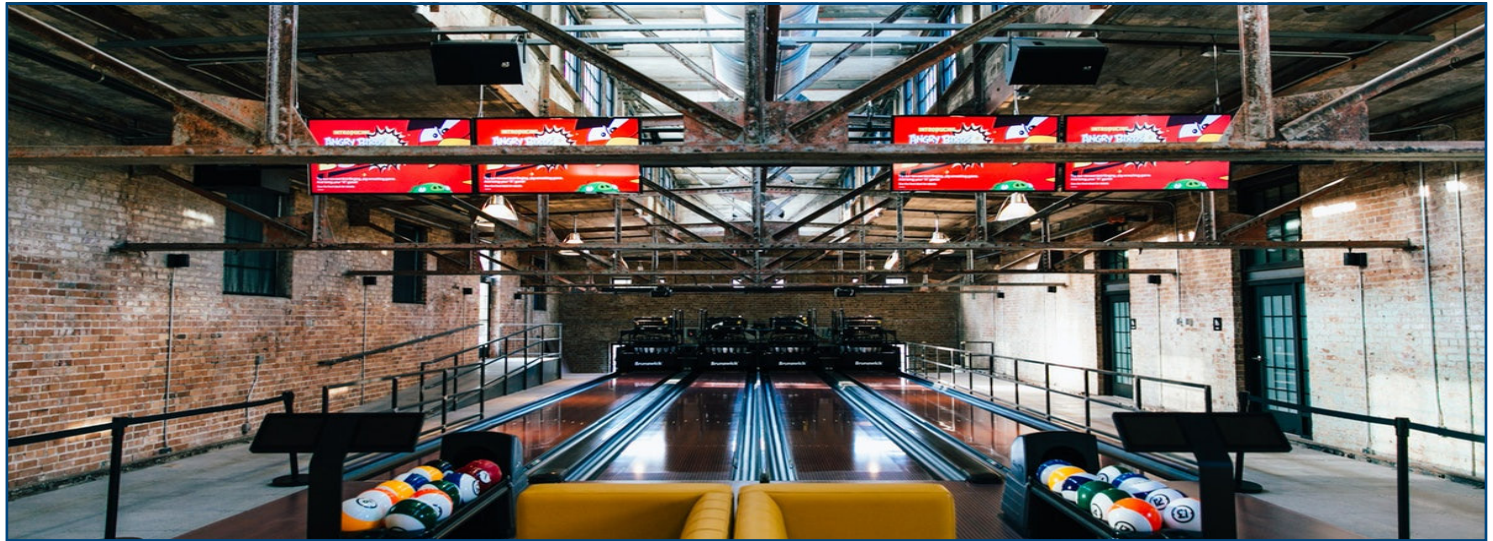

Ph (225) 769-0405

waterspettit.com



facebook.com/WatersPettit

Even though obtained from sources deemed reliable, no warranty or representation, expressed or implied is made as to the accuracy of the information herein, and it is subject to errors, omissions, change of price, rental or other conditions, withdrawal without notice, and to any special listing conditions imposed by our principals.



Working Together
for You.

Robert Pettit

Direct (225) 769-0405
Email Robert@waterspettit.com

Geordy Waters CCIM

Direct (225) 769-0405
Email Geordy@waterspettit.com

**Waters & Pettit
Commercial Real Estate**

8054 Summa Avenue, Suite E
Baton Rouge, LA 70809

Retail/Restaurant/Office Space For Lease

1509 GOVERNMENT STREET, BATON ROUGE, LA

BUILDING B

ELECTRIC DEPOT



Retail or Office

Only 4,570 SF remains!

Demising walls not in place.
Suite sizes and layout can be
modified to suit needs.



Ph (225) 769-0405 waterspettit.com facebook.com/WatersPettit

Even though obtained from sources deemed reliable, no warranty or representation, expressed or implied is made as to the accuracy of the information herein, and it is subject to errors, omissions, change of price, rental or other conditions, withdrawal without notice, and to any special listing conditions imposed by our principals.



Working Together
for You.

Robert Pettit

Direct (225) 769-0405
Email Robert@waterspettit.com

Geordy Waters CCIM

Direct (225) 769-0405
Email Geordy@waterspettit.com

Waters & Pettit Commercial Real Estate

8054 Summa Avenue, Suite E
Baton Rouge, LA 70809

Retail/Restaurant/Office Space For Lease

1509 GOVERNMENT STREET, BATON ROUGE, LA

BUILDING C

ELECTRIC DEPOT



Office or Retail

Interior (Climate Controlled): 3,908 SF
Patio/Deck: 540 SF
Total: 4,448 SF

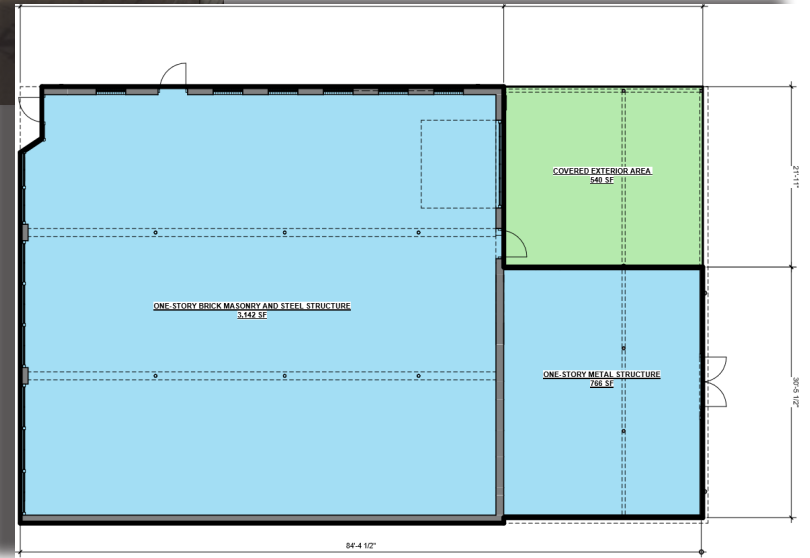

Ph (225) 769-0405 waterspettit.com [facebook.com/WatersPettit](https://www.facebook.com/WatersPettit)

Even though obtained from sources deemed reliable, no warranty or representation, expressed or implied is made as to the accuracy of the information herein, and it is subject to errors, omissions, change of price, rental or other conditions, withdrawal without notice, and to any special listing conditions imposed by our principals.



Working Together
for You.

Robert Pettit

Direct (225) 769-0405
Email Robert@waterspettit.com

Geordy Waters CCIM

Direct (225) 769-0405
Email Geordy@waterspettit.com

**Waters & Pettit
Commercial Real Estate**

8054 Summa Avenue, Suite E
Baton Rouge, LA 70809

Retail/Restaurant/Office Space For Lease

1509 GOVERNMENT STREET, BATON ROUGE, LA

BUILDING D

ELECTRIC DEPOT



LEASED

Restaurant or Retail

Interior (Climate Controlled) 3,366 SF
Patio/Deck: 1,193 SF
Total: 4,559 SF

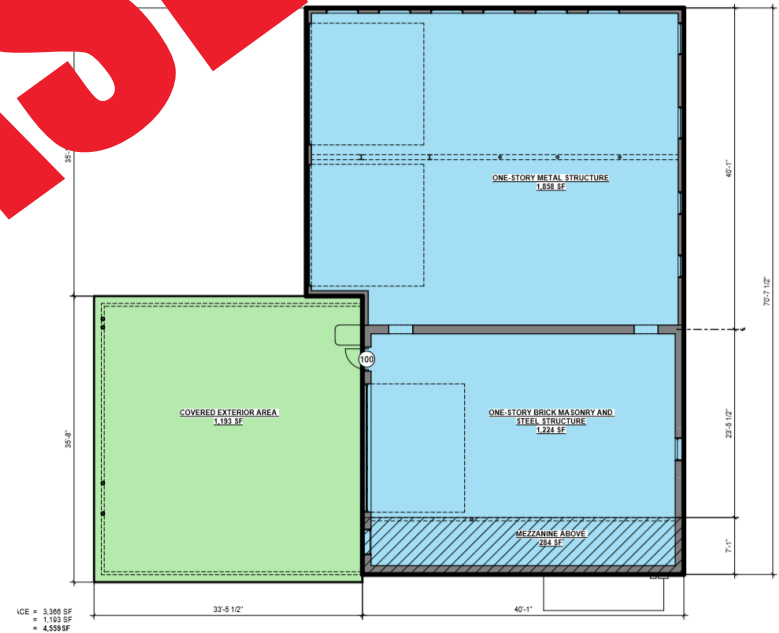

Ph (225) 769-0405 waterspettit.com facebook.com/WatersPettit

Even though obtained from sources deemed reliable, no warranty or representation, expressed or implied is made as to the accuracy of the information herein, and it is subject to errors, omissions, change of price, rental or other conditions, withdrawal without notice, and to any special listing conditions imposed by our principals.



Working Together
for You.

Robert Pettit

Direct (225) 769-0405
Email Robert@waterspettit.com

Geordy Waters CCIM

Direct (225) 769-0405
Email Geordy@waterspettit.com

Waters & Pettit Commercial Real Estate

8054 Summa Avenue, Suite E
Baton Rouge, LA 70809

Retail/Restaurant/Office Space For Lease

1509 GOVERNMENT STREET, BATON ROUGE, LA

SITE PLAN

ELECTRIC DEPOT



Ph (225) 769-0405 waterspettit.com facebook.com/WatersPettit

Even though obtained from sources deemed reliable, no warranty or representation, expressed or implied is made as to the accuracy of the information herein, and it is subject to errors, omissions, change of price, rental or other conditions, withdrawal without notice, and to any special listing conditions imposed by our principals.



Working Together
for You.

Robert Pettit

Direct (225) 769-0405
Email Robert@waterspettit.com

Geordy Waters CCIM

Direct (225) 769-0405
Email Geordy@waterspettit.com

Waters & Pettit Commercial Real Estate

8054 Summa Avenue, Suite E
Baton Rouge, LA 70809

Retail/Restaurant/Office Space For Lease

LOCATION

1509 GOVERNMENT STREET, BATON ROUGE, LA

ELECTRIC DEPOT



Ph (225) 769-0405 waterspettit.com [facebook.com/WatersPettit](https://www.facebook.com/WatersPettit)

Even though obtained from sources deemed reliable, no warranty or representation, expressed or implied is made as to the accuracy of the information herein, and it is subject to errors, omissions, change of price, rental or other conditions, withdrawal without notice, and to any special listing conditions imposed by our principals.