



1427 E 10th Street

Suite 101 | Charlotte, North Carolina 28204



Available for Lease

+/- 500 SF Retail/Office Space in Plaza Midwood

Property Overview

1427 E 10th Street Available for Lease

Introducing E. 10th St, Suite 101. One individual suite, perfect for those seeking a small space in a prime location. Whether you're an entrepreneur looking for a stylish storefront or a professional looking for office space, these suites offer endless possibilities. Don't miss this opportunity to elevate your business in one of Charlotte's most dynamic neighborhoods.

Property Details

Address	1427 E 10th Street Charlotte, NC 28204
Availability	Suite 101 +/- 500 SF
Zoning	NC
Parcel	08111424
Traffic Counts	E 10th Street 12,000 VPD
Pricing	Suite 101 \$2,800.00/Month, NNN fee estimated at \$5 per sq/ft *All leases are a 1-year term minimum*

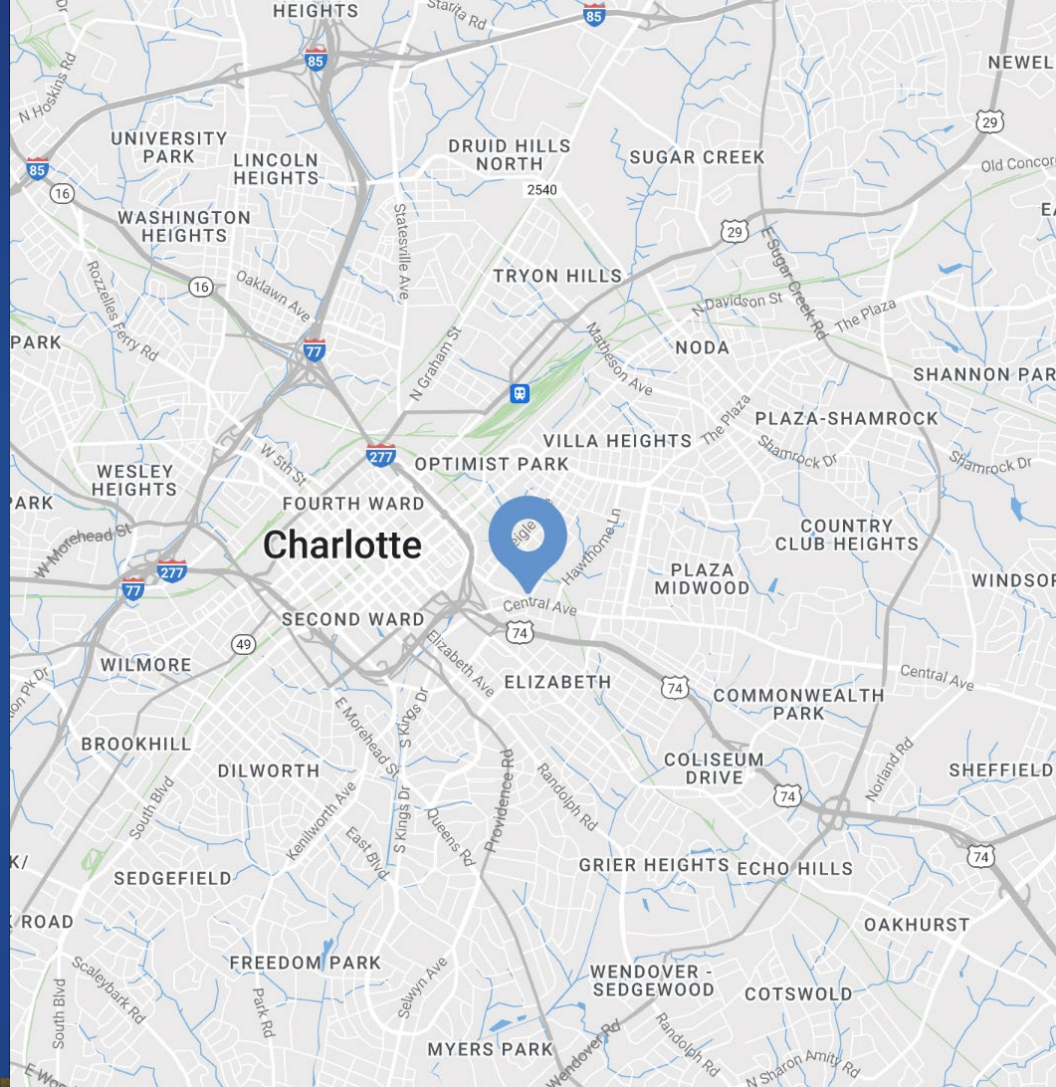

Demographics

RADIUS	1 MILE	3 MILE	5 MILE
2025 Population	17,344	135,526	303,421
Avg. Household Income	\$141,735	\$151,132	\$133,906
Median Household Income	\$93,811	\$96,901	\$80,624
Households	9,911	71,313	141,688
Daytime Employees	22,634	145,260	236,138

Available

+/- 500 SF

 Virtual Tour

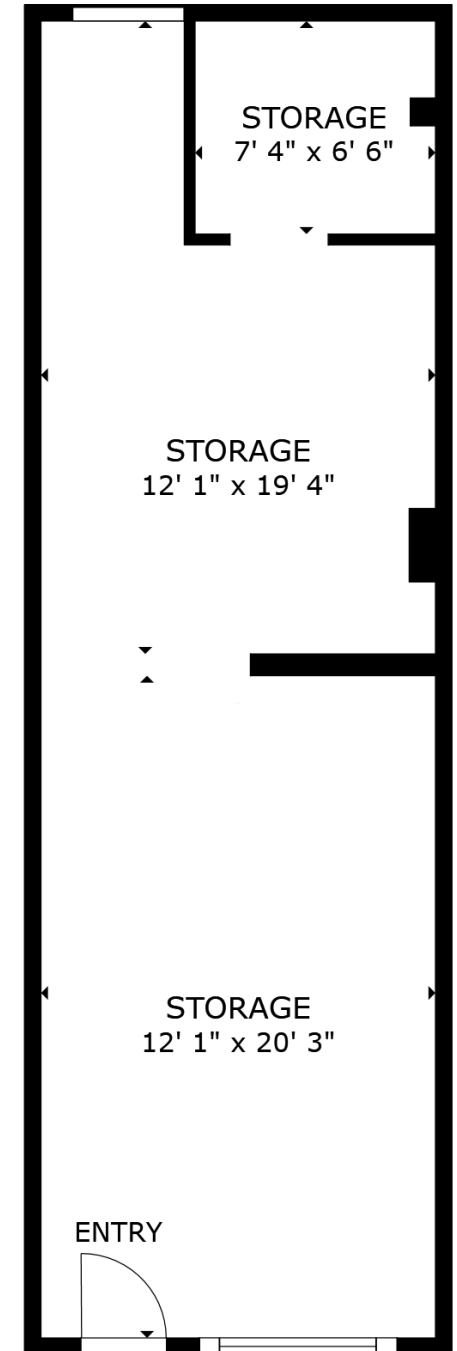

Market Overview



 LYNX Silver Line (PROPOSED)
 LYNX Gold Line & Extension

Site

Piedmont Open IB Middle School
1,088 Students

Lynx Silver Line (Proposed)

Central Piedmont Community College
50,000+ Students

skyla credit union
Skyla Credit Union Branch & Headquarters

Lynx Gold Line Street Car

12 AC Mixed-Use Redevelopment
Retail & Restaurants
383 Apartment Units
Boutique Hotel
400,000+ SF Office Space
Green Space





Contact for Details

Lauren Bremer

(980) 226-6911

lauren@thenicholscompany.com



Website

www.TheNicholsCompany.com

Phone

Office (704) 373-9797

Fax (704) 373-9798

Address

1204 Central Avenue, Suite 201

Charlotte, NC 28204

This information has been obtained from sources believed to be reliable. While we do not doubt its accuracy, we have not verified it and make no guarantee, warranty or representation to independently confirm its accuracy and completeness.