

NEW - TO - MARKET

15630 S FIGUEROA STREET, LOS ANGELES, CA 90248

OVERSIZED GROUND LEVEL DOOR WITH FENCED YARD & PARKING

FANTASTIC CENTRAL LOCATION NEAR THE 91, 105, 110, & 405 FWYs

AVAILABLE FOR LEASE

- 8,567 ± SF BUILDING
- 2,280 ± SF OFFICE
- FENCED YARD



PROPERTY FEATURES

- + 8,567 ± Square Feet of Building
- + 6,287 ± Square Feet of Warehouse Space
- + 2,280 ± Square feet of Office Space
- + 14' Clear Height
- + Oversized Ground Level Door
- + Fenced and Secured Yard
- + Nearly 2:1000 Parking Ratio
- + Easy Access to the 91, 105, 110, & 405 FWYs
- + 10 Miles from LA/LB Ports
- + Long Term Owner and Manager



**REALTY
ADVISORY
GROUP, INC.**

RAGINC.COM

JIMABBOTT, JR. (213) 892-8881 x 228 | JWABBOTT@RAGINC.COM | ID:01870203

CORPORATE HQ: 545 SOUTH FIGUEROA STREET, SUITE 1209, LOS ANGELES, CA 90071
CORPORATE ID: 01301202

Neither owner nor broker make any representations or warranties as to the accuracy or completeness of any evaluations materials, including building dimensions, any assumptions and resulting projections or that actual results will conform to any projections contained herein. Owner and broker expressly disclaim any liability for representations or warranties, expressed or implied, contained in this brochure, or in any other written, oral, or other communications transmitted or made available to prospective buyers, including and without limitation to, electronic brochures, computer disks containing files with floor plans, financial data and projections, etc.

15630 FIGUEROA STREET, LOS ANGELES, CA AVAILABLE FOR LEASE

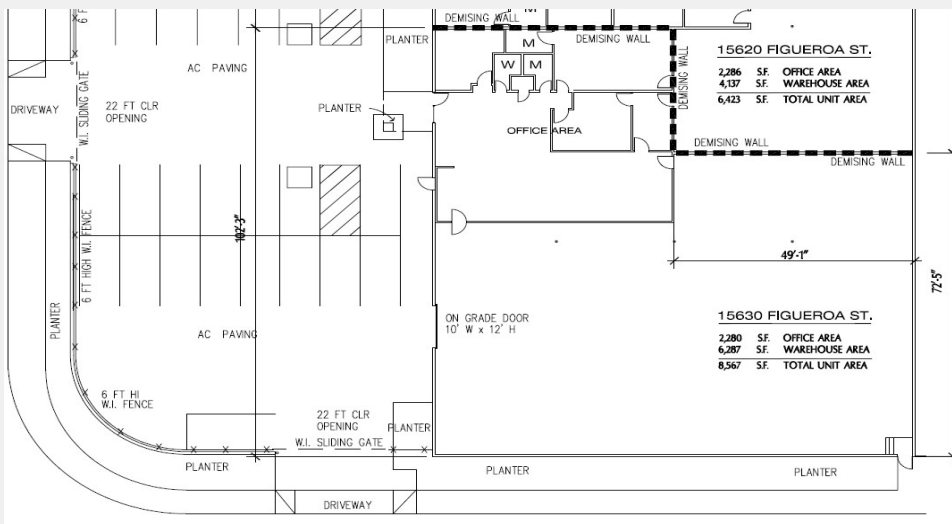

CONTACT

JIM ABBOTT, JR. (213) 892-8881 x 228 | JWABBOTT@RAGINC.COM | ID:01870203



**REALTY
ADVISORY
GROUP, INC.**

RAGINC.COM

CORPORATE HQ: 545 SOUTH FIGUEROA STREET, SUITE 1209, LOS ANGELES, CA 90071
 CORPORATE ID: 01301202

Neither owner nor broker make any representations or warranties as to the accuracy or completeness of any evaluations materials, including building dimensions, any assumptions and resulting projections or that actual results will conform to any projections contained herein. Owner and broker expressly disclaim any liability for representations or warranties, expressed or implied, contained in this brochure, or in any other written, oral, or other communications transmitted or made available to prospective buyers, including and without limitation to, electronic brochures, computer disks containing files with floor plans, financial data and projections, etc.

SOUTH FIGUEROA ST.

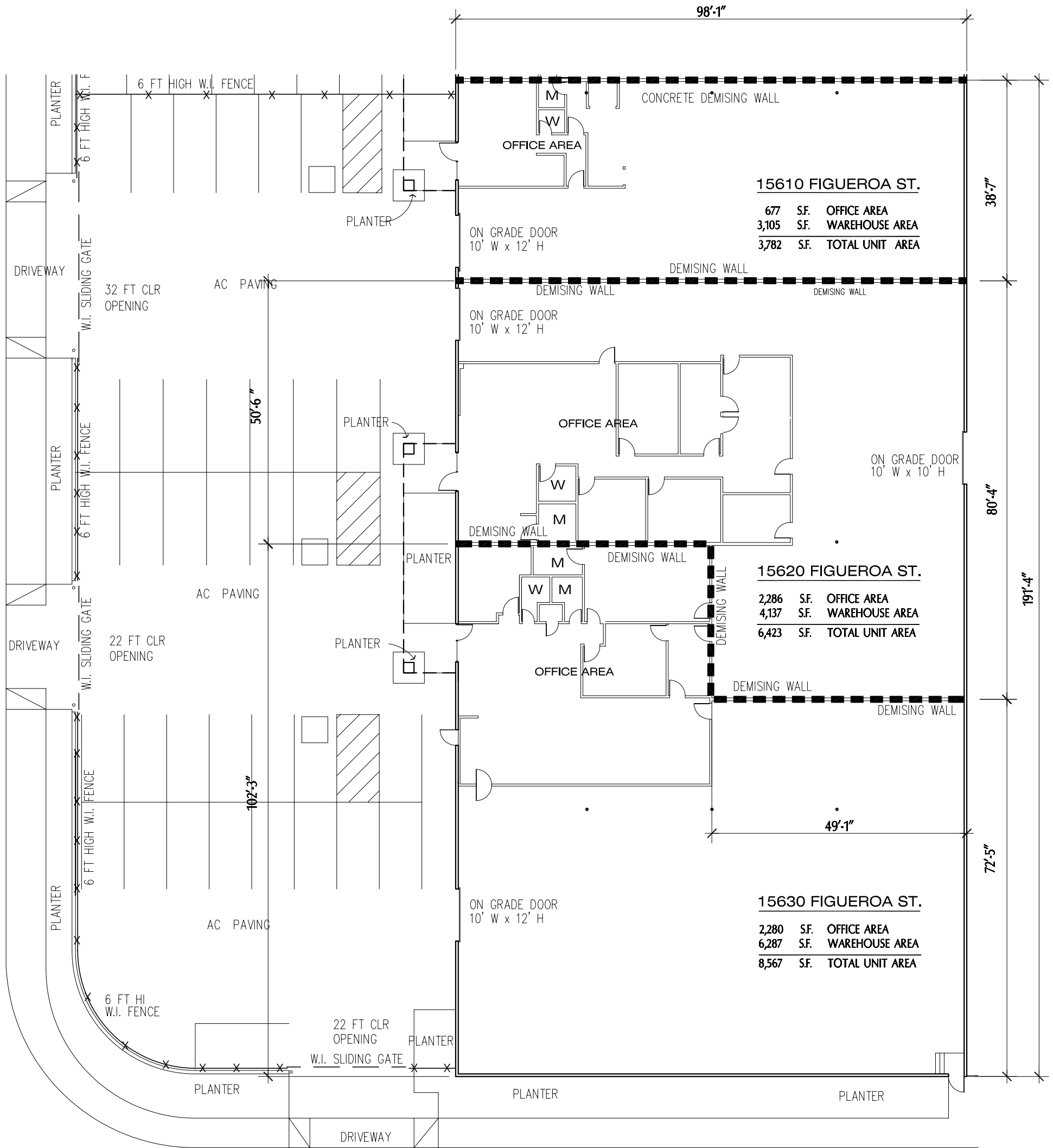

157 th STREET

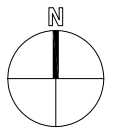

0 5' 10' 20' 40'
SCALE: 1" = 20'

GARDENA BUSINESS PARK - BUILDING 3

15610 - 15620 - 15630 FIGUEROA STREET- GARDENA, CALIFORNIA