

RESTAURANT SPACE AVAILABLE

# 570 BATTERY STREET

SAN FRANCISCO | FINANCIAL DISTRICT

maven  
RETAIL

# LOCATION HIGHLIGHTS

- Located a little over one block from the Embarcadero, San Francisco Bay, the Ferry Building and Transamerica Pyramid
- The Ferry Building, located across the street, is widely acclaimed for both the quality and diversity of its fresh farm products, and artisan and prepared foods
- Walk score of 99 - located close to employment, entertainment and complimentary retail - all daily errands can be accomplished without the need for a car or public transportation
- Located at a nexus of transportation options and attractions (all distances approximate).
  - +/- 0.2 miles to the Embarcadero BART Station
  - +/- 1 mile to the on-ramp of Interstate 80 and the Bay Bridge
  - Less than 5 miles to the Golden Gate Bridge and Highway 101
  - +/- 1.3 miles to AT&T Park, home of the San Francisco Giants

<b>WALK SCORE</b>	<b>TRANSIT SCORE</b>	<b>BIKE SCORE</b>
99	100	85



LEGEND

- SERVICES
- RESTAURANT & CAFE
- RETAIL







# 570 BATTERY

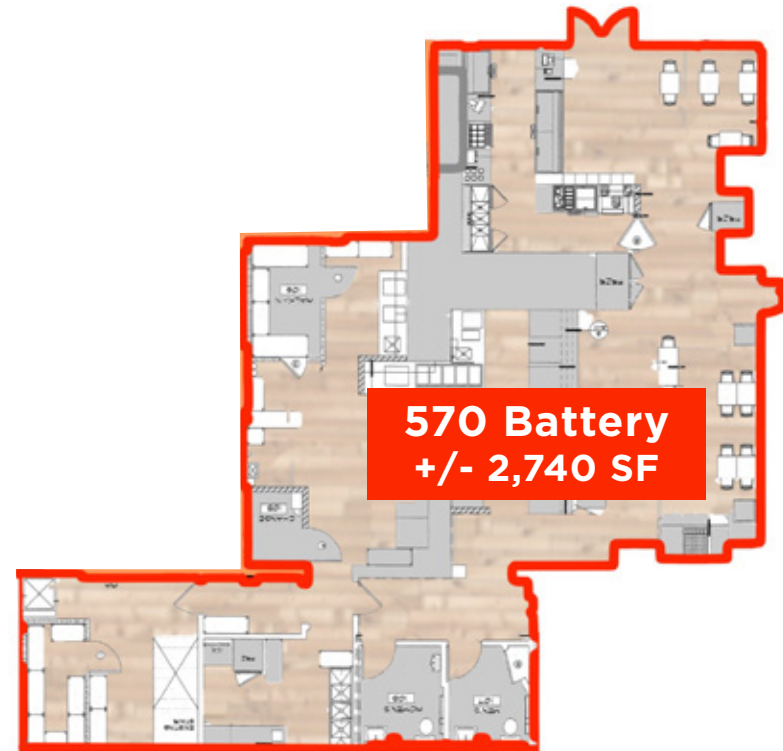

## FEATURES

- Great space that can be modified.
- Corner retail/restaurant space located at the Jackson & Battery intersection
- Large outdoor tree-lined garden with seating potential
- Generous tenant improvement allowance

# GATEWAY LEASING MAP

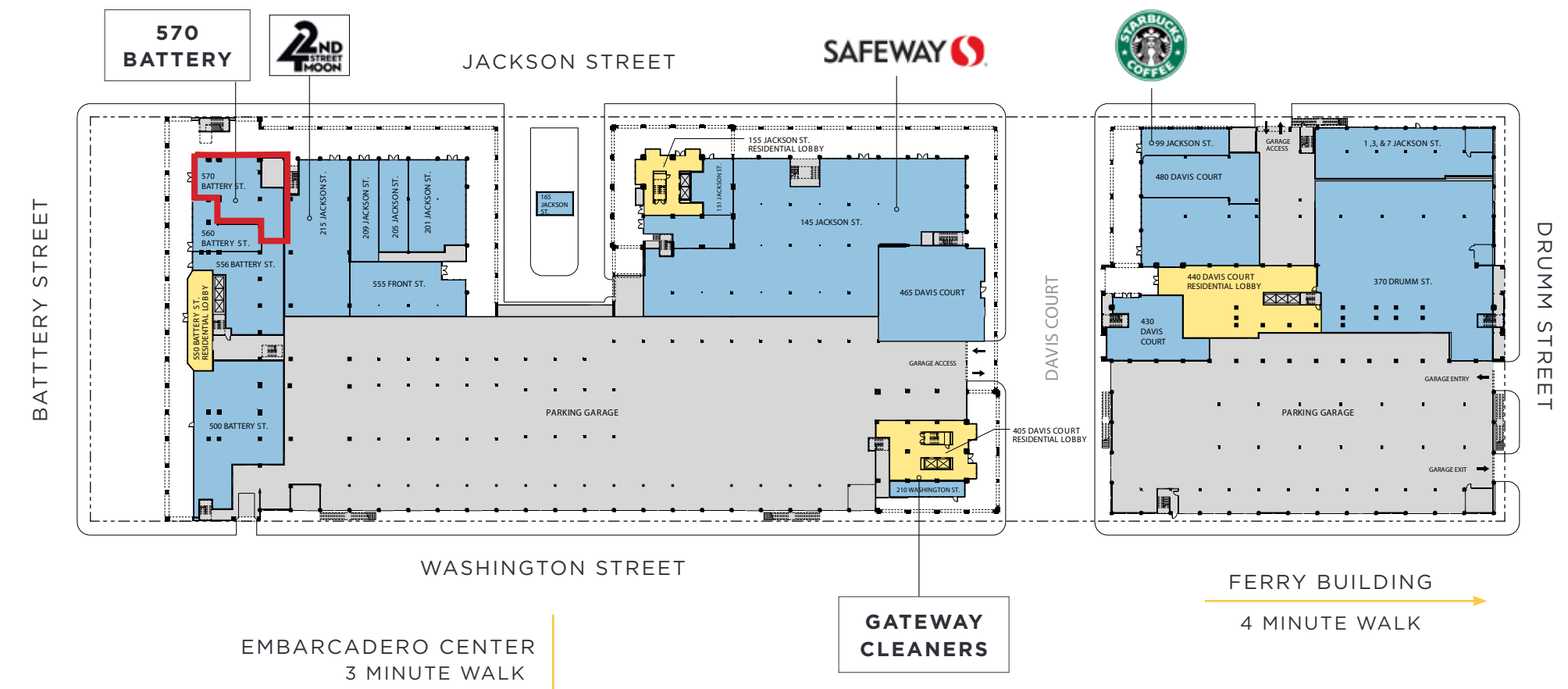





## GATEWAY NEIGHBORS



# 570 BATTERY

SAN FRANCISCO



## CONTACT

**ALI MCEVOY**  
office 415.404.7343  
ali@mavenproperties.com  
DRE #01930635

**HALEY KLEIN**  
office 415.404.7330  
haley@mavenproperties.com  
DRE #1907308

**SANTINO DEROSE**  
office 415.404.7337  
sd@mavenproperties.com  
DRE #01338326

NOTICE: This information has been secured from sources we believe to be reliable but we make no representations, warranties, express or implied, as to the accuracy of the information. Listing broker has been given enough information to provide only a preliminary interest in the property. The materials are not to be considered fact. The information contained herein is not a substitute for thorough due diligence investigation. References to square footage, zoning, use, or age are approximate. Please contact the San Francisco Planning Department to verify zoning at (415) 558-6378, as neither broker or landlord represent that this space is suitable for your use. Tenant or Buyer must verify the information at their own expense and bears all the risk for any inaccuracies. By receiving these materials you are agreeing to the disclaimers set forth herein. DRE#01878802

466 Green Street Suite #203, San Francisco, CA 94133  
www.mavenproperties.com | 415-781-7700