



Cedar Springs

Build-To-Suit
Warehouse Available

Entitled and Site Plan
Approved for 480,000 SF

11943 Greencastle Pike,
Hagerstown, MD



Thomas Gentner

Executive Vice President
DIR +1 410 319 2407
MOB +1 410 499 2599
tom.gentner@colliers.com

Brian Watts

Executive Vice President
DIR +1 410 319 2408
MOB +1 410 446 0203
brian.watts@colliers.com

John Lesinski

Vice Chair
DIR +1 703 394 4846
MOB +1 540 671 5721
john.lesinski@colliers.com

Ben Luke, SIOR

Executive Vice President
DIR +1 703 394 4810
MOB +1 540 229 7294
ben.luke@colliers.com





Opportunity

- 480,000 SF build-to-suit
- Located 1 mile from Exit 24 on I-70 and 3 miles from the I-81/I-70 Interchange
- Located just west of the expanded FedEx Ground Regional Distribution Center and northeast of the new FedEx Freight Facility
- Direct access to Exit 5 on I-81 will be available by 2024 from Halfway Blvd. Extended
- Fully approved and entitled
- Located in the State Enterprise Incentive Zone



Proposed Site Plan

- Cross-docked facility
- 275 car spaces
- 199 trailer spaces
- Perimeter fencing

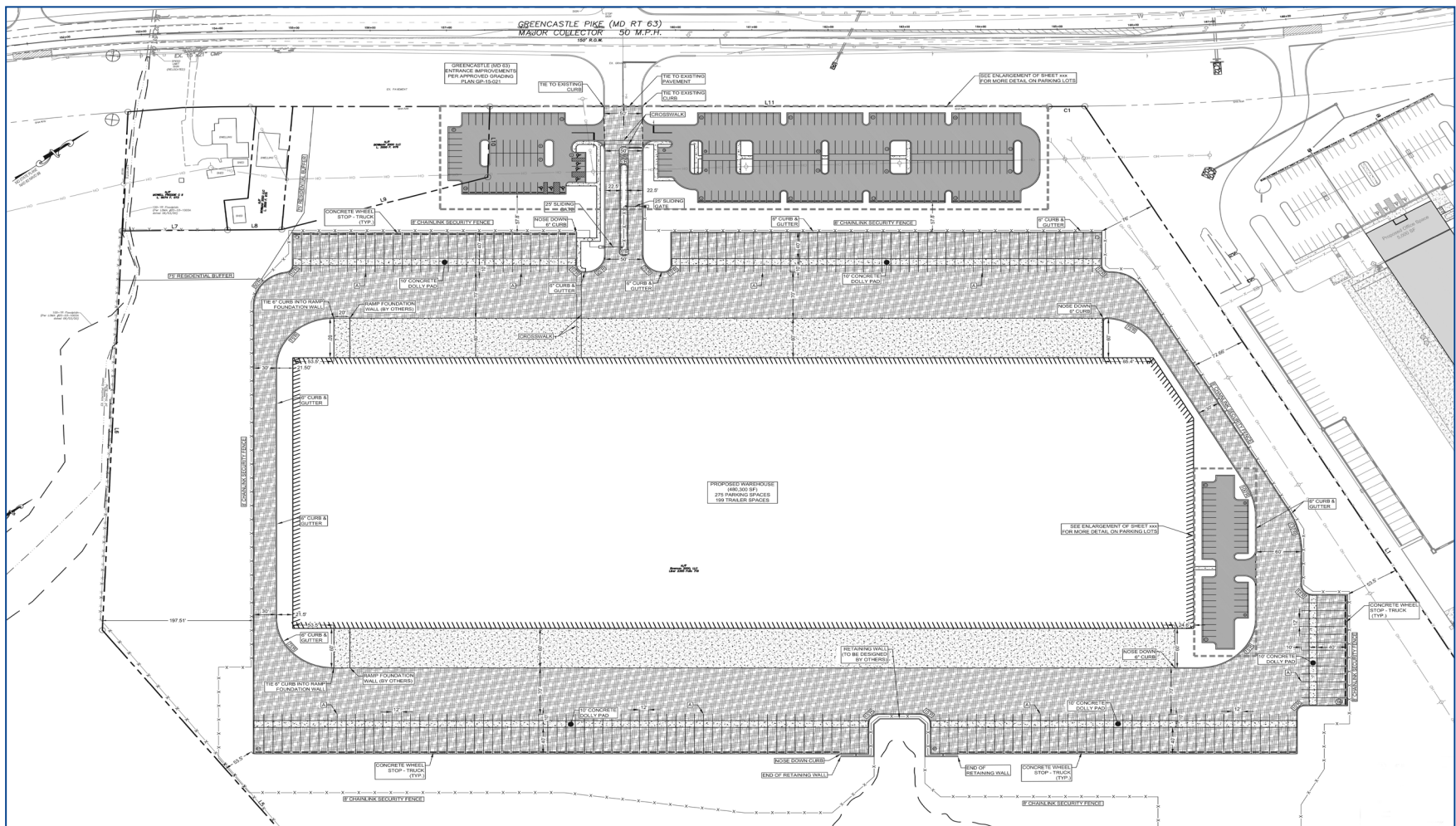

The Hopewell Valley Industrial Park



Halfway Boulevard Extended

Expected Completion: Spring 2024

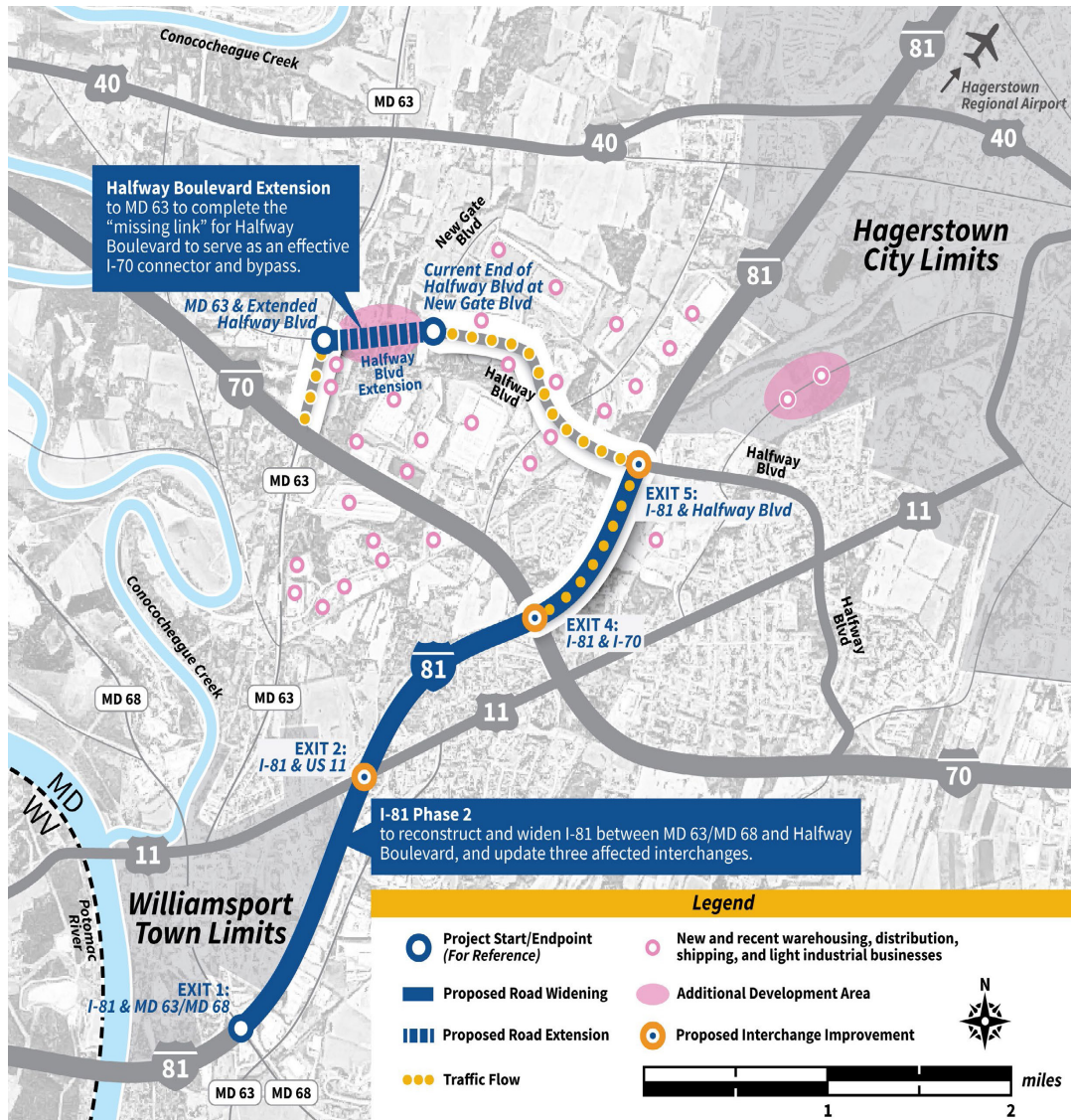

3600 Clipper Mill Road
Suite 105
Baltimore, MD 21211
+1 443 863 7210
colliers.com

Thomas Gentner
Executive Vice President
DIR +1 410 319 2407
MOB +1 410 499 2599
tom.gentner@colliers.com

Brian Watts
Executive Vice President
DIR +1 410 319 2408
MOB +1 410 446 0203
brian.watts@colliers.com

John Lesinski
Vice Chair
DIR +1 703 394 4846
MOB +1 540 671 5721
john.lesinski@colliers.com

Ben Luke, SIOR
Executive Vice President
DIR +1 703 394 4810
MOB +1 540 229 7294
ben.luke@colliers.com
john.lesinski@colliers.com