

FOR LEASE

INDUSTRIAL UNITS AND YARD SPACE AVAILABLE
IMPROVEMENTS UNDERWAY!

Industrial Space Available from 3,000 SF - 6,000 SF



2901 SOUTH HIGHLAND DRIVE
LAS VEGAS, NV 89109

MIKE WILLMORE
Senior Associate
(702) 369-4823
mike.willmore@cbre.com
Lic # S.0183520

ALEX STANISIC, SIOR
First Vice President
(702) 369-4874
alex.stanisic@cbre.com
Lic # S.0179950

COMMERCIAL PARKS 
CBRE

PROPERTY HIGHLIGHTS

Freeway 15 Industrial Park is a ±309,000 SF, 17-building industrial park just two blocks from the Las Vegas Strip, offering premier visibility with nearly 300,000 vehicles per day on I-15 and immediate freeway access via Sahara Ave. The property features flexible warehouse and light-industrial spaces with secured, paved yards, 24/7 key-code access, nightly security, ample parking, and upgraded infrastructure including LED lighting. Ongoing capital improvements include new 3-phase power to select buildings, new skylights, extensive exterior upgrades, and upcoming office and restroom renovations in Buildings 1–8. Freeway 15 is a modern, high-access hub for businesses seeking exceptional exposure and connectivity in the heart of Las Vegas.



PROJECT SIZE

±309,000 SF
±79,000 SF IOS



CLEAR HEIGHT

±18' - ±24'



ACREAGE

±18.60



POWER

120/208V, 3 PHASE POWER UPGRADES
IN PROGRESS AT BUILDINGS 1 & 3



ZONING

M (INDUSTRIAL)
CITY OF LAS VEGAS



PARKING RATIO

1.4/1000 SF



GRADE LEVEL DOORS

10' X 14'



SPRINKLER SYSTEM

FULLY FIRE SPRINKLERED



NATURAL GAS SERVICE



YEAR BUILT

1980; MAJOR RENOVATIONS
COMPLETED IN 2016, ADDITIONAL
RENOVATIONS IN PROGRESS



APN

162-08-613-001, 002, 003, 004, 005, 006 AND 007
162-08-611-008, 009, 013, 014, 015 AND 016
162-09-210-001 AND 002
162-08-610-010, 011 AND 012



SITE PLAN

- = Available
- ▲ = Dock Wells
- = Grade-Level Doors



*not to scale
*all measurements are approximate

BUILDING	SUITE	TOTAL SF	OFFICE SF	AVAILABLE
2	E	3,080 SF	TBD	Available Now!
3	A	3,000 SF	0	Available June 2026
12	A	6,000 SF	TBD	Available Now!
13	A	6,000 SF	TBD	Available Now!
Yard	L	2,700 SF	N/A	Available Now!

BUILDING 2 - FLOOR PLAN

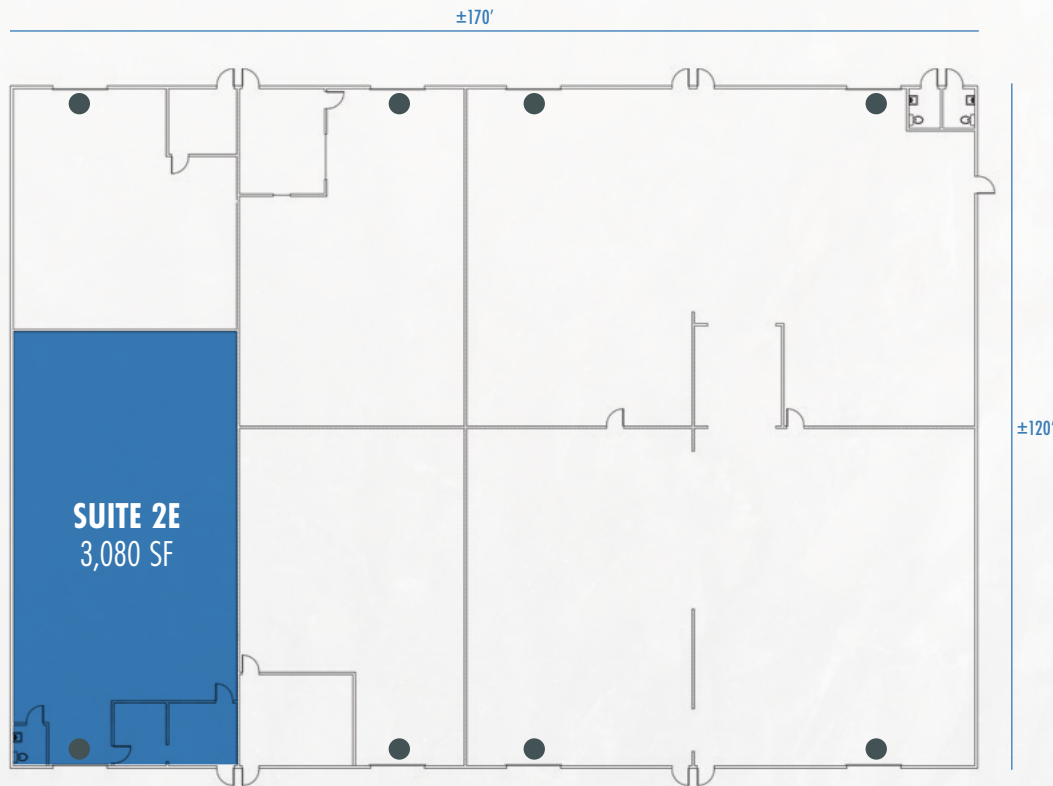

SUITE 2E – 3,080 SF

BRAND-NEW RESTROOM IMPROVEMENTS COMPLETED!

EVAPORATIVE COOLED WAREHOUSE

TWO (2) HVAC PRIVATE OFFICES

ONE (1) BRAND-NEW RESTROOM

22' CLEAR HEIGHT

ONE (1) 10' X 14' GRADE LEVEL ROLL-UP DOOR

LED WAREHOUSE LIGHTING

120/240 VOLT, SINGLE-PHASE POWER

BRAND-NEW SKYLIGHTS

\$1.15/SF (NNN)

\$0.195/SF CAM

TOTAL MONTHLY: \$4,142.60

AVAILABLE NOW!

BUILDING 3 - FLOOR PLAN

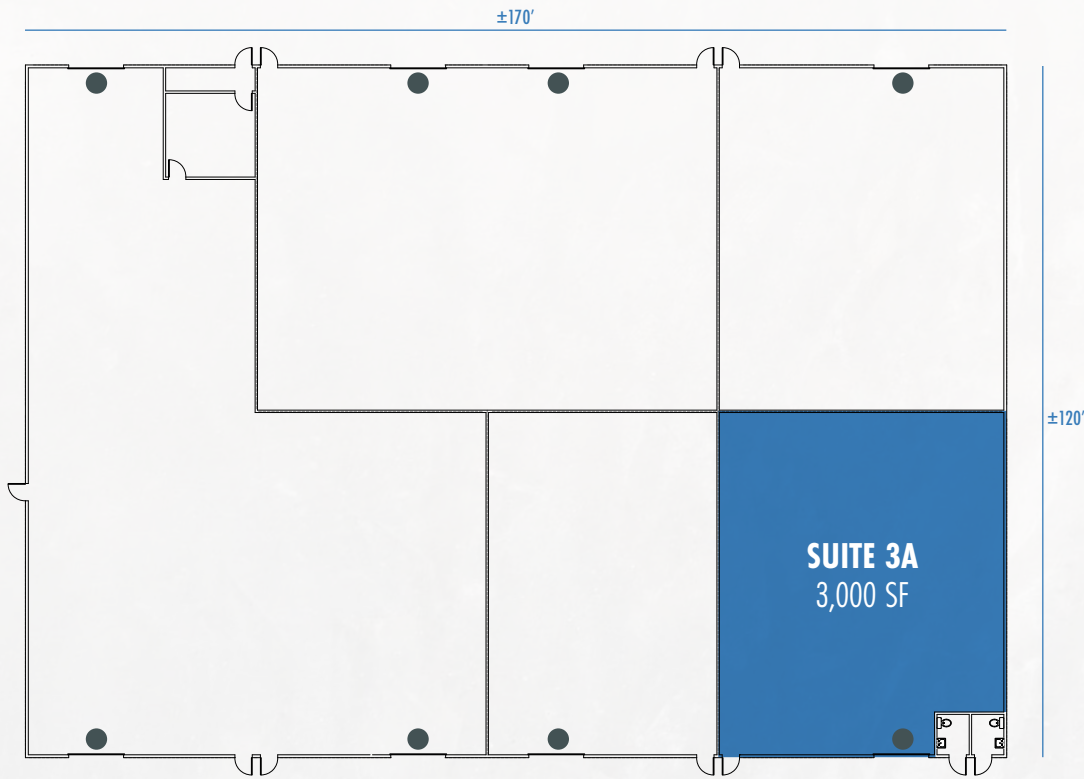

SUITE 3A – 3,000 SF

120/208V 3-PHASE POWER UPGRADE IN PROGRESS AT BUILDING 3!

EVAPORATIVE-COOLED WAREHOUSE

22' CLEAR HEIGHT

ONE (1) 10' X 14' GRADE LEVEL ROLL-UP DOOR

BRAND-NEW SKYLIGHTS

LED WAREHOUSE LIGHTING

\$1.15/SF (NNN)

\$0.195/SF CAM

TOTAL MONTHLY: \$4,035

BUILDING 12 - FLOOR PLAN

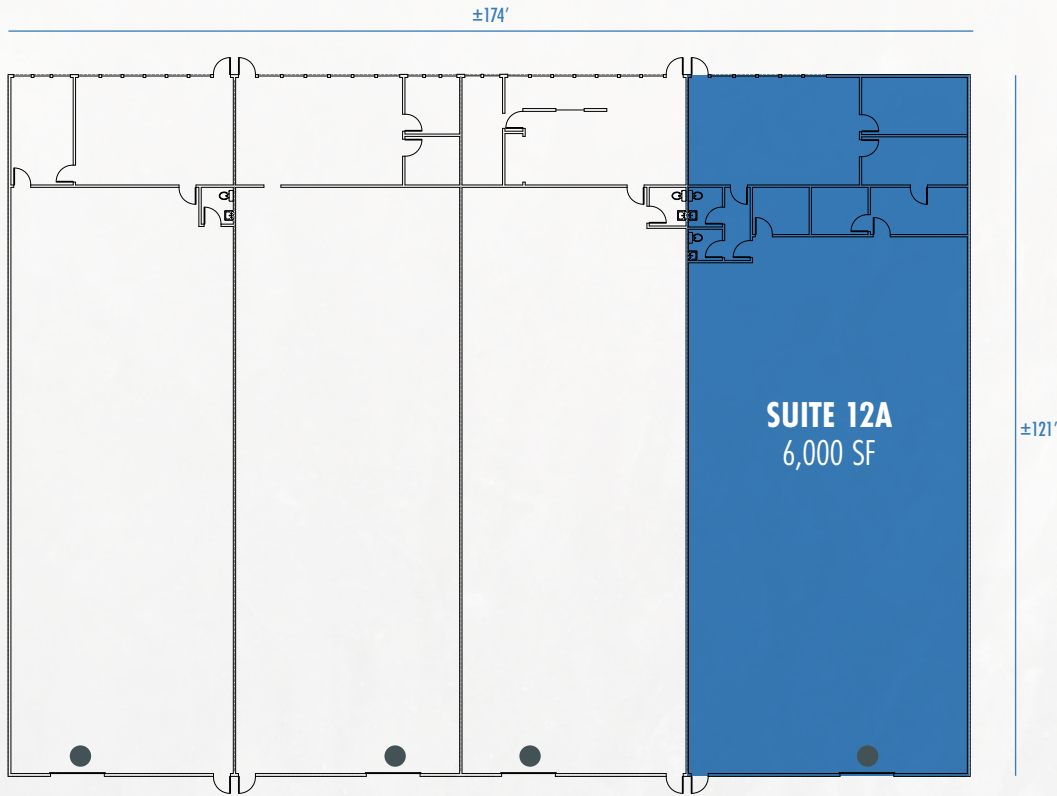

SUITE 12A – 6,000 SF

EVAPORATIVE COOLED WAREHOUSE

RECEPTION

FIVE (5) PRIVATE OFFICES

TWO (2) RESTROOMS

18' MINIMUM CLEAR HEIGHT

ONE (1) 10' X 14' GRADE LEVEL ROLL-UP DOOR

POWER: 120/208V 3-PHASE POWER

BRAND-NEW SKYLIGHTS

\$1.15/SF (NNN)

\$0.195/SF CAM

TOTAL MONTHLY: \$8,070.00

AVAILABLE NOW!

BUILDING 13 - FLOOR PLAN

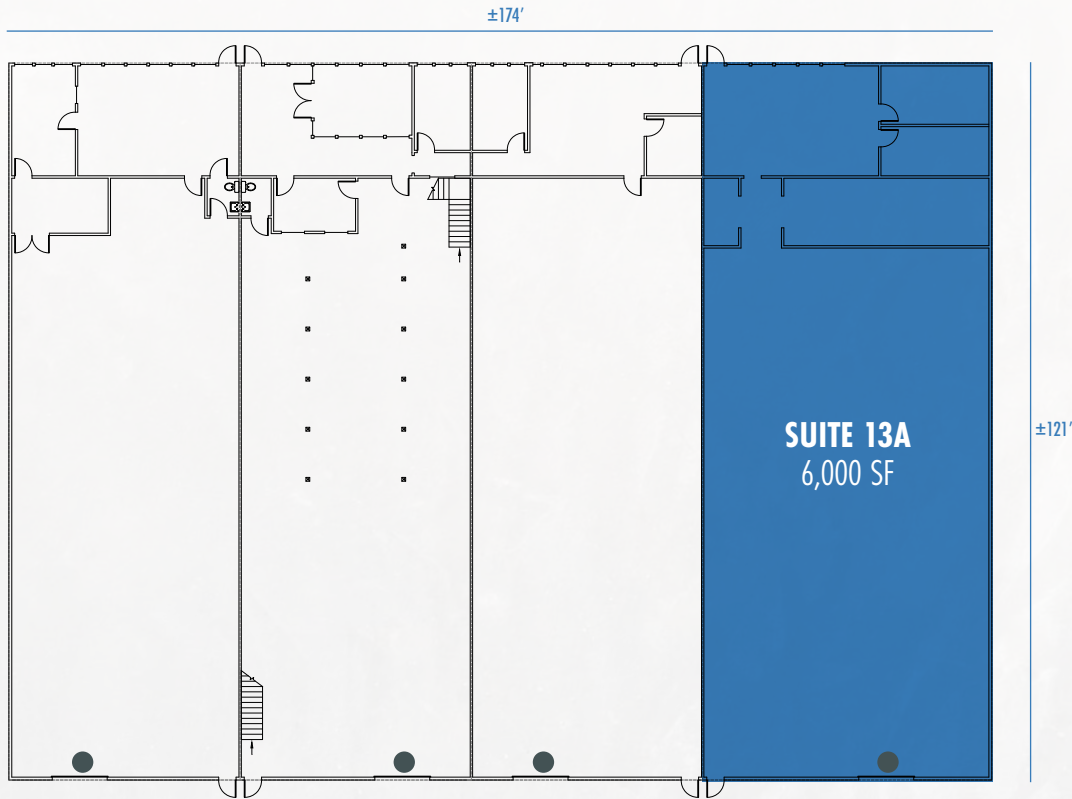

SUITE 13A – 6,000 SF

EVAPORATIVE COOLED WAREHOUSE

RECEPTION

TWO (2) PRIVATE OFFICES

TWO (2) RESTROOMS

18' MINIMUM CLEAR HEIGHT

ONE (1) 10' X 14' GRADE LEVEL ROLL-UP DOOR

POWER: 120/208V 3-PHASE POWER

BRAND-NEW SKYLIGHTS

\$1.15/SF (NNN)

\$0.195/SF CAM

TOTAL MONTHLY: \$8,070.00

AVAILABLE NOW!

YARD L

YARD L
2,700 SF

I-15 FREEWAY

YARD L – 2,700 SF

GATED, PAVED AND SECURED

\$0.40/SF (MG)

TOTAL MONTHLY: \$1,080.00

AVAILABLE NOW!

AERIAL MAP

- 1 Freeway 15 Industrial Park
- 2 Circus Circus
- 3 Area 15
- 4 Las Vegas Convention Center
- 5 The Sphere
- 6 Fashion Show Mall
- 7 The Sahara Hotel & Casino
- 8 Encore-Wynn
- 9 Venetian-Palazzo
- 10 The Rio
- 11 Allegiant Stadium
- 12 Future Las Vegas A's Ballpark
- 13 Harry Reid International Airport
- 14 T-Mobile Arena
- 15 Caesar's Palace
- 16 New Hard Rock Hotel

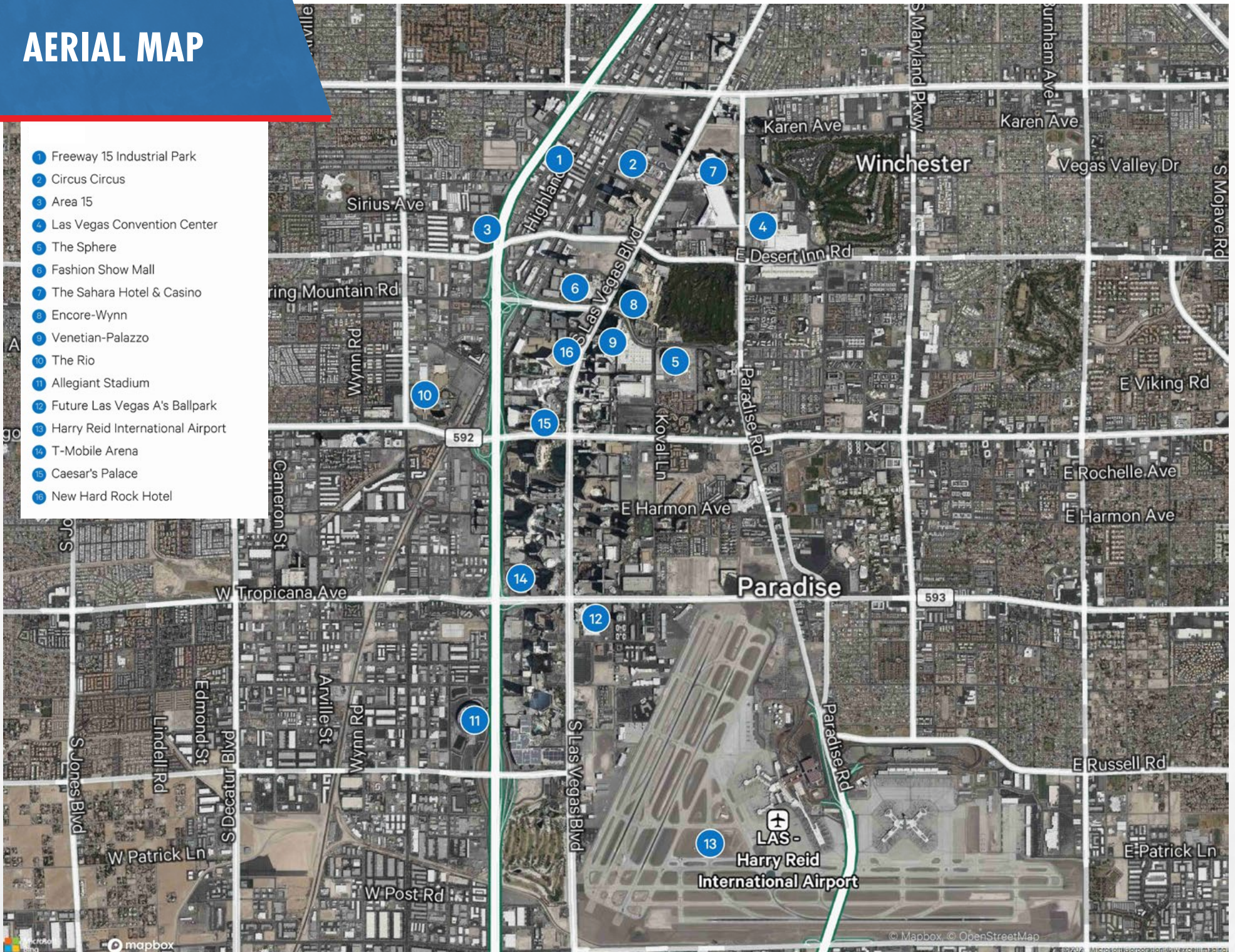

FREEWAY INDUSTRIAL PARK

2901 SOUTH HIGHLAND DRIVE, LAS VEGAS, NV 89109



CONTACT

MIKE WILLMORE
Senior Associate
(702) 369-4823
mike.willmore@cbre.com
Lic # S.0183520

ALEX STANISIC, SIOR
First Vice President
(702) 369-4874
alex.stanisic@cbre.com
Lic # S.0179950

LAUREN WILLMORE
Senior Associate
(702) 369-4825
lauren.willmore@cbre.com
Lic # S.0188698

KYLE KIRCHMEIER
Senior Associate
(702) 369-4862
kyle.kirchmeier@cbre.com
Lic # S.0197013

DEAN WILLMORE, SIOR
Executive Vice President
(702) 369-4808
dean.willmore@cbre.com
Lic # BS.0023886

© 2026 CBRE, Inc. All rights reserved. This information has been obtained from sources believed reliable, but has not been verified for accuracy or completeness. You should conduct a careful, independent investigation of the property and verify all information. Any reliance on this information is solely at your own risk. CBRE and the CBRE logo are service marks of CBRE, Inc. All other marks displayed on this document are the property of their respective owners. Photos herein are the property of their respective owners and use of these images without the express written consent of the owner is prohibited.