

# FOR SALE

130,000 SF | 41 ACRES



**CONTROLLED ENVIRONMENT  
MANUFACTURING WAREHOUSE**

428 POWER HOUSE RD,  
MONCK'S CORNER, SC 29461



# FACILITY SITE PLAN

								Employee parking	

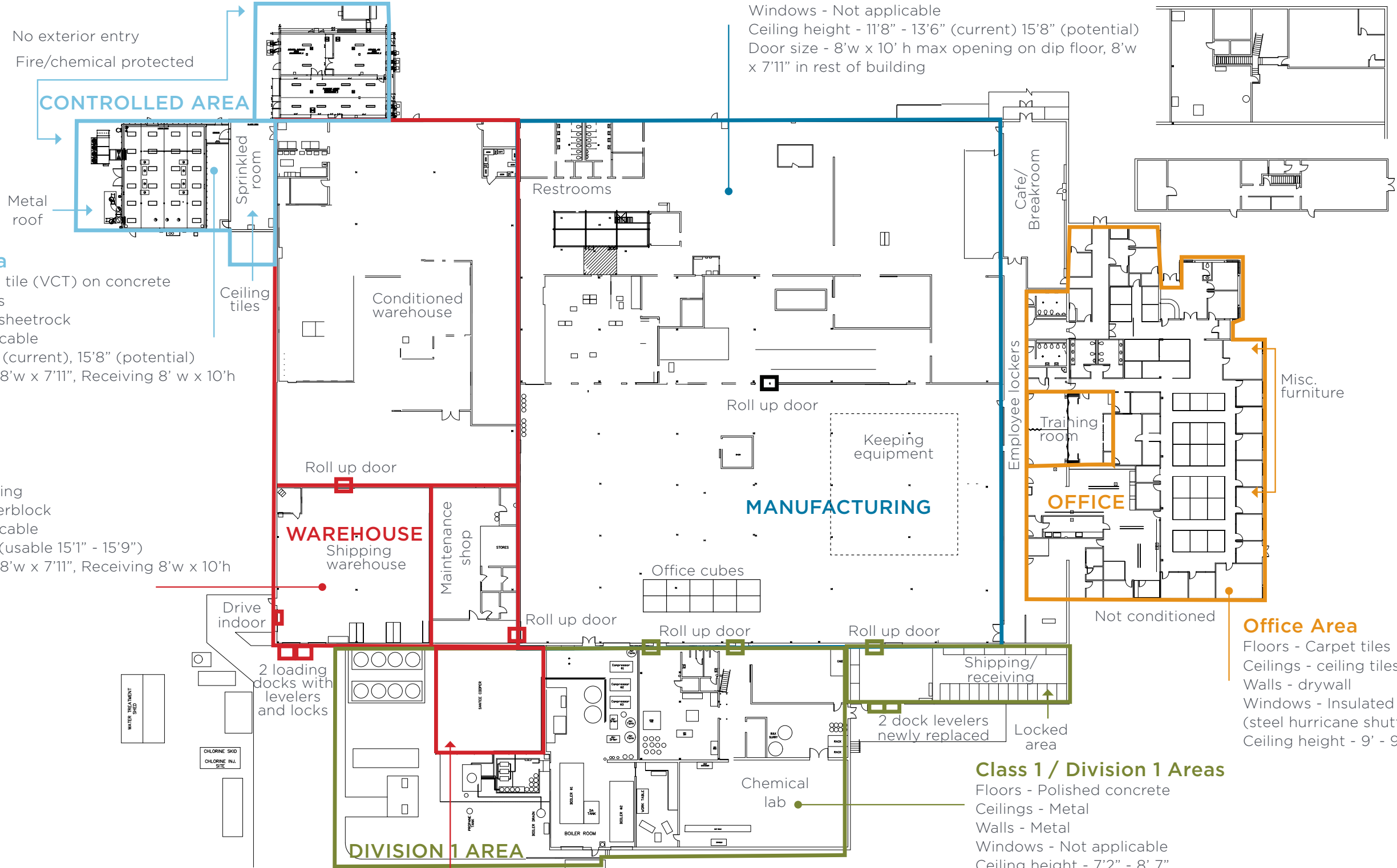

**Controlled Area**  
 Floors - Vinyl coated tile (VCT) on concrete  
 Ceilings - Ceiling tiles  
 Walls - Vinyl coated sheetrock  
 Windows - Not applicable  
 Ceiling height - 13'6" (current), 15'8" (potential)  
 Door size - shipping 8'w x 7'11", Receiving 8' w x 10'h

**Warehouse**  
 Floors - Concrete  
 Ceilings - Metal Roofing  
 Walls - Painted Cinderblock  
 Windows - Not applicable  
 Ceiling height - 18'1" (usable 15'1" - 15'9")  
 Door size - shipping 8'w x 7'11", Receiving 8'w x 10'h

**Manufacturing**  
 Floors - Concrete  
 Ceilings - Ceiling tiles  
 Walls - Painted cinderblock  
 Windows - Not applicable  
 Ceiling height - 11'8" - 13'6" (current) 15'8" (potential)  
 Door size - 8'w x 10' h max opening on dip floor, 8'w x 7'11" in rest of building

**Office Area**  
 Floors - Carpet tiles  
 Ceilings - ceiling tiles  
 Walls - drywall  
 Windows - Insulated thermopane (steel hurricane shutters)  
 Ceiling height - 9' - 9'8"

**Class 1 / Division 1 Areas**  
 Floors - Polished concrete  
 Ceilings - Metal  
 Walls - Metal  
 Windows - Not applicable  
 Ceiling height - 7'2" - 8' 7"  
 Door size - Max 94" x 94"

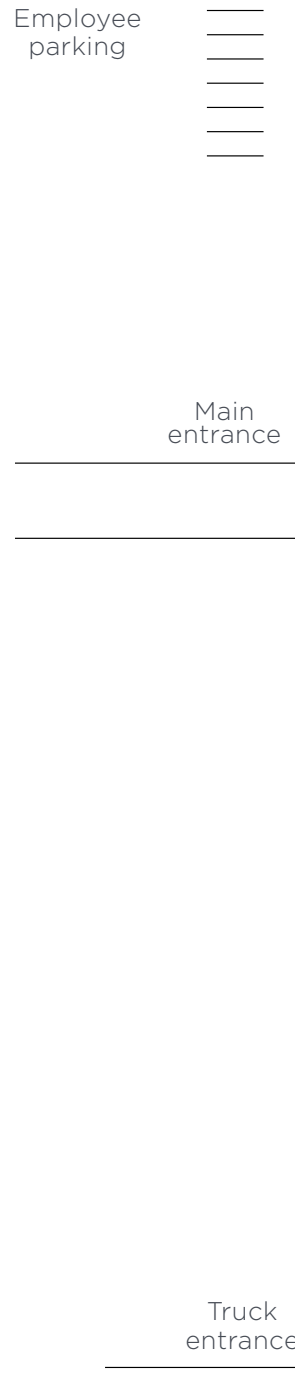

# FACILITY INFORMATION

PARCEL ID: 103-00-03-046  
OUTLYING BERKELEY COUNTY



## UTILITIES

### Air

Compressor capacity - 1,600 scfm  
90 psi oil-free dry air

### Water

Process and potable water - 105 MM gallons / year  
(groundwater withdrawal permit)

Fire sprinkler system - city water

2 - RO system

### Vaccum

None

### Fire Detection

Flow meters on fire risers send alarm signal

### Sprinklers

Wet pipe system in all areas

3 - chemical supression systems for Class 1 /Div 1 rooms

### Alcohol Chiller

50 tons

### Switch Gear Capacity

4000 W @ 460V 3 phase

### Power Availability to Site

2,500 kVa continuous  
Additional capacity can be added with notice

### Generator

2500 kW

### Boilers

2-16.7 MM Btu/hr propane boilers

### Propane

2 - 30,000 - gallon tanks (BD owned)

### Flooring

6-8" thick concrete

### Railings

Cable warning line 15' from edge | Guard rails where  
units are <6' from edge

### Roof

Cold applied modified bitumen system Installed 2018

# FACILITY PHOTOS

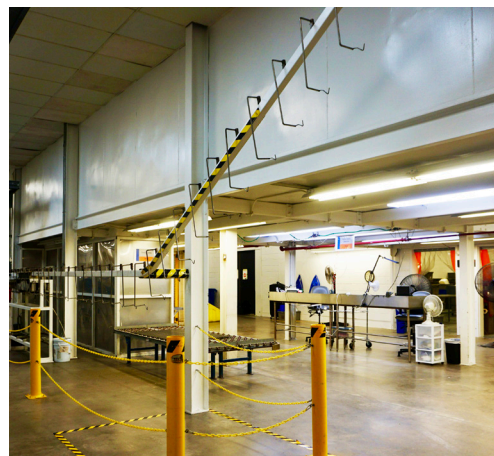
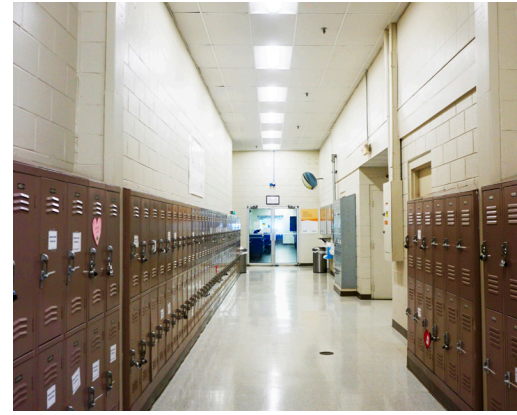

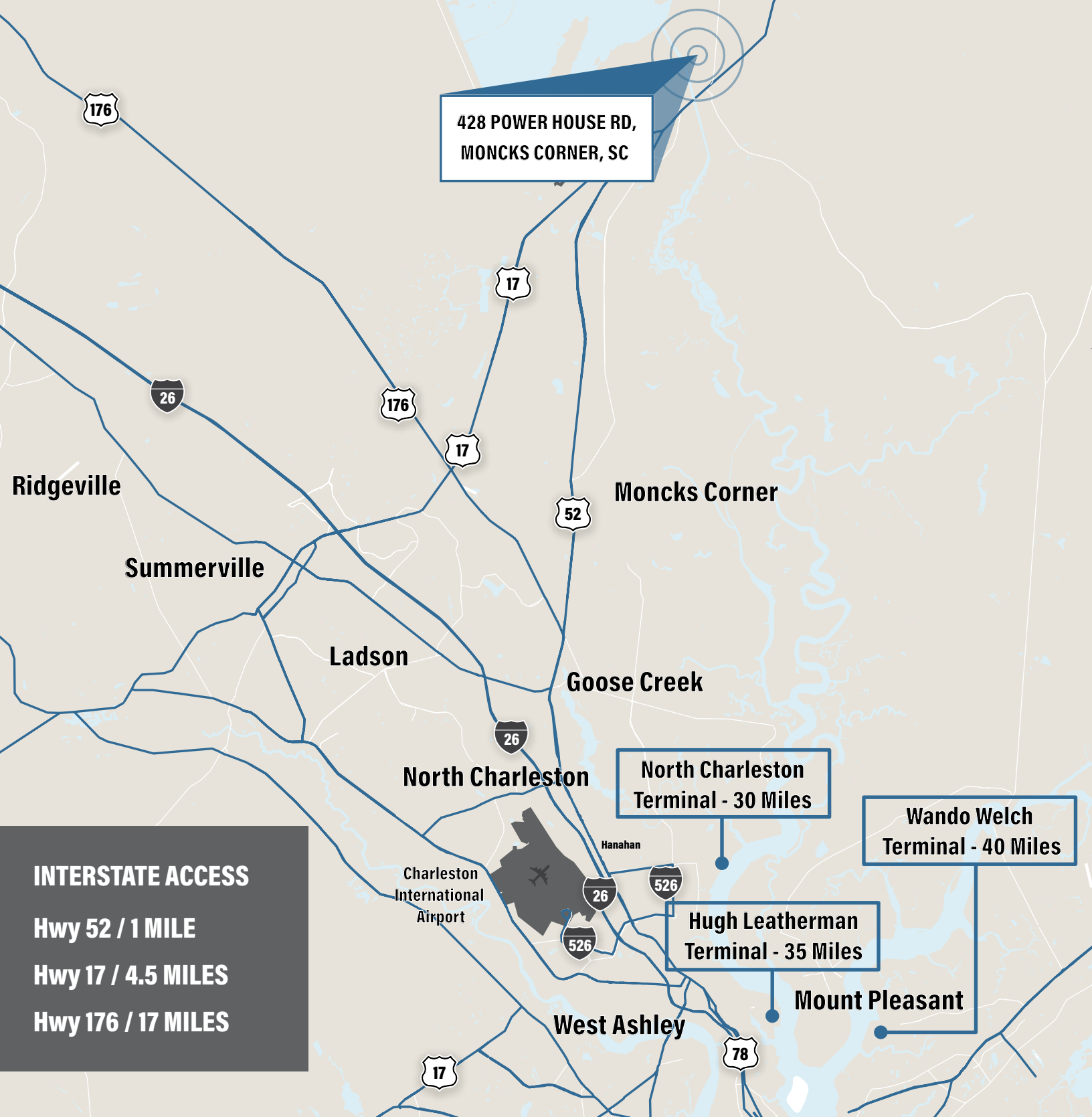

**428 POWER HOUSE RD,  
MONCKS CORNER, SC**

**North Charleston  
Terminal - 30 Miles**

**Wando Welch  
Terminal - 40 Miles**

**Hugh Leatherman  
Terminal - 35 Miles**

**INTERSTATE ACCESS**  
**Hwy 52 / 1 MILE**  
**Hwy 17 / 4.5 MILES**  
**Hwy 176 / 17 MILES**

Although information has been obtained from sources deemed reliable, JLL does not make any guarantees, warranties or representations, express or implied, as to the completeness or accuracy as to the information contained herein. Any projections, opinions, assumptions or estimates used are for example only. There may be differences between projected and actual results, and those differences may be material. JLL does not accept any liability for any loss or damage suffered by any party resulting from reliance on this information. If the recipient of this information has signed a confidentiality agreement with JLL regarding this matter, this information is subject to the terms of that agreement. ©2024 Jones Lang LaSalle Brokerage, Inc. All rights reserved.

**Lee Allen**  
843 805 5111  
lee.allen@jll.com

**Kevin Coats**  
843 805 5512  
kevin.coats@jll.com

**Tyler Smith**  
843 805 5118  
tyler.smith@jll.com

