

1700 CALIFORNIA

📍 SAN FRANCISCO, CA



±7,938 SF
FORMER
STEAKHOUSE

MATT SWEENEY

Executive Director
msweeney@theeconiccompany.com
(408) 863-1444 / LIC. 01746896

MEGAN MCARTHUR

Director
mmcarthur@theeconiccompany.com
(408) 863-1446 / LIC. 02089762



PROPERTY

HIGHLIGHTS



Former Steakhouse with Type I Hood



Prominent Corner Location on Van Ness (Hwy 101) and California



Shell Condition Dining Area



Across from Whole Foods and Near the New CPMC Medical Center



230 Seating Occupancy



Excellent Signage and Visibility Along Van Ness, with 45,500 Cars per Day

DEMOGRAPHICS



\$1,514,170

MEDIAN HOME VALUE



\$98,891

MEDIAN HH INCOME



38.6

MEDIAN AGE



82,491

HOUSEHOLDS

Source: 2024 Esri.

TRAFFIC COUNTS

Van Ness Ave	48,421 ADT
California St	39,000 ADT
Gough St	94,076 ADT



PROPERTY FLOOR PLAN

**FORMER
STEAKHOUSE
±7,938 SF**

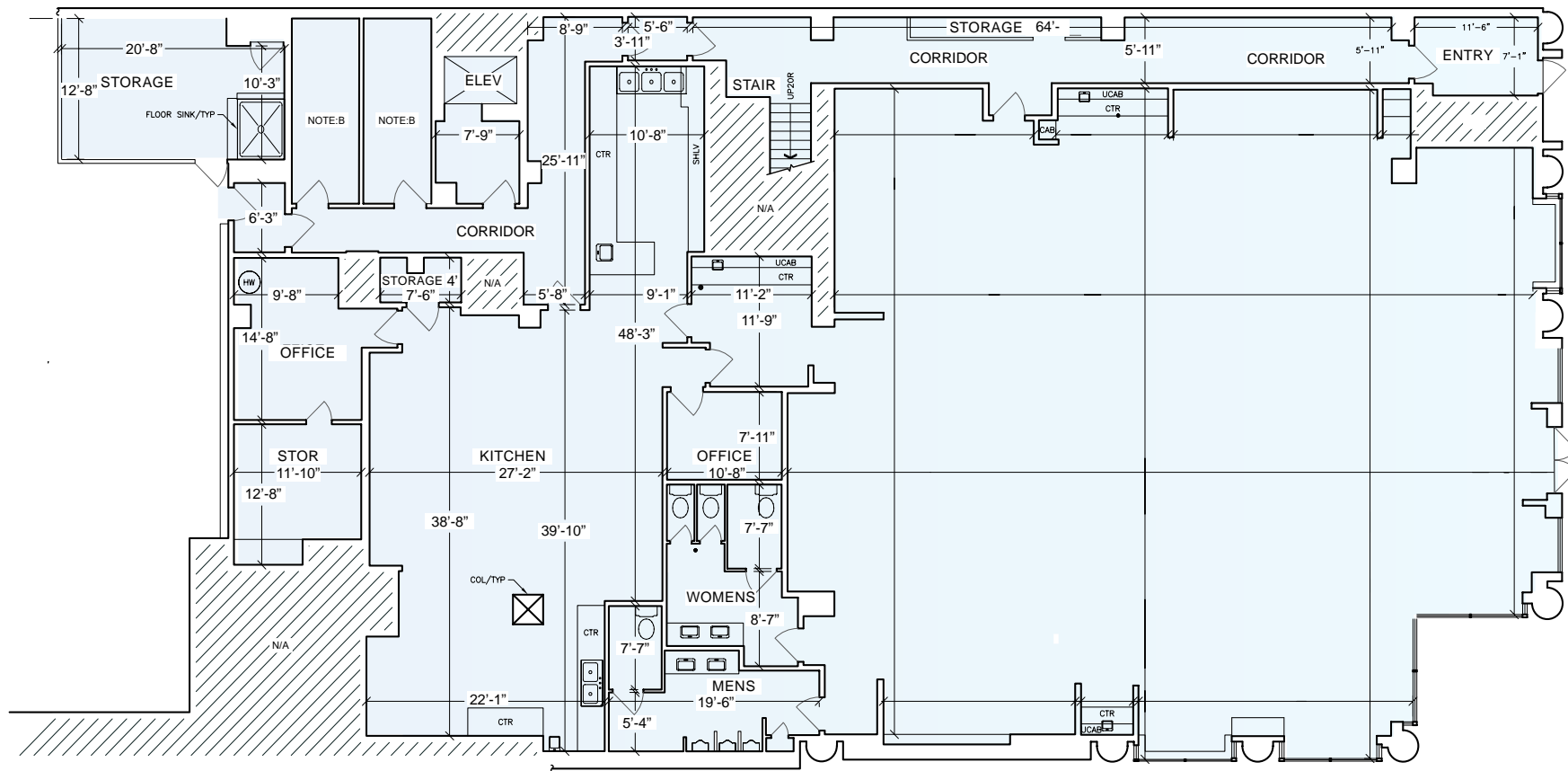

VAN NESS AVE: 48,421 ADT

CALIFORNIA ST: 39,000 ADT

GALLERY



NEARBY
AERIAL

MATT SWEENEY

msweeney@theeoniccompany.com
(408) 863-1444 / LIC. 01746896

MEGAN MCARTHUR

mmcarthur@theeoniccompany.com
(408) 863-1444 / LIC. 02089762

1700 CALIFORNIA

