

CERRITOS WEST INDUSTRIAL PARK

16331 CARMENITA ROAD, CERRITOS, CA

CBRE



±14,631 SF INDUSTRIAL BUILDING

FOR LEASE

Vacant and Available



High Image Business Park Environment



Monument Signage



±2,474 SF Office Space



1 Dock High Loading Door
1 Ground Level Loading Door



16-17' Warehouse Clearance



400 Amps/120-240 Volt Power



14 Parking Spaces



Fire Sprinklers



Convenient Access to the 5, 91, 605,
and 105 Freeways



Carmenita Road Exposure

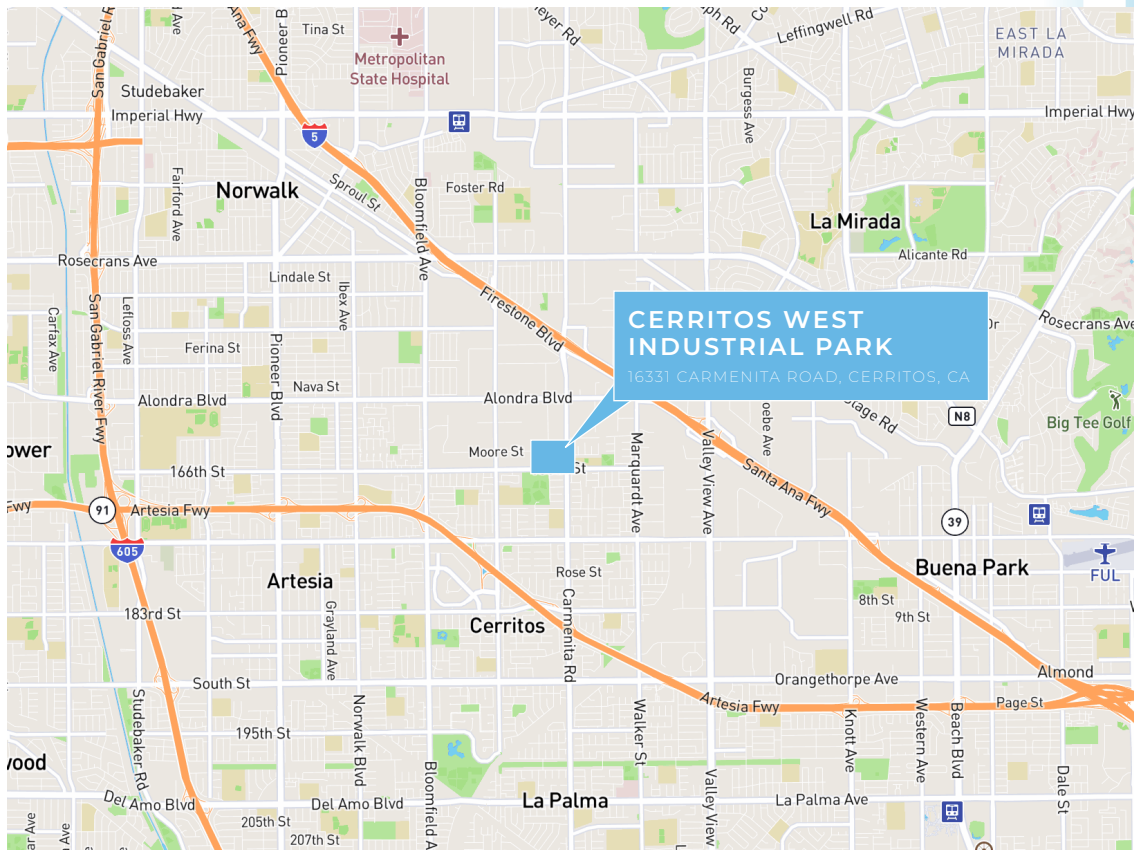

SITE PLAN

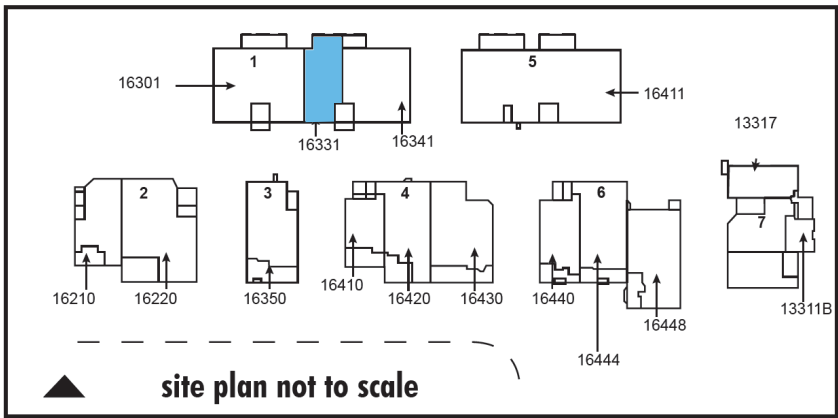

FLOOR PLAN

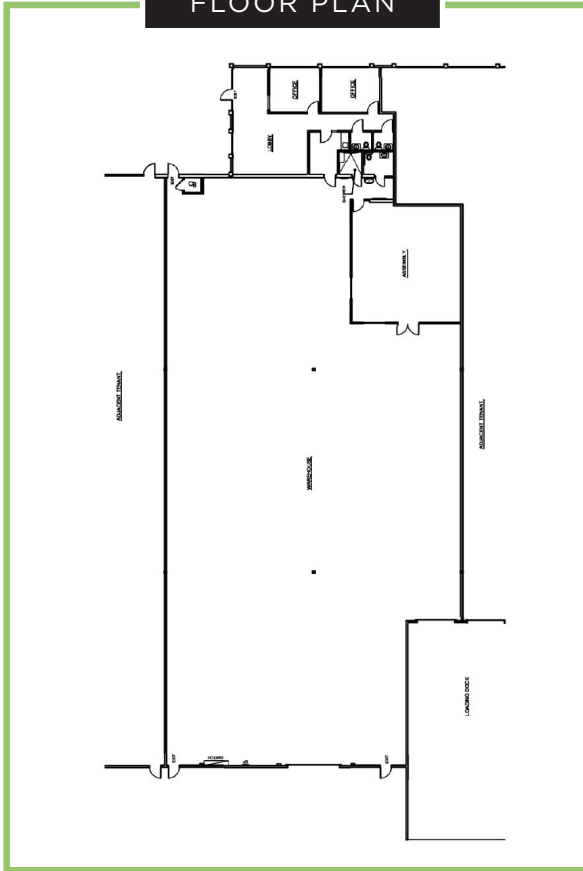

Contact Us

Laird A. Perkins
Senior Vice President
Lic. 00966207
+1 310 363 4920
laird.perkins@cbre.com

Josh Kracke
Associate
Lic. 02123022
+1 949 887 2190
joshua.kracke@cbre.com

Blake Wade
Associate
Lic. 02118407
+1 949 878 2933
blake.wade@cbre.com

