

1920-1938

CORNAGA AVENUE

NW CORNER OF CORNAGA AVENUE
& BEACH 19TH STREET
FAR ROCKAWAY



SPACE A

SPACE B

1920-1938

CORNAGA AVENUE

Space A: 10,989 SF Ground Floor
Space B: 3,454 SF Community Facility

Frontage: A: 159' wraparound
B: 52'

Ceiling Height: 11' 9"

Possession: Immediate

Transportation: 

Property Highlights:

- Retail and community facility spaces with efficient floor plates
- Situated at the base of two new construction, 255-unit residential buildings
- Neighboring tenants include:
VIM, Crown Fried Chicken, Frankel's Kosher Supermarket, Queen's Public Library, Heralife Nutrition Club, The Crate, Boost Mobile, Chase bank, Gino's Pizzeria, JD Sports, Sunny, La Palma



FLOOR PLAN:

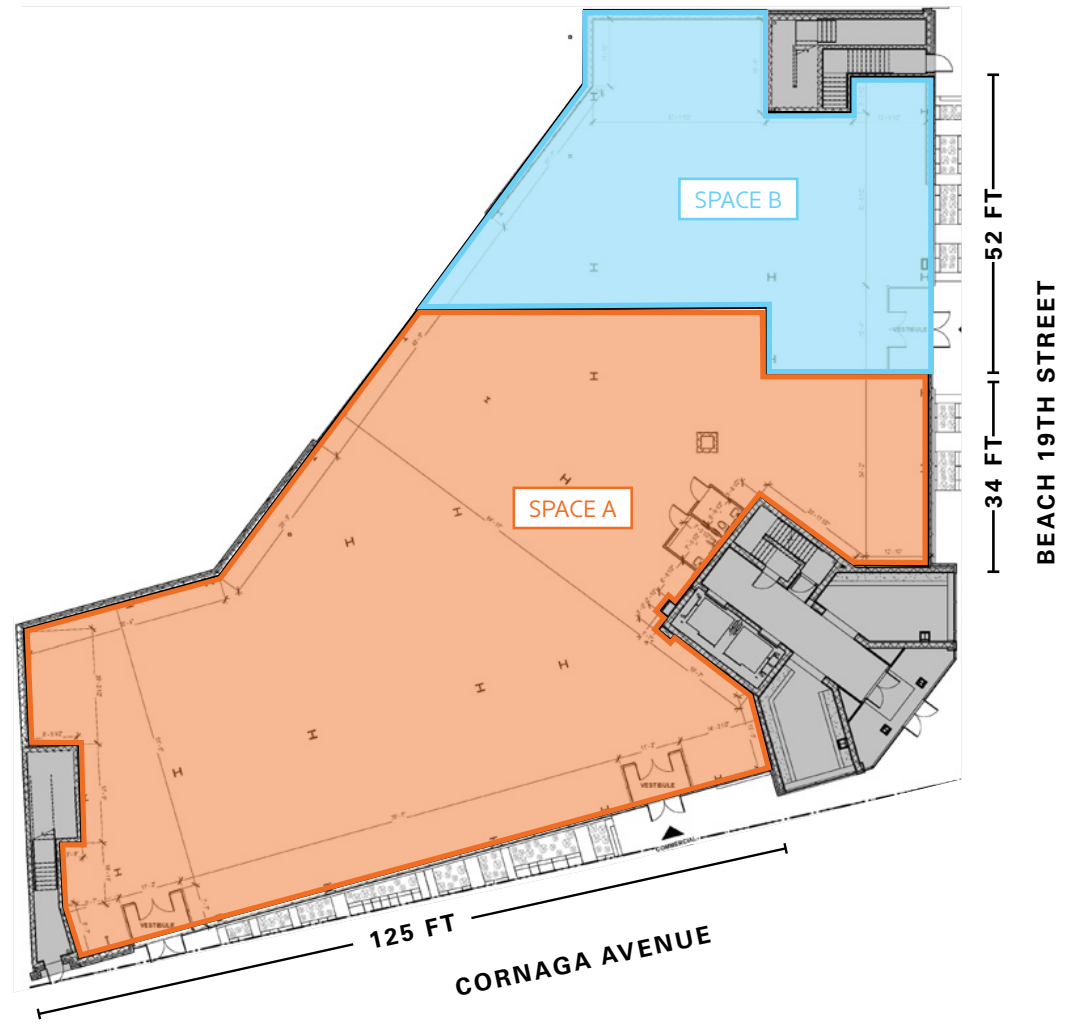

CONTACT OUR BROKERS FOR MORE INFORMATION:

Jack Hamadani
JHamadani@ksrny.com
718.415.0095

Freddy Souid
FSouid@ksrny.com
917.968.0329



All information supplied in this marketing presentation and/or flyer is from sources deemed reliable and is furnished subject to errors, omissions, modifications, removal of listings from sale/lease and to any listing condition. Any square footage, dimensions, floor plans and/or technical data set forth are approximations and are subject to further elaboration/confirmation.