

OFFICE SPACE FOR SUBLEASE

1200 CONCORD AVE, SUITE 290, CONCORD CA



PROPERTY HIGHLIGHTS

- 1200 Concord Ave, Suite 209, Concord, CA
- Size: ±8,432 SF
- Sublease Expires on 6/1/26
- Space is divisible to approx. ±1,800 SF
- Fully furnished space
- Access to common conference room and break room
- Available Immediately
- Asking Rate: \$2.00 SF Full Service

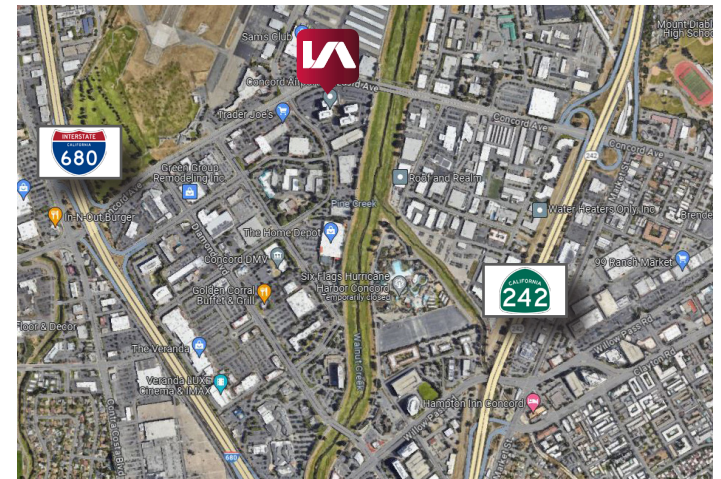

Chris Crabtree
ccrabtree@lee-associates.com
D 510.915.7645

Dan Moylan
dmoylan@lee-associates.com
D 925.239.1427

All information furnished regarding property for sale, rental or financing is from sources deemed reliable, but no warranty or representation is made to the accuracy thereof and same is submitted to errors, omissions, change of price, rental or other conditions prior to sale, lease or financing or withdrawal without notice. No liability of any kind is to be imposed on the broker herein.

OFFICE SPACE FOR SUBLEASE

1200 CONCORD AVE, SUITE 290, CONCORD CA



PROPERTY PHOTOS

Chris Crabtree
ccrabtree@lee-associates.com
D 510.915.7645

Dan Moylan
dmoylan@lee-associates.com
D 925.239.1427

All information furnished regarding property for sale, rental or financing is from sources deemed reliable, but no warranty or representation is made to the accuracy thereof and same is submitted to errors, omissions, change of price, rental or other conditions prior to sale, lease or financing or withdrawal without notice. No liability of any kind is to be imposed on the broker herein.

OFFICE SPACE FOR SUBLEASE

1200 CONCORD AVE, SUITE 290, CONCORD CA

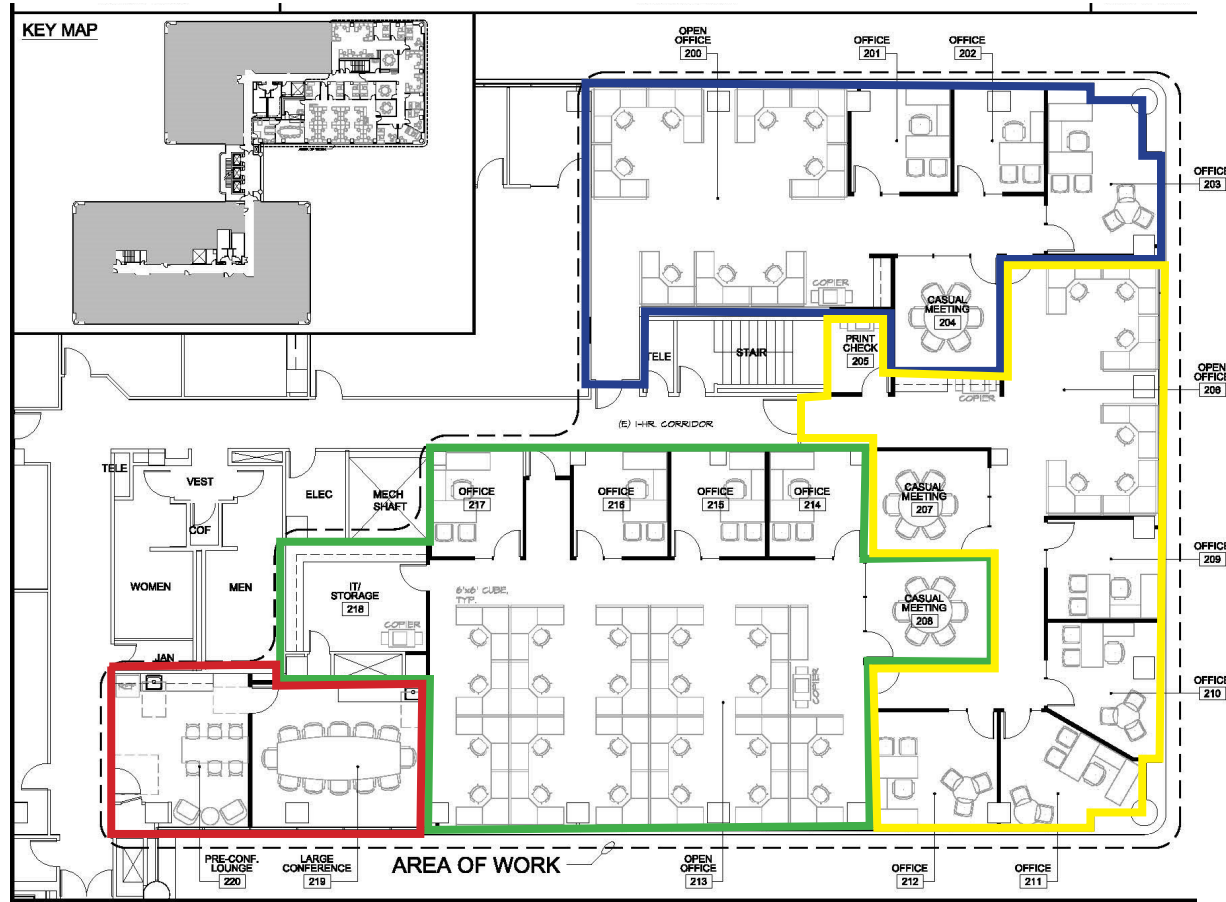

FLOOR PLAN

Chris Crabtree
ccrabtree@lee-associates.com
D 510.915.7645

Dan Moylan
dmoylan@lee-associates.com
D 925.239.1427

All information furnished regarding property for sale, rental or financing is from sources deemed reliable, but no warranty or representation is made to the accuracy thereof and same is submitted to errors, omissions, change of price, rental or other conditions prior to sale, lease or financing or withdrawal without notice. No liability of any kind is to be imposed on the broker herein.