

WOODLOCK CAPITAL

1056 BUSINESS PARK RD

SUMMERVILLE, SOUTH CAROLINA 29485

27,974 SQFT AVAILABLE / WAREHOUSE



**FOR LEASE**  
\$12.50/sf NNN and 27,974 sf available

# PROPERTY DETAILS

**ADDRESS:** 1056 Business Park Road, Summerville, SC

**TMS:** 207-00-01-126

**TOTAL BUILDING SIZE:** 56,875sf

**AVAILABLE SQUARE FOOTAGE:** 27,974sf

**CEILING HEIGHT:** 24' - 29'

**COLUMN SPACING:** 25' x 50'

**OFFICE:** 1,000sf - Two offices, kitchenette, two bathrooms

**DRIVE IN DOORS:** 5 (12'h x 14'w)

**ZONING:** Heavy Industrial (HI)

**COUNTY:** Berkeley County



# SITE PLAN

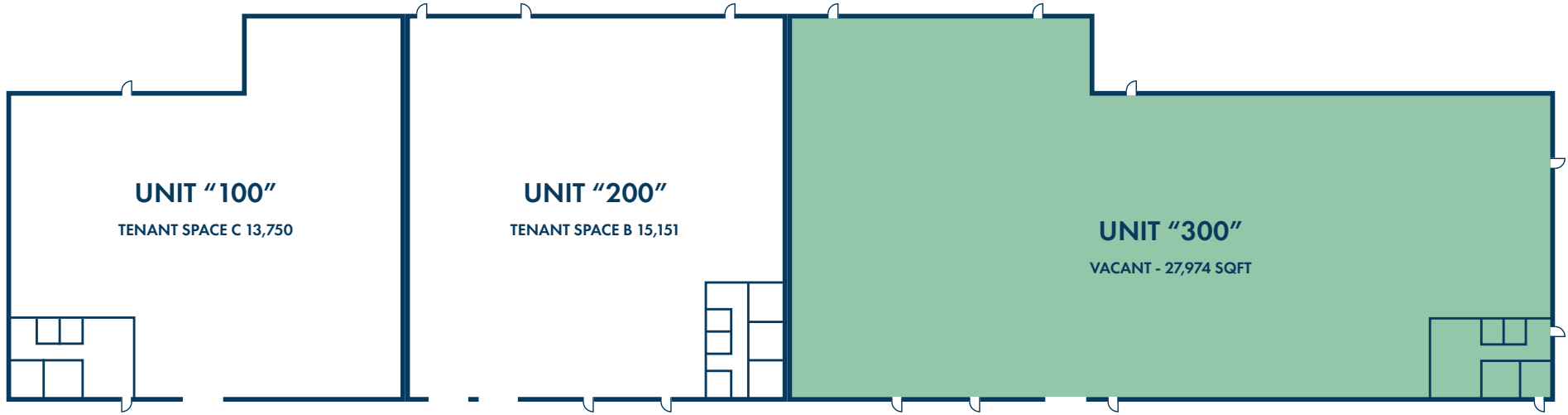

# OFFICE LAYOUT

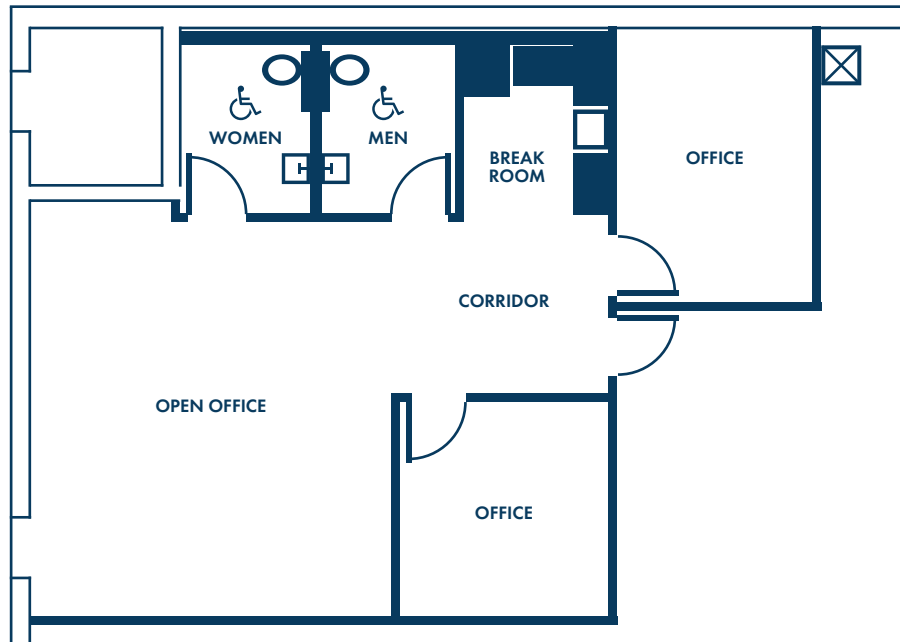

## REGIONAL ACCESS

### I-26 ON RAMP

<1 mile

### CHARLESTON INTERNATIONAL AIRPORT

20 miles

### SOUTH CAROLINA PORT AUTHORITY

32 miles

### MOUNT PLEASANT

3.31 miles

**SUBJECT PROPERTY**

**FRUIT OF THE LOOM**

**SOUTHEASTERN FREIGHT LINES**

**ROBERT BOSCH LLC**

**ZINUS, INC.**

**WOODLOCK**  
CAPITAL

MEGAN ANDERSON  
843-323-7634  
megan@woodlockcapital.com

RYLEY MCLELLAN  
828-989-9642  
ryley@woodlockcapital.com

OFFICE 843-906-1137  
2201 Mechanic Street, Suite C  
Charleston, SC 29405