

FOR SALE

0.92 Acre Walmart Outparcel



PROPERTY INFO

**6435 BELLS FERRY RD,
WOODSTOCK, GA 30189
STORE #5275**

- + Zoned: GC
- + Property benefits from access to the traffic signal.
- + Parcel benefits from affluent patrons on a 1-mile radius.
- + Woodstock is a desirable and coveted suburb of metro Atlanta.

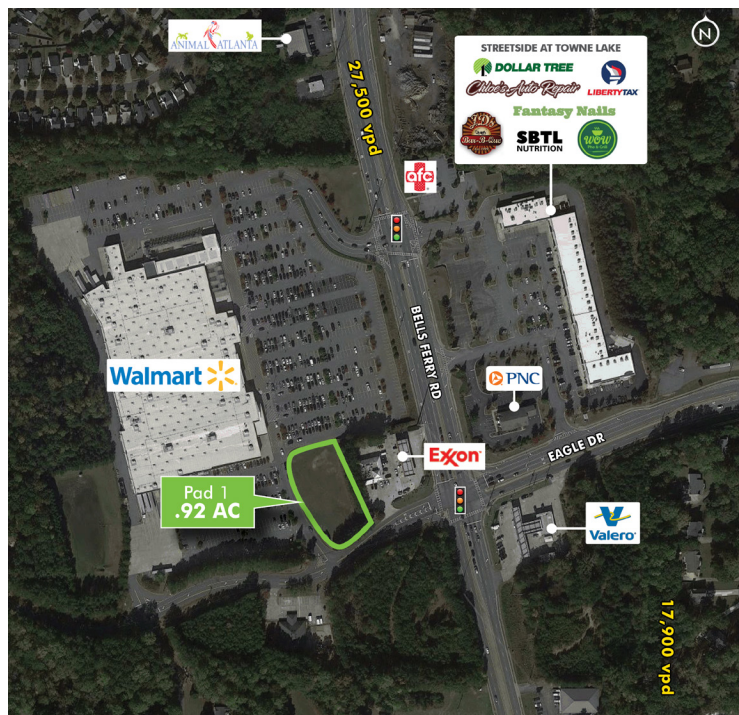

Total Population

5 Minutes	12,177
10 Minutes	82,026
15 Minutes	192,006

Source: Esri, 2020 Estimates

Number of Households

5 Minutes	4,064
10 Minutes	28,255
15 Minutes	68,967

Median HH Income

5 Minutes	\$79,105
10 Minutes	\$83,472
15 Minutes	\$77,800

CONTACT US

Daniel Duque

Associate
+1 404 812 5176
daniel.duque@cbre.com

CBRE, Inc.

3550 Lenox Road
Atlanta, GA 30326
+1 404 504 7900

Licensed Real Estate Broker

© 2024 CBRE, Inc. All rights reserved. This information has been obtained from sources believed reliable, but has not been verified for accuracy or completeness. You should conduct a careful, independent investigation of the property and verify all information. Any reliance on this information is solely at your own risk. CBRE and the CBRE logo are service marks of CBRE, Inc. All other marks displayed on this document are the property of their respective owners. Photos herein are the property of their respective owners. Use of these images without the express written consent of the owner is prohibited.

6435 BELLS FERRY RD
WOODSTOCK, GA 30189

www.cbre.us/walmart



FOR SALE

0.92 Acre Walmart Outparcel



RETAIL TRADE AREA

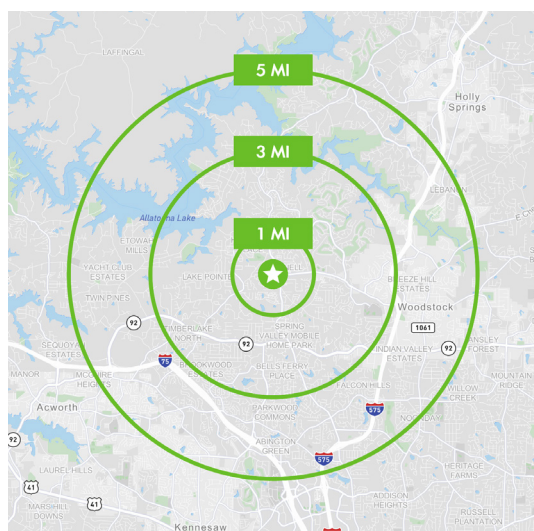
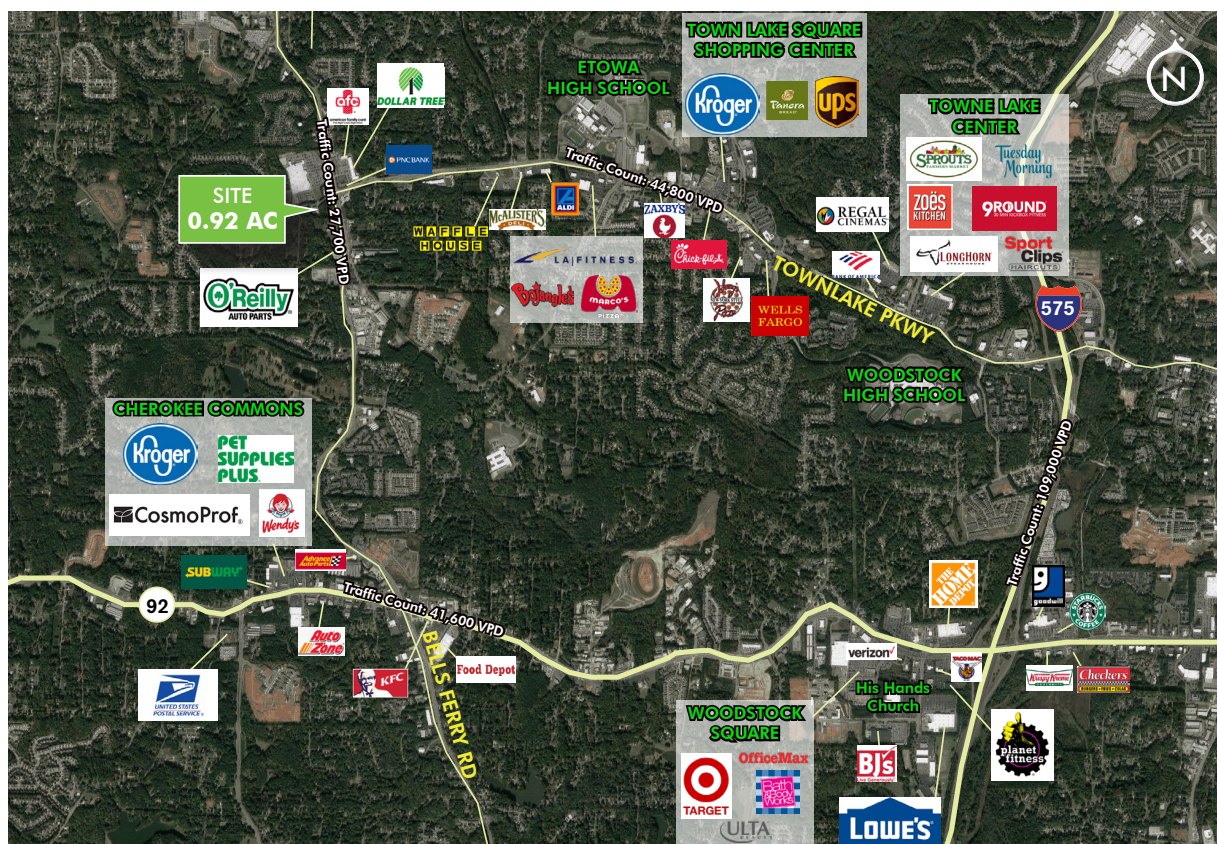

Demographics

	1 Mile	3 Miles	5 Miles
Total Population	8,980	62,044	146,577
Number of Households	2,837	21,389	51,491
Median HH Income	\$78,902	\$83,764	\$80,019

Source: Esri, 2020 Estimates

6435 BELLS FERRY RD
WOODSTOCK, GA 30189

www.cbre.us/walmart

