



293 BOSTON POST ROAD

MARLBOROUGH, MA



BUILDING & SYSTEM SPECS

293 BOSTON POST ROAD MARLBOROUGH, MA

FLOOR LOAD

100 lbs/sf

SLAB TO SLAB

13'8" (floor to joists: 11'10")

COLUMN SPACING

30'X30'

HVAC

2 CFM/sf

Power

26 watts/sf

GENERATORS

Shared with future 4th floor lab.
7.4 watts/sf on the 2nd floor

FIRE & SAFETY

Fully Sprinklered/Fire Alarm

PARKING

3.4/1,000 (612 Spaces)

FREIGHT ELEVATOR

8'W x 9'6"D x 8'H. 5,000lbs

UTILITIES

- Electricity: National Grid
- Water: Town of Marlborough
- Gas: Eversource
- Sewer: City of Marlborough

MOVE-IN READY LAB SPEC SUITES:

- Casework; (39) lab benches, each with upper shelf and hanging cabinet.
- (3) 6' fume hoods with the capacity to add (3) more 6' hoods, for a total of (6) 6' hoods.
- Dedicated 300amp, 480V service
- Under-sink chip tanks for chemical neutralization

NEW AMENITIES CENTER

- Renovated Lobby with 5-Story Atrium
- Conference Center
- Full-Service Cafeteria
- Fitness Center with Sauna
- Daycare
- Storage
- Accessible Roof Decks



293 BOSTON POST ROAD

MARLBOROUGH, MA

LAB SPEC SUITE | 2ND FLOOR | 5,994 RSF

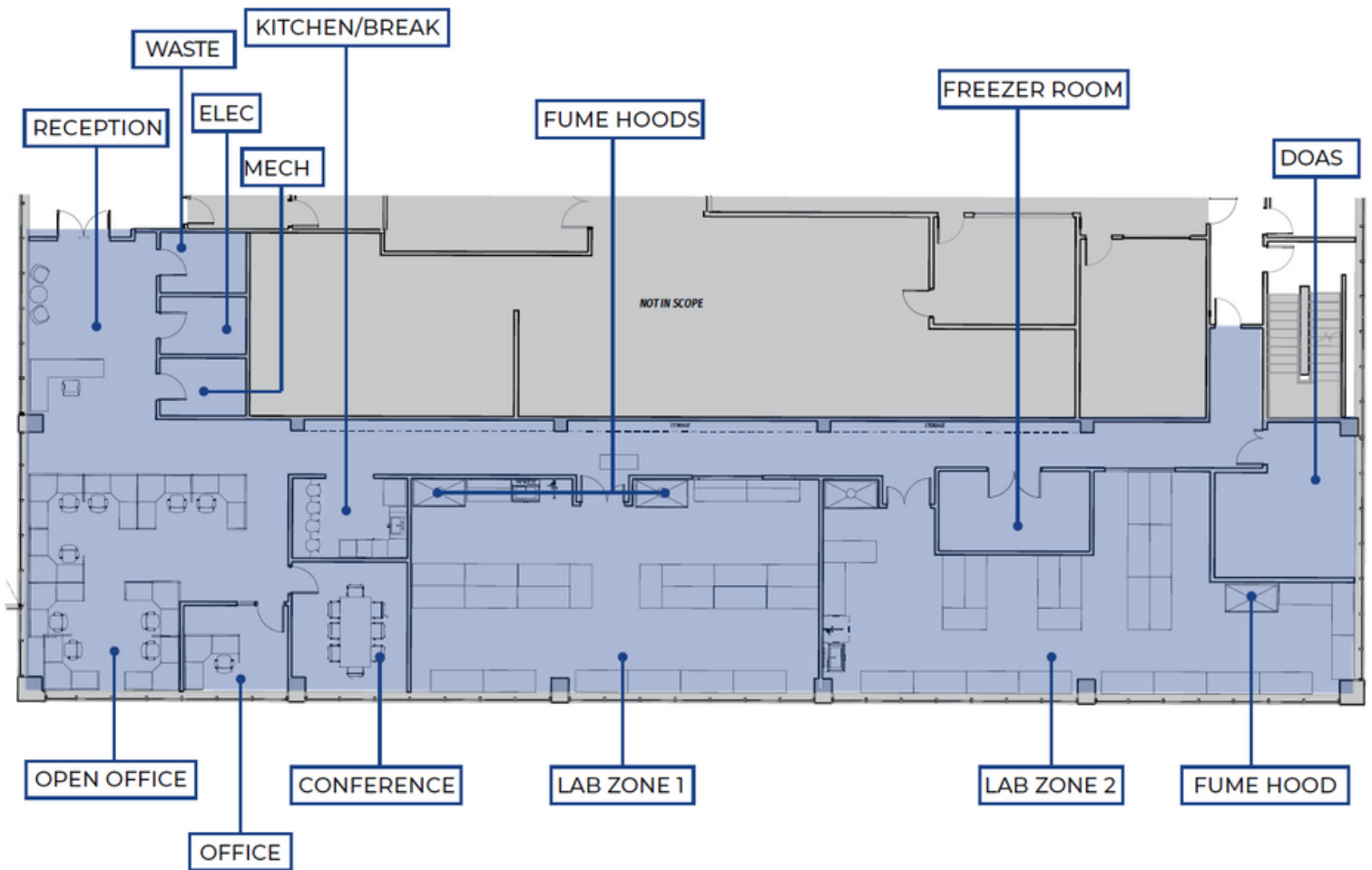

DANIEL CORDEAU
978.505.5134

dcordeau@kelleher-sadowsky.com

ANDREW SHERMAN
860.748.2822

sherman@kellehersadowsky.com

PHIL DeSIMONE
617.721.6466

desimone@kellehersadowsky.com



ROSS MINER
802.578.3673

miner@kelleher-sadowsky.com

MADISON O'BRIEN
508.320.7352

obrien@kelleher-sadowsky.com

METROWEST LIFE SCIENCE COMPANIES

293 BOSTON POST ROAD MARLBOROUGH, MA

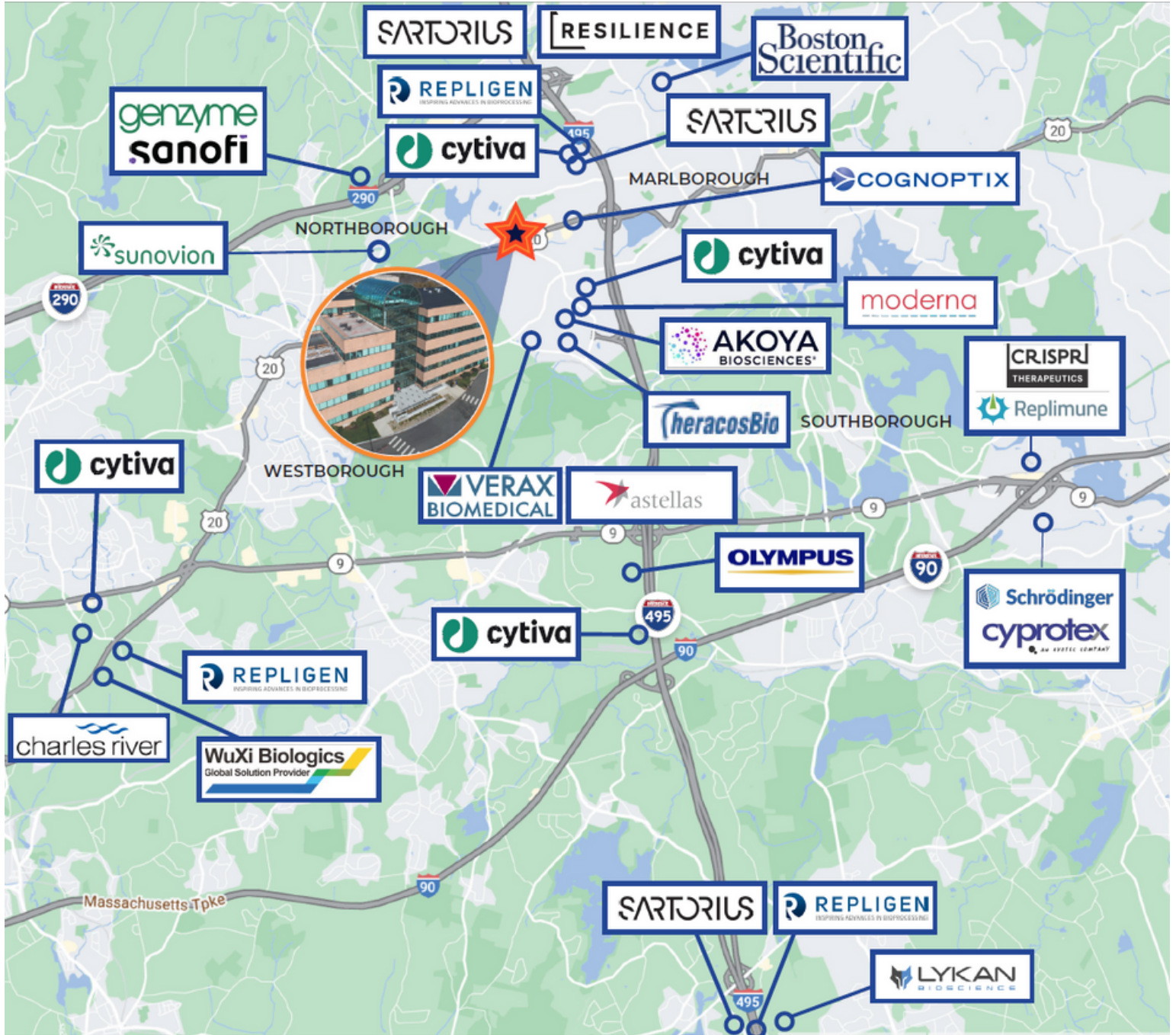

DANIEL CORDEAU
978.505.5134
dcordeau@kelleher-sadowsky.com

ANDREW SHERMAN
860.748.2822
sherman@kellehersadowsky.com

PHIL DeSIMONE
617.721.6466
desimone@kellehersadowsky.com



ROSS MINER
802.578.3673
miner@kelleher-sadowsky.com

MADISON O'BRIEN
508.320.7352
obrien@kelleher-sadowsky.com

LOCATION OVERVIEW

293 BOSTON POST ROAD MARLBOROUGH, MA

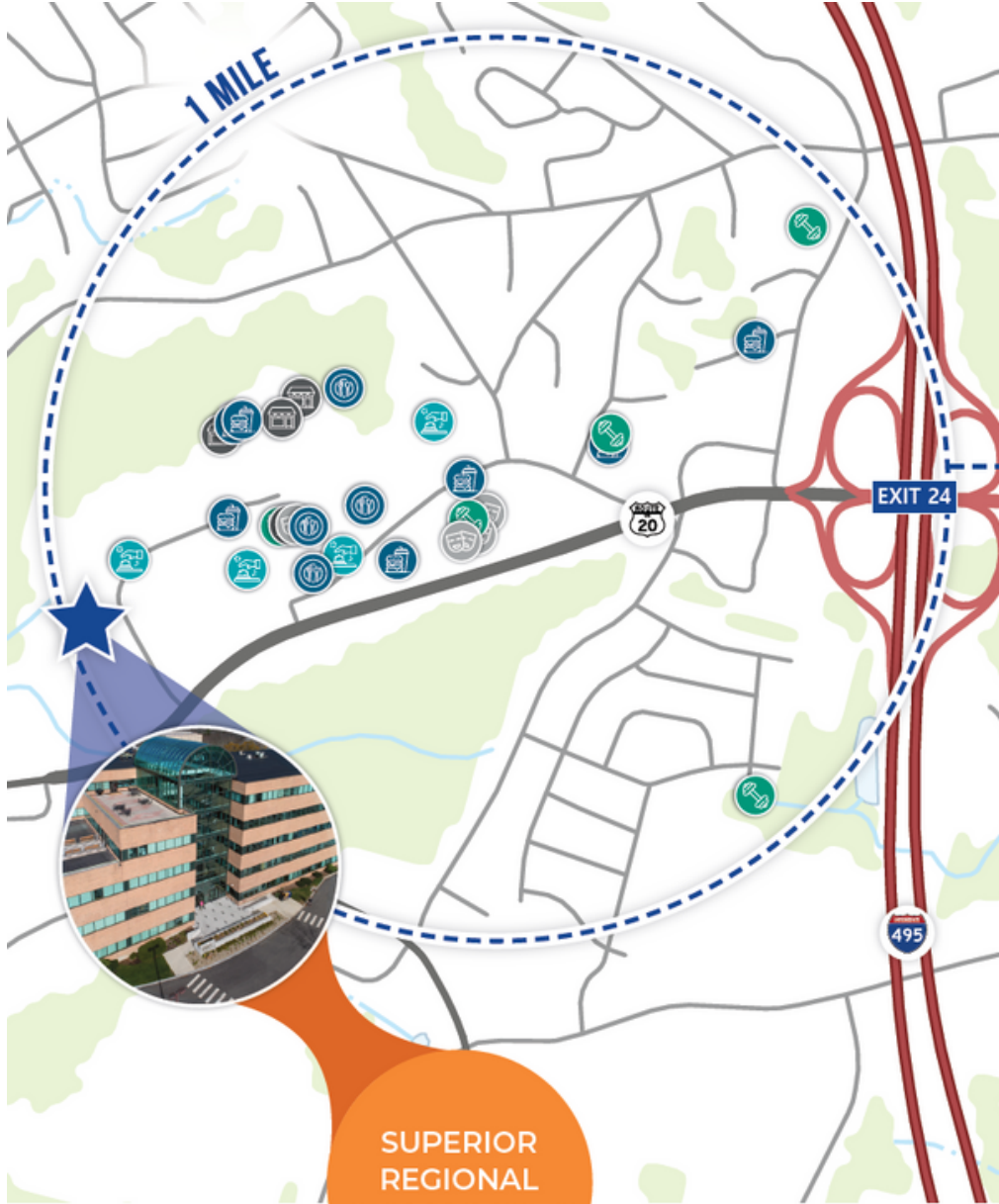

**SUPERIOR
REGIONAL
ACCESSIBILITY**

FOOD	
110 Grill	Ninety Nine RESTAURANT & PUB
JASON MILES USA	QDOBA
Tanera	PROTEINHOUSE
FIVE GUYS BURGERS AND FRIES	Friendly's
	Chick-fil-A
HOTEL	
Hampton	HYATT PLACE
EMERSON SUITES	FAIRFIELD INN & SUITES
	Marriott
FITNESS	
Fore Kicks	Orangetheory FITNESS
Planet Fitness	TITLE BOXING CLUB
CONVENIENCE	
Bank of America	OfficeMax
Citizens Bank	
ENTERTAINMENT	
PIT STOP	BREAKOUT
Westender	MUSE
APEX	HALFAX

DANIEL CORDEAU
978.505.5134
dcordeau@kelleher-sadowsky.com

ANDREW SHERMAN
860.748.2822
sherman@kellehersadowsky.com

PHIL DeSIMONE
617.721.6466
desimone@kellehersadowsky.com



ROSS MINER
802.578.3673
miner@kelleher-sadowsky.com

MADISON O'BRIEN
508.320.7352
obrien@kelleher-sadowsky.com

KSLABS

@293

AMENITY CENTER

