

15201 E Twelve Mile Rd

Roseville, MI

- 30,648 Square Feet on 1.8 Acres
- Great Building on 12 Mile Road
- 1.5 Miles to I-696
- Power Well Distributed
- Truckwell
- Fenced Parking Lot
- Quick Occupancy

INDUSTRIAL BUILDING FOR LEASE



27,548 SF of Factory



3,100 SF of Office



3 Grade Level Doors



Exterior Truckwell

FOR MORE INFORMATION:

Tom Jablonski
Senior Vice President
248.637.7794
tjablonski@LMCap.com

248.637.9700 | LMCap.com

Information contained herein was obtained from sources deemed to be reliable but is not guaranteed. Subjects to prior sales, changes of price or withdrawal.

BACK ON MARKET!

POSSIBLE SALE!



L. MASON CAPITANI
CORFAC INTERNATIONAL

15201 E Twelve Mile Rd

Roseville, MI



L. MASON CAPITANI

CORFAC INTERNATIONAL

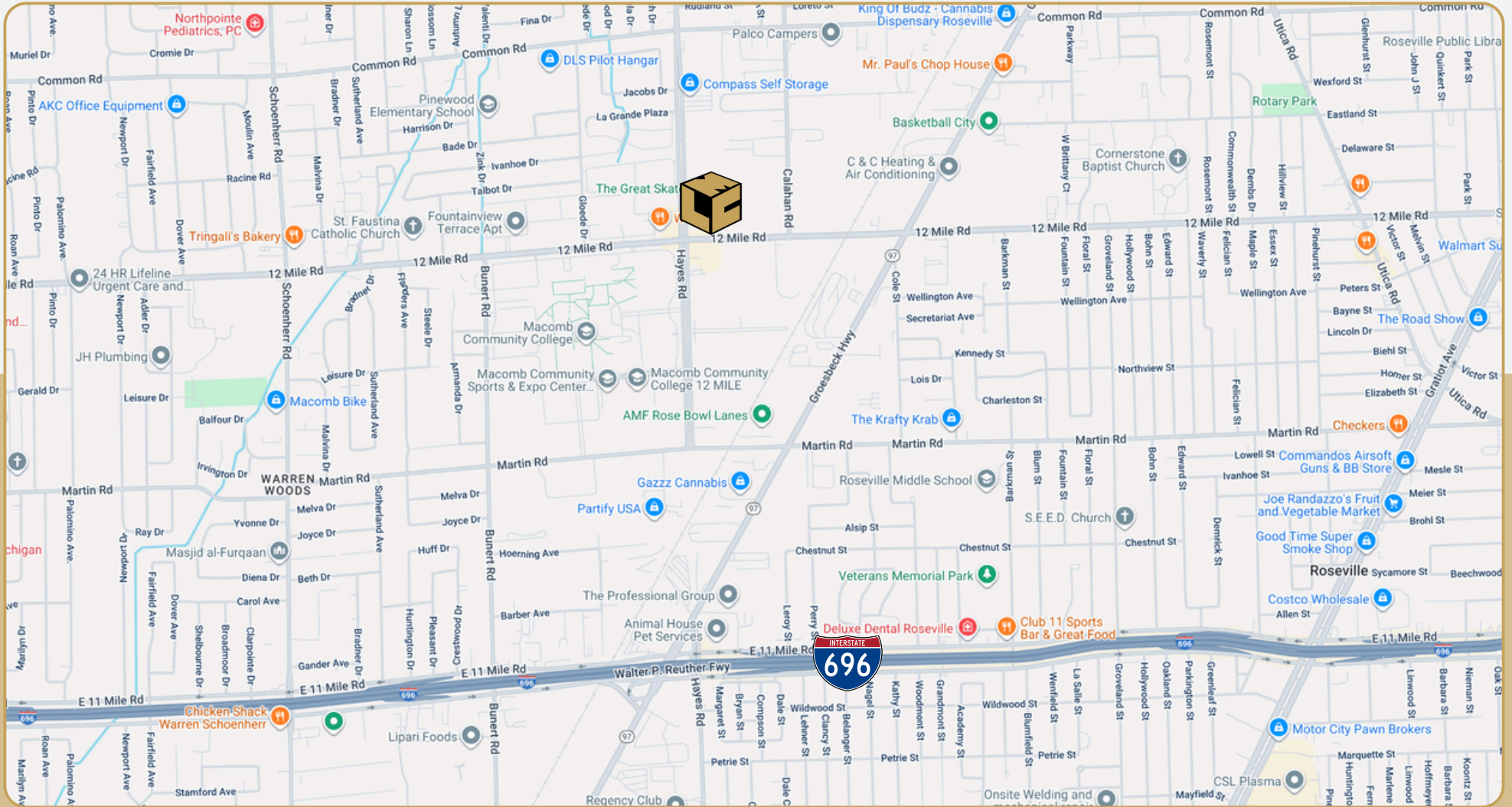

248.637.9700 | LMCap.com

Information contained herein was obtained from sources deemed to be reliable but is not guaranteed. Subjects to prior sales, changes of price or withdrawal.

15201 E Twelve Mile Rd

Roseville, MI



248.637.9700 | LMCap.com

Information contained herein was obtained from sources deemed to be reliable but is not guaranteed. Subjects to prior sales, changes of price or withdrawal.

15201 E Twelve Mile Rd

Roseville, MI



248.637.9700 | LMCap.com

Information contained herein was obtained from sources deemed to be reliable but is not guaranteed. Subjects to prior sales, changes of price or withdrawal.

15201 E Twelve Mile Rd

Roseville, MI



L. MASON CAPITANI
CORFAC INTERNATIONAL

Industrial Property Details:

Details:

Total SF:	30,648 SF
Available SF:	30,648 SF
Office SF:	3,100 SF
Factory SF:	27,548 SF
Zoning:	Industrial
Acres:	1.80
Frontage:	147'
Depth:	604'
Expandable:	No
Intersection:	12 Mile Rd/Hayes Rd
X-Way Distance:	1 Mile to I-696
Parking:	On-Site
Year Built:	1966
Year Renovated:	2015
Outside Storage:	No
Rail Siding:	No
Occupancy:	Immediate

Interior:

Ceiling Height:	14', 17'
Bay Size:	50'
Restrooms:	5
Power:	1,000-2,000 Amps
Lighting:	Fluorescent
Truckwells:	1 ext.
Grade Door:	3
Heating:	Tube Radiant
A/C:	Office Only
Sprinklered:	None
Air Lines:	Yes
Compressor:	No

Notes: Very clean usable space. Power well distributed. Easy access truckwell. Updated offices & shop. Main road frontage. One mile from I-696 Access. Possible sale!

Economic:

Sale Price:	Contact Broker
Lease/SF:	\$6.95
Lease/Month:	\$17,750.00
Lease Terms:	NNN
Taxes:	\$35,000.00

248.637.9700 | LMCap.com

Information contained herein was obtained from sources deemed to be reliable but is not guaranteed. Subjects to prior sales, changes of price or withdrawal.

15201 E Twelve Mile Rd

Roseville, MI



L. MASON CAPITANI

CORFAC INTERNATIONAL

Building Layout

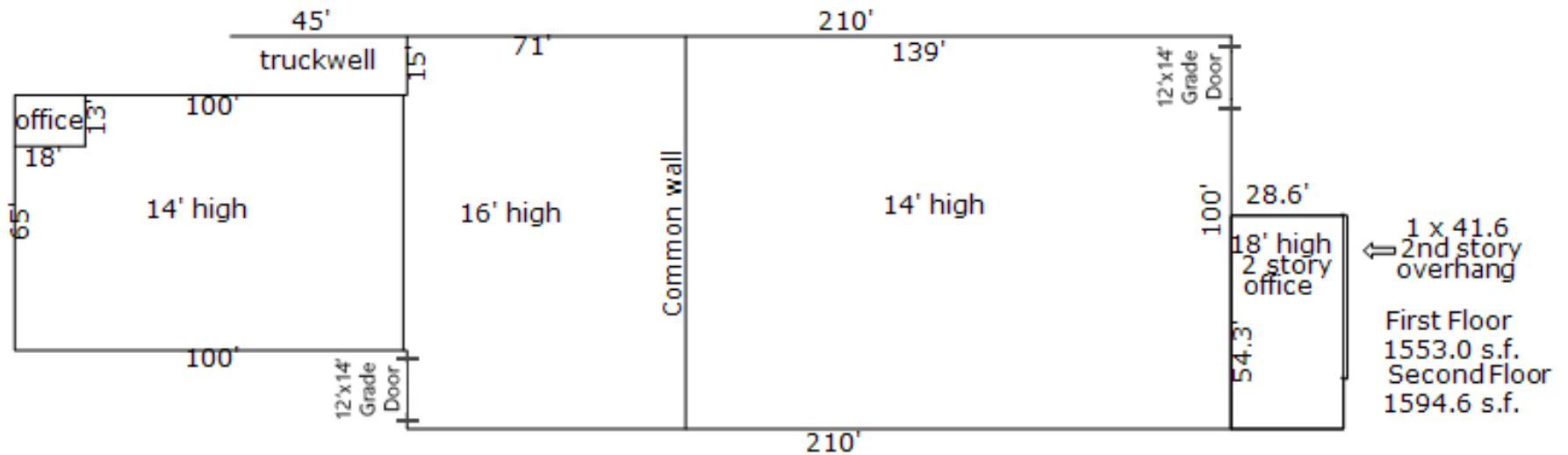

248.637.9700 | LMCap.com

Information contained herein was obtained from sources deemed to be reliable but is not guaranteed. Subjects to prior sales, changes of price or withdrawal.