



COMMERCIAL REAL ESTATE



Archer Building 209 E. Archer, Tulsa, OK

- The Tulsa Arts District of downtown Tulsa is Tulsa’s cultural center
- Home to Cain’s Ballroom, OKPOP, Woody Guthrie Museum, Bob Dylan Archive, ONEOK Field
- 40,000+ daytime population in CBD
- 2 million+ annual attendees to downtown events

PRICING

SPACES: 5,460 square feet

RENT: Call for details

NNN: Estimated at \$3.00/sf

TI: Negotiable

MILE RADIUS	1	3	5
POPULATION	8,284	75,301	162,826
HOUSEHOLDS	3,300	32,328	69,707
AVE. INCOME	\$61,798	\$65,041	\$64,702

NEIGHBORS



MORE INFORMATION

Bob Reppe

bob@reppepropertygroup.com

918-237-6903

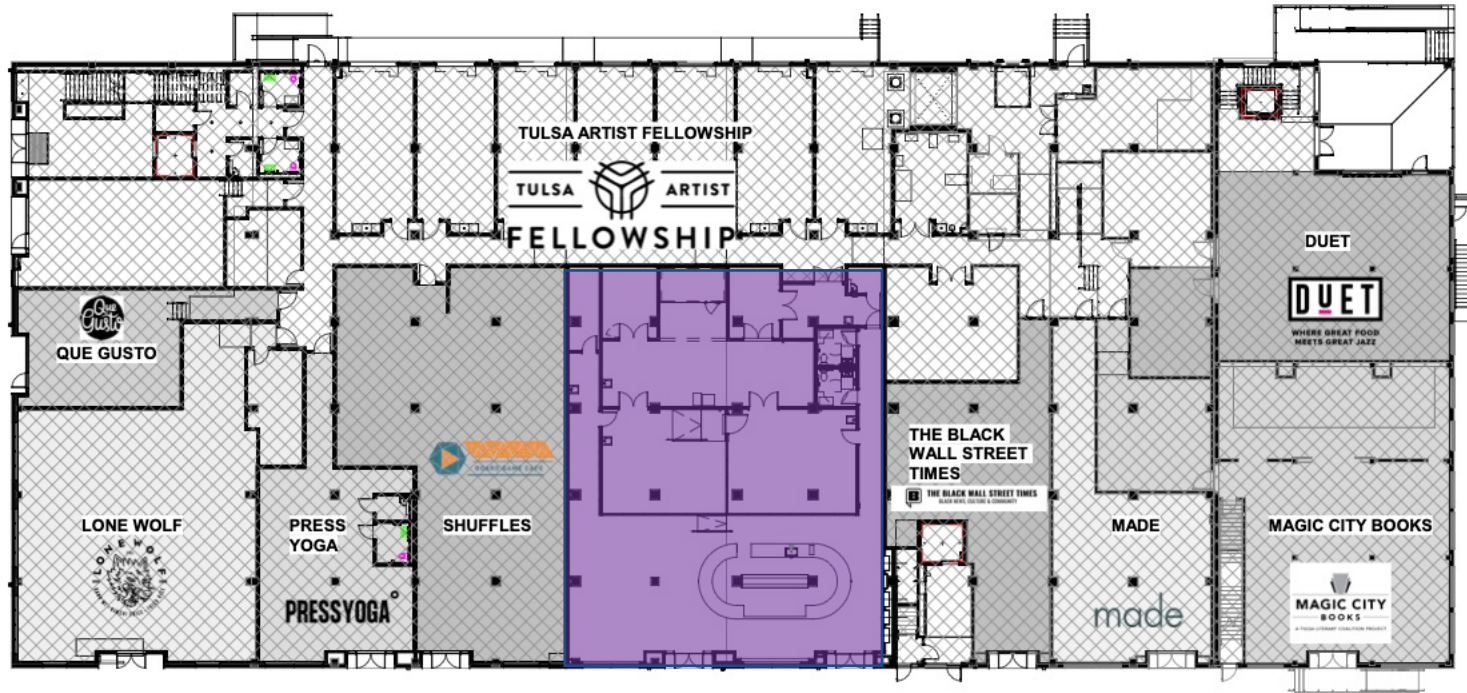

Office/Retail/Creative Space
5,460 SF

Archer Street

