

Industrial / Flex Space Available

1850 N GRAVERS ROAD, PLYMOUTH MEETING, PA



Property Highlights

Total Square Feet	76,028 SF
Available SF	+/- 9,000 SF
HVAC	RTU's to feed open space
Clear Height	16-foot clear on warehouse portion
Lighting	Warehouse lighting and office lighting
Loading	One drive-in door, 12x12
Parking	+/- 3/1,000 spaces
Zoning	Industrial Park District (IP)
New Roof	Single membrane, metal deck, steel structure roof
Electrical	4,000 amps



**Get more
information**

Dave Smith
Principal
M +1 609 314 4864
david.smith@avisonyoung.com

William Ciarlone
Associate
M +1 484 889 8491
william.ciarlone@avisonyoung.com



FLOOR PLANS

1st Floor

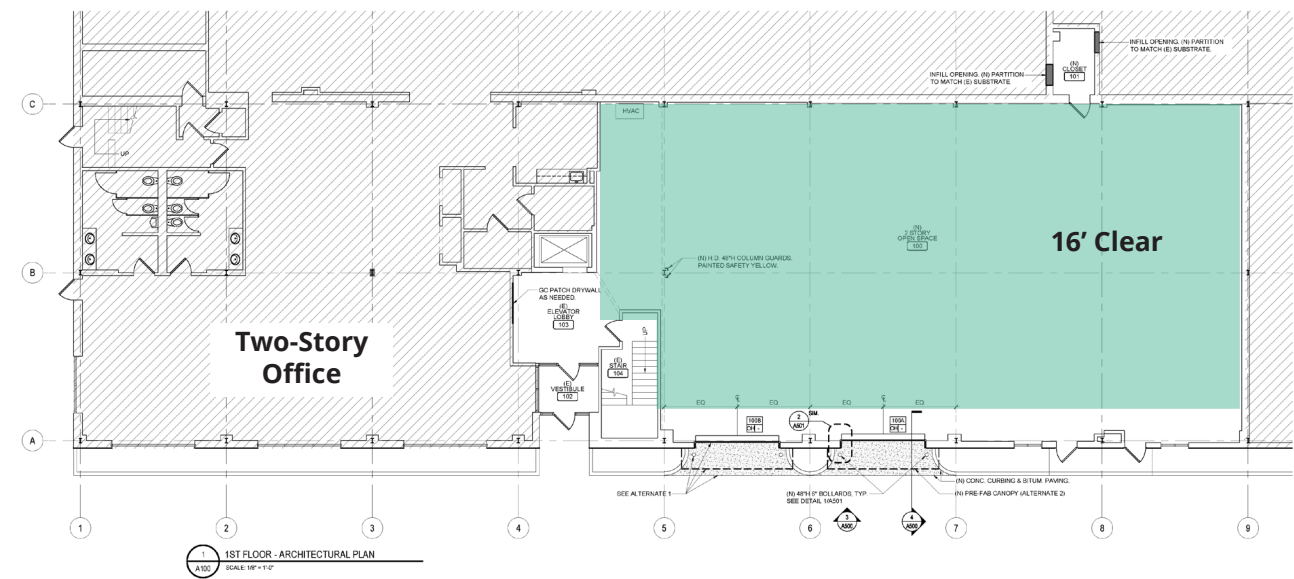

2nd Floor



Get more
information

Dave Smith
Principal
M +1 609 314 4864
david.smith@avisonyoung.com

William Ciarlone
Associate
M +1 484 889 8491
william.ciarlone@avisonyoung.com





Exterior Rendering



Interior Rendering



Interior Rendering



Interior Rendering

SITE AERIAL



**Get more
information**

Dave Smith
Principal
M +1 609 314 4864
david.smith@avisonyoung.com

William Ciarlone
Associate
M +1 484 889 8491
william.ciarlone@avisonyoung.com

