

**GOBLE  
PROPERTIES**

3301-3345

  
NEW DIMENSION ELECTRONICS  
PCB & CABLE ASSEMBLY



**3311 KELLER  
STREET  
SANTA CLARA, CA**

R&D/FLEX For Lease  
2,800 SF



**GOBLEPROPERTIES.COM**

**Contact Us**

**408-452-1754**

[contact@gobleproperties.com](mailto:contact@gobleproperties.com)

**3311 Keller Street  
2,800 SF**

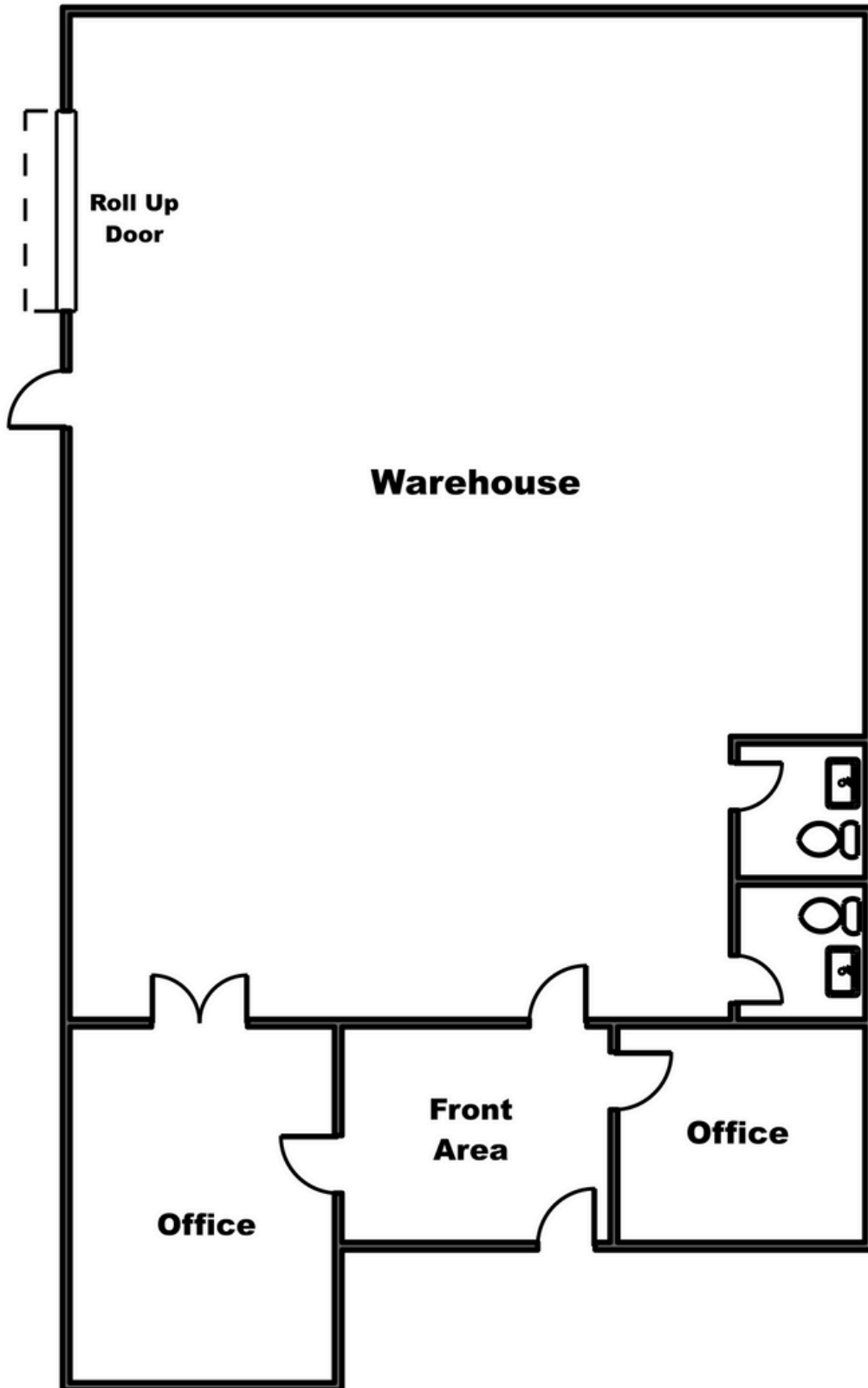

## Unit Highlights

- 2,800 sq. ft.
- 100 Amps
- Grade Level Roll Up Door
- 2 Restrooms
- Lobby + 2 Private Offices
- HVAC



---

## Contact Us

408-452-1754

[contact@gobleproperties.com](mailto:contact@gobleproperties.com)

