

FOR SALE

WILDOMAR PLANNED INDOOR SHOOTING RANGE

SEC BUNDY CANYON & MISSION TRAIL | WILDOMAR, CA



PROPERTY HIGHLIGHTS:

- ±2 acres located at the signalized corner of Mission Trail and Bundy Canyon Rd.
- Site would be the closest indoor range to ±650,000 residents.
[Click Here to view Demographics Report](#)
- Approved C.U.P. 19-0093 for ±34,000 SF Indoor Shooting Range, Academy and Tactical Range
- Includes: All previously submitted plans, reports and studies. (Contact Brokers for Specific Information)
- Potential Business Incentives offered by city of Wildomar

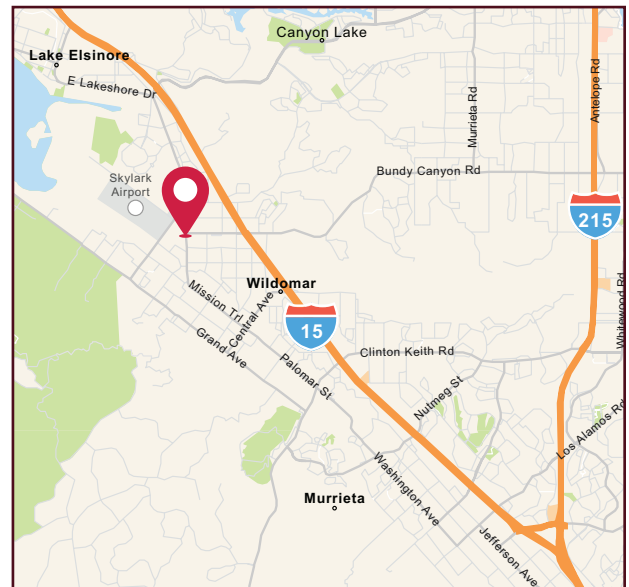

ASKING PRICE:
\$1,500,000.00

Gordon Mize

951.445.4504
gmize@leetemecula.com
DRE #01275376

Charley Black

951.445.4507
cblack@leetemecula.com
DRE #01000597

No warranty or representation has been made to the accuracy of the foregoing information. Terms of sale or lease and availability are subject to change or withdrawal without notice. Lee & Associates Commercial Real Estate Services, Inc. - Riverside. 25240 Hancock Avenue, Suite 100 - Murrieta, CA 92562 Corporate ID# 01048055

FOR SALE

WILDOMAR PLANNED INDOOR SHOOTING RANGE

SEC BUNDY CANYON & MISSION TRAIL | WILDOMAR, CA

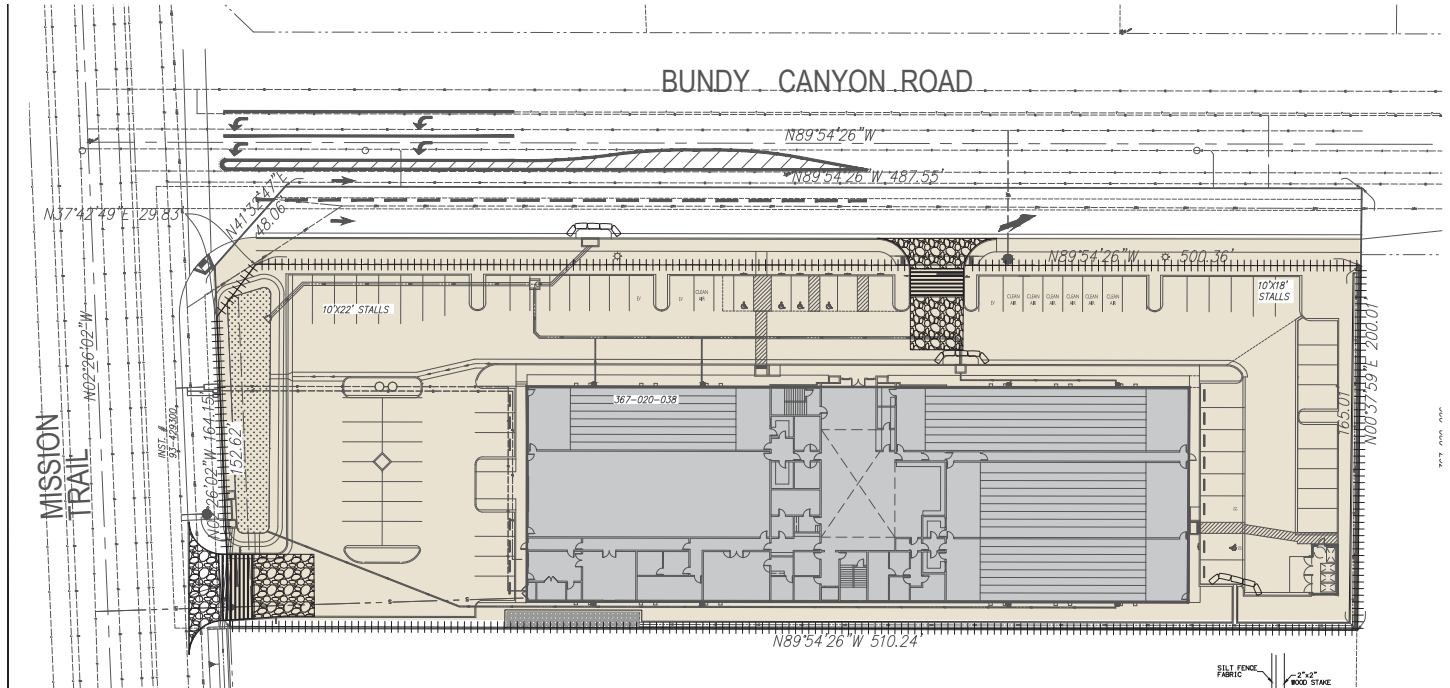

Gordon Mize
951.445.4504
gmize@leetemecula.com
DRE #01275376

Charley Black
951.445.4507
cblack@leetemecula.com
DRE #01000597

No warranty or representation has been made to the accuracy of the foregoing information. Terms of sale or lease and availability are subject to change or withdrawal without notice. Lee & Associates Commercial Real Estate Services, Inc. - Riverside. 25240 Hancock Avenue, Suite 100 - Murrieta, CA 92562 Corporate ID# 01048055

FOR SALE

WILDOMAR PLANNED INDOOR SHOOTING RANGE

SEC BUNDY CANYON & MISSION TRAIL | WILDOMAR, CA



COMPETITION STUDY: CLOSET INDOOR SHOOTING RANGES



SUBJECT SITE:
CORNER OF BUNDY CYN
AND MISSION TRAIL
WILDOMAR

- 1. Beaumont Indoor Shooting Range:**
877 W. 4th St., Beaumont
- 2. Riverside Magnum Range:**
12391 Sampson, Riverside
- 3. Riverside Indoor Range:**
11631 Sterling Ave., Riverside
- 4. North County Shooting Center:**
1440 Descanso Rd., San Marcos
- 5. Iron Sights Shooting Range:**
618 Airport Road, Oceanside

Gordon Mize
951.445.4504
gmize@leetemecula.com
DRE #01275376

Charley Black
951.445.4507
cblack@leetemecula.com
DRE #01000597

No warranty or representation has been made to the accuracy of the foregoing information. Terms of sale or lease and availability are subject to change or withdrawal without notice. Lee & Associates Commercial Real Estate Services, Inc. - Riverside. 25240 Hancock Avenue, Suite 100 - Murrieta, CA 92562 Corporate ID# 01048055