



**LEE & ASSOCIATES**  
COMMERCIAL REAL ESTATE SERVICES

**Randall Bentley, SIOR, CCIM**  
President/Managing Principal  
rbentley@lee-associates.com

**Kevin Bentley, SIOR**  
EVP/Principal  
kbentley@lee-associates.com

**Micah Williams**  
Senior Associate  
mwilliams@lee-associates.com

**Justin Bentley**  
Associate  
jbentley@lee-associates.com

**864.704.1040**  
LeeGreenville.com

## **±150,004 RSF (DIVISIBLE) INDUSTRIAL SPACE FOR LEASE**

300 South Main Street  
Mauldin, SC 29662

**Lease Rate:**  
**\$5.75 / NNN**

**LAYDOWN YARD  
AVAILABLE:  
CLICK TO VIEW**

- Heavy Power Available
- Over ±100M People within a one day drive
- One turn to Interstate Access
- Office Space Available
- Minimum Divisible: 15,940 SF



**MAJOR INTERSTATE  
ACCESS**

±1.5 MILES TO I-385  
±4.0 MILES TO I-85



**CLEAR HEIGHT**  
15' -30'



**DOCKS & DRIVE-INS**  
6 DOCKS AND 1  
DRIVE-IN



**ZONING**  
I-1



# PROPERTY OVERVIEW

PROPERTY NAME	300 S Main Street
TYPE	Industrial
TOTAL AVAILABLE SF	±150,004 RSF (DIVISIBLE)
TOTAL BUILDING SF	±344,004 SF
TAX MAP #	M004010101700
COUNTY	Greenville
CITY LIMITS	No
ZONING	I-1
CONSTRUCTION TYPE	Masonry
ROOF	TPO
WAREHOUSE SF	±103,790 SF
OFFICE SF	TBD
CEILING HEIGHT	15' - 30'
DOCK DOORS	Six (6) Docks
DRIVE-IN DOORS	One (1) Drive-in
LIGHTING	LED (To be installed)
SPRINKLERS	Wet Sprinklers
PARKING	On-Site
UTILITIES	Power, Water, Natural Gas
POWER	480V 3 Phase / 3,000 Amp





# LOCATION OVERVIEW



<b>POPULATION</b>	<b>5 MIN</b>	<b>10 MIN</b>	<b>15 MIN</b>
2021 Households	9,071	18,760	153,277
2026 Household Projection	9,675	20,105	164,068
Annual Growth 2010-2021	1.5%	2.0%	1.5%
<b>HOUSEHOLDS</b>	<b>5 MIN</b>	<b>10 MIN</b>	<b>15 MIN</b>
2021 Households	9,071	18,760	153,277
2026 Household Projection	9,675	20,105	164,068
Annual Growth 2010-2021	1.5%	2.0%	1.5%
Average Household Income	\$85,176	\$91,567	\$93,733
Median Household Income	\$69,062	\$74,440	\$68,741



# RAIL ACCESS



# FLOOR PLAN

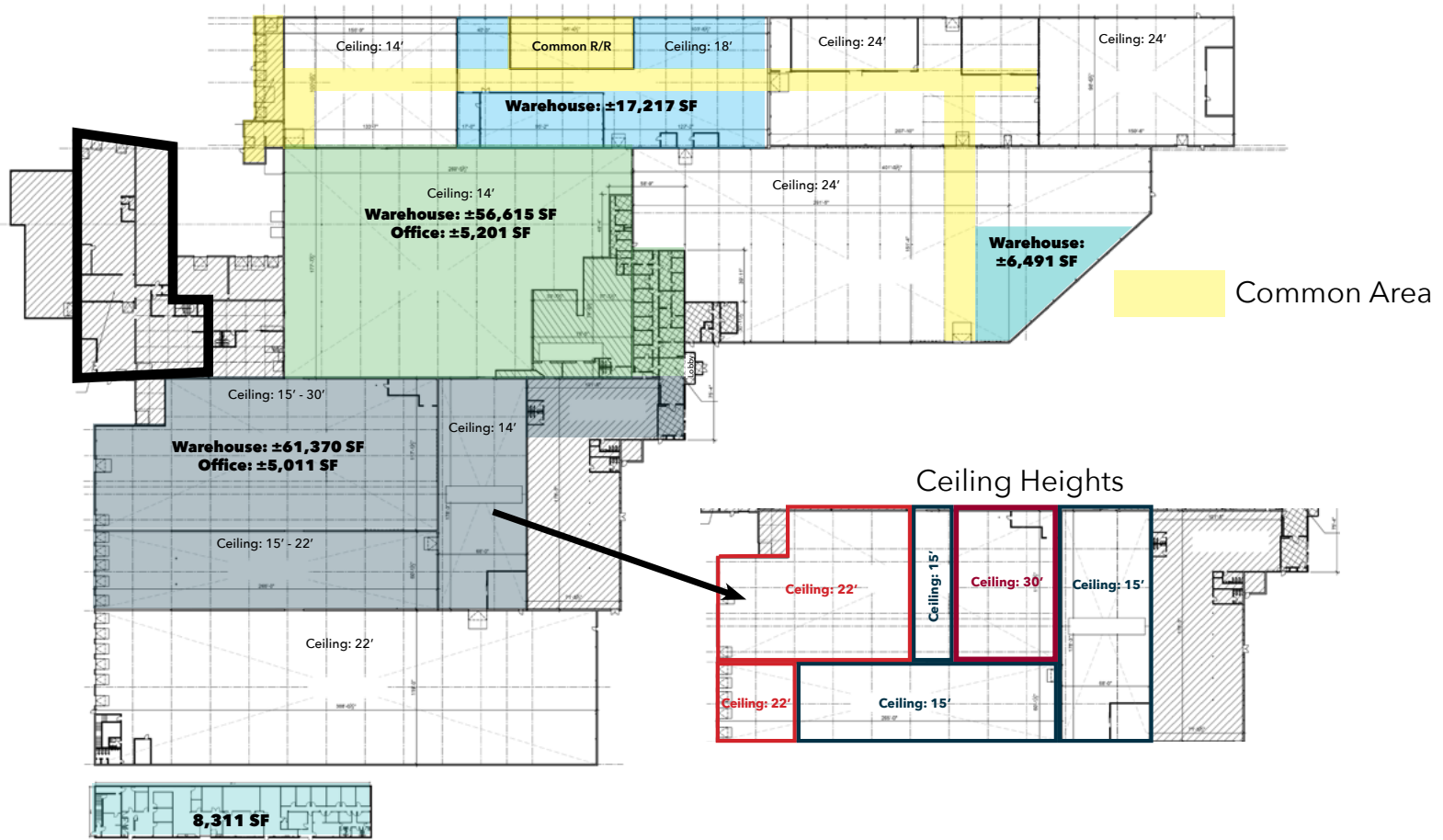





# LEARN MORE GIVE US A CALL



**Randall Bentley, SIOR, CCIM**  
President/ Managing Principal  
864.444.2842  
rbentley@lee-associates.com



**Kevin Bentley, SIOR**  
EVP/Principal  
864.444.1196  
kbentley@lee-associates.com



**Micah Williams**  
Senior Associate  
864.477.0455  
mwilliams@lee-associates.com



**Justin Bentley**  
Associate  
864.449.1059  
jbentley@lee-associates.com



**LEE & ASSOCIATES**  
COMMERCIAL REAL ESTATE SERVICES

**864.704.1040**  
**LeeGreenville.com**

### **GREENVILLE OFFICE**

201 W McBee Ave, Suite 400  
Greenville, SC 29601

### **SPARTANBURG OFFICE**

320 E. Main Street, Suite 430  
Spartanburg, SC 29302

All information furnished regarding the properties and information in this packet is from sources deemed reliable, but no warranty or representation is made to the accuracy thereof and same is submitted to errors, omissions, change of price, rental or other conditions prior to sale, lease or financing or withdrawal without notice. No liability of any kind is to be imposed on the broker herein.