

14108 HOUSTON WHITTIER ST.  
DETROIT, MICHIGAN



**SIGNATURE  
ASSOCIATES**  
KNOW SIGNATURE | KNOW RESULTS

RETAIL FOR SALE  
1,640 Square Feet Available



## PROPERTY FEATURES

- 1,640 square feet available
- Turn-key dispensary
- High density neighborhood
- Zoned B4
- Sale Price: \$350,000 (\$213.41/sq. ft.)

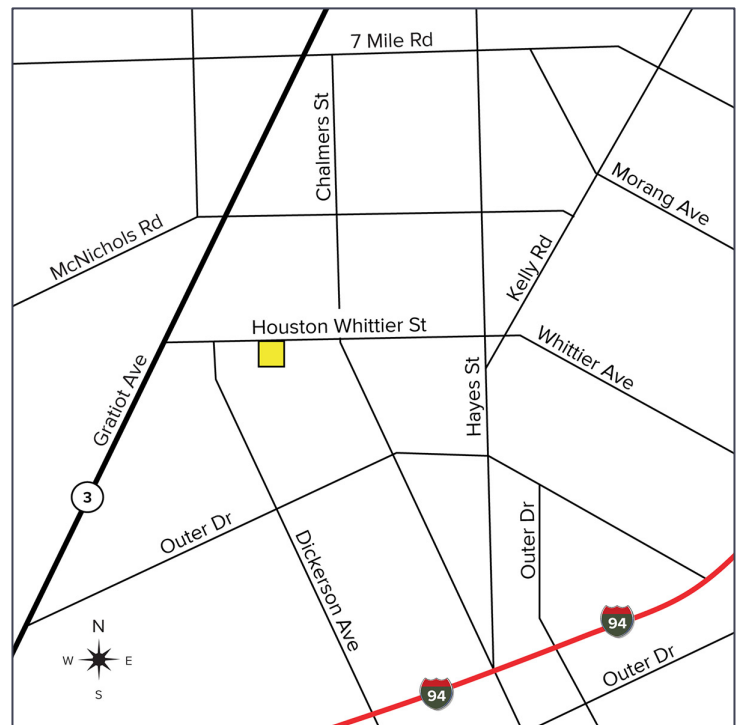

For more information, please contact:

**JOE STACK**  
(248) 359 0615  
jstack@signatureassociates.com

**MARVIN PETROUS**  
(248) 359 0647  
mpetrous@signatureassociates.com

**SIGNATURE ASSOCIATES**  
One Towne Square, Suite 1200  
Southfield, MI 48076  
www.signatureassociates.com

# 14108 Houston Whittier Street – Detroit, Michigan

Retail For Sale

1,640  
Square Feet  
AVAILABLE

## Site Plan

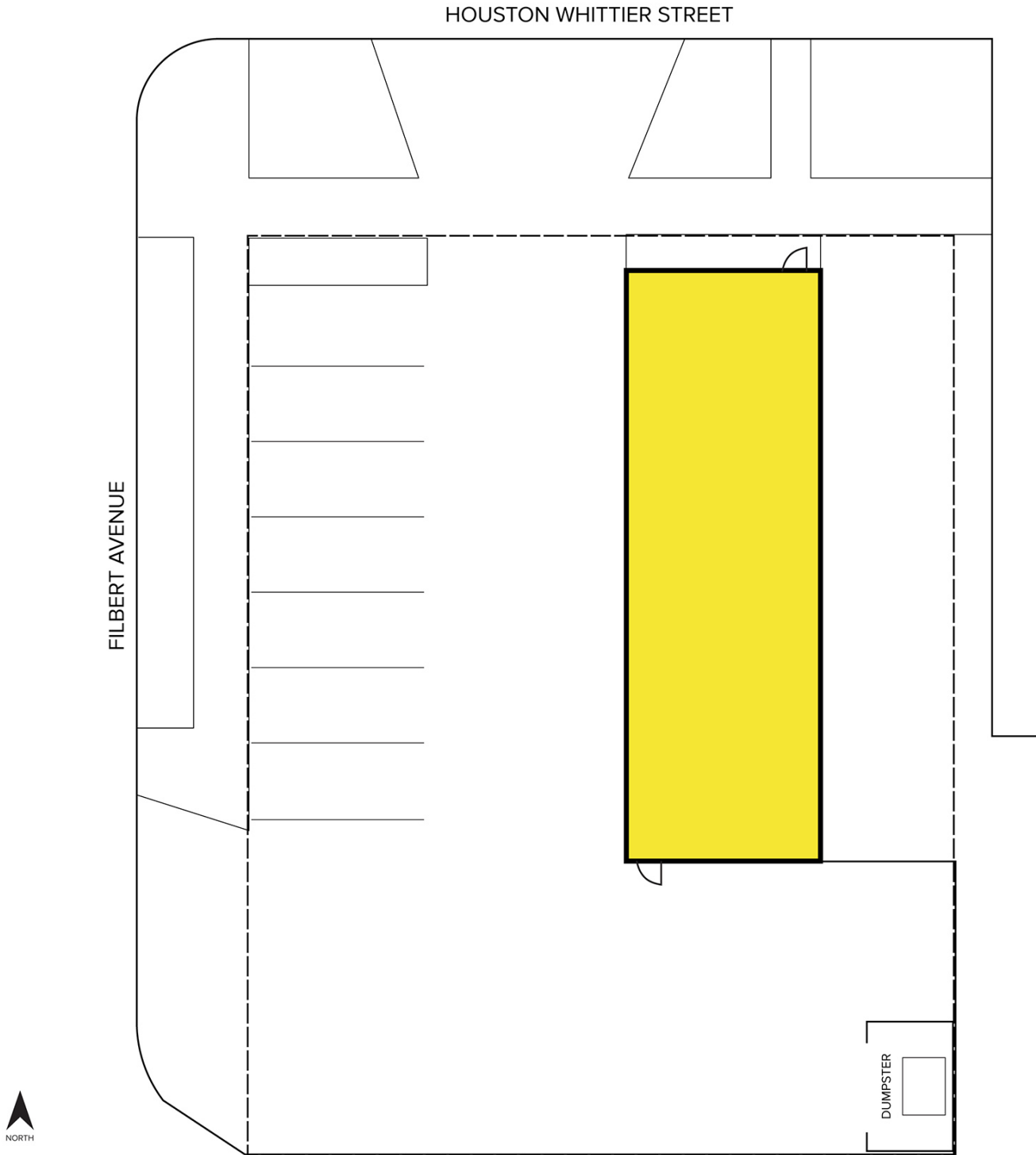

For more information, please contact:

**JOE STACK**  
(248) 359 0615  
jstack@signatureassociates.com

**MARVIN PETROUS**  
(248) 359 0647  
mpetrous@signatureassociates.com

**SIGNATURE ASSOCIATES**  
One Towne Square, Suite 1200  
Southfield, MI 48076  
www.signatureassociates.com

# 14108 Houston Whittier Street – Detroit, Michigan

Retail For Sale

1,640  
Square Feet  
AVAILABLE



## DEMOGRAPHICS

	POPULATION	MED. HH INCOME
1 MILE	14,814	\$42,891
3 MILE	135,611	\$46,274
5 MILE	364,689	\$61,920

## TRAFFIC COUNTS (TWO-WAY)

4,095	Chalmers St. N of Houston Whittier St.
4,557	Chalmers St. S of Houston Whittier St.
4,103	Houston Whittier St. E of Chalmers St.
3,855	Houston Whittier St. W of Chalmers St.



For more information, please contact:

**JOE STACK**  
(248) 359 0615  
jstack@signatureassociates.com

**MARVIN PETROUS**  
(248) 359 0647  
mpetrous@signatureassociates.com

**SIGNATURE ASSOCIATES**  
One Towne Square, Suite 1200  
Southfield, MI 48076  
www.signatureassociates.com