

ARWArchitecture PLLC
691 Greene Dr. Winter Park, FL 32792
407-618-3370 arwarchitecture@yahoo.com

THESE DOCUMENTS ARE THE PROPERTY OF ARIARCHITECTURE
AND ARE INSTRUMENTS OF SERVICE FOR THIS PROJECT ONLY.
DOCUMENTS MAY NOT BE USED OR COPIED FOR ANY OTHER
PROJECT WITHOUT THE WRITTEN PERMISSION OF ARIARCHITECTURE.

& Associates
LESSORS OF INDUSTRIAL & COMMERCIAL REAL ESTATE
FLORIDA, STATEWIDE
CERTIFIED GENERAL CONTRACTOR: 000011457
4800 North Orange Blossom Trail
Orlando, Florida 32810
407/291-9292

[illegible]

PARKWAY CENTER COURT
Orlando, FL

BUILDING FLOOR PLAN

This document has been electronically signed and sealed by R. Wolfe using a Digital Seal. Printed copies of this document are not considered signed and sealed. The signature must be verified on the electronic copy.

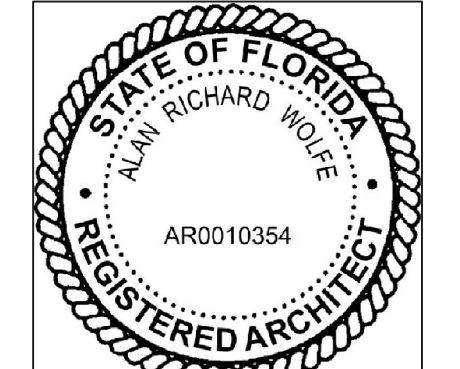

Alan R. Wolfe Fl. Reg. No. AR0010354

	PRELIMINARY
	PRELIM PRICING
	DESIGN DEV.
	LIFE SAFETY
	PERMIT DOCUMENTS
	CONST. DOCS.

DATE : 08/21/2024
PRINTED:: 11/07/2024

JOB NO. : 2434

SHEET NUMBER

A00

APPROVED BY:	DATE:
--------------	-------

8 Ground Level Loading Doors

3521 Parkway Center Court

10,000 sq.ft

3517 Parkway Center Court

9,200 sq.ft

3511 Parkway Center Ct

8,800 sq.ft

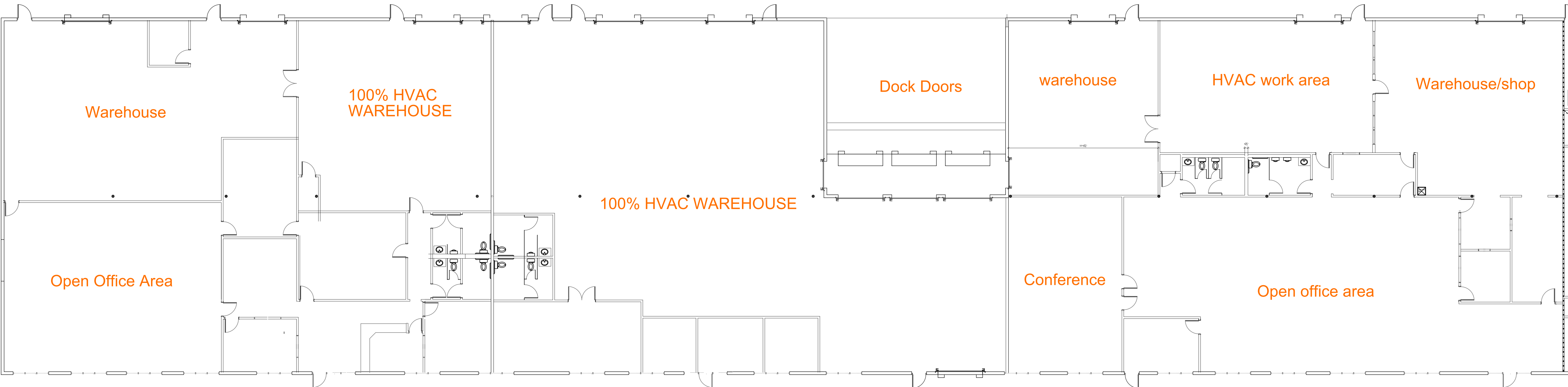

1 Building Floor Plan

SCALE: 3/32" = 1'-0"

SCALE: 3/32" = 1'-0"

NOT FOR CONSTRUCTION

