

Lake Eola

Portfolio of 5 Properties for Sale

Joann Eldred

joannce10@gmail.com

(407) 862-1200

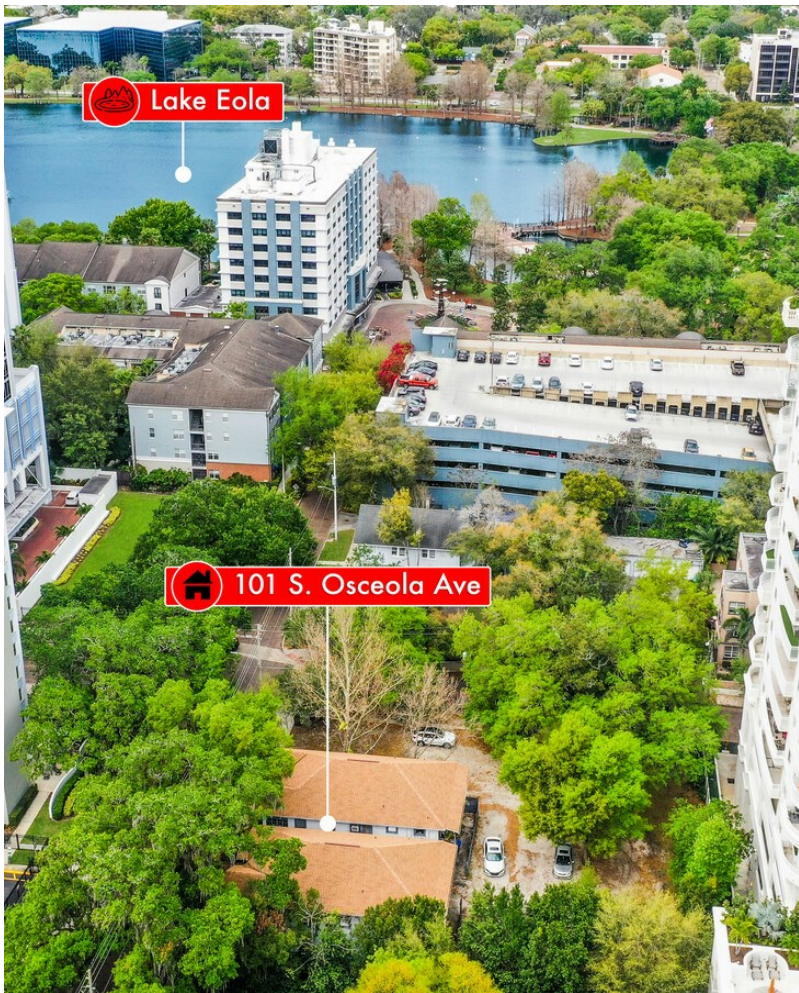

Lake Eola

\$7,999,999

Located in the heart of downtown Orlando one block from Lake Eola. Here is your opportunity to buy a prime location for future development. A PORTFOLIO OF 5 ADJACENT LOTS ZONED MXD-2/T, SUITABLE FOR MIXED-USE DEVELOPMENT POSSIBLY OVER TWENTY STORIES HIGH AND SURROUNDED BY HIGHRISES.

There are existing buildings on the properties that are occupied and income generating providing an immediate revenue stream for the new owners while redevelopment plans begin. All spaces are currently at full occupancy and provide \$23,860 per month in income.

The total site measures 0.59 acres with total of 25,804.11 square feet of land. The site is immediately adjacent to The Sanctuary multifamily development, one block South of Lake Eola and benefits from numerous walkable amenities including dining, shopping, and recreation.

- A+ Location Opportunity
- Lake Eola Downtown Orlando Area
- Portfolio of 5 adjacent Lots, All Zoned Mixed Use MXD-2/T
- Prime for Development

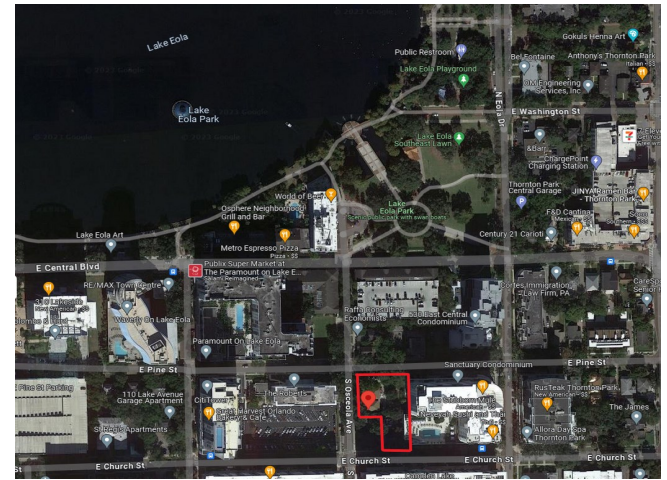

Price:	\$7,999,999
Price / SF:	\$311.28 / SF
Sale Type:	Investment
Status:	Active
Number of Properties:	5
Total Building Size:	
Total Land Area:	0.59 AC

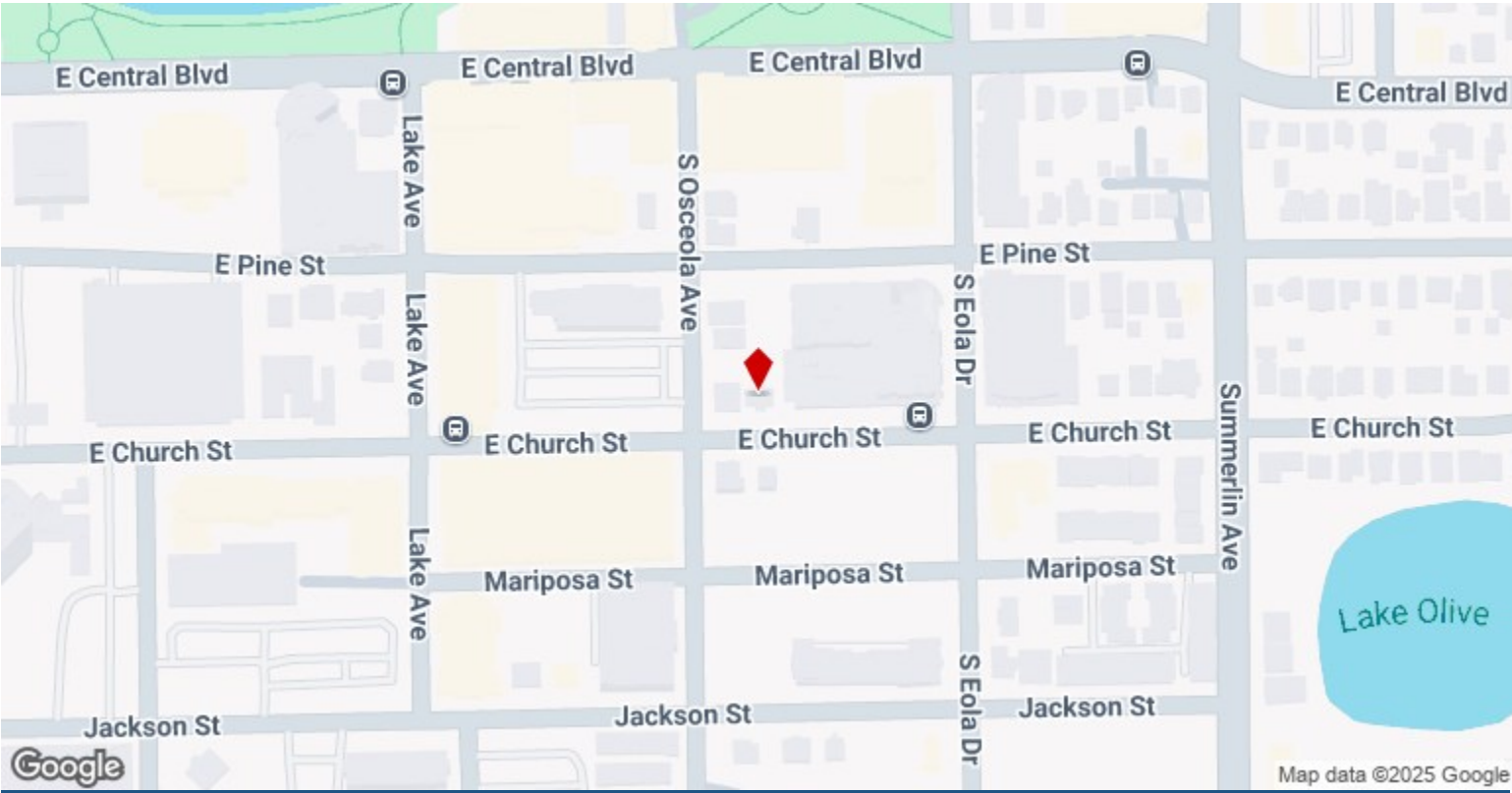

Lake Eola

Property Name/Address, City, State	Property Type	Size	Year Built	Individual Price
 509 E Church St Bldg 1, Orlando, FL	Land	0.18		
 101 S Osceola Ave Bldg 1, Orlando, FL	Land	0.11		
 103 S Osceola Ave Bldg 1, Orlando, FL	Land	0.09		
 109 S Osceola Ave, Orlando, FL	Land	0.09		
 510 E Pine St Bldg 1, Orlando, FL	Land	0.12		

Property Photos



Property Photos

