

Industrial | For Lease

# ±107,759 SF Warehouse Space

8845 Washington Blvd., Suite 100 | Roseville, CA 95678



## Contact Us:

**Todd Sanfilippo, Lic 01045162**  
Executive Vice President  
+1 916 847 3206  
[todd.sanfilippo@cbre.com](mailto:todd.sanfilippo@cbre.com)

**Walter Smyth, Lic 00956946**  
Senior Vice President  
+1 916 781 4843  
[walter.smyth@cbre.com](mailto:walter.smyth@cbre.com)

**Matt Susac, Lic 01979110**  
First Vice President  
+1 916 781 4832  
[matt.susac@cbre.com](mailto:matt.susac@cbre.com)

**CBRE**



# Property Features

- Available:  $\pm 107,759$  SF
- Ability to Demise in increments from  $\pm 20,603$  SF
- Office/Showroom:  $\pm 10,957$  SF
- Warehouse:  $\pm 96,802$
- GL Doors: 3 ( $\pm 12' \times 14'$ )
- DH Doors: 22 ( $\pm 10' \times 10'$ )
- Clear Height:  $\pm 28'$
- Fire Sprinklers: ESFR
- Column Spacing:  $\pm 57' \times 60'$
- Dock Apron:  $\pm 60'$  concrete
- Roof Truss: Metal
- Power:  $\pm 1,200$  Amps, 480 Volt, 3PH 4 Wire
- Construction Type: Concrete Tilt
- Skylights: Yes



NOT TO SCALE. ALL DIMENSIONS ARE APPROXIMATE.

# Potential Demising Floor Plan

Suite #	Total SF	Doors	Office SF
A	±20,603	4 DH / 1 GL	±2,221
C	±25,822	8 DH / 1 GL	0
B	±27,472	4 DH / 1 GL	±623
D	±34,430	6 DH / 1 GL	±8,113

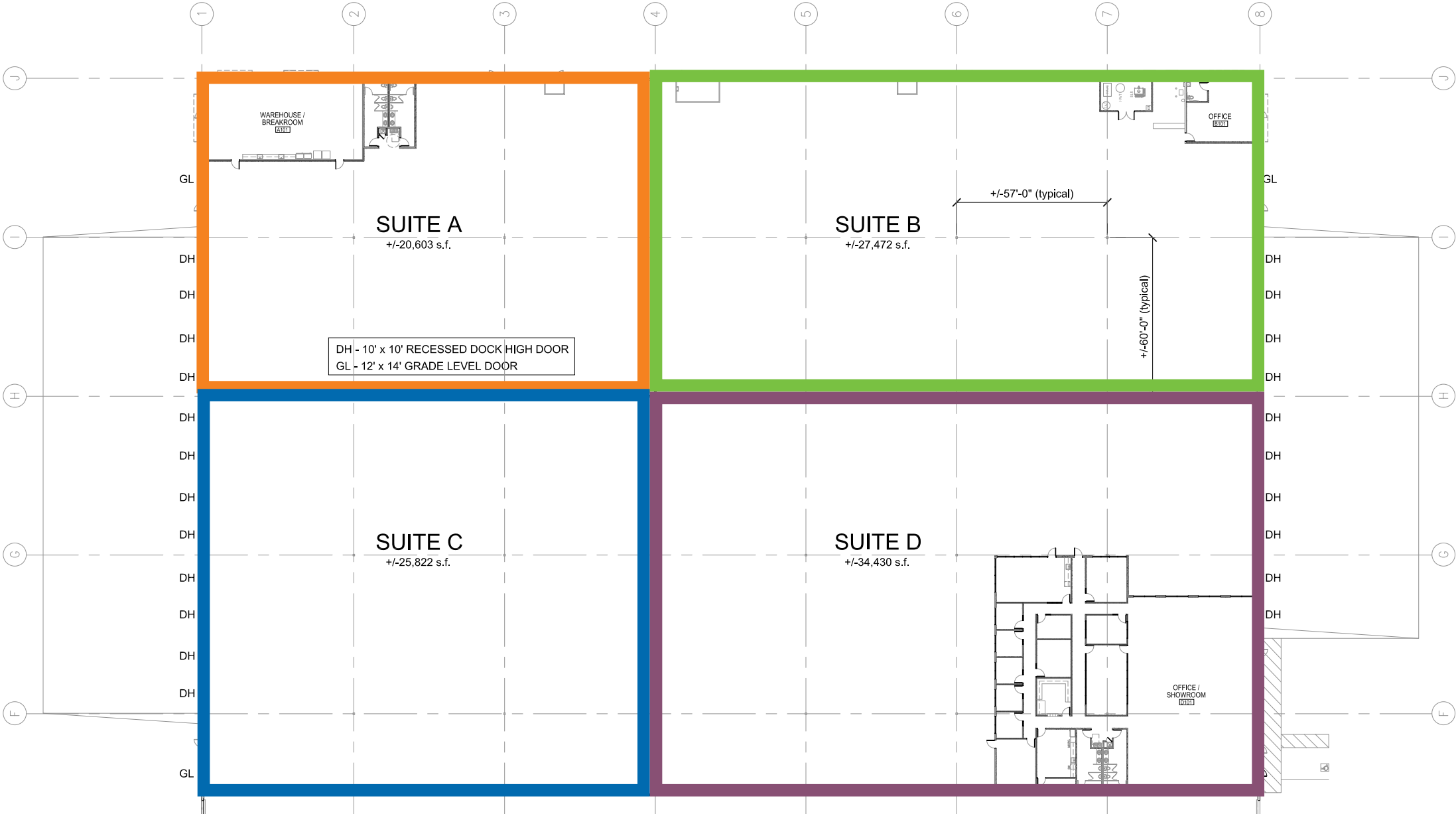

NOT TO SCALE. ALL DIMENSIONS ARE APPROXIMATE.

# Potential Demising Floor Plan

Suite #	Total SF	Doors	Office SF
B, C & D	±87,724	Cross Dock w/ 18 DH / 3 GL	±8,736

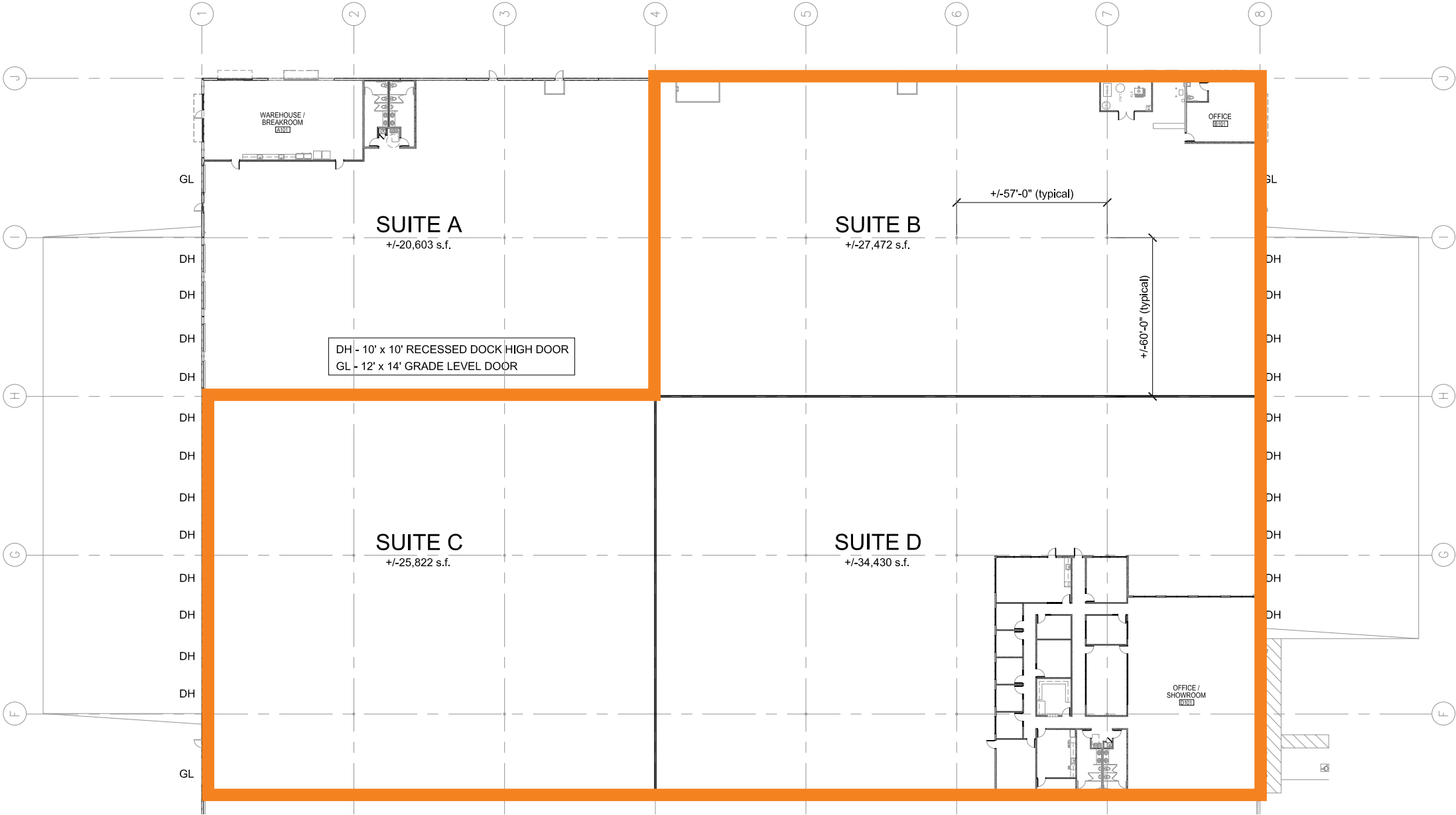

NOT TO SCALE. ALL DIMENSIONS ARE APPROXIMATE.

# Potential Demising Floor Plan

Suite #	Total SF	Doors	Office SF
A & B	±48,075	Cross Dock w/ 8 DH / 2 GL	±2,844
C & D	±60,252	Cross Dock w/ 14 DH / 2 GL	±8,113

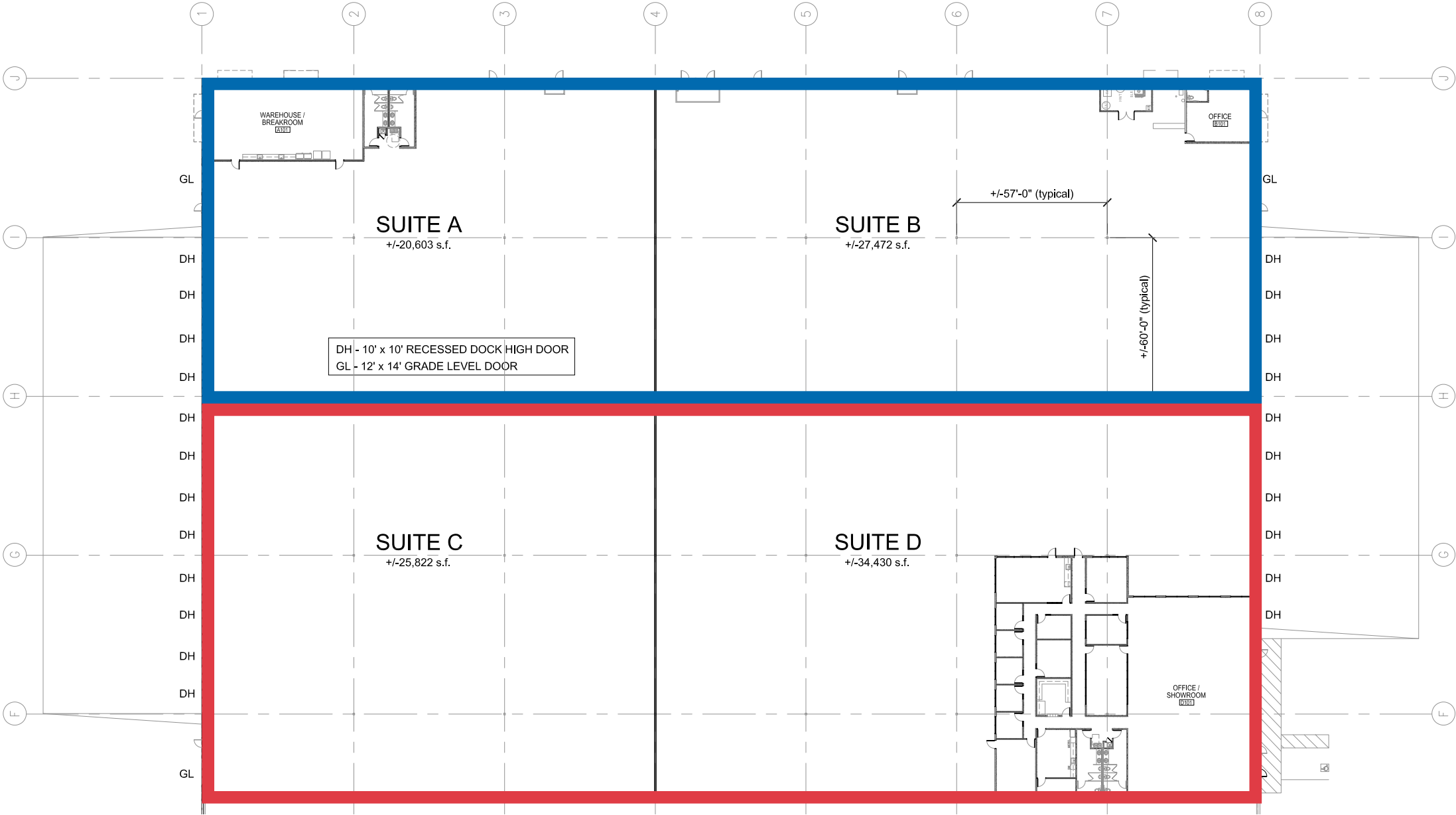

NOT TO SCALE. ALL DIMENSIONS ARE APPROXIMATE.



# Building Aerial

---





# Access Overview

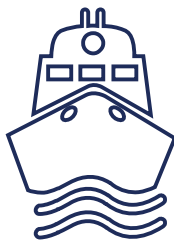

CITY	MILES
DAVIS	38
SACRAMENTO	27
OAKLAND	109
SAN FRANCISCO	110
SAN JOSE	142
RENO	116
FRESNO	199
LOS ANGELES	417
PORTLAND	569
SALT LAKE	634
SEATTLE	742
PHOENIX	780

AIRPORT	MILES
SACRAMENTO	24
STOCKTON	79
OAKLAND	114
SAN FRANCISCO	121
SAN JOSE	140

PORT	MILES
PORT OF STOCKTON	77
PORT OF OAKLAND	105
PORT OF LA/ LONG BEACH	438
PORT OF PORTLAND	581
PORT OF SEATTLE	744

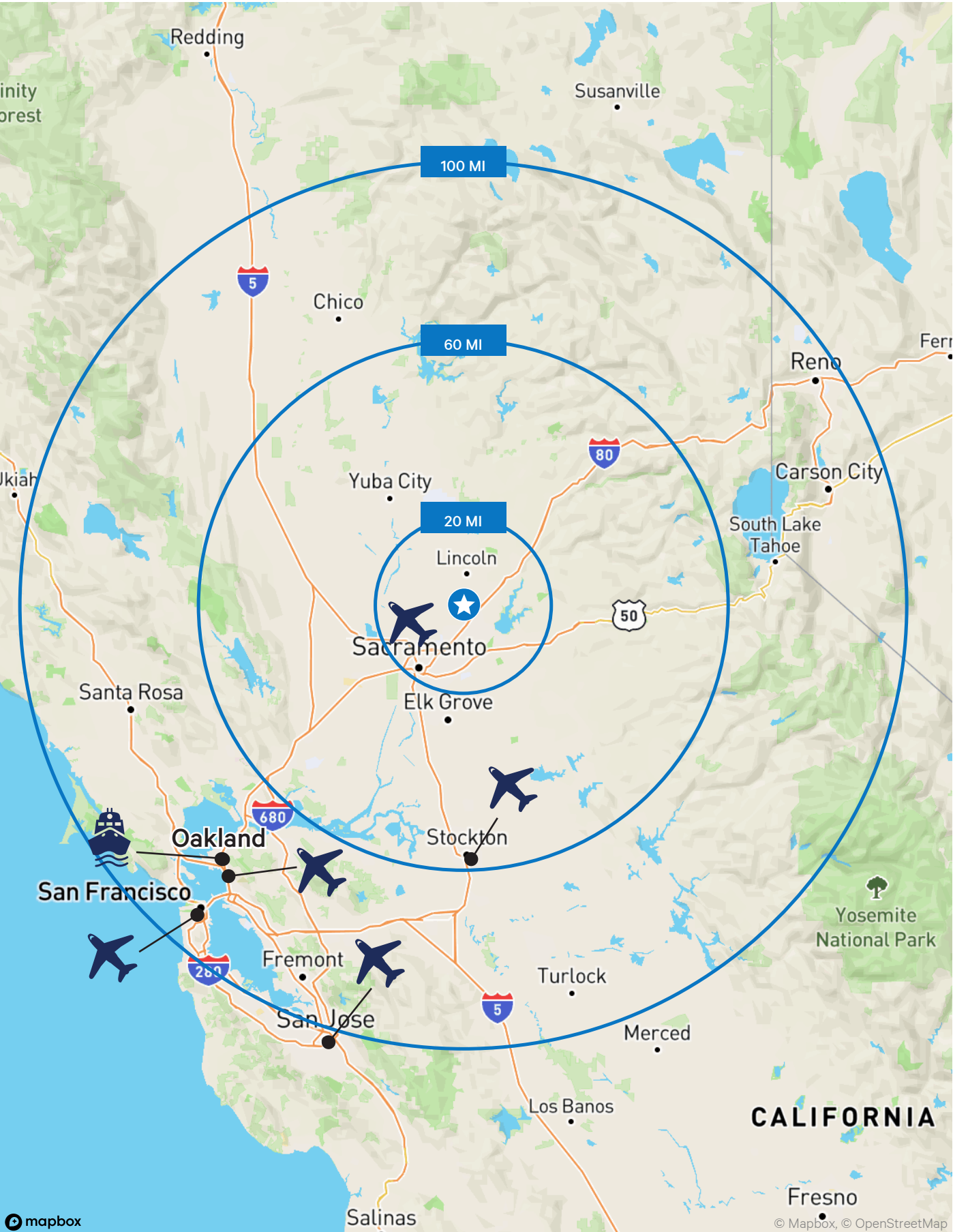

# Drive Time to Major Distribution Destinations



Local & Regional

CITY	MILES
DAVIS	37
SACRAMENTO	27
OAKLAND	109
SAN FRANCISCO	110
SAN JOSE	142
RENO	116
FRESNO	199
LOS ANGELES	411
PORTLAND	569
SALT LAKE	634
SEATTLE	742
PHOENIX	780



Western U.S.

AIRPORT	MILES
SACRAMENTO	24
STOCKTON	79
OAKLAND	114
SAN FRANCISCO	121
SAN JOSE	140

PORT	MILES
PORT OF STOCKTON	77
PORT OF OAKLAND	105
PORT OF LA/ LONG BEACH	438
PORT OF PORTLAND	581
PORT OF SEATTLE	744

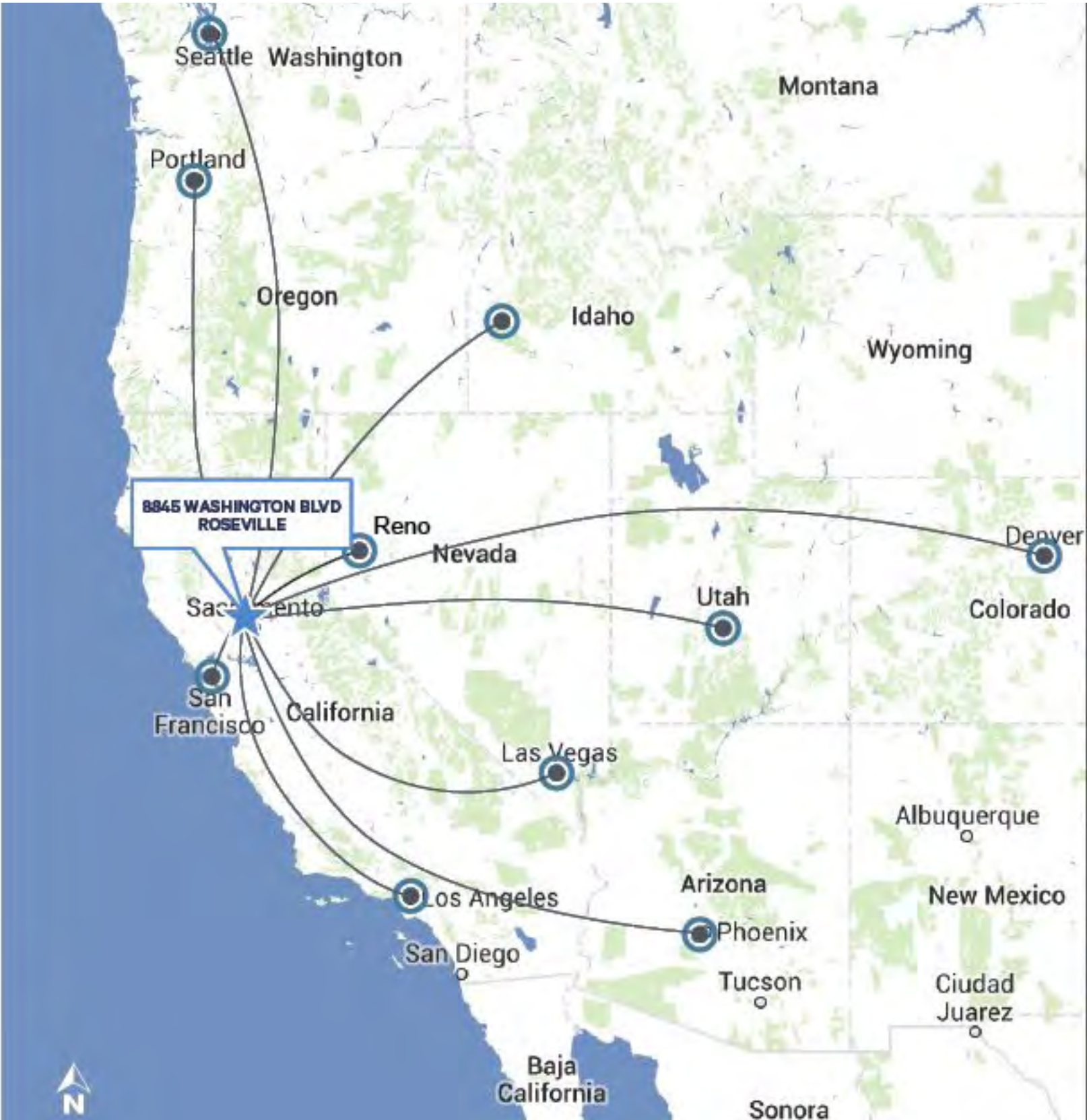



# Neighboring Companies





# 8845 Washington Blvd. | Roseville, CA 95678

---

## Contact Us:

**Todd Sanfilippo, SIOR**

Executive Vice President

+1 916 781 4859

todd.sanfilippo@cbre.com

**Walter Smyth**

Senior Vice President

+1 916 781 4843

walter.smyth@cbre.com

**Matt Susac**

Vice President

+1 916 781 4832

matt.susac@cbre.com