

18,250 & 3,200 RETAIL SUITES AVAILABLE FOR LEASE

10215 N. 28th Drive

PHOENIX, AZ



NEWMARK

Joseph Hoyer II
Director
t 602-952-3819
joe.hoyer@nmark.com

18,250 & 3,200 RETAIL SUITES AVAILABLE FOR LEASE

Property Overview

- Situated within the high traffic region of the Phoenix Metrocenter
- Suitable for variety of retail-service uses
- Good visibility and curb appeal
- Conveniently located adjacent to major retail tenants in the market including Burlington, Barnes & Noble, Michaels and Petco

Demographics

	1-Mile	3-Miles	5-Miles
Population	15,203	172,093	447,601
Average H.H. Income	\$62,617	\$78,684	\$86,848
Daytime Population	27,040	151,872	396,653

Source: ESRI



YOUR NAME HERE



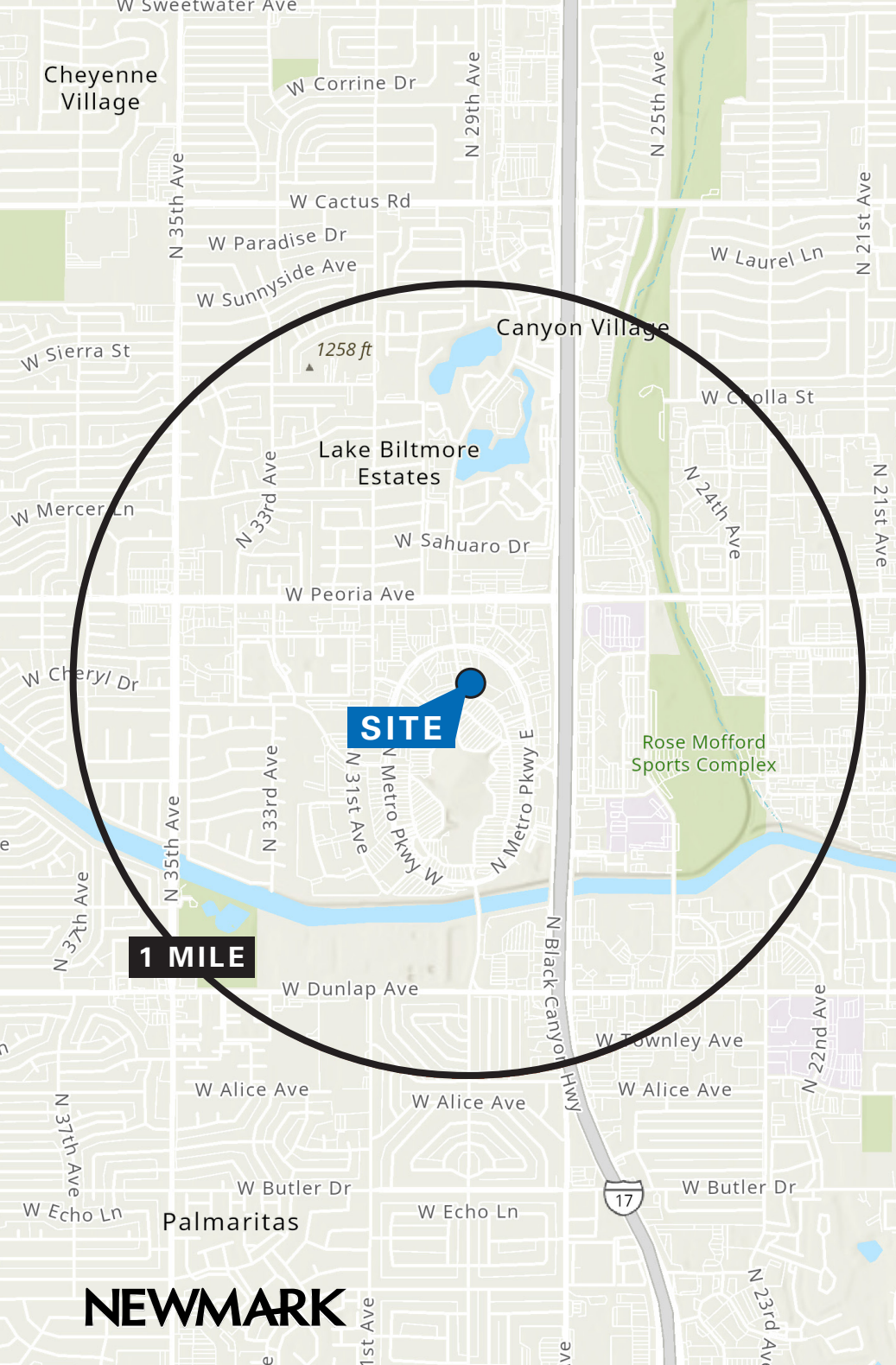

DEMOGRAPHICS

	1-MILE	3-MILES	5-MILES
POPULATION			
2023 Population	15,203	172,093	447,601
2028 Population	14,979	169,601	443,157
2020 Population	15,246	172,273	447,618
2010 Population	13,657	156,249	405,829
2023-2028 Annual Rate	-0.30%	-0.29%	-0.20%
2023 Median Age	34.2	34.8	35.7
Total Businesses	1,153	4,159	10,628
Total Employees	16,100	50,101	132,946
2023 Total Daytime Population	27,040	151,872	396,653
HOUSEHOLDS			
2023 Total Households	6,573	63,173	166,023
2028 Total Households	6,504	62,765	165,740
2010 Households	6,115	58,067	153,032
2000 Households	6,554	61,253	159,921
2023-2028 Annual Rate	-0.21%	-0.13%	-0.03%
2023 Average Household Size	2.29	2.69	2.62
INCOME			
2023 Median Household Income	\$46,103	\$56,165	\$59,243
2028 Median Household Income	\$52,914	\$64,891	\$70,064
2023 Average Household Income	\$62,617	\$78,684	\$86,848
2028 Average Household Income	\$74,011	\$92,592	\$101,615
2023 Per Capita Income	\$26,849	\$28,874	\$32,349
HOUSING			
2023 Total Housing Units	7,025	66,597	175,973
2023 Owner Occupied Housing Units	30.6%	48.8%	51.3%
2023 Renter Occupied Housing Units	63.0%	46.1%	43.0%
2023 Vacant Housing Units	6.4%	5.1%	5.7%
2023 Median Home Value	\$277,761	\$289,913	\$317,376
2023 Average Home Value	\$399,628	\$376,247	\$394,944

18,250 & 3,200 RETAIL SUITES AVAILABLE FOR LEASE

10215 N. 28th Drive

PHOENIX, AZ

Prepared by:

Joseph Hoyer II
Director

t 602-952-3819
joe.hoyer@nrmk.com

2555 East Camelback Rd., Suite 600 Phoenix, AZ 85016 | t 602-952-3800

nrmk.com

The information contained herein has been obtained from sources deemed reliable but has not been verified and no guarantee, warranty or representation, either express or implied, is made with respect to such information. Terms of sale or lease and availability are subject to change or withdrawal without notice.

NEWMARK

