

For Lease

699 Ivy Street Glendale | CA



Presented By:

Christopher Rohrer
818.624.1180
chris@pacwestonline.com
DRE#02018754

Ron Rohrer
818.309.0628
ron@pacwestonline.com
DRE#01918399

Randy Rohrer
818.244.3000
randy@pacwestonline.com
DRE#00672287

Scott Cox
818.244.3000
scott@pacwestonline.com
DRE#01070703

The logo for Pacific West Business Properties, Inc. features the word 'Pacific' in a large, red, serif font, with 'West' in a smaller, red, serif font below it. To the left of the text are several black diagonal lines of varying lengths. Below the text, 'Business Properties, Inc.' is written in a smaller, red, sans-serif font.

Pacific
West
Business Properties, Inc.

Property Information

Available SF:	8,400 SF	› Internal Loading Dock
Asking Price:	\$14,280 (\$1.70/SF)	› Fully Air Conditioned
Lease Type:	Modified Gross	› Gated Parking
Power:	100 A; 240V; 3 Ph	› Convenient to 5 and 134 freeways
Zoning:	IMU	› 12 Foot Clearance in Warehouse
Parking:	8 Gated	› 725 SF of Office
Built:	1947	› 10' x 10' Loading Door

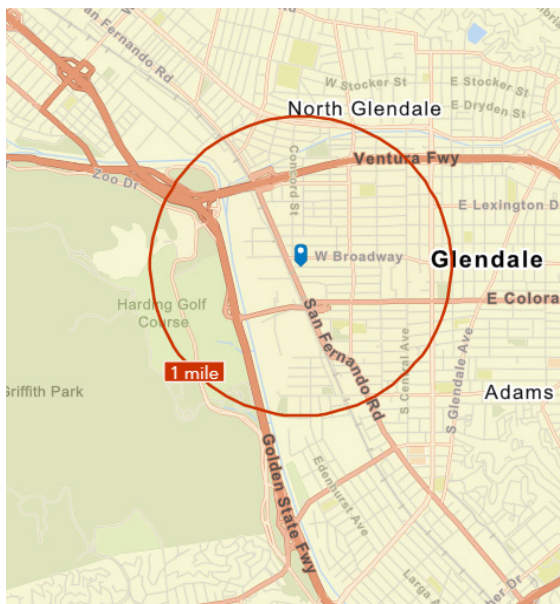

34,218

Population



2.4

Average Household Size



40.6

Median Age

\$67,996

Median Household Income



13%

No High School Diploma



24%

High School Graduates



24%

Some College



39%

Bachelor's/GreatPr of Degree

BUSINESS



3,816

Total Businesses



33,642

Total Employees

EMPLOYMENT



White Collar

67.1%



Blue Collar

17.2%



Services

15.7%



7.5%

Unemployment Rate

The facts contained herein, while not guaranteed as to accuracy, are accurate to the best of our knowledge and belief.

Floor Plan

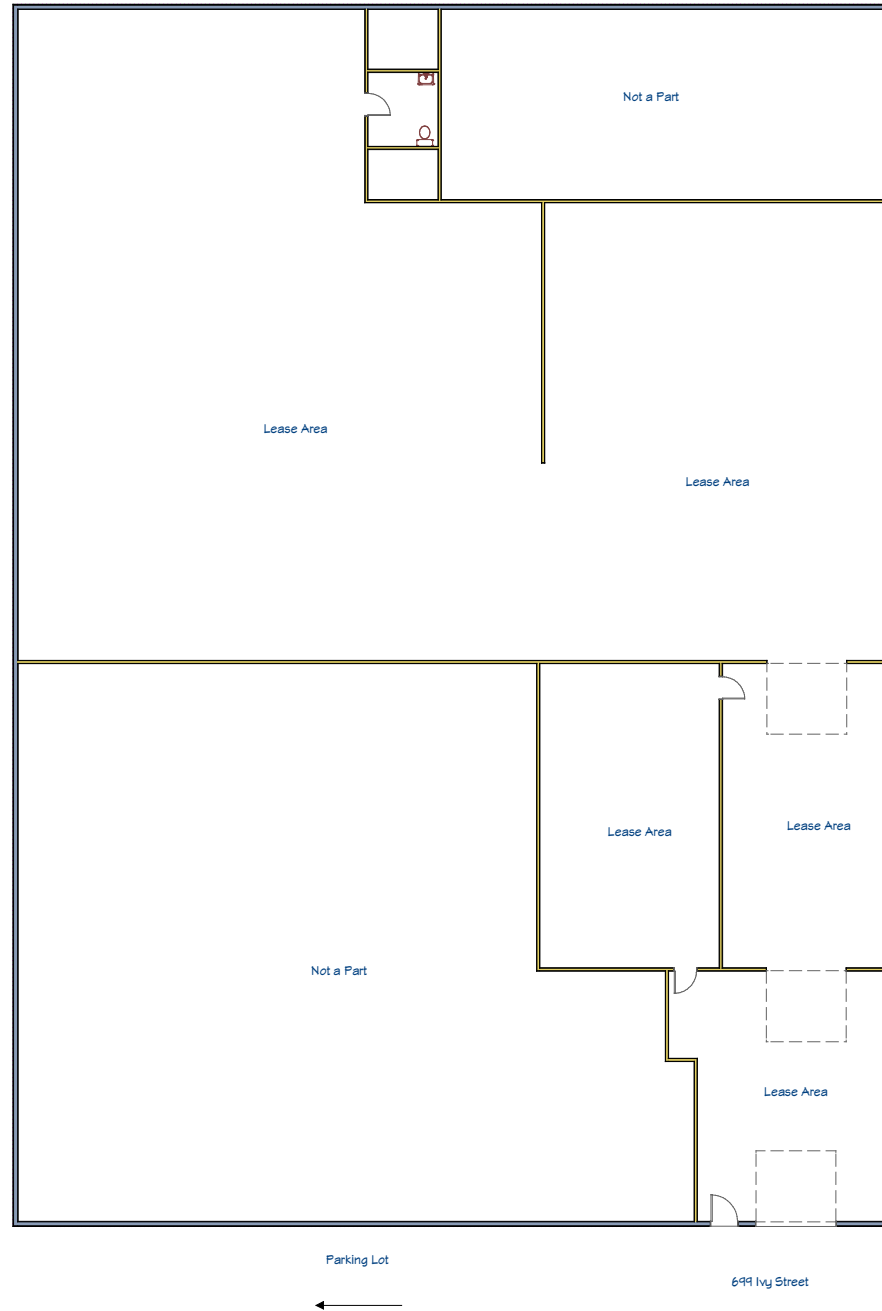

Map Location

Pacific West Business Properties, Inc.

6624 San Fernando Road Glendale, CA 91201 | 818-244-3000



Photos



Photos

