

FOR LEASE

# Mesa 17th Center

211 E. 17th Street | Costa Mesa, CA 92627

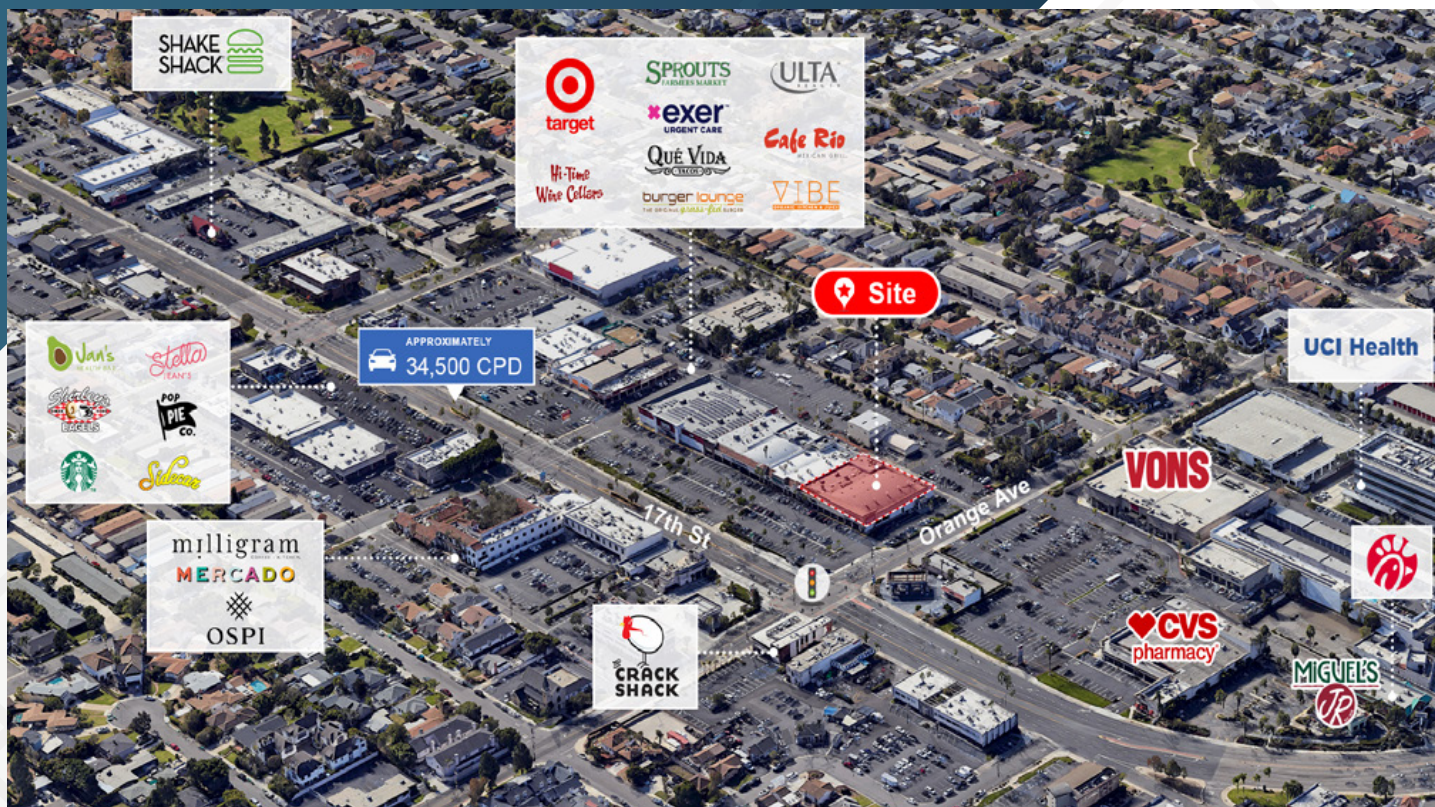

## Retail/Restaurant/Medical/Fitness Opportunity

±15,384 SF (Divisible)

Demising Options

±2,940 SF to ±9,098 SF

Property Owned and  
Managed By:



## CONTACT

**Terrison Quinn**

949.698.1107 | terrison.quinn@srsre.com  
CA License No. 01789657

**Casey Mahony**

949.698.1108 | casey.mahony@srsre.com  
CA License No. 01886184

**Tony Vuona**

949.270.8211 | tony.vuona@srsre.com  
CA License No. 02046746



## DESCRIPTION

- Rare 17th St. opportunity available in Eastside Costa Mesa
- Excellent demographics with high profile disposable incomes in the surrounding area
- Well-trafficked and highly visible center with monument signage available along 17th Promenade
- Opportunity to join one of the most desirable retail corridors in Orange County
- Caters to the greater Newport Beach & Costa Mesa area, including Newport Heights, Dover Shores & Eastside Costa Mesa
- Strong co-tenancy: Target, Sprouts, Ulta, Surfside Sports, Exer Urgent Care, Burger Lounge, Cafe Rio, dr. Laser, Que Vida Tacos, Vibe Kitchen, Hi-Time Wine Cellar and more

**SRSRE.COM**

# Mesa 17th Center

211 E. 17th Street | Costa Mesa, CA 92627



**TENANT 1** ±9,098 SF + ±1,635 SF Patio

**TENANT 2** ±2,940 SF

**TENANT 3** ±3,346 SF

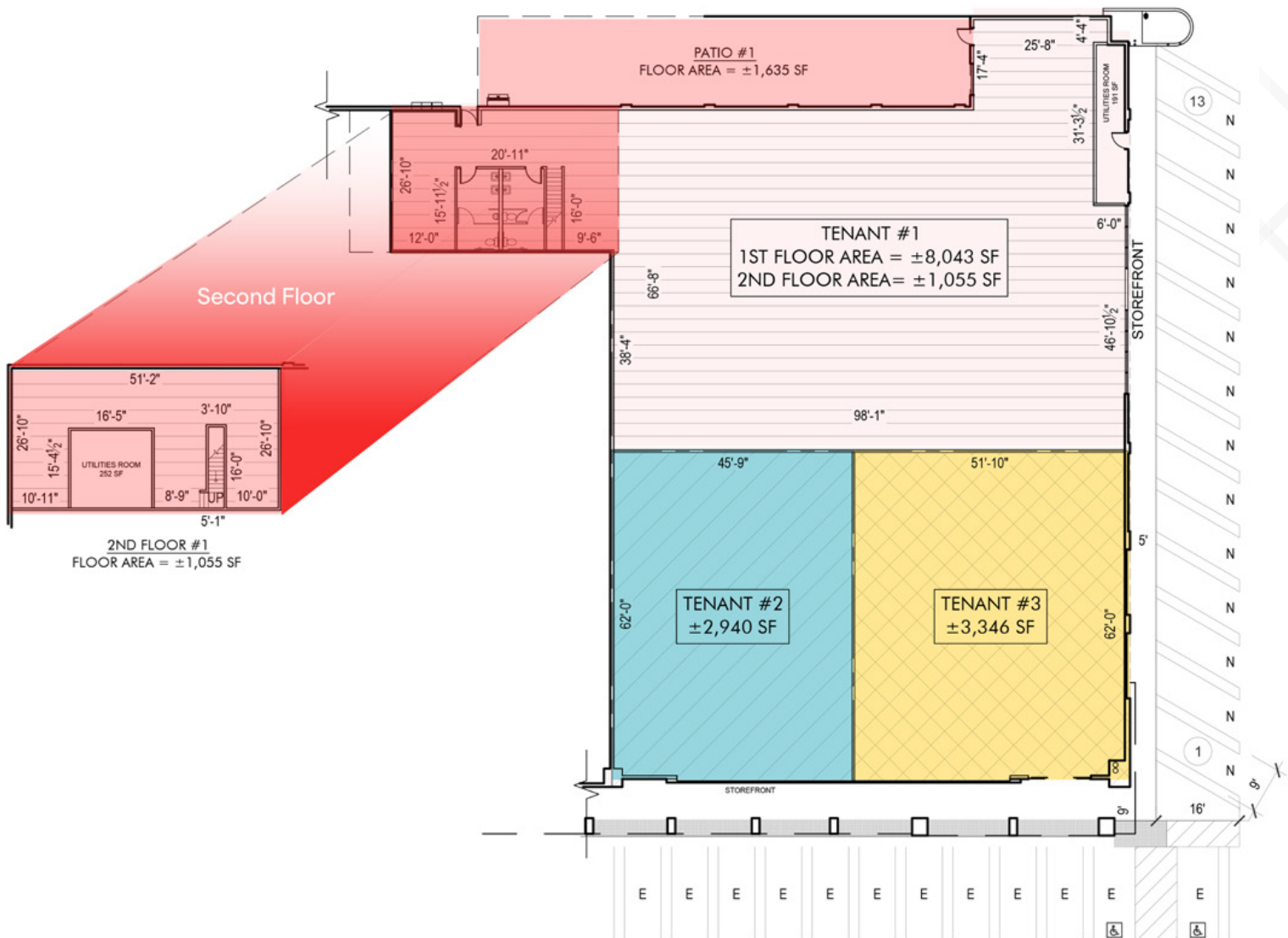

Property Owned and  
Managed By:





# Mesa 17th Center

211 E. 17th Street | Costa Mesa, CA 92627



±15K AVAILABLE  
(DIVISIBLE)

**A** ±15,384 SF (Divisible)

Demising Options

±2,940 SF to ±9,098 SF

Highly visible pylon  
signage available along 17th Street!

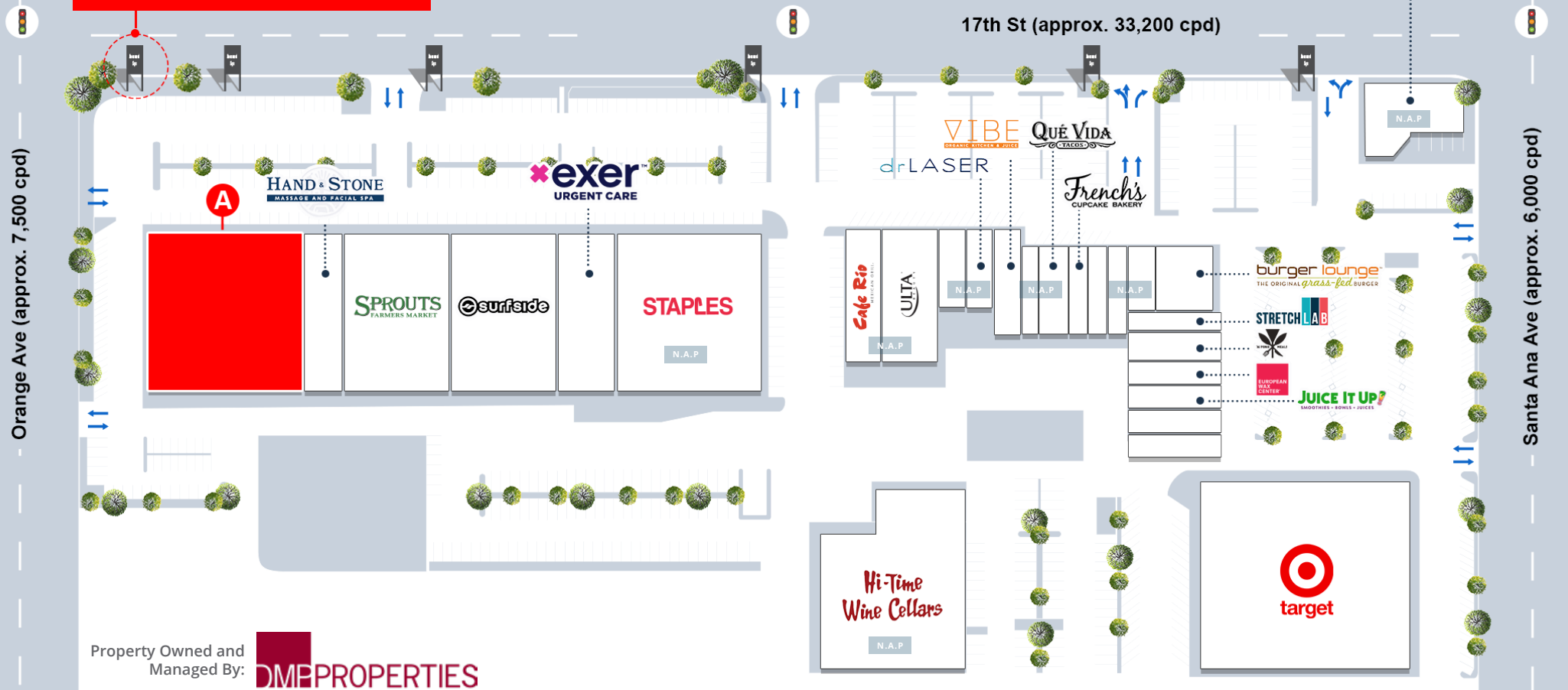



# Mesa 17th Center

211 E. 17th Street | Costa Mesa, CA 92627

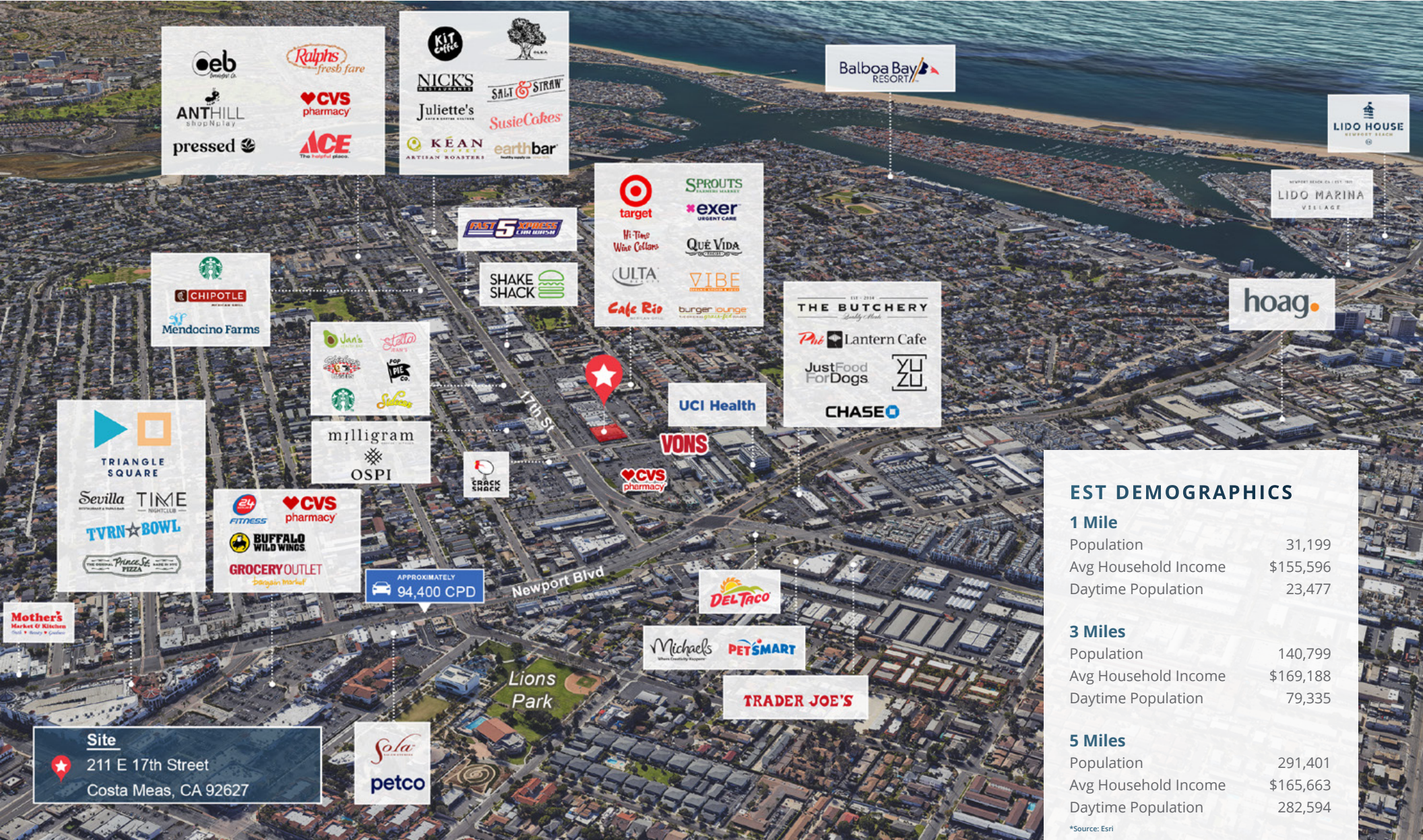

© SRS Real Estate Partners

610 Newport Center Drive, Suite 1500, Newport Beach, CA 92660

The information presented was obtained from sources deemed reliable; however SRS Real Estate Partners does not guarantee its completeness or accuracy.

Property Owned and  
Managed By:

