

# FORMER GLORY SUPER MARKET

19136-19150 Telegraph Road / Detroit, MI



**MID-AMERICA®**  
Real Estate-Michigan, Inc.

## FOR SALE & LEASE



RETAIL OPPORTUNITY

# FORMER GLORY SUPER MARKET



## Address

19136-19150 Telegraph Road  
Detroit, MI 48219

## Availability

9,450 - 49,570 SF  
3.85 Acres

## Area Tenants



## Features

- Former Glory Supermarket on the northeast corner of 7 Mile and Telegraph Roads is available for lease or sale.
- The existing 49,570 SF building sits on 3.85 acres, with opportunity to carve out an outlot.
- There is pylon signage available on both 7 Mile and Telegraph Roads, along with 460 feet of Telegraph Road frontage, both providing great visibility for the property.
- Zoned B-4 (General Business): permits a wide range of uses including: auto sales, medical uses, and dance halls, among many others.

## Demographics (2024)

	1 MILE	3 MILES	5 MILES
POPULATION	14,241	106,090	295,111
HOUSEHOLDS	6,191	44,299	123,651
AVG HOUSEHOLD INCOME	\$52,901	\$70,743	\$78,734
DAYTIME POPULATION	11,317	92,679	306,243

# FORMER GLORY SUPER MARKET

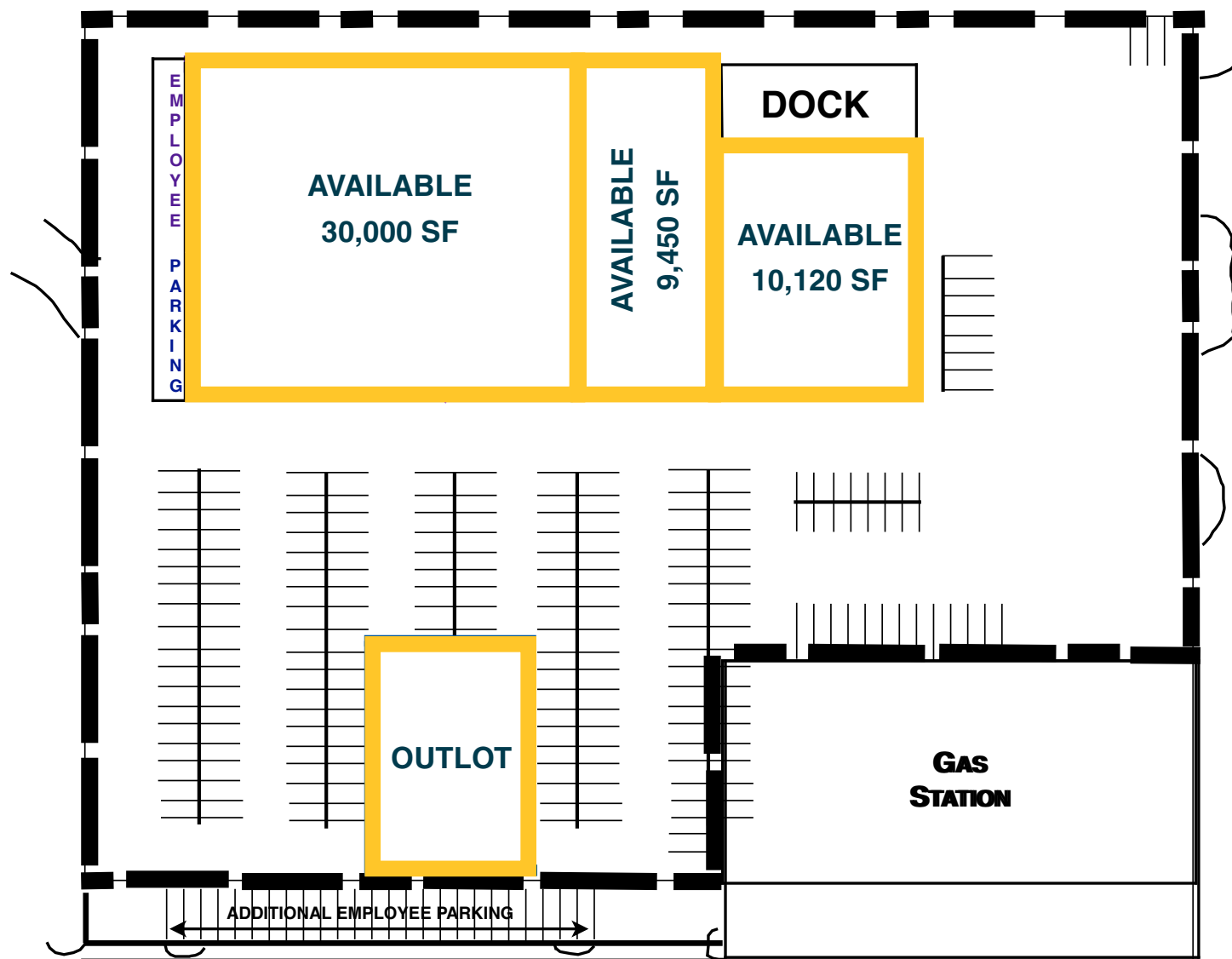



# FORMER GLORY SUPER MARKET



Shoppes at Redford Oaks  
Great Lakes **ACE** Hardware  
**Rainbow**  
ASHLEY STEWART  
**DOLLAR GENERAL**  
kids for less  
SHERWIN WILLIAMS



Communication and  
Media Arts High School  
(512 students)

Wright Academy of  
Arts and Science  
(600 students)

Greater Grace  
Conference  
Center

**SITE**  
19136-19150  
Telegraph Road

Telegraph Rd  
54,954 vpd

12,916 vpd

7 Mile Rd

Grand River Ave  
18,781 vpd

52,118 vpd

AERIAL



# FORMER GLORY SUPER MARKET



Eric  
Unatin

Mid-America Real Estate -  
Michigan, Inc.

T: 248.855.6800

**EUnatin@MidAmericaGrp.com**

George  
Sheena

Mid-America Real Estate -  
Michigan, Inc.

T: 248.855.6800

**GSheena@MidAmericaGrp.com**



**MID-AMERICA®**  
Real Estate-Michigan, Inc.

38500 Woodward Ave, Suite 100  
Bloomfield Hills, Michigan 48304  
248.855.6800

**MidAmericaGrp.com**

CONTACT