

AVAILABLE IMMEDIATELY

4535 E ELWOOD ST

Suite 101 · Phoenix, AZ · Industrial / Warehouse

26,594

SF AVAILABLE

3,200

SF OFFICE

24'

CLEAR HEIGHT

93,726

SF TOTAL BUILDING

SUITE
101

AVAILABLE SF
26,594 SF

OFFICE SF
3,200 SF

OCCUPANCY
IMMEDIATE

CONTACT TO TOUR
SCOTT GUO

PROPERTY HIGHLIGHTS

- **I-10 Freeway Frontage** – Direct visibility to 300,000+ daily vehicle trips
- **5-Minute Drive to Sky Harbor** – Unmatched air freight & logistics access
- **Institutional Ownership** – Professionally managed campus with responsive local management
- **24' clear height** – ideal for high-bay racking
- **4 dock-high doors + 1 ramped drive-in door**
- **200' shared truck court** – full 53' trailer access
- **27 dedicated auto parking stalls**

PROPERTY SPECIFICATIONS

ADDRESS	4535 E Elwood St, Phoenix, AZ
SUITE	101
AVAILABLE SF	26,594 SF
OFFICE SF	3,200 SF
TOTAL BUILDING SF	93,726 SF
CLEAR HEIGHT	24'
DOCK DOORS	4
DRIVE-IN DOORS	1 (Ramped)
TRUCK COURT	200' Deep (Shared)
SPRINKLER	ESFR
WAREHOUSE COOLING	Evaporative
PARKING	27 Auto Stalls
OCCUPANCY	Immediate

CAPITAL IMPROVEMENTS

- New LED Lighting w/ Motion Sensors
- Warehouse Whiteboxing
- New Office Paint & Flooring

SCOTT GUO



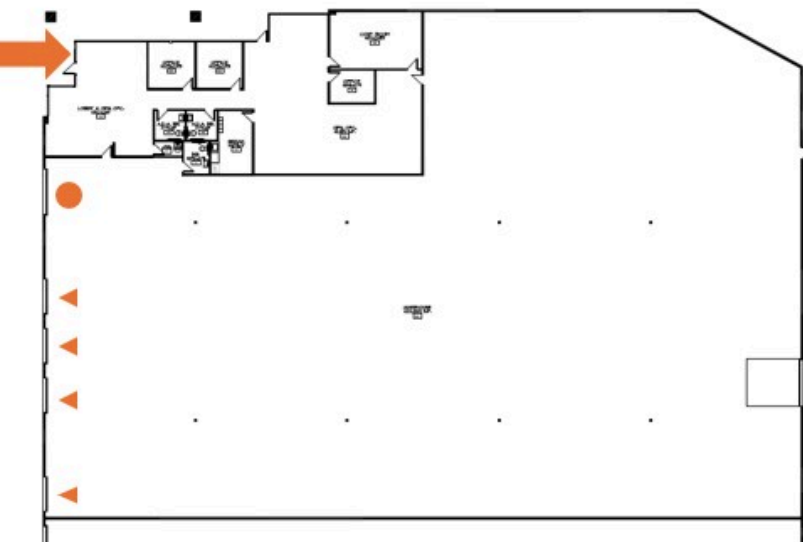
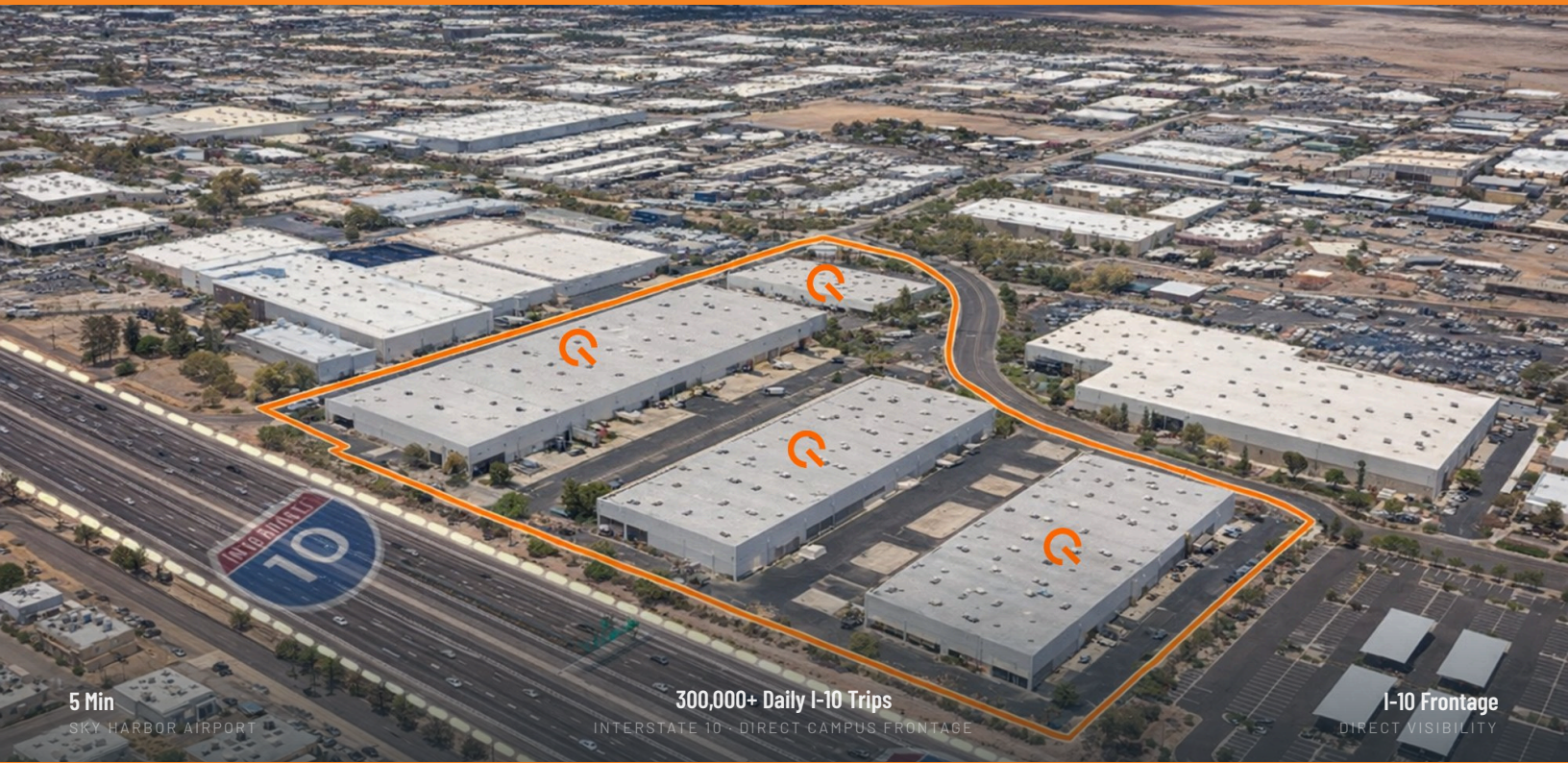

EQT REAL ESTATE

(480) 637-1166

✉ scott.guo@eqtpartners.com



SUITE 101 - FLOOR PLAN



-  **Primary Entrance**
Main office entry off E Elwood Street
-  **Ramped Drive-In Door**
Grade-level access for drive-in loading
-  **4 Tailgate Loading Doors**
Dock-high doors on rear truck court
-  **26,594 SF Available**
Includes 3,200 SF of office space

 **5 Min**
to Phoenix Sky Harbor International Airport

 **I-10 Frontage**
300,000+ daily vehicle trips — direct freeway visibility

 **4-Bldg Campus**
EQT Real Estate owned & professionally managed

SCOTT GUO
EQT REAL ESTATE

 (480) 637-1166  scott.guo@eqtpartners.com