

VICTOR CORPORATE PARK



MID-AMERICA®
Real Estate-Michigan, Inc.

19265 Victor Parkway / Livonia, MI

FOR LEASE OR SALE



RETAIL OPPORTUNITY

VICTOR CORPORATE PARK



Address

19265 Victor Parkway
Livonia, MI 48152

Availability

1.8 Acres

Features

- Adjacent to the largest exclusive BMW motorcycle dealership in the United States and Dave & Buster's at the highly visible 7 Mile and I-275 interchange.
- Offers an unobstructed view of I-275, with traffic exposure to over 155,000 vehicles daily. Convenient access to Victor Parkway from both 7 Mile and 8 Mile Roads.
- Zoned C-4, allowing for a variety of permitted uses, including banks, full-service restaurants, hotels, indoor recreational facilities, medical offices, physical therapy and health services, retail stores, and schools, among others.
- Dave & Buster's ranks #1/3 in Michigan according to Placer.ai, attracting 363,900 visitors annually.
- Signage details to be determined.

Area Tenants



Demographics (2025)

	1 MILE	3 MILES	5 MILES
POPULATION	4,238	79,702	191,310
HOUSEHOLDS	2,033	34,816	83,379
AVG HOUSEHOLD INCOME	\$122,376	\$136,939	\$137,701
DAYTIME POPULATION	18,213	96,516	254,704

VICTOR CORPORATE PARK

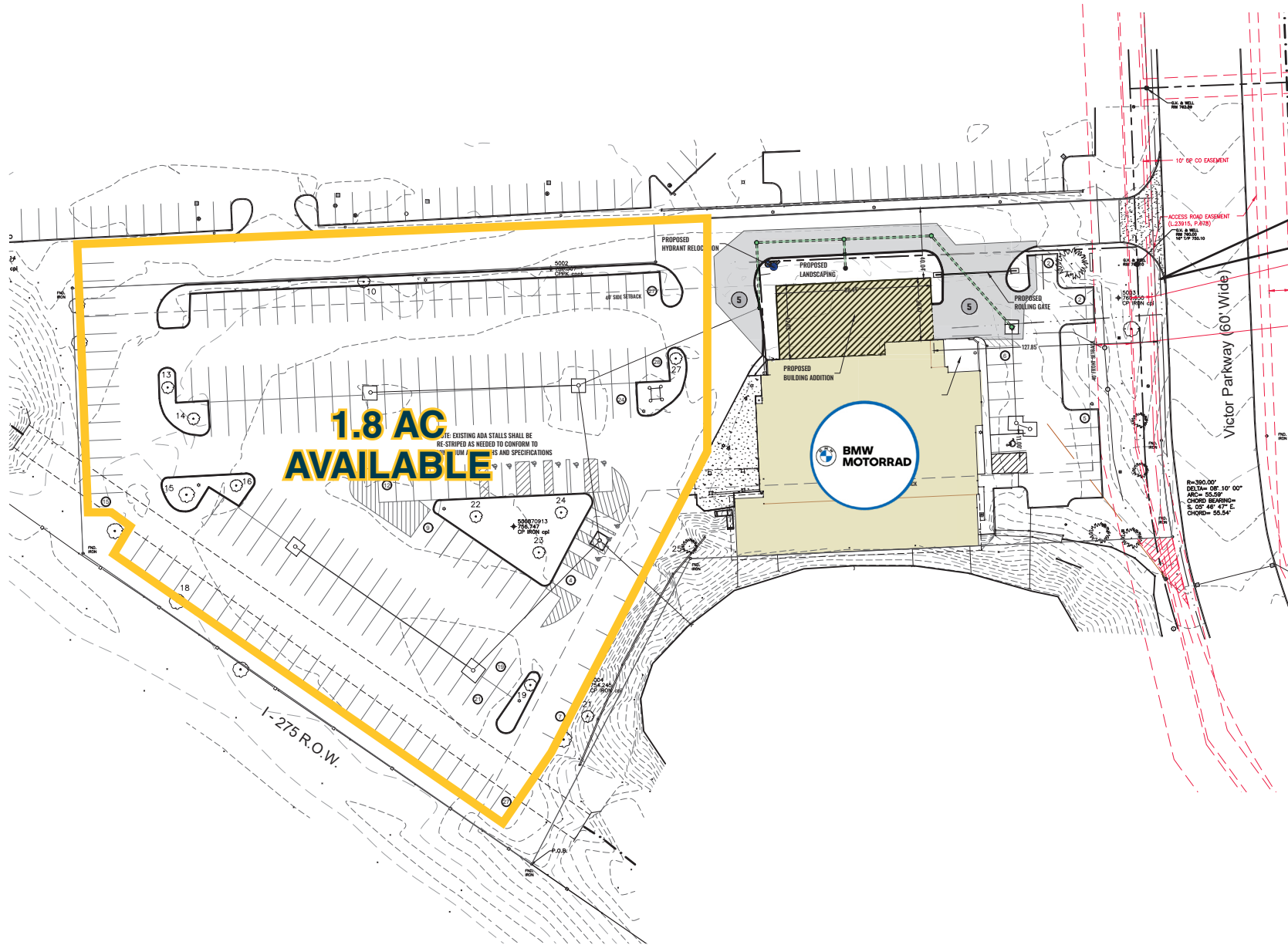

VICTOR CORPORATE PARK



LOW LEVEL AERIAL

VICTOR CORPORATE PARK



VICTOR CORPORATE PARK



Jared
Gell

Mid-America Real Estate -
Michigan, Inc.

T: 248.855.6800

JGell@MidAmericaGrp.com

In Cooperation With:

Steven Badgero

Vice President

T: 248.226.1812 | C: 248.408.5892

steven.badgero@colliers.com

400 W. 4th Street, Suite 350 | Royal Oak, MI 48067

www.colliers.com



MID-AMERICA®
Real Estate-Michigan, Inc.

38500 Woodward Ave, Suite 100
Bloomfield Hills, Michigan 48304
248.855.6800

MidAmericaGrp.com

CONTACT