

Bank of Hawaii Waikiki Center

2155 Kalakaua Avenue,
Honolulu, HI 96815

Property Overview

CBRE is pleased to present 1,242 square feet of sublease office space on the 4th floor at Bank of Hawaii Waikiki Center. The office features two private offices and a lounge/conference room.

Bank of Hawaii Waikiki Center is a nine-story Class A office building, located in the heart of Waikiki. The property is situated at the intersection of Kalakaua Avenue and Beach Walk. This premier location offers high visibility and convenient access to Waikiki.

The building amenities include a conference room, covered parking, EV charging stations, extended AC hours and 24-hour security. Notable tenants like Longs Drugs and Bank of Hawaii contribute to the building's convenience on the ground floor.

Extended Building Hours:

- + Monday through Friday 6:30 a.m. to 6:00 p.m.
- + Saturdays and Sundays 6:30 a.m. to 5:00 p.m.

Air Conditioning:

- + AC is provided on Holidays
- + Afterhours AC available at an hourly rate



Property Features

Suite Number	409
Size	1,242 RSF
Base Rent	Negotiable
Sublease Term	June 30th, 2027
OPEX	\$2.43/RSF/Month (2025)
Parking	2 Unreserved Stalls

Sublease Opportunity – Bank of Hawaii Waikiki Center

2155 Kalakaua Avenue | Honolulu, HI 96815

For Sublease

Floor Plan

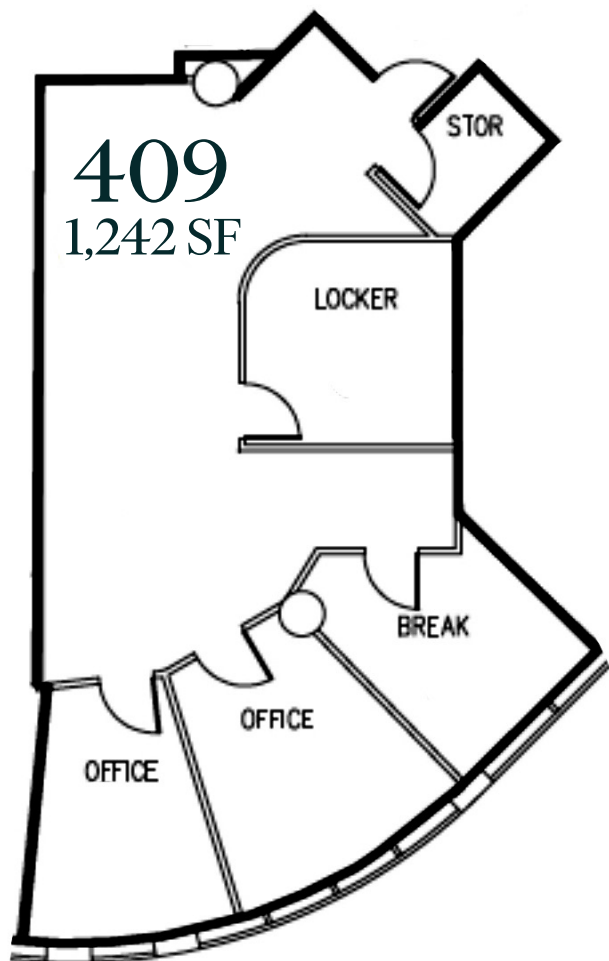

Location Map

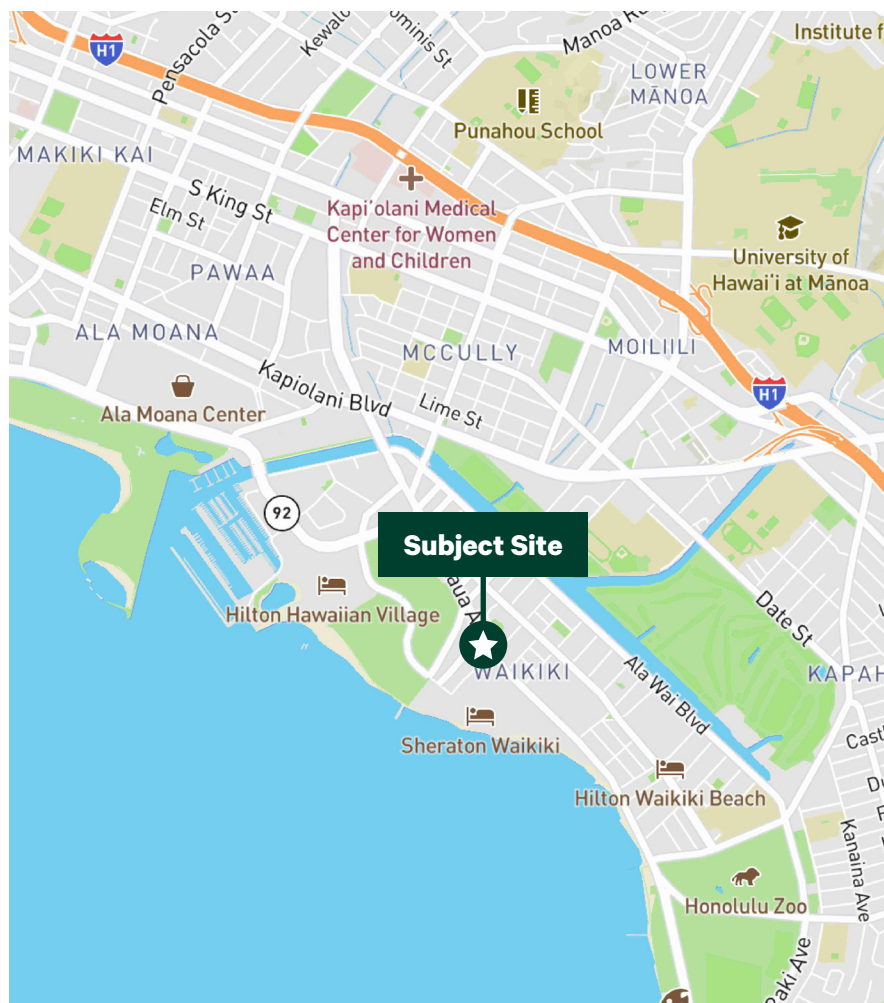

Contact Us

Serena C. Longo

First Vice President
+1 808 541 5181
serena.longo@cbre.com
Lic. RS-74888

Austin O'Leary

Associate
+1 808 541 5146
austin.oleary@cbre.com
Lic. RS-83544

© 2025 CBRE, Inc. All rights reserved. This information has been obtained from sources believed reliable, but has not been verified for accuracy or completeness. You should conduct a careful, independent investigation of the property and verify all information. Any reliance on this information is solely at your own risk. CBRE and the CBRE logo are service marks of CBRE, Inc. All other marks displayed on this document are the property of their respective owners, and the use of such logos does not imply any affiliation with or endorsement of CBRE. Photos herein are the property of their respective owners. Use of these images without the express written consent of the owner is prohibited.

AO:RMP_OF81_2155 Kalakaua Ave_10.08.25

www.cbre.com/hawaii

CBRE