

# Stratford Plaza

Prime Location Retail Center in Macomb Twp., MI



Commercial Real Estate Services  
Property Management  
Brokerage

51863 Schoenherr Road  
Suite 102, Shelby Township,  
MI 48315

Phone: 586-228-2232

Email:

Larry@hrgproperty.com

Jordan@hrgproperty.com

## General Information:

- 22000 23 Mile Road Macomb Twp  
(Southeast Corner 23 Mile Rd. & Card Road)
- Total Structure Size: 60,000 Square Feet
- Many new homes and growing neighborhoods in the area
- Great Location / High Visibility
- Generous # of Parking Spaces
- HIGH Traffic Volumes
- Current Tenants: Leo's Coney Island, Jet's Pizza, Benjamin Moore, Summit Urgent Care, Allstate and several others.

WEBSITE : [www.HRGproperty.com](http://www.HRGproperty.com)

# LEASE PLAN-OVERVIEW



Commercial Real Estate Services  
Property Management  
Brokerage

51863 Schoenherr Road  
Suite 102, Shelby Township,  
MI 48315

Phone: 586-228-2232

Email:  
Larry@hrgproperty.com  
Jordan@hrgproperty.com

## CARD ROAD

SUMMIT URGENT CARE
AMERICAN DRY CLEANERS
VIANA BRAZILIAN BEAUTY
ANIMAL HOSPITAL
LITTLE LEARNING CENTER
NUTRITION
SUSHI
GENESIS CHIROPRACTIC
RAEDENE'S DANCE STUDIO
GOLF SIMULATOR
ALLSTATE
SCOOP-N-TWIST
CHROMA SALON
VAPE
T.K.O.
CUP OF JOE
MATHNASIUM
<b>4,030 SQ FT AVAILABLE</b>

DOLLAR TREE

GREAT CLIPS  
HUNTINGTON BANK

23 MILE ROAD

**AVAILABLE 4,030 SQ FT**

REMEMBER WHEN
Jet's Pizza
China Gourmet
Stewie's Healthy Paws
Physical Therapy
TIFFANY'S TIPS & TOES
EASTERN MASSAGE
BENJAMIN MOORE PAINT
LEO'S CONEY ISLAND





# INTERIOR PHOTOS AND LAYOUT

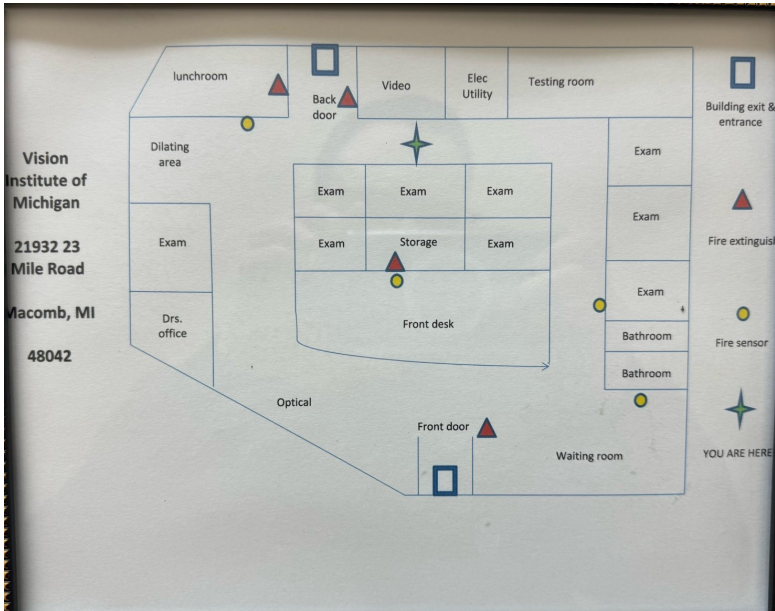



# MAPS



**Commercial Real Estate Services  
Property Management  
Brokerage**

**51863 Schoenherr Road  
Suite 102, Shelby Township,  
MI 48315**

**Phone: 586-228-2232**

**Email:  
Larry@hrgproperty.com  
Jordan@hrgproperty.com**

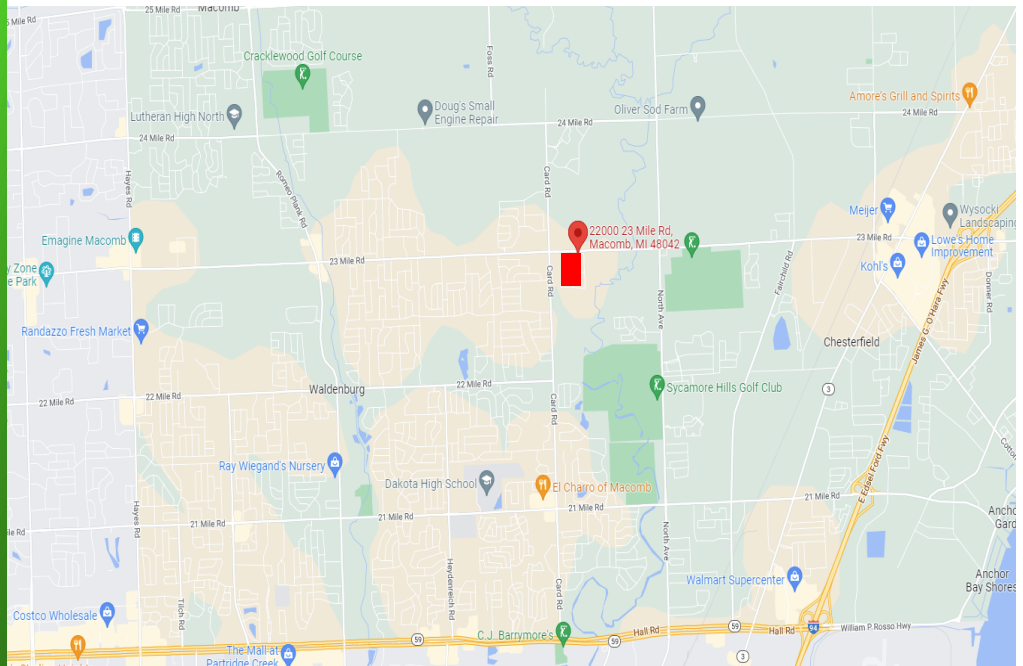

**WEBSITE : [www.HRGproperty.com](http://www.HRGproperty.com)**