

# Waterside Marketplace – Chesterfield Township (Detroit), MI

23 Mile Road & Interstate 94 Chesterfield Township, Michigan



- **Multiple NEW national tenant leases in all phases of center**
- **Available shops – 2,400 sf inline, 2,200 sf in OP, and 4,000 sf built out restaurant endcap**
- **Available anchor -28,000 sf former Bed Bath & Beyond**
- Significant retail center of gravity with **strong tenant sales** and additional junior anchor tenants interested in center
- High visibility to Interstate 94 with 80,000 vehicles per day at 23 Mile with 30,000 vehicles per day
- +550,000 SF including TJ Maxx, Burlington (2021 const), Aldi (2020 const), Old Navy, Ulta, Bed Bath & Beyond, Five Below, DSW (2015 const), JoAnn (2016 const), Best Buy, Dicks Sporting Goods, Lowes, JCP
- Solid and growing demographics plus tourism component from Anchor Bay access to Lake St. Clair and transient population from Selfridge Air National Guard base

### Demographic Overview:

	1 Mile	3 Mile	5 Mile
Population	7,100	44,000	101,000
Average HH Income	\$72,000	\$79,000	\$82,000
2017-2022 Growth	1.25%	2.50%	3.20%

PLEASE CONTACT BELOW FOR ADDITIONAL INFORMATION:

**Local Tenants - [Leasing@PMAT.net](mailto:Leasing@PMAT.net) or 202-780-PMAT (7628); National Tenants - [Kevin@PMAT.net](mailto:Kevin@PMAT.net)**

# Waterside Marketplace – Chesterfield Township (Detroit), MI

23 Mile Road & Interstate 94 Chesterfield Township, Michigan



PMAT Companies



**LAYOUT – 30,000 SF Freestanding Retail Space**

**LAYOUT – 7,500 SF & 6,500 SF Freestanding Restaurants**

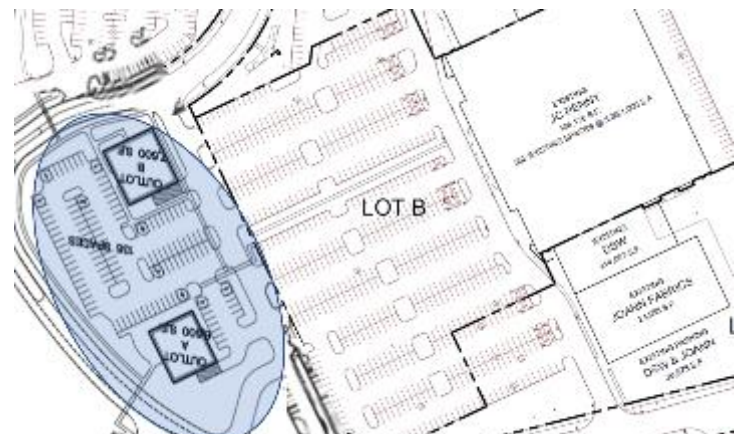
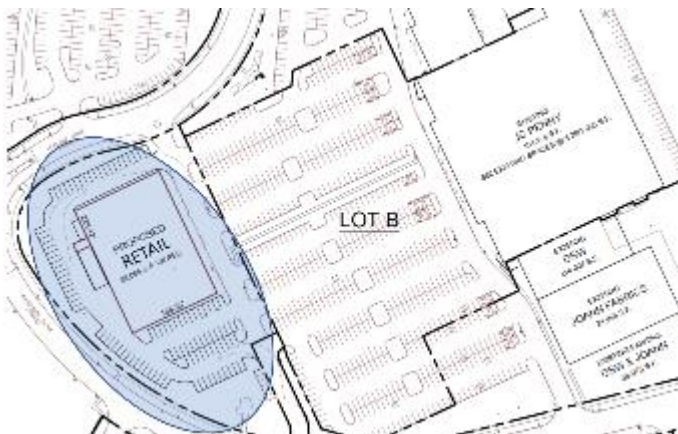

PLEASE CONTACT BELOW FOR ADDITIONAL INFORMATION:

Local Tenants - [Leasing@PMAT.net](mailto:Leasing@PMAT.net) or 202-780-PMAT (7628); National Tenants - [Kevin@PMAT.net](mailto:Kevin@PMAT.net)

# Waterside Marketplace – Chesterfield Township (Detroit), MI

23 Mile Road & Interstate 94 Chesterfield Township, Michigan

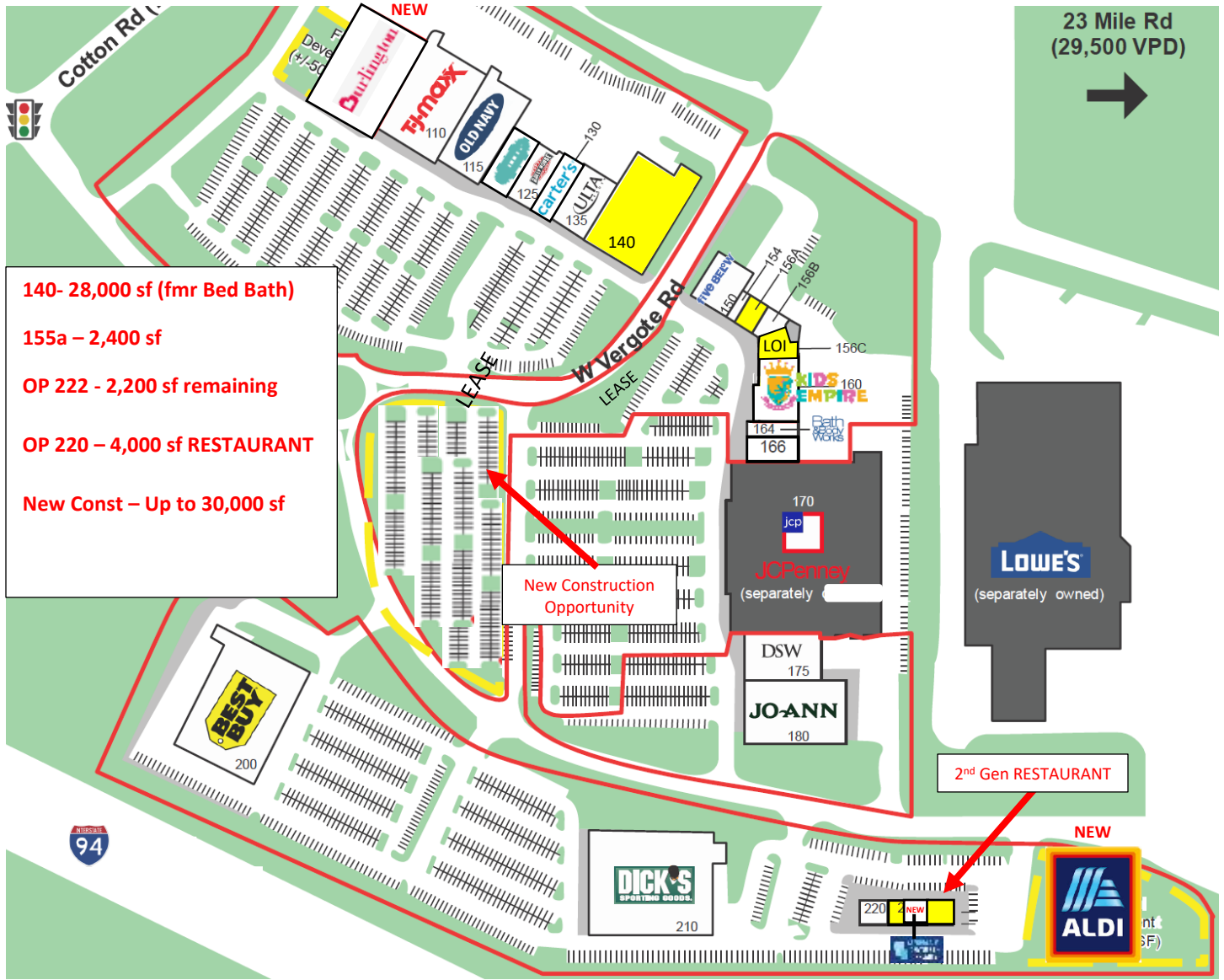

PLEASE CONTACT BELOW FOR ADDITIONAL INFORMATION:

Local Tenants - [Leasing@PMAT.net](mailto:Leasing@PMAT.net) or 202-780-PMAT (7628); National Tenants - [Kevin@PMAT.net](mailto:Kevin@PMAT.net)