

NOTES:
1) DESIGN AND DRAWINGS ARE BASED ON HUSSON-GRADING PLAN, PROJECT NO:17932, SHEET NO: SW1, REVISION 5, 23-03-27

2) STEPPING IN THE BASE AND TOP OF WALL ARE APPROXIMATE AND ARE TO BE VERIFIED (BY OTHERS) ON SITE DURING CONSTRUCTION
3) STATIONS AND ELEVATIONS ARE APPROXIMATE AND ARE TO BE VERIFIED (BY OTHERS) ON SITE PRIOR TO CONSTRUCTION
4) COPING UNITS AT CORNERS ARE TO BE MITRED ON SITE BY CONTRACTOR

RETAINING WALL QUANTITIES	
FACE AREA = 35.8 sq.m	
LENGTH = 35.8 m	
RETAINING WALL HEIGHT = 1.2 m	
DRAWING NO.	
LEGEND	
GRANDE 438	30 UNITS
GRANDE 375	60 UNITS
GRANDE 750	60 UNITS
GRANDE 1125	60 UNITS

WALL AT BLOCK E-A

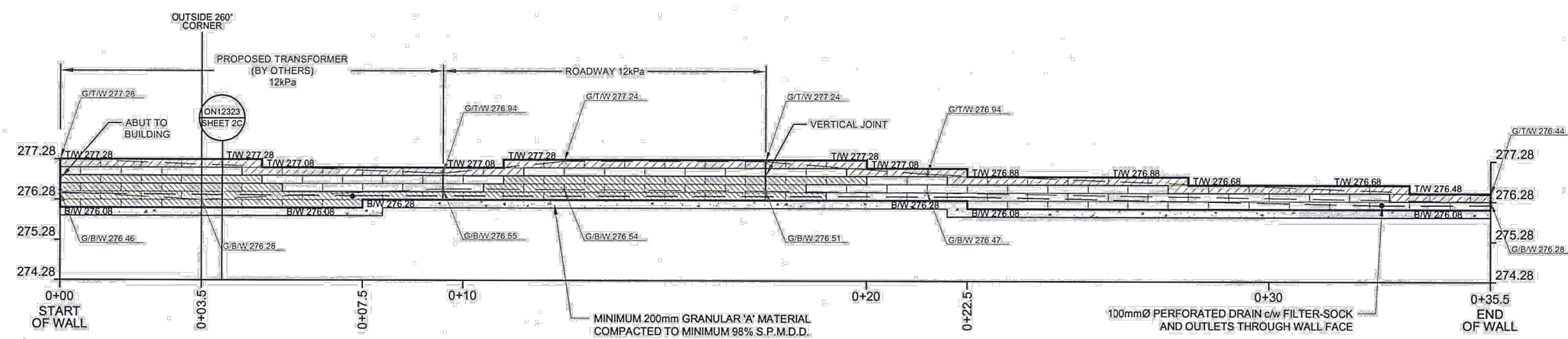

REV	DATE	DESCRIPTION	BY
1	2023-03-27	ISSUED FOR CONSTRUCTION	WTH
2	2023-03-27	ISSUED FOR CONSTRUCTION	WTH

DRAWING:	GRANDE Wall RETAINING WALL PROFILE WALL AT BLOCK E-A
PROJECT:	DAVIS DRIVE DEVELOPMENT 1015 DAVIS DRIVE NEWMARKET, ONTARIO
PROJECT ENGINEER:	HUSSON

GRANDE® Wall
PERMACON
A CRH COMPANY

DESIGN ENGINEER:	Peto MacCallum Ltd. CONSULTING ENGINEERS
DRAWN BY:	MTP
CHKD BY:	gk
DATE:	May 23, 2023
SCALE:	1:125
FILE NAME:	ON12323-1.DWG
DRAWING No.:	ON12323 SHEET 1B

NOTE:
TO REDUCE THE POTENTIAL FOR STAINING OF THE RETAINING WALL FACE, PRE-WET ENTIRE BLOCK FACE AREA PRIOR TO CORING. WASH ENTIRE AREA IMMEDIATELY AFTER CORING

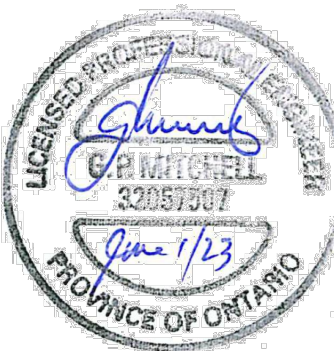
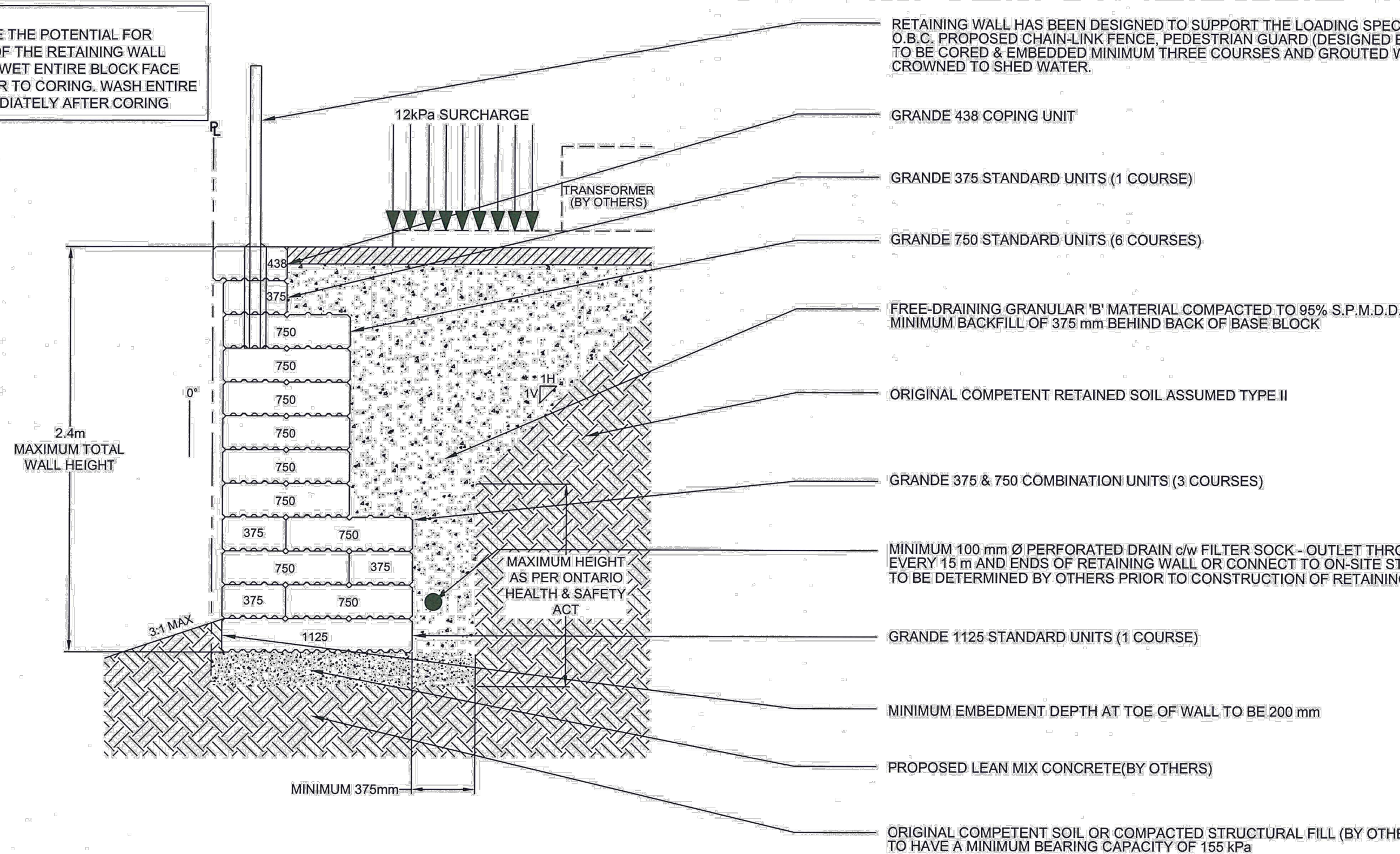

REV	DATE	DESCRIPTION	BY
1	2023-03-27	ISSUED FOR CONSTRUCTION	WTH
2	2023-03-27	ISSUED FOR CONSTRUCTION	WTH

DRAWING:	GRANDE Wall MAXIMUM CROSS SECTION NORTH WALL
PROJECT:	DAVIS DRIVE DEVELOPMENT 1015 DAVIS DRIVE NEWMARKET, ONTARIO
PROJECT ENGINEER:	HUSSON ENGINEERING

GRANDE® Wall
PERMACON
A CRH COMPANY

DESIGN ENGINEER:	Peto MacCallum Ltd. CONSULTING ENGINEERS
DRAWN BY:	DAD
CHKD BY:	gk
DATE:	April 24, 2023
SCALE:	NOT TO SCALE
FILE NAME:	ON12323-2.dwg
DRAWING No.:	ON12323 SHEET 2A

PROPOSED 1.8m HIGH WOOD FENCE (DESIGNED BY OTHERS) AS PER THE O.B.C. TO BE PLACED IN CONCRETE FILLED SONOTUBES BEHIND WALL. SONOTUBE TO EXTEND 500mm MIN. BEYOND BOTTOM OF WALL. BACKFILL AND COMPACT WITH SAND AS SHOWN.

NOTE:
TO REDUCE THE POTENTIAL FOR STAINING OF THE RETAINING WALL FACE, PRE-WET ENTIRE BLOCK FACE AREA PRIOR TO CORING. WASH ENTIRE AREA IMMEDIATELY AFTER CORING

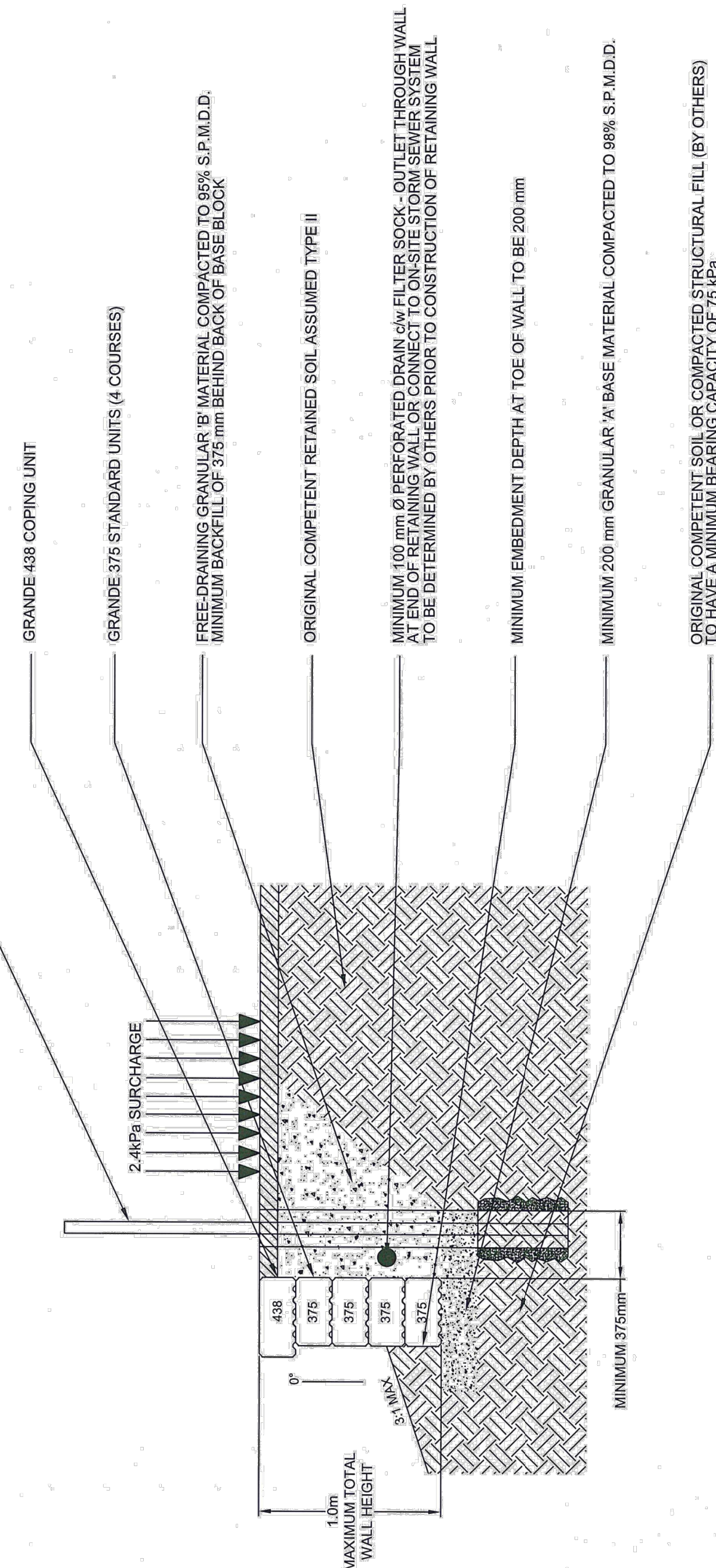

DESIGN ENGINEER:	Peto MacCallum Ltd. CONSULTING ENGINEERS
DRAWN BY:	CHKD BY:
DAD	gk
DATE:	April 24, 2023
SCALE:	NOT TO SCALE
FILE NAME:	ON12323-2.dwg
DRAWING No.:	ON12323 SHEET 2B

GRANDE® Wall
PERMACON
A CRH COMPANY

DRAWING:	GRANDE Wall MAXIMUM CROSS SECTION WALL AT BLOCK D
PROJECT:	DAVIS DRIVE DEVELOPMENT 1015 DAVIS DRIVE NEWMARKET, ONTARIO
PROJECT ENGINEER:	HUSSON ENGINEERING

REV	DATE	DESCRIPTION	BY
1	2023-03-27	ISSUED FOR CONSTRUCTION	DAD
2	2023-03-27	ISSUED FOR CONSTRUCTION	DAD

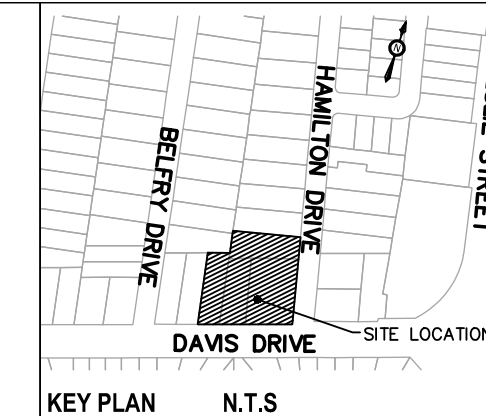
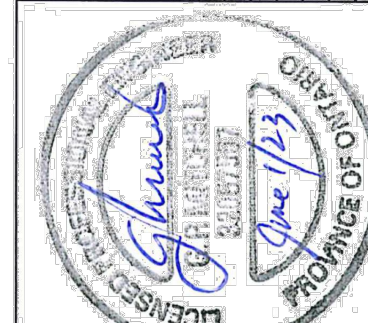

LEGEND:

BENCHMARK:
ELEVATIONS ARE GEODETIC AND ARE REFERRED TO YORK REGION BM NO.8
ELEVATION: 262.50m
DESCRIPTION: NO.826 DAVIS DRIVE, TABLET SET HORIZONTALLY IN EAST WALL, 7.3m S OF NE CORNER AND 0.3m ABOVE GROUND LEVEL.

REV. NO.	REVISION NOTE	DATE
5	ISSUED FOR SPA	23-06-12
4	ISSUED FOR SCOPED GRA/2BA	22-11-11
3	ISSUED FOR SITE PLAN APPLICATION	21-11-26
2	ISSUED FOR REZONING	20-08-21
1	ISSUED FOR SITE PLAN APPLICATION	18-10-05



APPLICATION FOR OFFICIAL PLAN
AMENDMENT & ZONING BY-LAW
AMENDMENT

1015, 1025, 1029 DAVIS DRIVE, 22 HAMILTON
DRIVE
TOWN OF NEWMARKET



SCALE	1:200
OWNER NAME	LULU HOLDINGS INC.
DATE	JUNE 12, 2023

SHEET NAME
PERMACON DETAILS