

For Lease

Industrial Facility

7450 E 46th St Tulsa, OK 74145

WIGGIN
PROPERTIES, LLC



Property Features

- Total SF \pm 3,680 SF
 - \pm 1,562 SF Office
- Office area includes reception area, large open showroom/sales floor, (3) private offices, (2) restrooms
- (1) 12' x 12' Overhead Door
- Partially Climate Controlled
- LED Lighting
- 14.5' to the Red Irons
- 16' Clear Height
- 225 Amp 240 Volt 3-Phase Power
- Small Fenced Yard
- Zoned IL

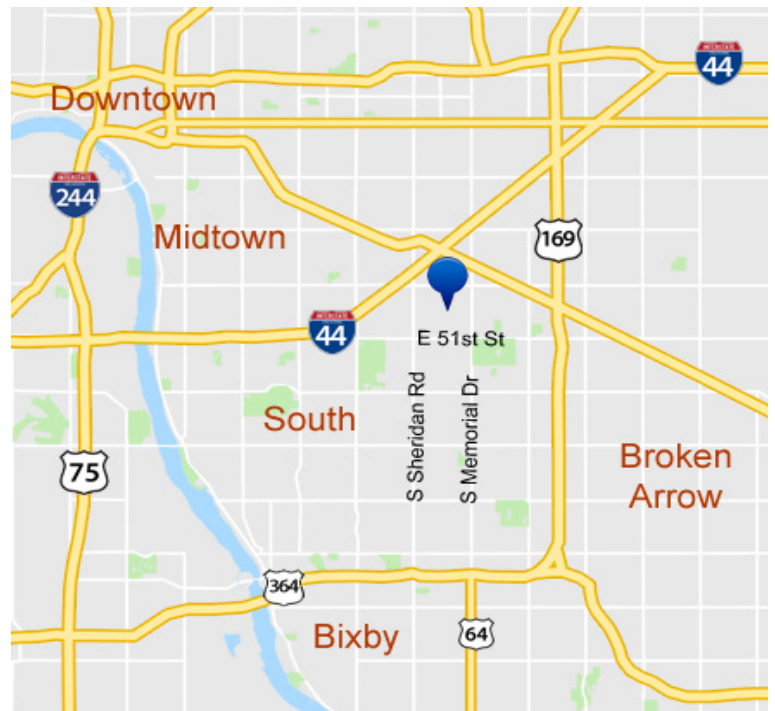

Call Shawna Hale, CCIM at 918.282.8664 or John Watchous at 918.991.8519

shale@wiginprop.com | jwatchous@wiginprop.com | wiginprop.com

This material is provided for information purposes only. It is from sources believed to be reliable. However, Wiggin Properties makes no warranties or representations, expressed or implied, as to the accuracy or sufficiency of the information. It is presented subject to errors, omissions, changes or withdrawal without notice. Square footage is provided by the local County Assessor or the Owner. Photos and graphics with copyrights by Costar, Google, Wiggin Properties and independent contractors are used with permission.

For Lease

Industrial Facility

7450 E 46th St Tulsa, OK 74145

WIGGIN
PROPERTIES, LLC

Floor Plan

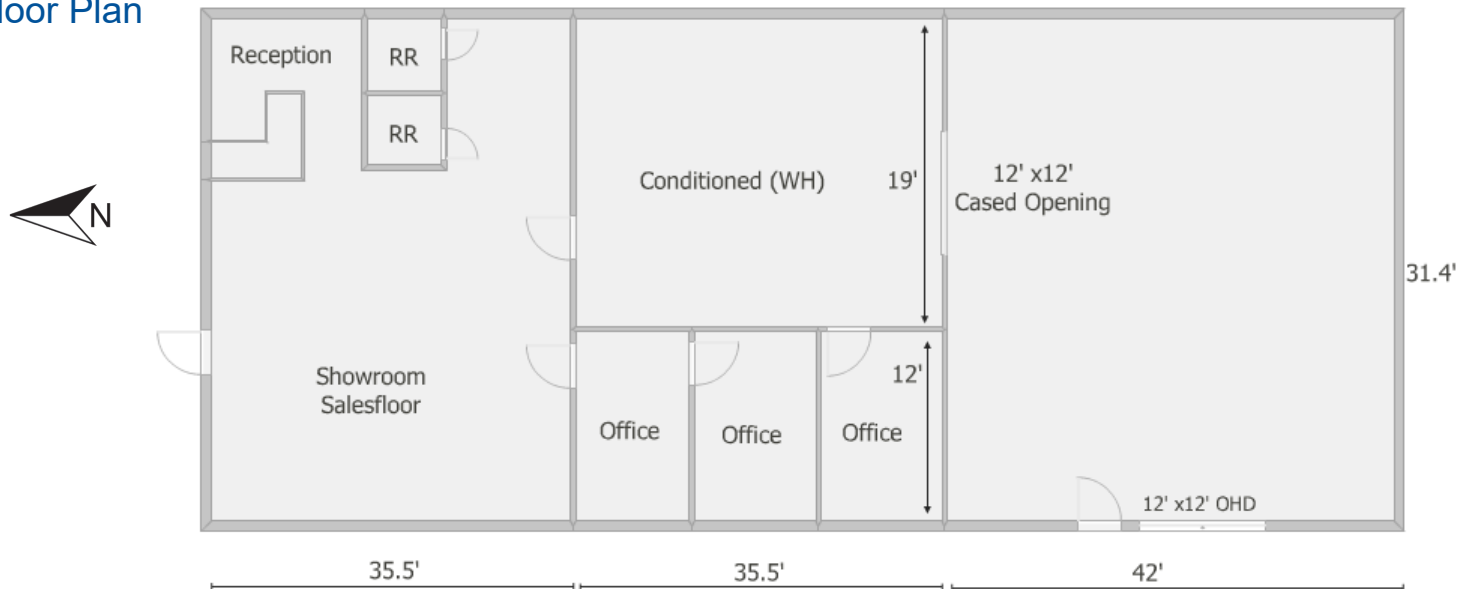

Call Shawna Hale, CCIM at 918.282.8664 or John Watchous at 918.991.8519

shale@wigginprop.com | jwatchous@wigginprop.com | wigginprop.com

This material is provided for information purposes only. It is from sources believed to be reliable. However, Wiggin Properties makes no warranties or representations, expressed or implied, as to the accuracy or sufficiency of the information. It is presented subject to errors, omissions, changes or withdrawal without notice. Square footage is provided by the local County Assessor or the Owner. Photos and graphics with copyrights by Costar, Google, Wiggin Properties and independent contractors are used with permission.