

FOR SALE

5810 & 5822 NE SKYPORT WAY
PORTLAND, OR

PRICE REDUCTION!
(NOW ONLY \$170/SF)

5810

BUILDING SIZE

39,486 SF

LIST PRICE

\$6,712,620

(\$170/SF)

5822

BUILDING SIZE

63,916 SF

LIST PRICE

\$10,865,720

(\$170/SF)

TWO ADJOINING PROPERTIES

MINUTES FROM I-205, PDX, AND NE
PORTLAND BUSINESS CORRIDORS

HEAVY POWER FOR MANUFACTURING-READY
OPERATIONS

IDEAL FOR OWNER-USER WITH ADJACENT
EXPANSION OPPORTUNITY



WRIGHT COMMERCIAL
REAL ESTATE SERVICES

CONTACT

WILL WRIGHT

503-335-3300

will@wrightcommercial.com

ERIC ZIEGLER

503-583-7519

eric@wrightcommercial.com

PROPERTY DETAILS

5810 NE SKYPORT WAY

TOTAL BUILDING SIZE 39,486 SF

OFFICE 5,171 SF (13%)
SINGLE-STORY

LOT SIZE 2.06 ACRES

SALE PRICE \$6,712,620.00

ZONING IG-2 (GENERAL INDUSTRIAL 2)

PROPERTY TYPE INDUSTRIAL

CONSTRUCTION CONCRETE TILT-UP

CLEAR HEIGHT 19 FT

LOADING 5 DOCK-LEVEL DOORS
1 GRADE-LEVEL DOOR

POWER 3,200 AMPS TOTAL
120/208V 3-PHASE

SPRINKLERS WET SYSTEM

PARKING 40 SPACES

COLUMN SPACING N TO S: 25'
E TO W: 47'

UPGRADES NEW ROOF (2022)

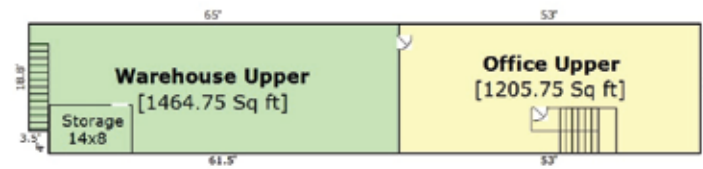



5810 NE SKYPORT WAY



WRIGHT COMMERCIAL
REAL ESTATE SERVICES

PORTLAND, OREGON

PROPERTY DETAILS

5822 NE SKYPORT WAY

TOTAL BUILDING SIZE	63,916 SF
OFFICE	6,750 SF (11%)
LOT SIZE	2.6 ACRES
SALE PRICE	\$10,865,720.00
ZONING	IG-2 (GENERAL INDUSTRIAL 2)
PROPERTY TYPE	INDUSTRIAL
CONSTRUCTION	CONCRETE TILT-UP
CLEAR HEIGHT	21 FT 6 IN
LOADING	6 DOCK-LEVEL DOORS 1 GRADE-LEVEL DOOR
SPRINKLERS	WET SYSTEM
PARKING	30 SPACES
COLUMN SPACING	N TO S: 40' E TO W: 50'
POWER	4,000 AMPS TOTAL 120/208V 3-PHASE 240/480V TRANSFORMER

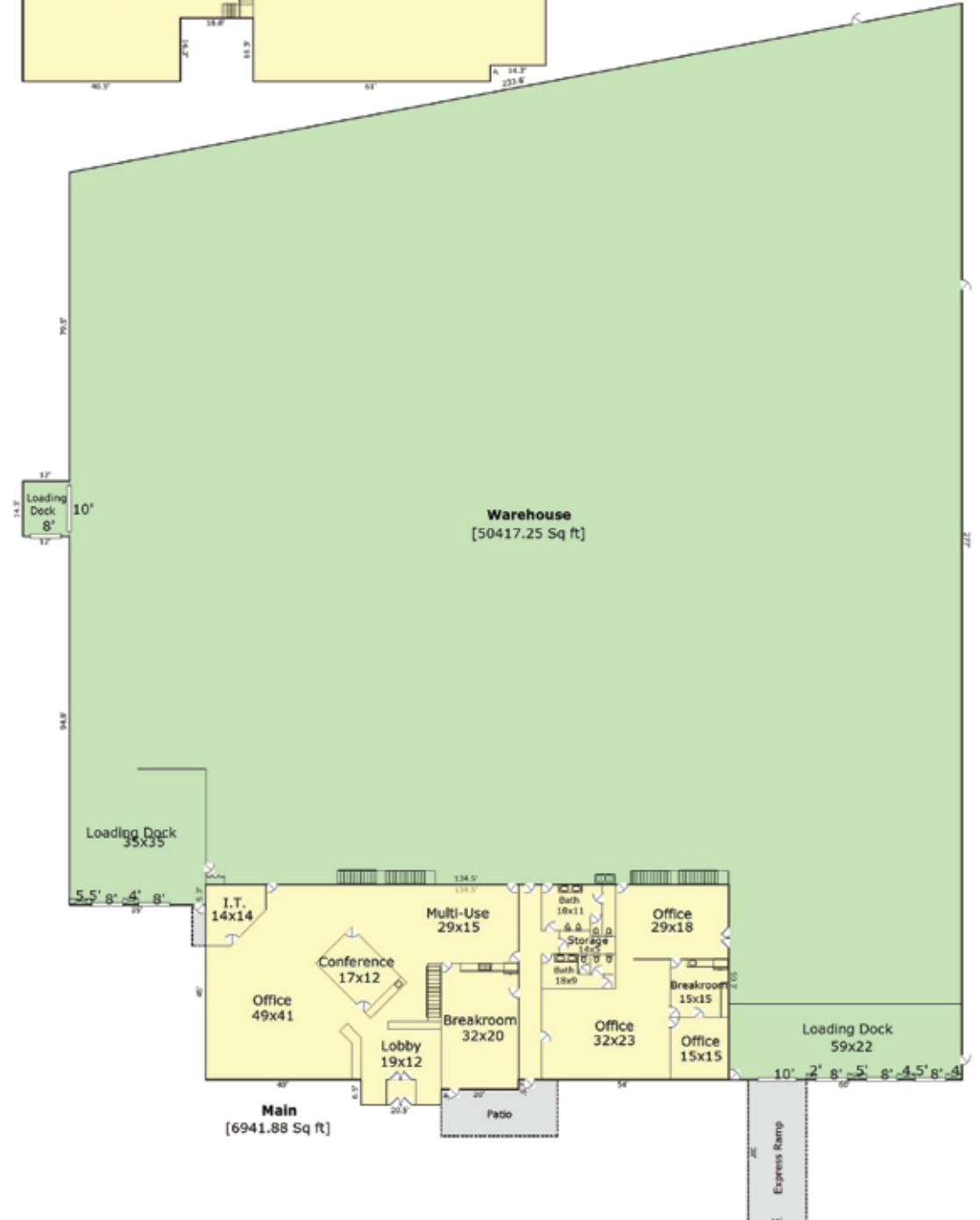



WRIGHT COMMERCIAL
REAL ESTATE SERVICES

5822 NE SKYPORT WAY

PORTLAND, OREGON

CONVENIENT NORTHEAST PORTLAND LOCATION

5810 & 5822 NE SKYPORT WAY | PORTLAND, OR



PORTLAND
INTERNAT'L
AIRPORT



809 N. RUSSELL STREET SUITE 201
PORTLAND, OR 97227
503-335-3300
wrightcommercial.com



WRIGHT COMMERCIAL
REAL ESTATE SERVICES

CONTACT

WILL WRIGHT
503-335-3300
will@wrightcommercial.com

ERIC ZIEGLER
503-583-7519
eric@wrightcommercial.com