

2200 WILLIAM D TATE AVE

Grapevine, TX 76051

Industrial For Lease

181,322 SF



Leasing Information:
214.740.3300

Michael Peinado
214.740.3356
mpeinado@lpc.com

Gil Stroube
214.740.3427
gstroube@lpc.com

Tom Kuhlmann
214.740.3363
tkuhlmann@lpc.com

Doak Dozier
214.740.3574
ddozier@lpc.com

Lincoln

Lincoln Property Company
8111 Douglas Avenue
Dallas, TX 75225

www.lpc.com

2200 WILLIAM D TATE AVE

Grapevine, TX 76051

Industrial For Lease



Property Highlights

- 24' Clear Height
- 100% HVAC
- 7% office
- Eight (8) 9' x 10' Dock High Doors
- One (1) Drive in Door
- 130' Truck Court
- 42' x 42' column spacing
- +/- 435 Parking Spaces
- ESFR Sprinkler
- 3200 amps, 480V service (Tenant to field verify)

Availabilities

100

SF

181,322 SF

Lease Rate

\$9.50 NNN

Date Available

11/1/2024

Michael Peinado

214.740.3356
mpeinado@lpc.com

Gil Stroube

214.740.3427
gstroube@lpc.com

Tom Kuhlmann

214.740.3363
tkuhlmann@lpc.com

Doak Dozier

214.740.3574
ddozier@lpc.com

Lincoln

2200 WILLIAM D TATE AVE

Site Plan

Grapevine, TX 76051

2200 William D Tate

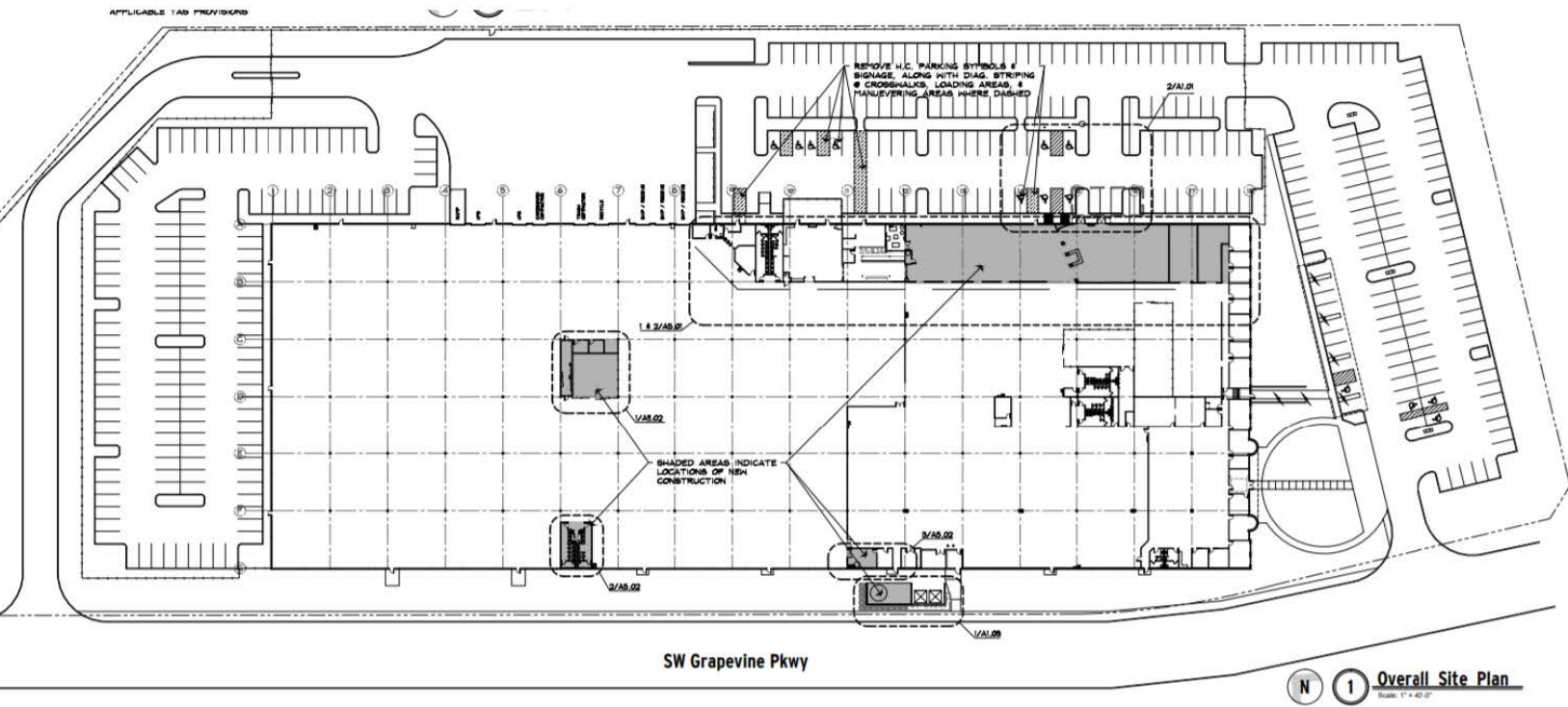

Suite	Size	Lease Rate	Description
100	181,322 SF	\$9.50 NNN	-

Michael Peinado
214.740.3356
mpeinado@lpc.com

Gil Stroube
214.740.3427
gstroube@lpc.com

Tom Kuhlmann
214.740.3363
tkuhlmann@lpc.com

Doak Dozier
214.740.3574
ddozier@lpc.com

Lincoln

2200 WILLIAM D TATE AVE

Location Map

Grapevine, TX 76051

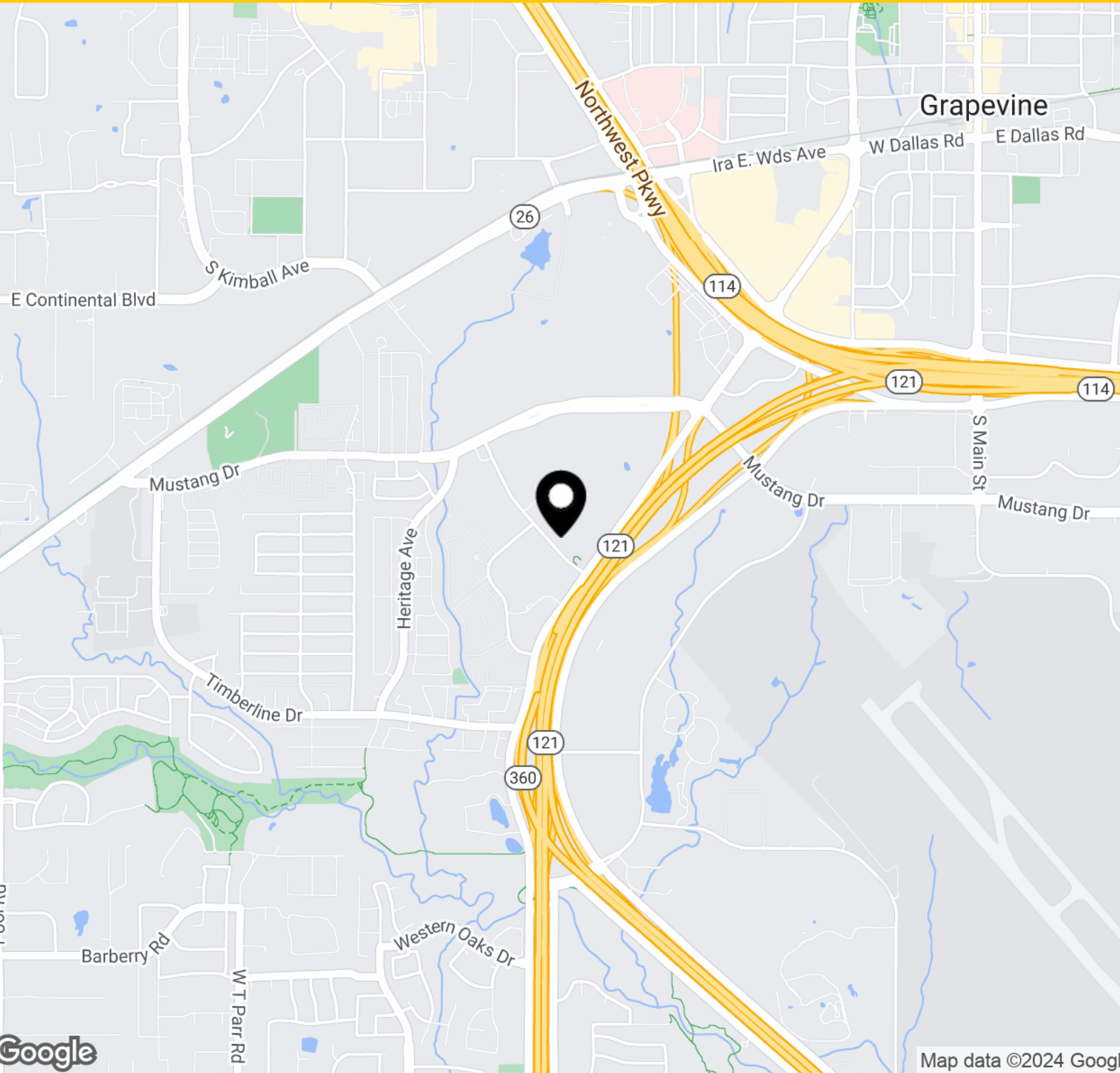

Michael Peinado
214.740.3356
mpeinado@lpc.com

Gil Stroube
214.740.3427
gstroube@lpc.com

Tom Kuhlmann
214.740.3363
tkuhlmann@lpc.com

Doak Dozier
214.740.3574
ddozier@lpc.com

Lincoln



2200 WILLIAM D TATE AVE

Grapevine, TX 76051

Leasing Information:
214.740.3300

Michael Peinado
214.740.3356
mpeinado@lpc.com

Gil Stroube
214.740.3427
gstroube@lpc.com

Tom Kuhlmann
214.740.3363
tkuhlmann@lpc.com

Doak Dozier
214.740.3574
ddozier@lpc.com

Lincoln

Lincoln Property Company
8111 Douglas Avenue
Dallas, TX 75225

www.lpc.com