



# 343 GODSHALL DRIVE HARLEYSVILLE, PA

## 14,501 SF FLEX INDUSTRIAL SPACE AVAILABLE FOR LEASE

- 2 natural gas generators on site
- Excellent signage opportunity along Route 63
- Abundant parking
- Fully conditioned space
- 14 x 12 drive in door
- 100% sprinklered
- 600 SF office space
- 2 restrooms
- Available February 2025
- 18 ft. Clear height
- Zoned light industrial, Lower Salford Township

The  
Flynn  
Company



**MICHAEL BORSKI, JR., SIOR**  
MBORSKIJR@FLYNNCO.COM  
215-561-6565 X 1119



**MARK PAWLOWSKI**  
MPAWLOWSKI@FLYNNCO.COM  
215-561-6565 X 118



**KEVIN FLYNN, JR.**  
KFLYNNJR@FLYNNCO.COM  
215-561-6565 X 121

THE FLYNN COMPANY

WWW.FLYNNCO.COM | 1621 WOOD STREET, PHILADELPHIA, PA 19103 | 215.561.6565

# FLOOR PLAN

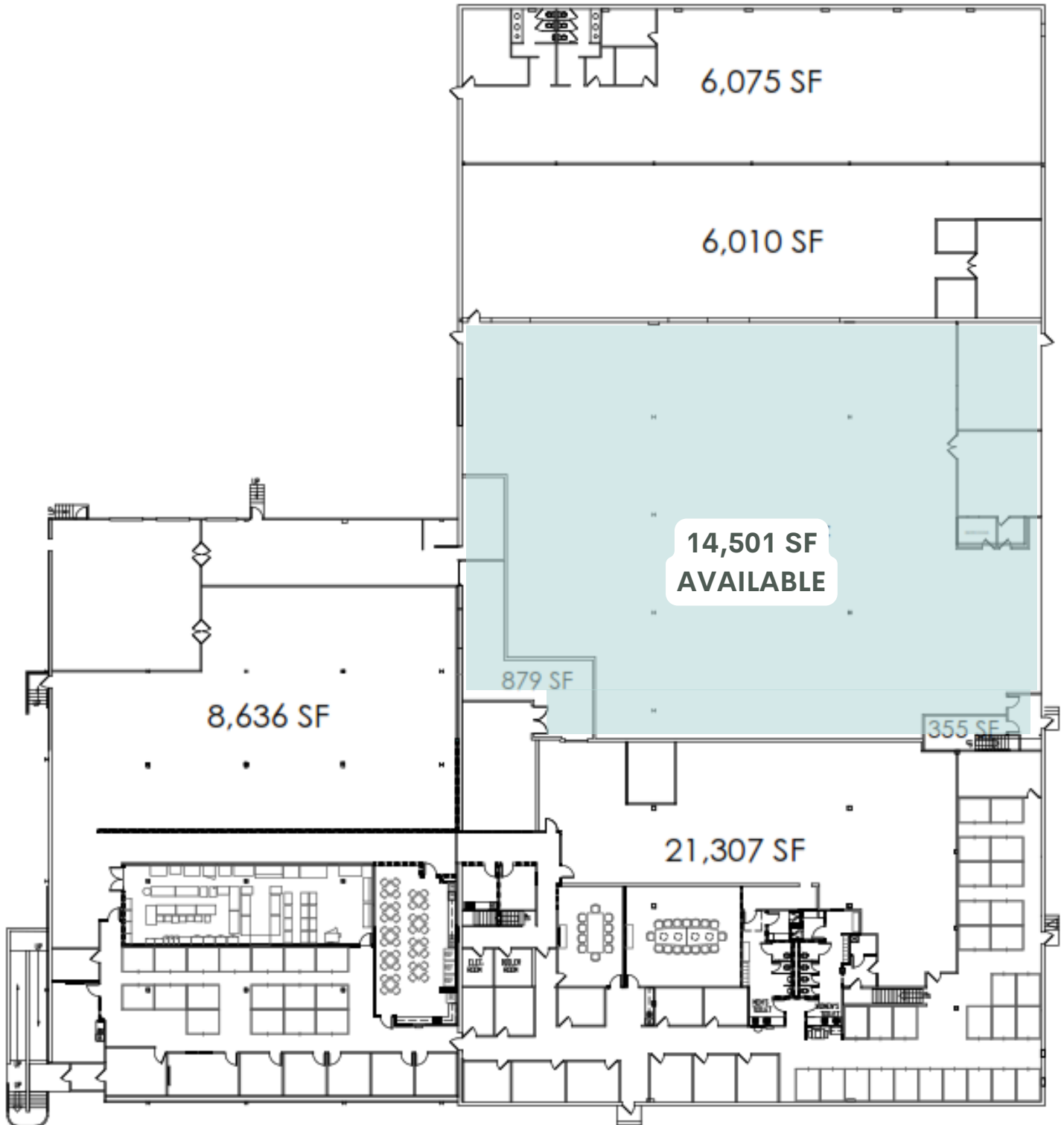



# PROPERTY PHOTOS





# LOCATION

