



# IRONWOOD

COMMERCE CENTER

[IRONWOOD.CBRE-PROPERTIES.COM](http://IRONWOOD.CBRE-PROPERTIES.COM)

## Move-In Ready Options

*Available Immediately*



***Buildings 1 & 2***

12700 NW Le Jeune Road, Opa-Locka, FL 33054

**CBRE**

**TA REALTY**



# Property Highlights

Ironwood Commerce Center is the newest industrial park in the Central Dade submarket of Miami. Ironwood Commerce Center includes four buildings, totaling ±505,440 SF.



**Total SF:**  
±505,440



**Clear Height:**  
32'



**Loading:**  
Bldgs 1-3 Rear loading  
Bldg 4 Front loading



**Column Spacing:**  
54'



**Lighting:**  
LED



**Parking:**  
492 spaces



**Acreage:**  
28.31

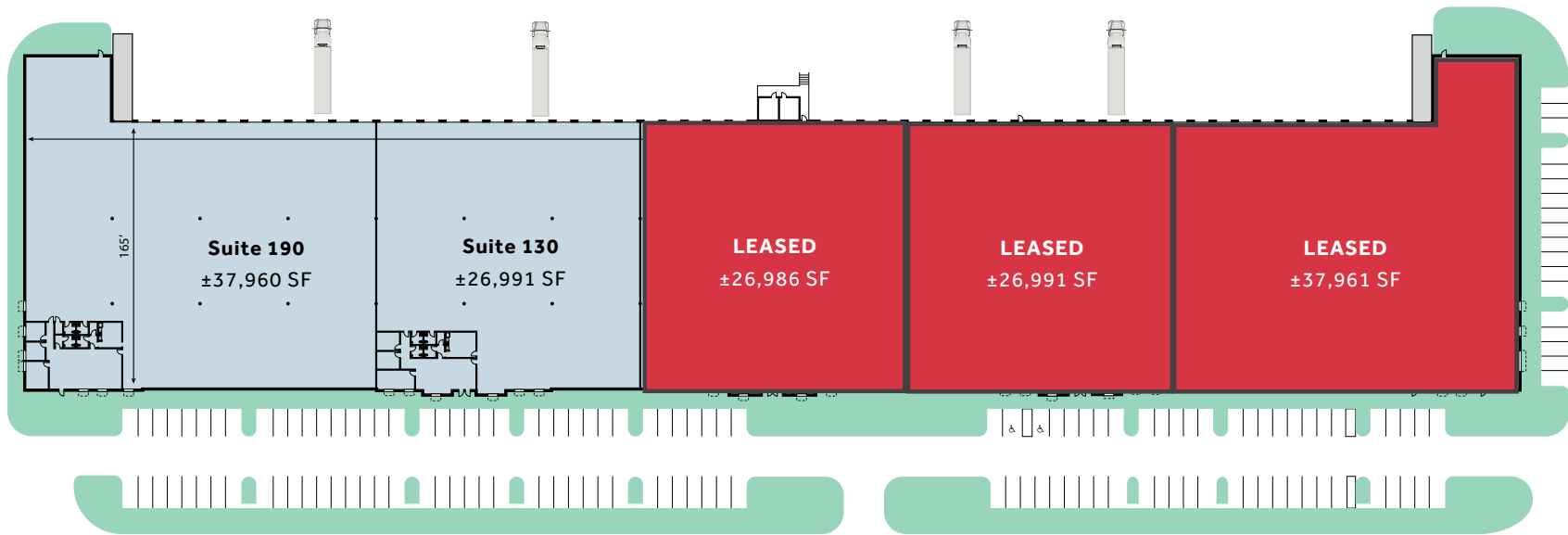

## Building 1 Availability

	SUITE 190	SUITE 130
<b>Total SF</b>	±37,960 SF	±26,991 SF
<b>Warehouse SF</b>	±35,416 SF	±24,711 SF
<b>Office SF</b>	±2,544 SF	±2,280 SF
<b>Clear Height</b>	32'	32'
<b>Loading</b>	11 dock positions, 1 ramp	12 dock positions
<b>Car Parking</b>	1.02/1,000	1.02/1,000
<b>Building Depth</b>	165'	165'
<b>Available</b>	Immediately	Immediately
<b>2026 OpEx</b>	\$5.05 PSF	\$5.05 PSF

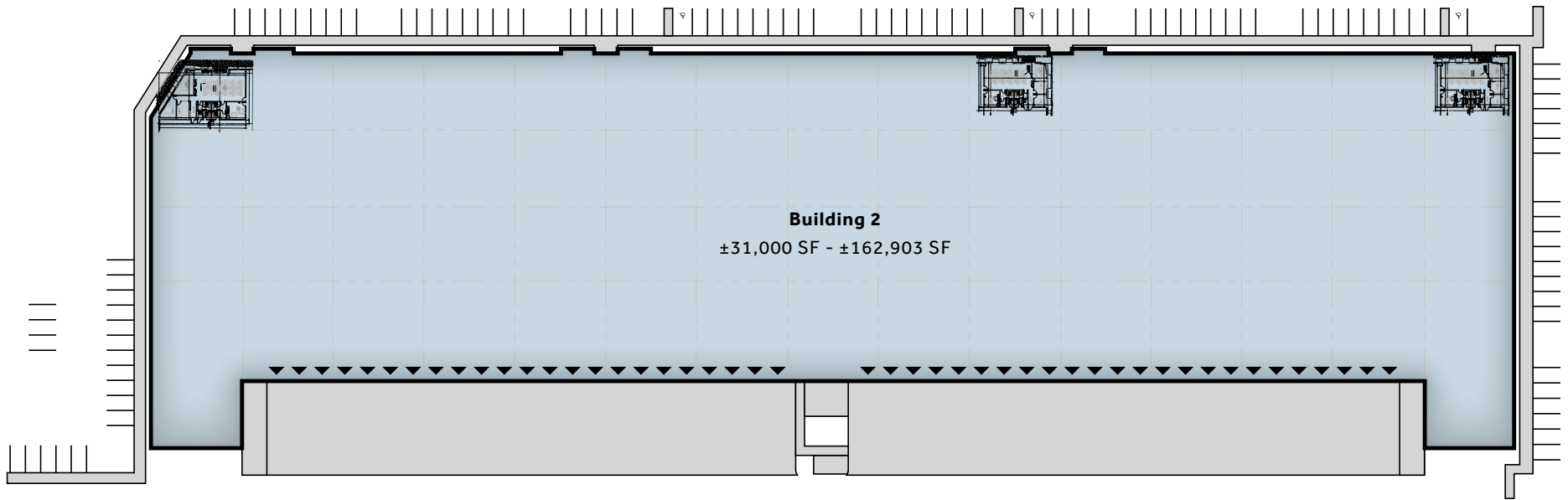

## Building 2 Availabilities

Total SF	±162,903 SF
Minimum Divisible	±31,000 SF
Office SF	±2,500 SF
Clear Height	32'
Loading	47 dock positions, 2 ramps
Car Parking	0.95/1,000
Building Depth	195'
Available	February 2026
2026 OpEx	\$5.05 PSF





# IRONWOOD

COMMERCE CENTER

[IRONWOOD.CBRE-PROPERTIES.COM](http://IRONWOOD.CBRE-PROPERTIES.COM)

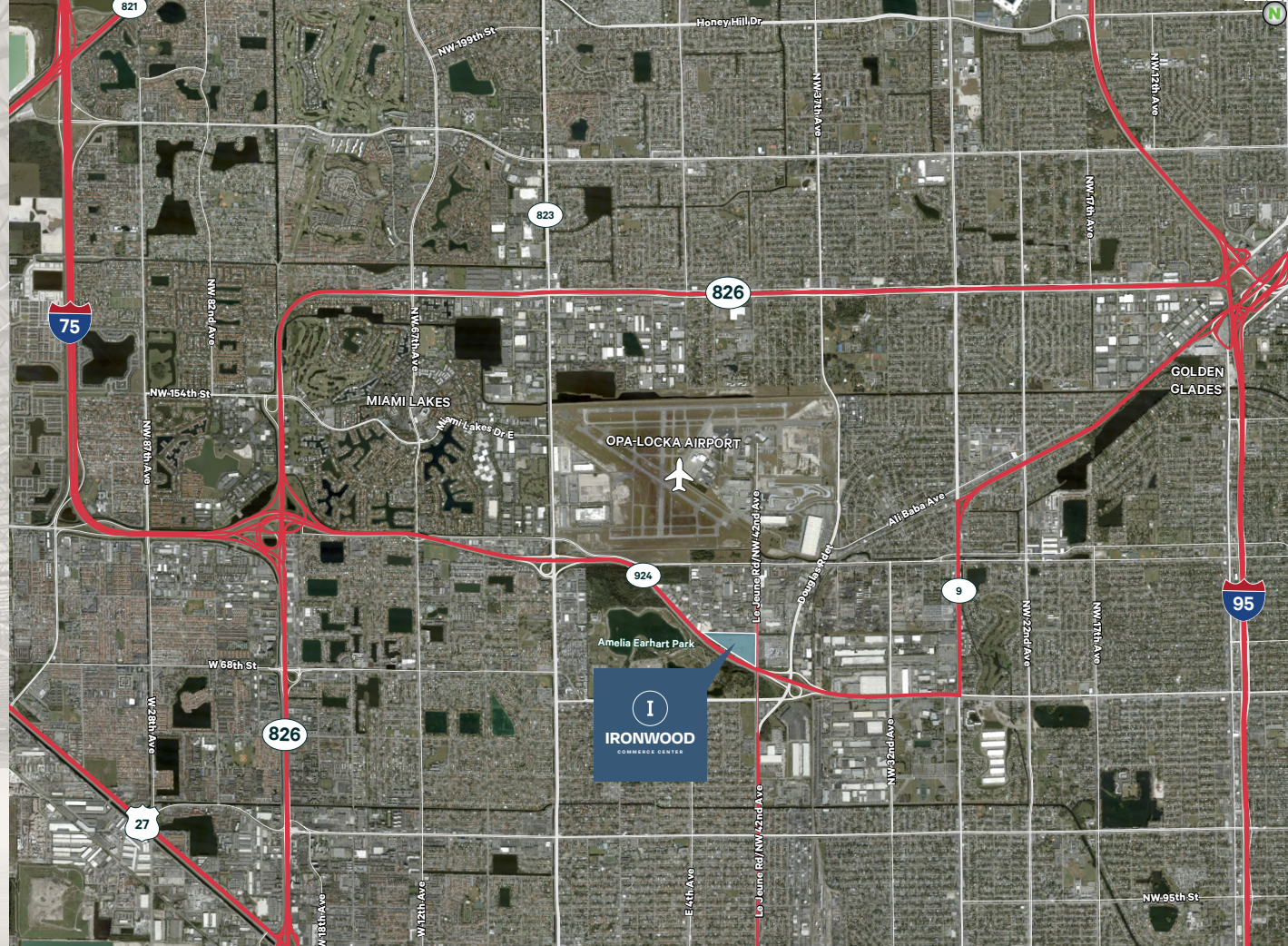

**Devin White**  
*Executive Vice President*  
+1 305 381 6409  
[devin.white@cbre.com](mailto:devin.white@cbre.com)

**David Albert**  
*Executive Vice President*  
+1 305 381 6474  
[david.albert@cbre.com](mailto:david.albert@cbre.com)

**CBRE**

**TA REALTY**