

BEREWICK MEDICAL DEVELOPMENT

BEREWICK TOWN CENTER DRIVE
CHARLOTTE | NORTH CAROLINA



WILL ROBERTSON
704-996-5824
will@FlagshipHP.com

GREG MCINTOSH
704-562-2153
greg@FlagshipHP.com

AVAILABLE Q3 2025

PROPERTY OVERVIEW

PROPERTY OVERVIEW

Berewick Medical Development will be located near the intersection of Highway 160 and Dixie River Road, in the ever expanding area of Southwest Charlotte.

Nearby amenities are abound with the Charlotte Premium Outlets, Whitehall Commons, Rivergate, and numerous other shopping centers in close proximity.



CONTACT:

WILL ROBERTSON
704-996-5824
will@FlagshipHP.com

GREG MCINTOSH
704-562-2153
greg@FlagshipHP.com



AVAILABLE SPACE:
±5,000 SF



LEASE RATE:
\$40.00/SF



LEASE TYPE:
NNN



PARKING RATIO:
5.00/1,000 SF



DELIVERY:
Q3, 2025

SITE PLAN

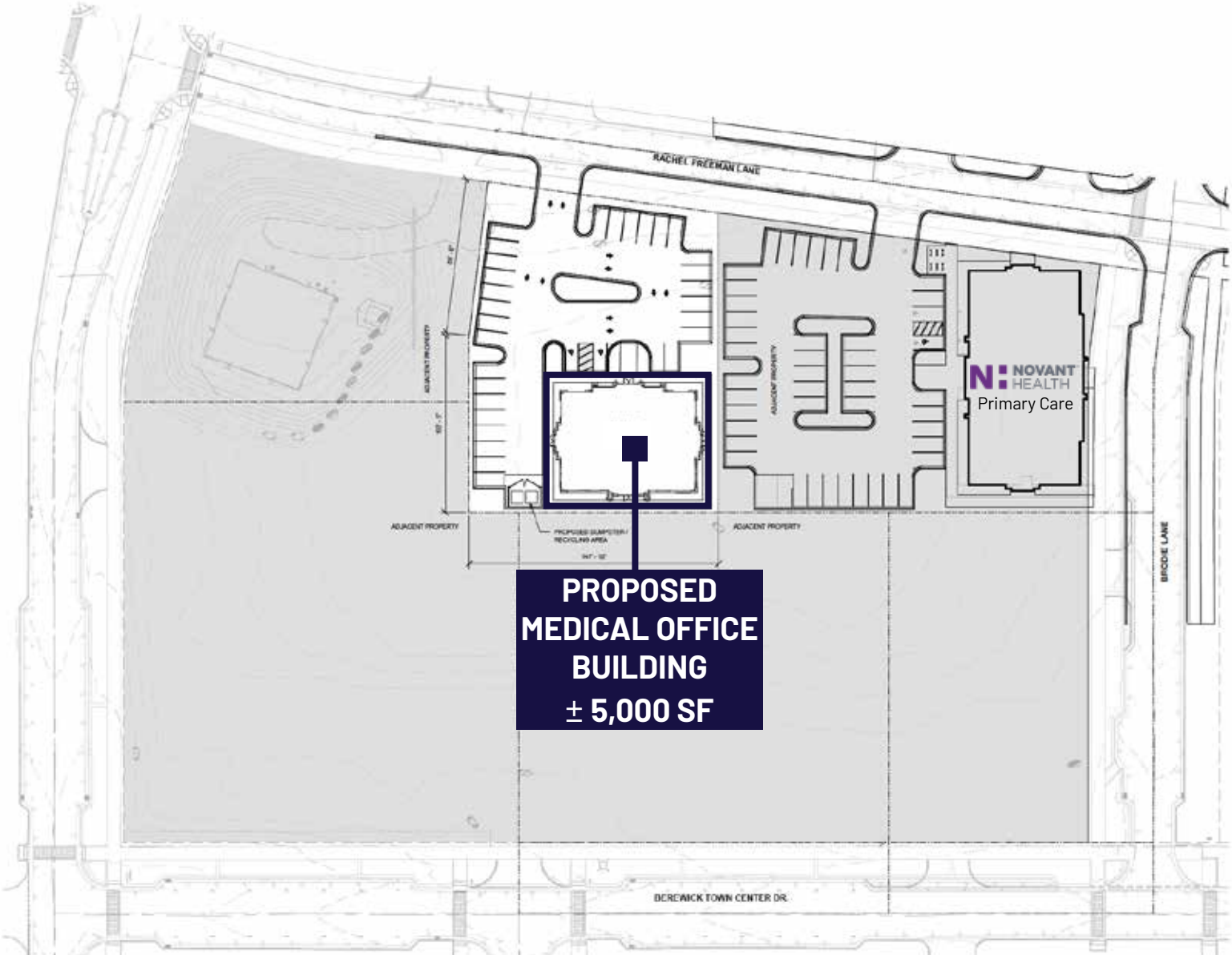

**PROPOSED
MEDICAL OFFICE
BUILDING
± 5,000 SF**

AREA MAP



Charlotte Premium Outlets

DIXIE RIVER RD

I-45

HWY 160

Olive Garden

LongHorn Steakhouse

McDonald's

Walgreens

bp

PROPOSED MOB SITE

Bojangles

Starbucks

McAlister's Deli

Harris Teeter

Steele Creek Modern Dentistry

Outback Steakhouse

Steele Creek Elementary School