

7,412-24,598 SF
FOR LEASE



- CURRENT OFFICE BUILD-OUT,
CAN BE EASILY CONVERTED TO:
 - WAREHOUSE
 - LIGHT MANUFACTURING
 - R & D
 - FLEX SPACE
- MULTIPLE DOCK HIGH &
DRIVE-IN DOORS POSSIBLE

FLEXIBLE INDUSTRIAL

1843 WEST 4000 SOUTH
ROY, UT 84067

Brandon Benner
801-851-1111
Brandon@KCommercial.com

UTHOLD LLC



CAM SF/MTH

\$0.24

Parking

Ample

RENT/SF/NNN

\$0.72

County

Weber

Zoning

BP

Disclaimer: The information contained herein (on this page and included pages) has been obtained through sources deemed reliable but cannot be guaranteed or relied upon as to its accuracy. Any information should be verified through independent sources by interested parties. All measurements and calculations are approximate. The property may no longer be available for sale or lease, may be withdrawn, its offering price changed, or sold or leased to another party at anytime and without notice. Please do not provide any information deemed private or confidential.

UTHOLD LLC



1843 W 4000 S

- 7,412 – 24,598 SF Available
- 1.5 Acres Lot
- Divisible
- Flexible Unit Sizes
- 14' Clear Height
- Up to 8 Overhead Doors
- Fully Fire Sprinklered
- Nice Office Buildout
- Ample Parking
- 20 Year Roof Warranty
- Newer HVAC System



Brandon Benner
801-851-1111
Brandon@KCommercial.com

*UT*HOLD LLC



1843 W 4000 S SITE PLAN

Building Total: 24,598 SF

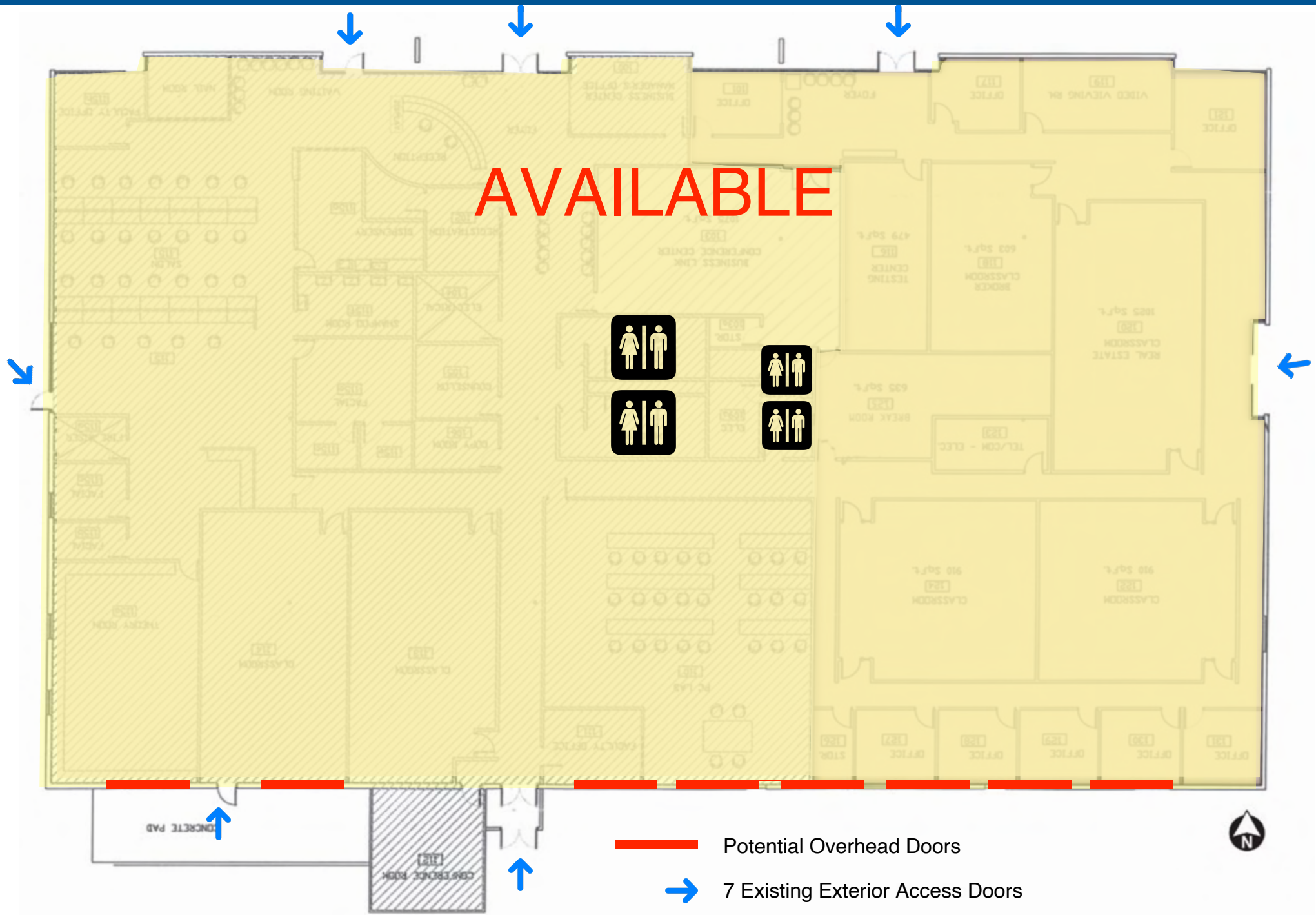

PROPOSED SITE PLAN 1

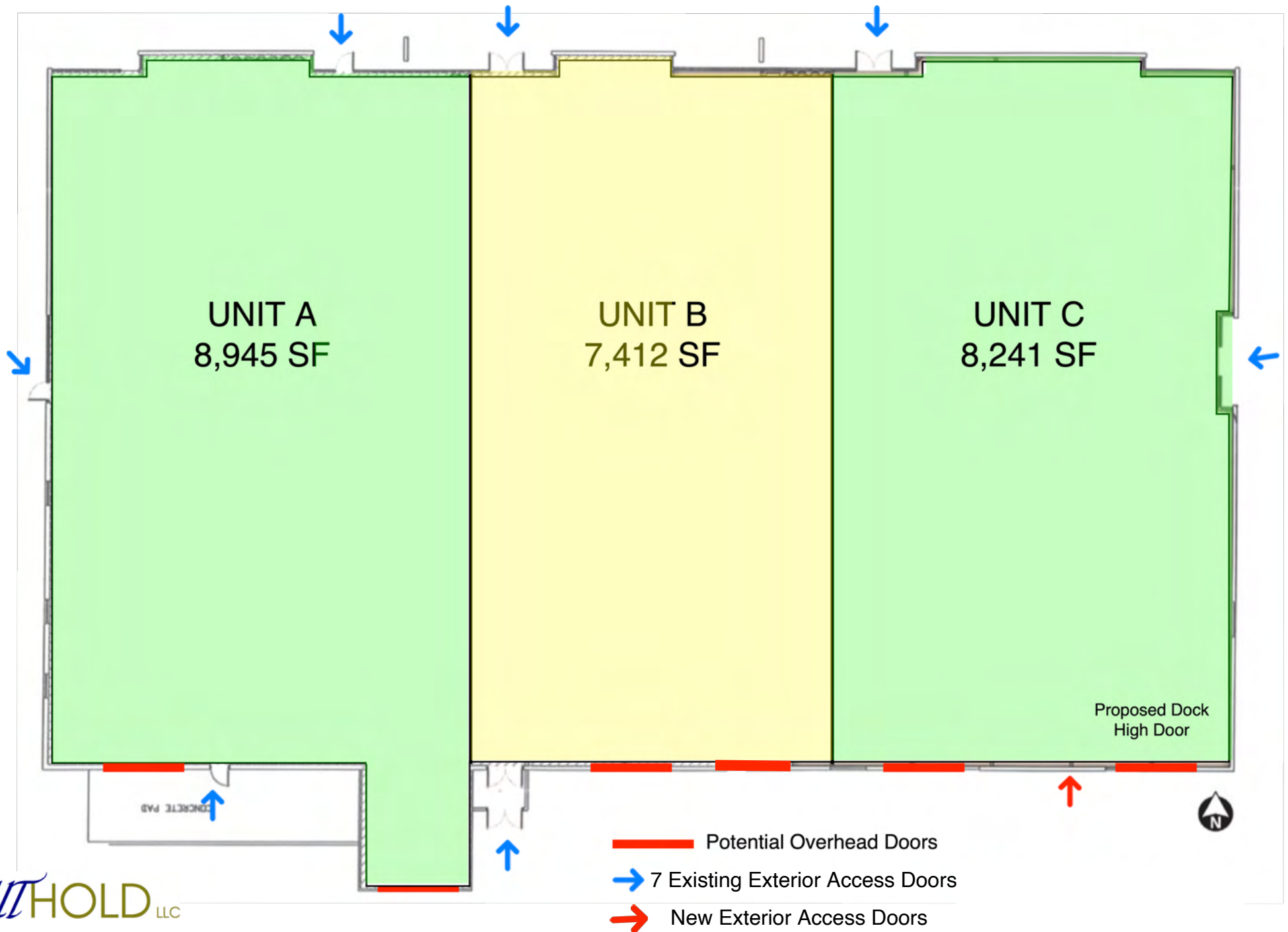

LOCATION 1843 West & 4000 South

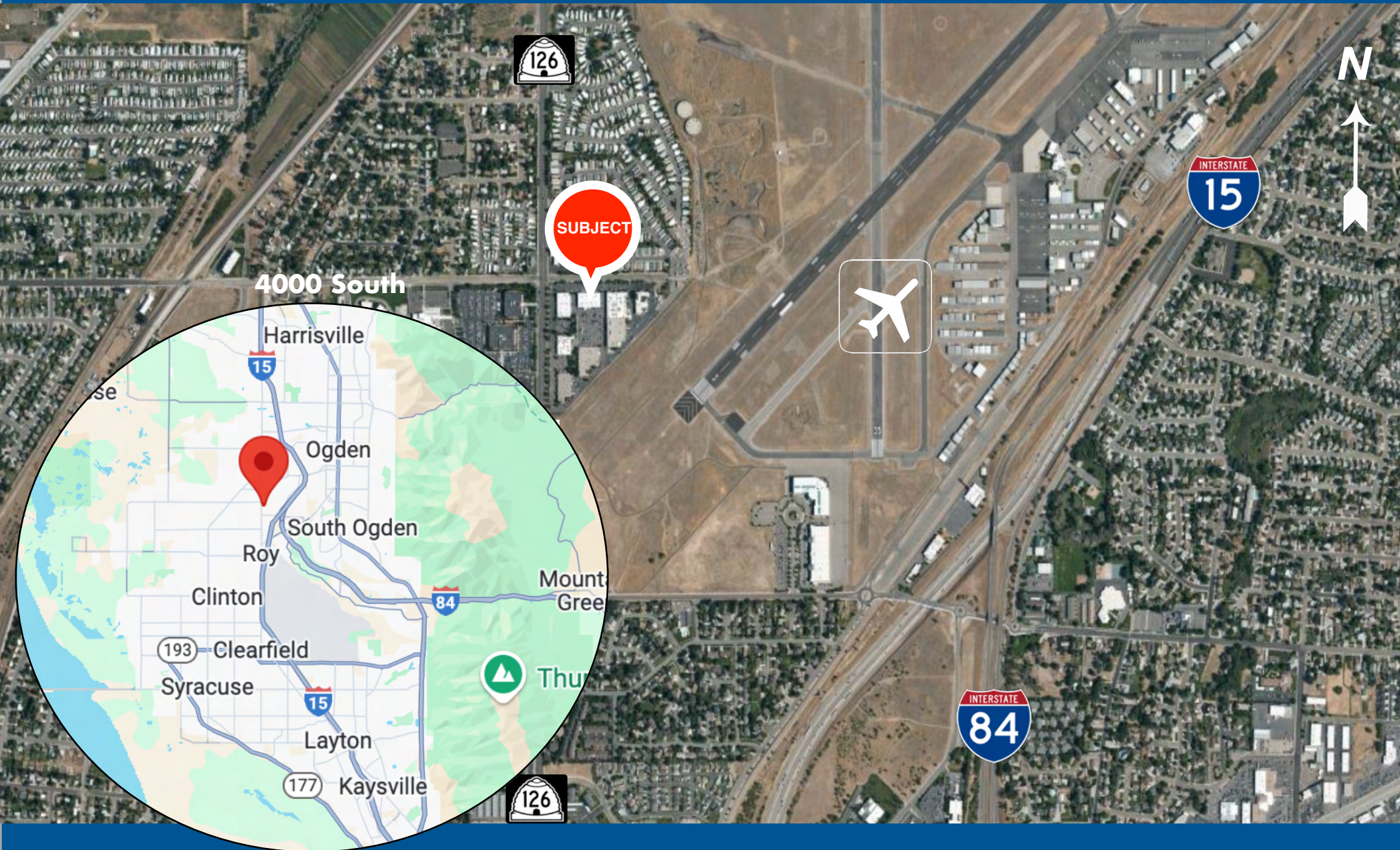

Brandon Benner
801-851-1111
Brandon@KCommercial.com

*UT*HOLD LLC