

PROPERTY MAP - PASCO COUNTY, FLORIDA

6203 SPRINGER DRIVE

PORT RICHEY, FL 34668 · LOT 4, BLOCK B, PORT RICHEY ACRES UNIT 2 · S28-T255-R16E

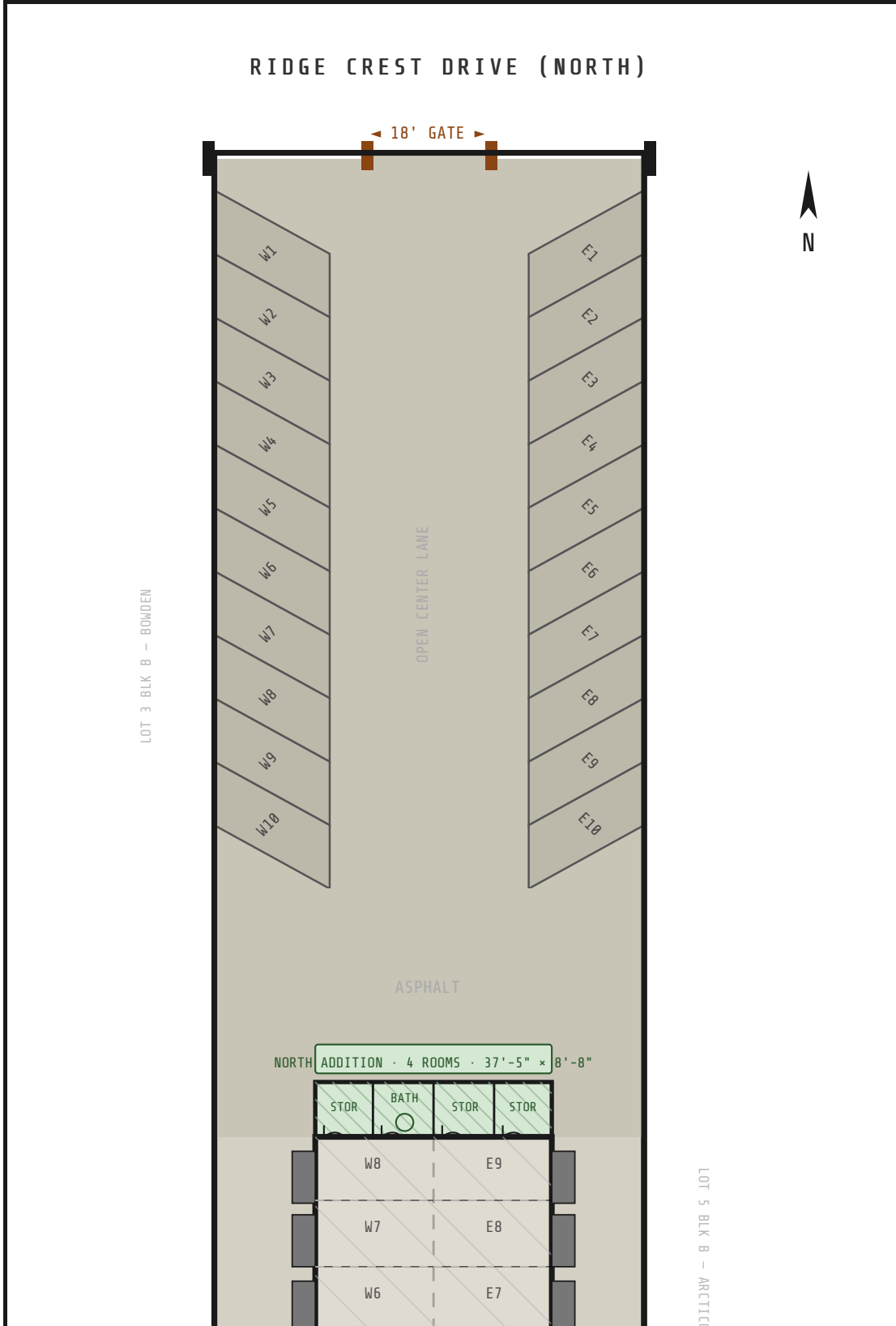

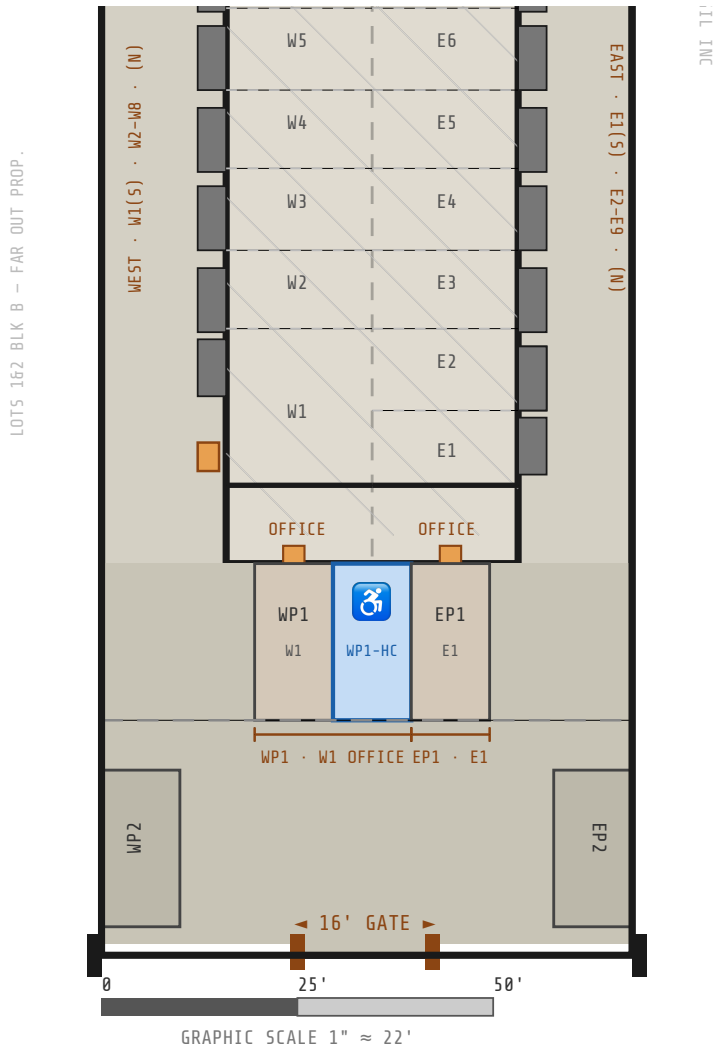

## SPRINGER DRIVE (SOUTH)

50' R/W - PUBLIC

PARCEL DEPTH: **306.45' (P) / 303.72' (M)**

BLDG WIDTH: **37.4' (E-W)**

BLDG AREA: **±3,914 SF · 1 STORY · ±16.4'**

E SETBACK: **14.6'**

SOUTH APRON: **49.8'**

WEST UNITS: **W1(OFF+2GAR) · W2 · W3 · W4 · W5 · W6 · W7 · W8**

NORTH GATE: **18' - RIDGE CREST DR**

SOUTH GATE: **16' - SPRINGER DR**

TRUCK STALLS: **PT-SW + PT-SE PARALLEL (10×20)**

ADDITION ROOMS: **STORAGE (×3) + BATHROOM**

PARCEL WIDTH: **67.8'**

BLDG LENGTH: **101.5' (N-S)**

W SETBACK: **15.8'**

NORTH LOT: **155.15'**

TOTAL UNITS: **17 LEASABLE**

EAST UNITS: **E1(OFF+GAR) · E2 · E3 · E4 · E5 · E6 · E7 · E8 · E9**

NORTH STALLS: **20 ANGLED 45° (W1-W10 + E1-E10) · 10×18**

SOUTH STALLS: **4 DEDICATED · W1(×2 incl HC) · E1(×2)**

NORTH ADDITION: **4 ROOMS · 37'-5" × 8'-8" · 13' HT**