

Thursday, July 22, 2021

LOCATION

Property Address	610 Fessler's Ln Nashville, TN 37210
Subdivision	Lena Myers
County	Davidson County, TN

PROPERTY SUMMARY

Property Type	Commercial
Land Use	Vacant Commercial Land
Improvement Type	
Square Feet	

GENERAL PARCEL INFORMATION

Parcel ID/Tax ID	106-01-0-136.00
Alternate Parcel ID	
Account Number	
District/Ward	USD
2010 Census Trct/Blk	159/2
Assessor Roll Year	2020

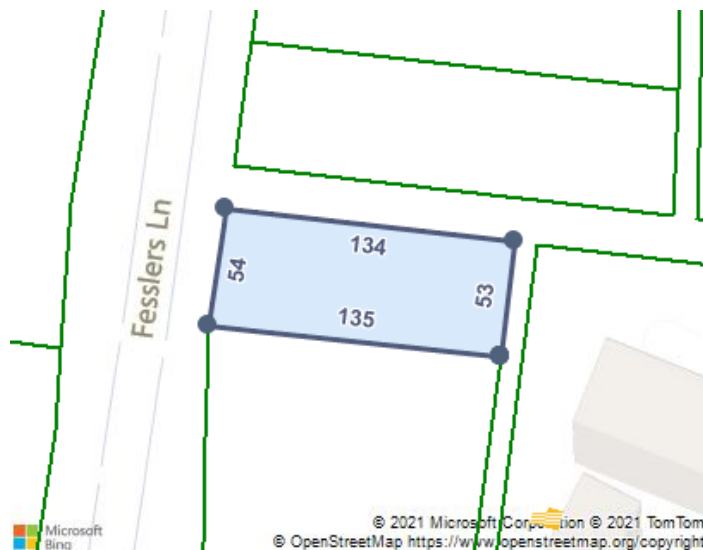
CURRENT OWNER

Name	Rsg Fessler's Gp
Mailing Address	4117 Hillsboro Pike Ste 103 Nashville, TN 37215-2728

SCHOOL ZONE INFORMATION

Napier Elementary Enhanced Option School	0.8 mi
Elementary: Pre K to 4	Distance
Hickman Elementary School	5.1 mi
Elementary: Pre K to 4	Distance
Donelson Middle School	5.1 mi
Primary Middle: 5 to 8	Distance
Two Rivers Middle Preparatory School	5.2 mi
Primary Middle: 5 to 8	Distance
McGavock High School	4.7 mi
High: 9 to 12	Distance

SALES HISTORY THROUGH 07/14/2021

Date	Amount	Buyer/Owners	Seller	Instrument	No. Parcels	Book/Page Or Document#
8/18/2020		Rsg Fessler's Gp	Rs Development LLC	Quit Claim Deed		202008240095542
12/2/2016	\$125,000	Rs Development Group LLC	Sisk Bingham Samuel	Warranty Deed		201612080128909
7/26/2012		Sisk Bingham Samuel & Kenneth P Jr	Sisk Bingham Samuel	Quit Claim Deed	4	201208090071068
8/19/1991		Sisk Kenneth P Et Ux		Quit Claim Deed	6	8461/822
12/30/1985		Sisk Kenneth P Et Ux		Quit Claim Deed	3	6883/409
4/26/1985		Sisk Kenneth P Jr Et Al		Warranty Deed	3	6547/475
12/30/1952		Sisk K P		Warranty Deed		2105/403

TAX ASSESSMENT

Appraisal	Amount	Assessment	Amount	Jurisdiction	Rate
Appraisal Year	2020	Assessment Year	2020		
Appraised Land	\$69,700	Assessed Land	\$27,880	General Services District	3.788
Appraised Improvements		Assessed Improvements			
Total Tax Appraisal	\$69,700	Total Assessment	\$27,880		
		Exempt Amount			
		Exempt Reason			

TAXES

Tax Year	City Taxes	County Taxes	Total Taxes
2020	\$120.72	\$1,056.09	\$1,176.81
2019	\$111.52	\$768.09	\$879.61
2018	\$111.52	\$768.09	\$879.61
2017	\$111.52	\$768.09	\$879.61
2016	\$115.56	\$765.96	\$881.52
2015	\$115.56	\$765.96	\$881.52
2014	\$115.56	\$765.96	\$881.52
2013	\$115.56	\$765.96	\$881.52

MORTGAGE HISTORY

Date	Loan Amount	Borrower	Lender	Book/Page or Document#
12/02/2016	\$135,000	Rs Development Grp LLC	Commercial Bank	201612080128910

PROPERTY CHARACTERISTICS: BUILDING

No Buildings were found for this parcel.

PROPERTY CHARACTERISTICS: EXTRA FEATURES

No extra features were found for this parcel.

PROPERTY CHARACTERISTICS: LOT

Land Use	Vacant Commercial Land	Lot Dimensions	53 X 134
Block/Lot	/7	Lot Square Feet	6,970
Latitude/Longitude	36.143653°/-86.743887°	Acreage	0.16

PROPERTY CHARACTERISTICS: UTILITIES/AREA

Gas Source		Road Type	
Electric Source		Topography	
Water Source		District Trend	
Sewer Source		Special School District 1	
Zoning Code	Cs: Commercial Service / Ov-Air: Airport Overlay	Special School District 2	
Owner Type			

LEGAL DESCRIPTION

Subdivision	Lena Myers	Plat Book/Page	
Block/Lot	/7	District/Ward	USD
Description	P/O Lot 7 Lena Myers Plan / Neighborhood Code And Name: 3112 Murfreesboro Pk/Fesslers/Elm Hill Pk		

FEMA FLOOD ZONES

Zone Code	Flood Risk	BFE	Description	FIRM Panel ID	FIRM Panel Eff.
-----------	------------	-----	-------------	---------------	-----------------

			Date
X	Minimal	Area of minimal flood hazard, usually depicted on FIRMs as above the 500-year flood level.	47037C0263H 04/05/2017