

Avonlea Plaza East - Now Leasing!

Dixie Highway & Green River Parkway, Stuart, FL 34994

NAISouthcoast



Presented by

Nikolaus M. Schroth, CCIM

Principal | Broker Associate

+1 772 286 6292

nikschroth@naisouthcoast.com

www.naisouthcoast.com

J. Jeffery Allman, Jr.

Principal | Broker Associate

+1 772 286-6292 c +1 772 283 1555

jeff@naisouthcoast.com

www.naisouthcoast.com

James McKinney

Sales Associate

+1 772 349 3414

jamesmckinney@naisouthcoast.com

www.naisouthcoast.com

FOR LEASE:

\$32.50/SF NNN

Avonlea Plaza East - Now Leasing!

Dixie Highway & Green River Parkway, Stuart, FL 34994

The Shoppes
AT AVONLEA

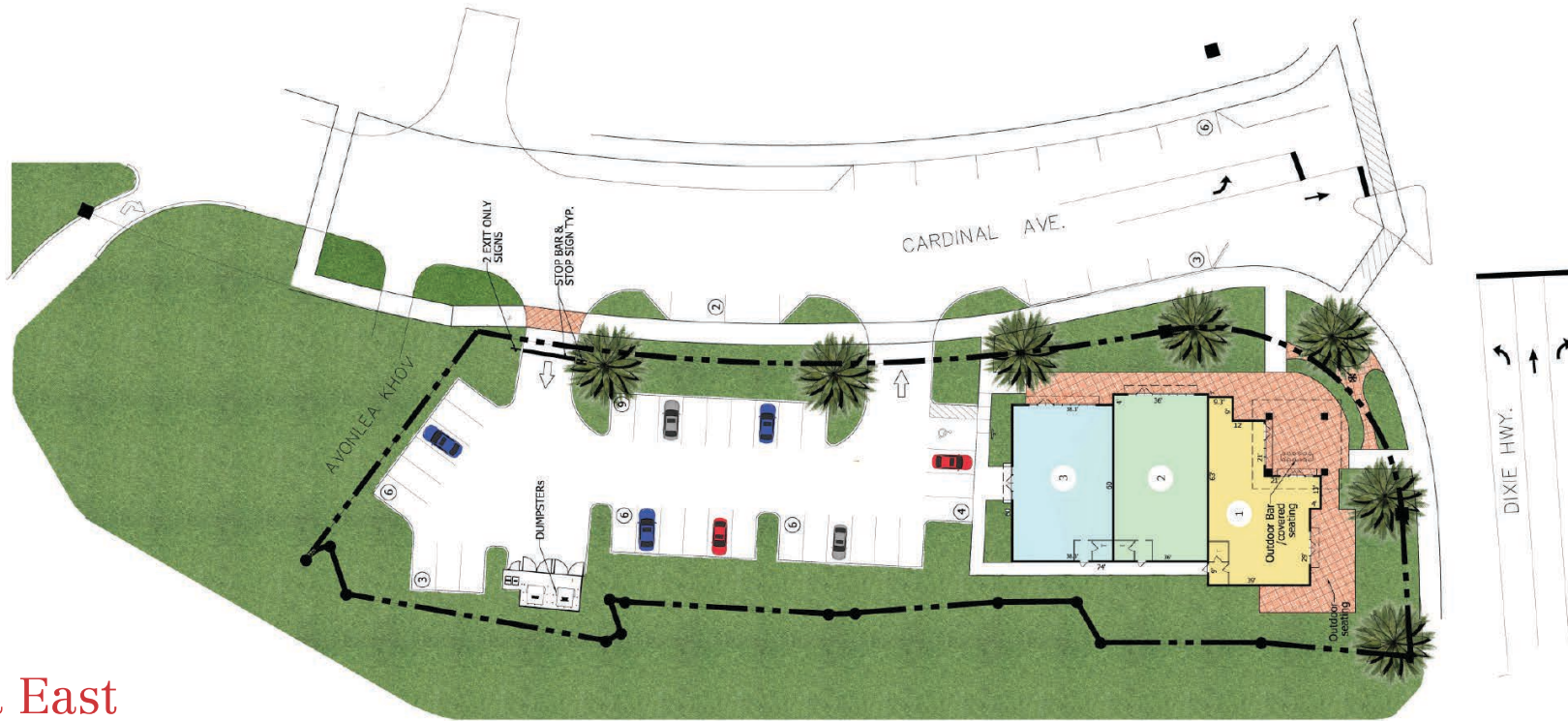

Plaza East

Building Key

- 1 - 2,221 SF
- 2 - 2,306 SF
- 3 - 2,300 SF

Gross SF: 6,827 SF

Flexible unit sizes available



Avonlea Plaza East - Now Leasing!

Dixie Highway & Green River Parkway, Stuart, FL 34994

Property Details

- Lease Rate: \$32.50/SF NNN
- Unit Size: 1,000 SF to 7,000 SF
- Zoning: C PUD, City of Stuart
- Utilities: City of Stuart
- Property Type: Commercial Land

Property Overview

Avonlea is Stuart's newest neighborhood nestled just north of the bridge between downtown Stuart, downtown Jensen Beach and Rio with over 20 acres of preserve. With 620 new residential units under construction the Avonlea area will be home to over 1,000 new residents and is prime for neighborhood commercial uses.

These buildings will feature a unique architecture focused on blending Old Stuart charm with new modern construction. Perfect for restaurants, offices and other users who want to be part of a dynamic new community.

Seeking restaurants, medical offices, professional offices and other retail uses to create a dynamic tenant mix to serve Stuart's newest neighborhood.



Avonlea Plaza East - Now Leasing!

Dixie Highway & Green River Parkway, Stuart, FL 34994



Avonlea Plaza East - Now Leasing!

Dixie Highway & Green River Parkway, Stuart, FL 34994

Drive Time

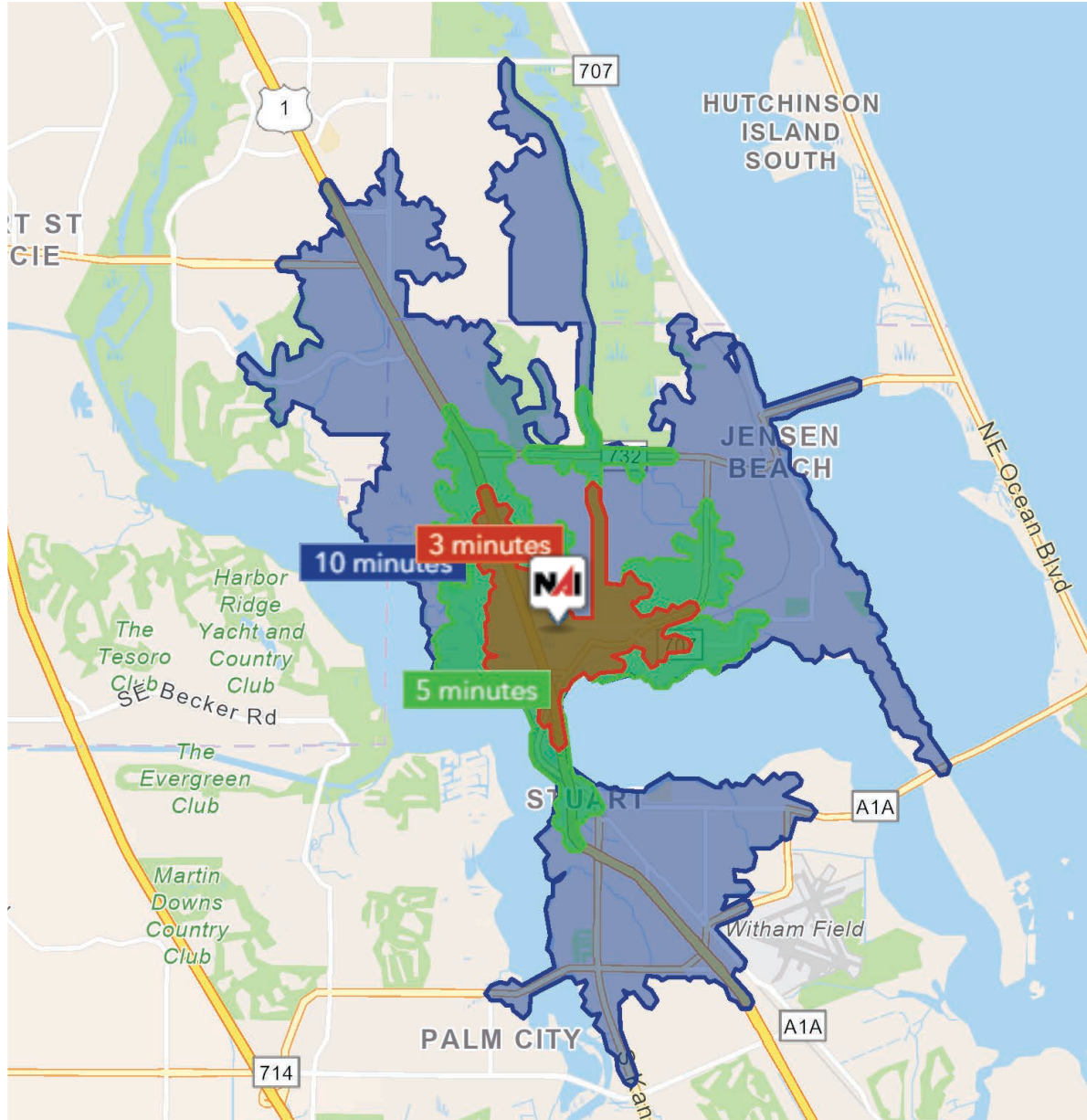

3 Minutes	5 Minutes	10 Minutes
2,115 2010 Population	6,350 2010 Population	36,883 2010 Population
3,035 2025 Population	8,136 2025 Population	43,207 2025 Population
43.4% 2010-2025 Population Growth	28.1% 2010-2025 Population Growth	17.1% 2010-2025 Population Growth
1.84% 2025-2030 (Annual) Est. Population Growth	1.54% 2025-2030 (Annual) Est. Population Growth	1.14% 2025-2030 (Annual) Est. Population Growth
53.2 2025 Median Age	53.2 2025 Median Age	53.0 2025 Median Age
\$116,049 Average Household Income	\$116,601 Average Household Income	\$102,334 Average Household Income
49.5% Percentage with Some College Degree or Better	50.1% Percentage with Some College Degree or Better	47.1% Percentage with Some College Degree or Better
61.6% Percentage in White Collar Profession	63.8% Percentage in White Collar Profession	61.6% Percentage in White Collar Profession

Avonlea Plaza East - Now Leasing!

Dixie Highway & Green River Parkway, Stuart, FL 34994

Property Overview

The goal of Avonlea Plazas is to create a unique space for nearby residents to enjoy neighborhood businesses. The architecture is a blend of old Stuart/Caribbean architecture and modern design that will stand out in the area but compliment the new construction underway. With the Rio neighborhood proposed to boom and over 600 units under construction in the immediate area of Avonlea Plaza, the market is in need of businesses to serve these new residents.

With flexible unit sizes and large common areas, the plazas are the ideal location for your business.



Regional Overview

Martin County, Florida

The cities that make up Martin County include Jensen Beach/Rio, Stuart/Sewall's Point, Hutchinson Island, Hobe Sound, Jupiter/Tequesta, Palm City, Port Salerno and Indiantown. Martin County is a wonderful place to visit and live, with beaches, golf, fishing and boating. The County boasts arts, quaint downtowns with shops, gourmet dining, galleries, museums, historic places, festivals and more.

Martin County is for...

The golf enthusiast... Martin County is home to over 35 world-class golf courses all within a 15-mile radius. The sun worshiper... The County offers its visitors and residents alike some of the finest beaches on the east coast. The discriminating arts shopper... More than 20 galleries participate in a monthly First Thursday gallery night. Many of these galleries are in the historic downtowns of Stuart, Jensen Beach, Port Salerno and Hobe Sound. The music lover... The historic Lyric Theatre offers a wide array of first-class talent nearly 300 days a year... This acoustically amazing theatre features concerts for all music lovers, from classical to rock and roll, and theatrical performances by local and national talent.

Mark your calendars for a plethora of events to look forward to in Martin County, Florida. The Stuart Air Show, Stuart Boat Show, ArtsFest, and the Martin County Fair are just some of the many events taking place throughout the year. The Treasure Coast Children's Museum, located at Indian Riverside Park, is a great place for kids and families, offering a water play area, fishing, and a riverfront view. Often, there are events in the park including concerts, orchid shows, and more. Indian Riverside Park also features the Maritime and Yachting Museum. Hutchinson Island is home to the Elliott Museum which celebrates the genius of innovation, creativity and the historical events of Martin County. Named after the prolific inventor Sterling Elliott, the museum hosts permanent exhibits showcasing Model A Trucks, early transportation, the history of Stuart and its surrounding regions, and baseball memorabilia. For the scientifically minded and curious kids, the Florida Oceanographic Coastal Center offers fun opportunities to learn about our local ecosystem.

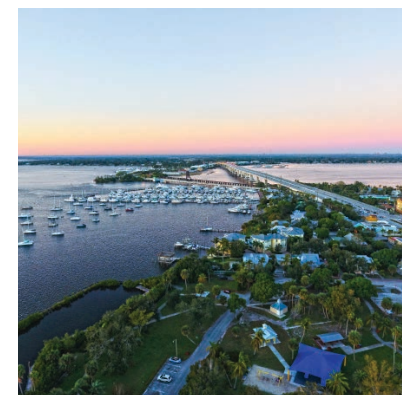
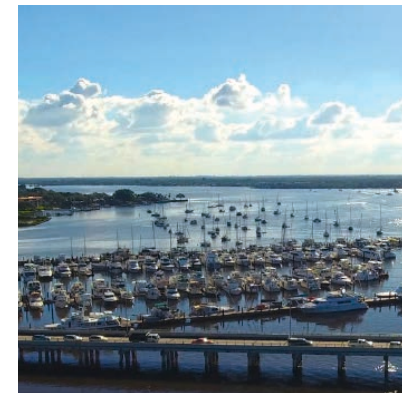

City Overview

Stuart, Florida

Stuart, Florida is located on Florida's East Coast, which borders the St. Lucie River and West of the Indian River. The climate is pleasant with mild winters and warm summers. The annual average temperature is 72 degrees. Annual rainfall averages 60 inches.

Stuart is famed for its exceptional sailfishing and all other types of sport fishing. You can enjoy ocean fishing, river and bay fishing, and fresh water fishing. The North and South forks of the St. Lucie River are tropical wonderlands for cruises. Stuart has quaint older neighborhoods in the downtown area, including a mixture of townhomes and condominiums. Stuart's successful revitalization program has given the Downtown area a pleasant ambiance, with shops and restaurants lining the streets.

The top major employers are, Cleveland Clinic Hospital, Vought Aircraft, Municipal Government, and thousands of successful small businesses. The economy is driven by retail service, hospitality, construction and government sectors located throughout the city.

At the present time, Stuart is a growing community, annexing new properties north and south of the city, currently 6.25 square miles. Revitalization continues in the Potsdam section of the downtown area as well as North of the Roosevelt Bridge. Completed in 1996, the Roosevelt Bridge, is a prominent feature in the area, allowing for easy connectivity and accessibility to Stuart's Public Beaches.



Nikolaus M. Schroth, CCIM

Principal | Broker Associate
+1 772 286 6292
nikschroth@naisouthcoast.com



J. Jeffery Allman, Jr.

Principal | Broker Associate
+1 772 286-6292 c +1 772 283 1555
jeff@naisouthcoast.com



James McKinney

Sales Associate
+1 772 349 3414
jamesmckinney@naisouthcoast.com

Avonlea Plaza East - Now Leasing!

Dixie Highway & Green River Parkway, Stuart, FL 34994



FOR LEASE:

\$32.50/SF NNN