

THE LAKES MALL



5600 HARVEY STREET | MUSKEGON, MI

PROPERTY FEATURES

- 587,984 total square foot shopping mall
- 691 – 25,666 available square feet
- Two outlots available for sale – 1 Acre & 9 Acres
- Zoned PUD
- Built in 2000
- 21' ceiling height

Comments: Welcome to The Lakes Mall! Class A, prime retail located in the heart of Muskegon's retail corridor. Join retailers such as JCPenney, Target, Family Farm & Home, Chick Fil-A and Dick's Sporting Goods to name a few. There are pad sites available as well for free-standing opportunities. Interior suites inside the enclosed mall for a variety of national and local retailers to take advantage of. The Lakes Mall boost both cost friendly level suites and great co-tenancy for your business needs.

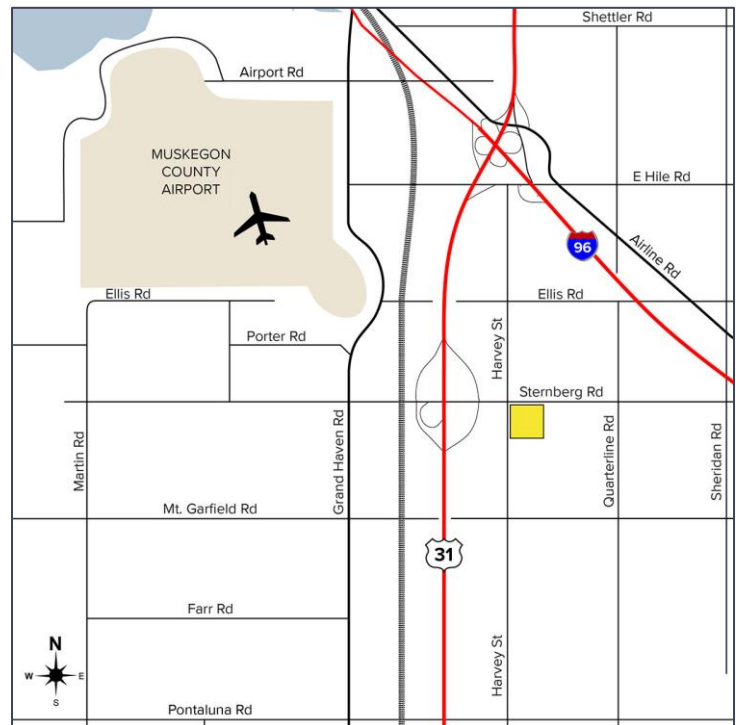

For more information, please contact:

JOE RIZQALLAH

(616) 822 6310

jrizqallah@signatureassociates.com



**SIGNATURE
ASSOCIATES**
KNOW SIGNATURE | KNOW RESULTS

5600 Harvey Street – Muskegon, MI

For Lease

691 – 25,666
Square Feet
AVAILABLE

Site Plan

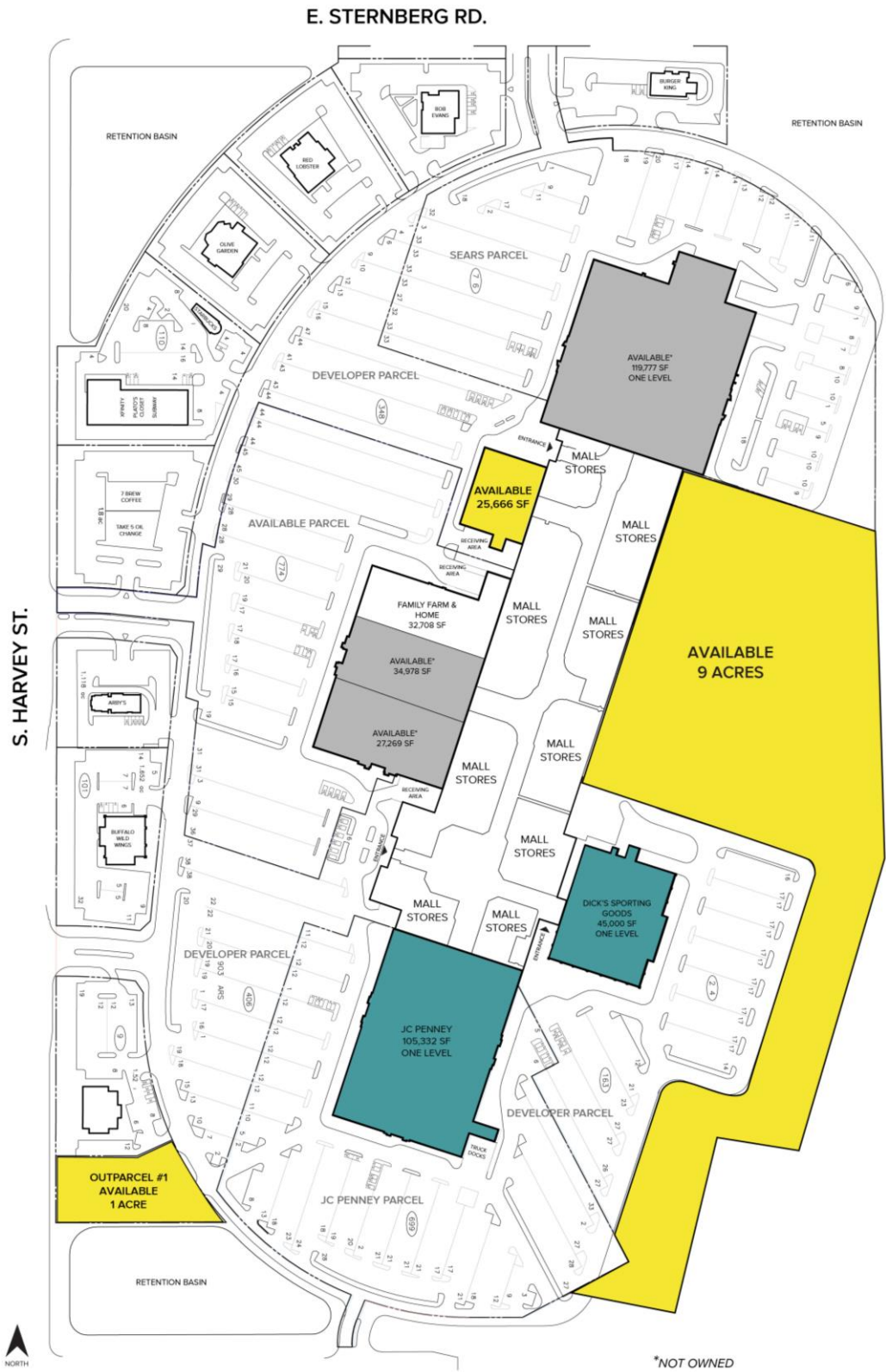

For more information, please contact:
JOE RIZQALLAH
(616) 822 6310
jrizzqallah@signatureassociates.com

SIGNATURE ASSOCIATES
1188 East Paris Avenue SE, Suite 220
Grand Rapids, MI 49546
www.signatureassociates.com

Information is subject to verification and no liability for errors or omissions is assumed. Price is subject to change and listing withdrawal.

5600 Harvey Street – Muskegon, MI
For Lease

691 – 25,666
Square Feet
AVAILABLE

Floor Plan

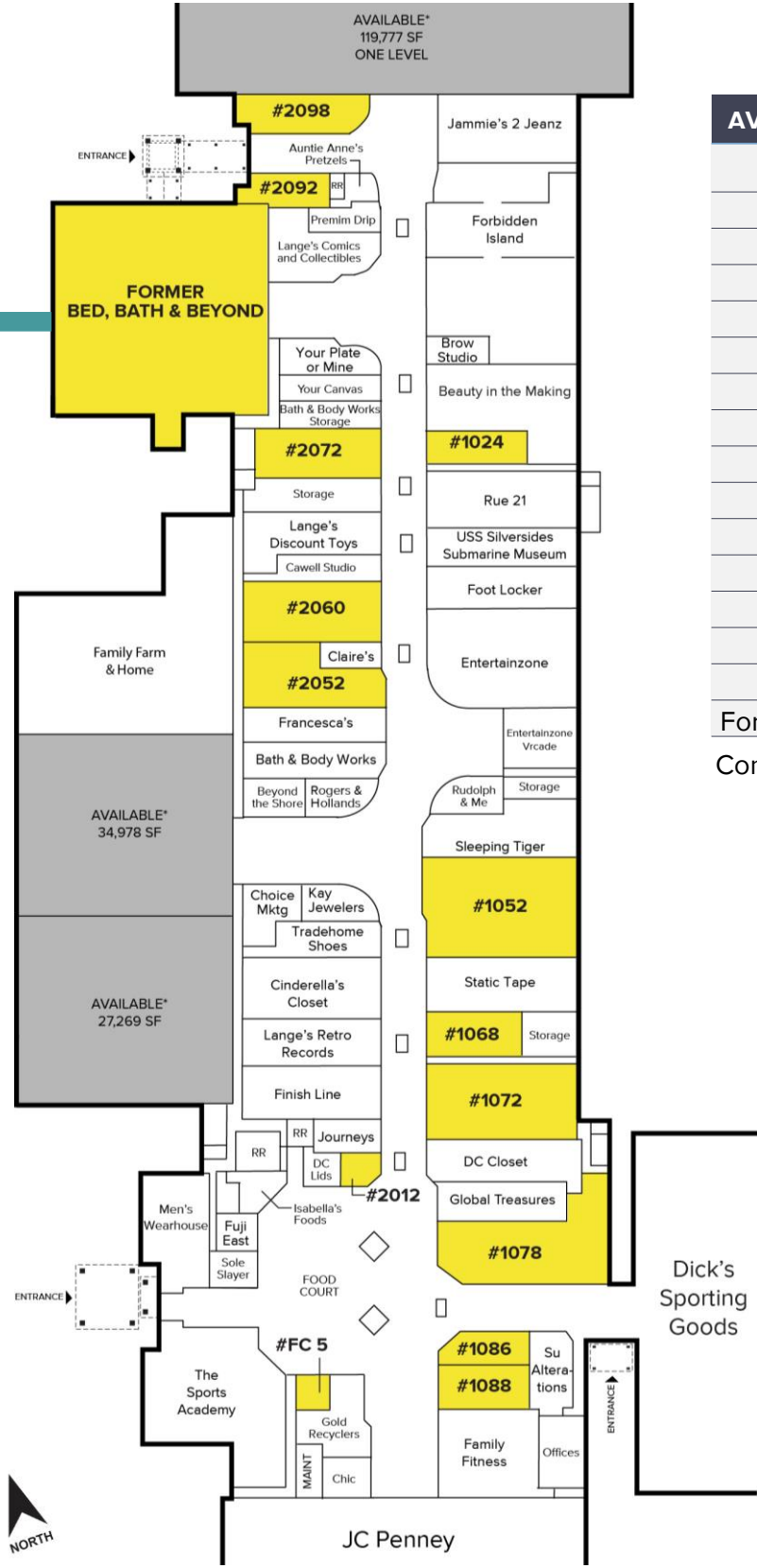
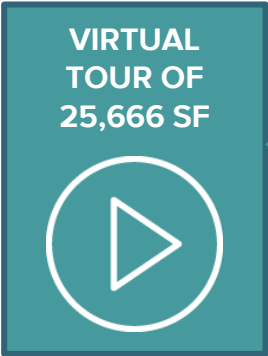

AVAILABILITY	
UNIT	TOTAL SF
1024	1,824
1052	8,512
1068	2,340
1072	6,118
1078	6,745
1086	1,601
1088	2,191
2012	712
2052	4,376
2060	4,665
2072	3,568
2092	1,130
2098	2,798
FC-5	691
Former BBB	25,666

Contact Agent for Pricing



For more information, please contact:
JOE RIZQALLAH
(616) 822 6310
jrizzqallah@signatureassociates.com

SIGNATURE ASSOCIATES
1188 East Paris Avenue SE, Suite 220
Grand Rapids, MI 49546
www.signatureassociates.com

Information is subject to verification and no liability for errors or omissions is assumed. Price is subject to change and listing withdrawal.

5600 Harvey Street – Muskegon, MI
For Lease

691 – 25,666
Square Feet
AVAILABLE

Aerial



DEMOGRAPHICS		
	POPULATION	MED. HH INCOME
1 MILE	1,993	\$69,437
3 MILE	18,517	\$82,667
5 MILE	67,564	\$71,881

TRAFFIC COUNTS (TWO-WAY)	
12,462	Harvey St between Sternberg & Mt. Garfield
14,123	Sternberg Rd east of Harvey St
38,222	US 31 south of Sternberg Rd
45,010	US 31 north of Sternberg Rd

For more information, please contact:
JOE RIZQALLAH
(616) 822 6310
jrizzqallah@signatureassociates.com

SIGNATURE ASSOCIATES
1188 East Paris Avenue SE, Suite 220
Grand Rapids, MI 49546
www.signatureassociates.com

Information is subject to verification and no liability for errors or omissions is assumed. Price is subject to change and listing withdrawal.