



CUSHMAN &
WAKEFIELD

GILBERT &
EZELLE



FOR LEASE

Asking Rent: **NEGOTIABLE**

Suite B-3

Richmond Hill Exchange

60 Exchange Street
Richmond Hill, GA 31324

MORE INFORMATION:

JOHN GILBERT, CCIM
Partner
+1 912 547 4464
jgilbert@gilbertezelle.com

FOR LEASE

Richmond Hill Exchange

60 Exchange Street, Richmond Hill, GA



CUSHMAN &
WAKEFIELD

GILBERT &
EZZELLE



PROPERTY OVERVIEW

PROPERTY SUMMARY

| Address | 60 Exchange Street |
|------------------|--------------------|
| Total SF | 24,650 SF |
| Available Suites | B-3 (1,514 SF) |
| Rate | Negotiable |
| Year Built | 2009 |
| Land Area | 4.65 Acres |
| Zoning | C-1 |

HIGHLIGHTS

- Kroger-shadow center in Richmond Hill, GA
- On Highway 144, Richmond Hill's primary retail corridor, just East of Interstate 95 interchange
- Access, visibility, and signage on Highway 144/Ford Avenue
- Abundant Parking
- Surrounded by national tenants
- Extremely successful/stable center with little turnover since construction 15 years ago

SURROUNDING TENANTS



FOR LEASE

Richmond Hill Exchange

60 Exchange Street, Richmond Hill, GA



FLOOR PLAN

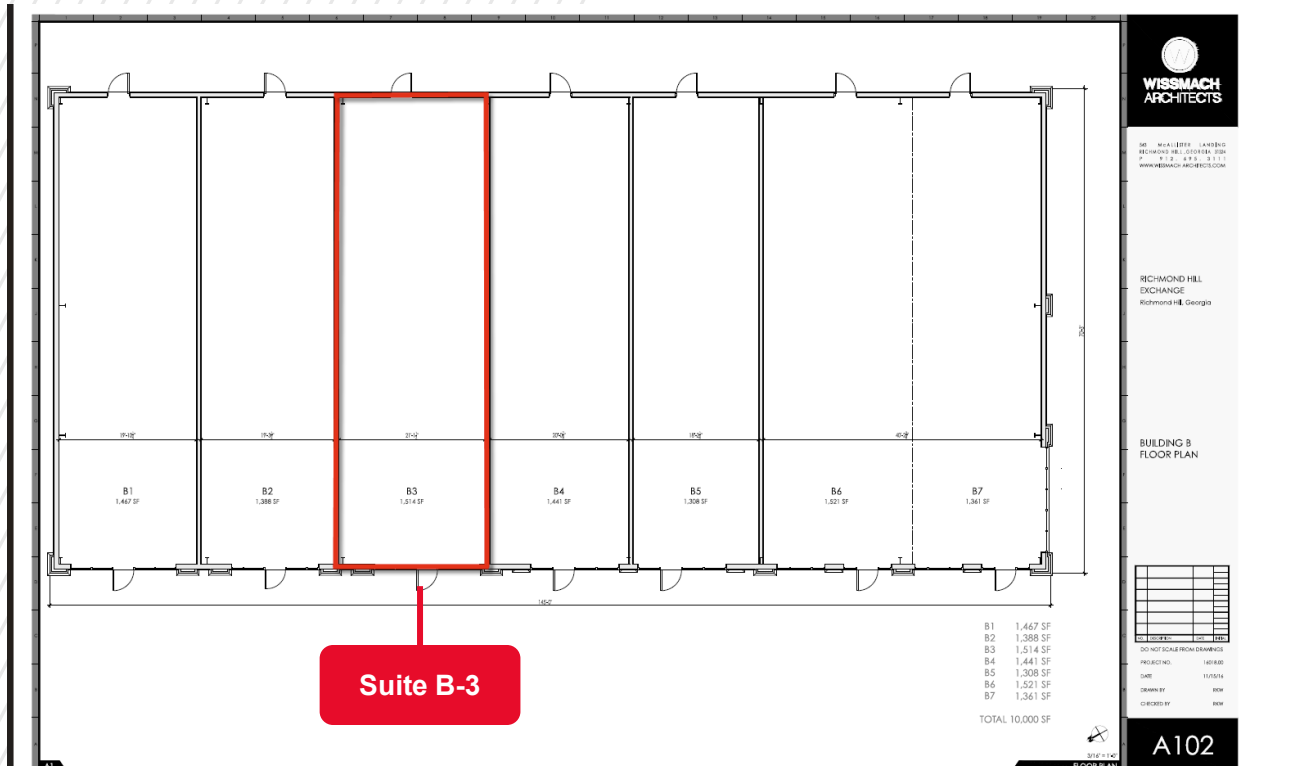

| Suite | SF | Asking Rate |
|-------|-------|-------------|
| B-3 | 1,514 | Negotiable |
| | | |



FOR LEASE

Richmond Hill Exchange

60 Exchange Street, Richmond Hill, GA



LOCATION & DEMOGRAPHICS

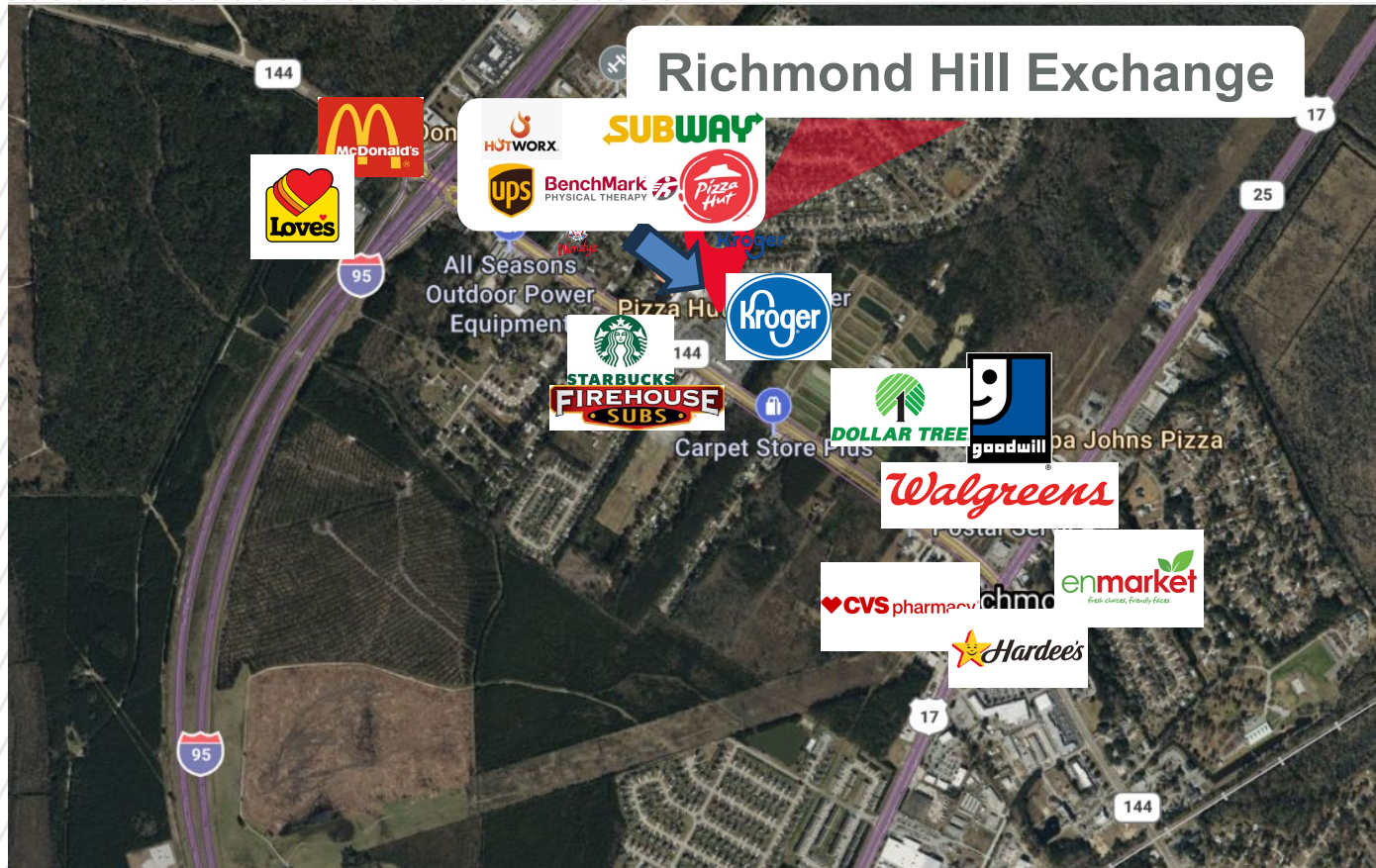

| POPULATION | 1 MILE | 3 MILES | 5 MILES |
|-----------------------------|--------|---------|---------|
| Total Population | 2,782 | 15,615 | 30,367 |
| 2029 Population (Projected) | 3,189 | 18,129 | 34,668 |
| 2024-2029 Annual Rate | 2.77% | 3.03% | 2.68% |
| Average Age | 37.0 | 33.3 | 33.6 |

| HOUSEHOLDS & INCOME | 1 MILE | 3 MILES | 5 MILES |
|---------------------|-----------|-----------|-----------|
| Total Households | 910 | 5,644 | 11,015 |
| # of Persons per HH | 3.02 | 2.74 | 2.74 |
| Average HH Income | \$122,044 | \$102,719 | \$102,840 |
| Per Capita Income | \$43,115 | \$36,429 | \$37,161 |

FOR LEASE

Richmond Hill Exchange

60 Exchange Street, Richmond Hill, GA



CUSHMAN &
WAKEFIELD

GILBERT &
EZELLE

Richmond Hill Exchange

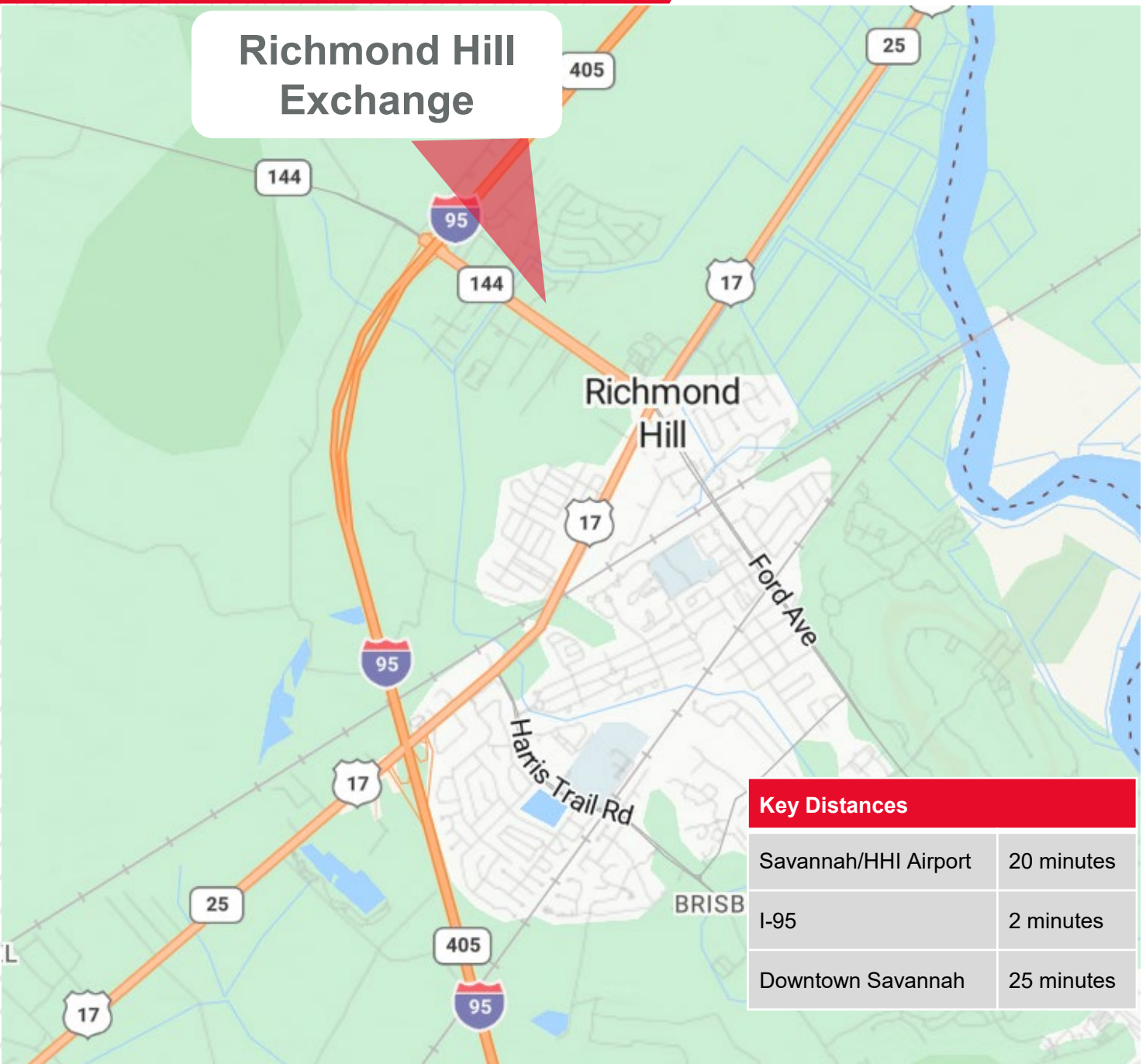

Key Distances

| | |
|----------------------|------------|
| Savannah/HHI Airport | 20 minutes |
| I-95 | 2 minutes |
| Downtown Savannah | 25 minutes |

MORE INFORMATION:

JOHN GILBERT, CCIM
Partner
+1 912 547 4464
jgilbert@gilbertezelle.com

Cushman & Wakefield | Gilbert & Ezelle
820 Abercorn St
Savannah, GA 31401
912-236-8992

©2020 Cushman & Wakefield. All rights reserved. The information contained in this communication is strictly confidential. This information has been obtained from sources believed to be reliable but has not been verified. No warranty or representation, express or implied, is made as to the condition of the property (or properties) referenced herein or as to the accuracy or completeness of the information contained herein, and same is submitted subject to errors, omissions, change of price, rental or other conditions, withdrawal without notice, and to any special listing conditions imposed by the property owner(s). Any projections, opinions or estimates are subject to uncertainty and do not signify current or future property performance.