

**HUGE  
PRICE  
REDUCTION!**

5,727/SF  
**STANDALONE RESTAURANT  
FOR SALE OR LEASE**

**341 JOHNNIE DODDS BLVD. | MT. PLEASANT SC**

**High profile location along Highway 17 with  
marquee visible to 50,000 cars per day**

- Large outdoor patio and bar not included in 5,727 sq. ft. calculation
- All FF&E with full kitchen, two range hoods & walk-ins will convey
- New roof, electrical service, insulation & HVAC
- Ample parking with the potential for more if needed

**\*\*Click Here for S.C. Agency Relationships Disclosure**





**341 JOHNNIE DODDS BLVD.  
MT. PLEASANT SC**

**5,727/SF  
STANDALONE  
RESTAURANT  
FOR SALE  
OR LEASE**

SIZE: 5,727 SF  
TMS#: 571-00-00-064  
COUNTY: Charleston  
SALE PRICE: \$3,500,000

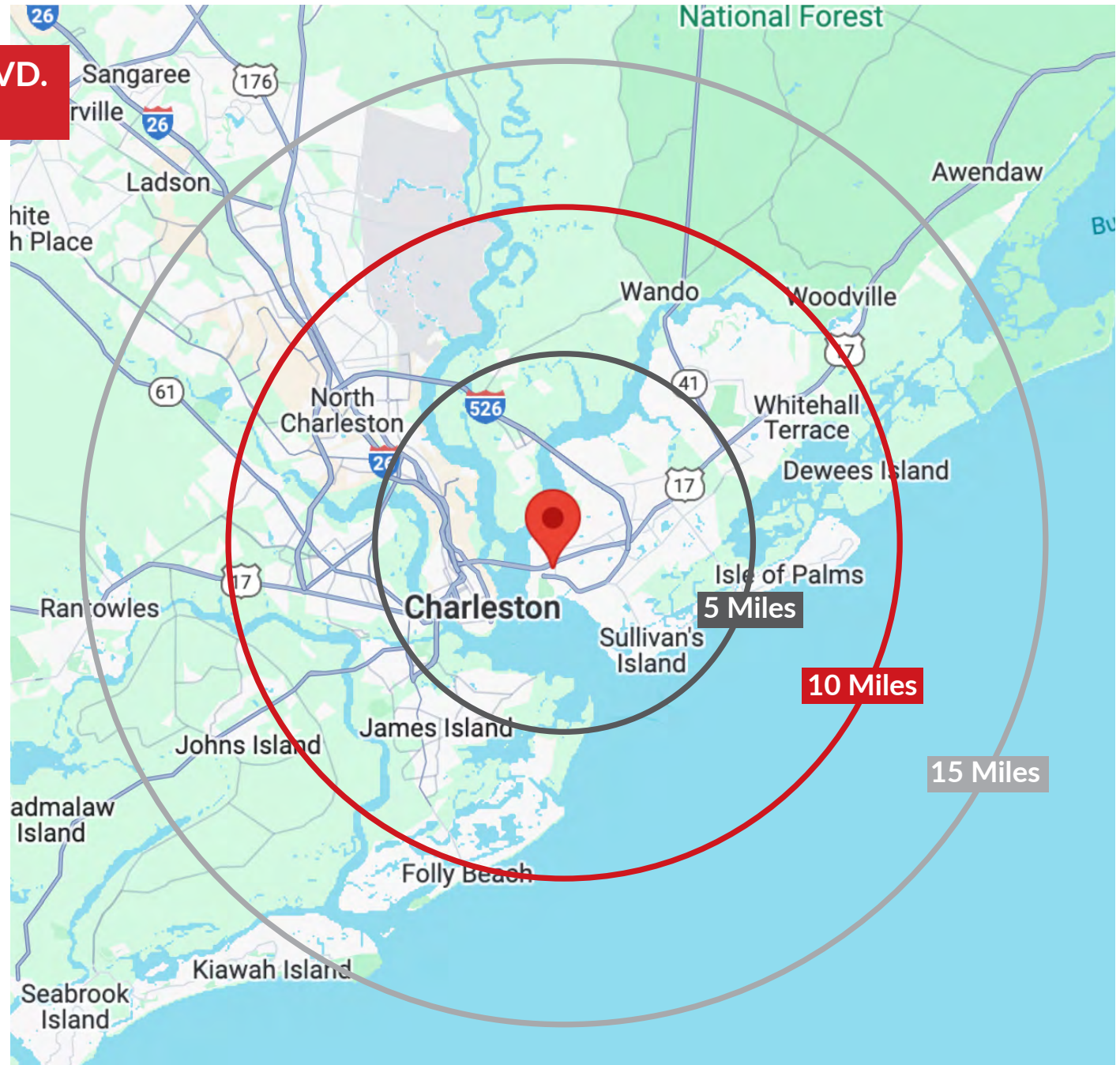











341 JOHNNIE DODDS BLVD.  
MT. PLEASANT SC  
**[www.landmark-enterprises.com](http://www.landmark-enterprises.com)**







# FLOOR PLAN

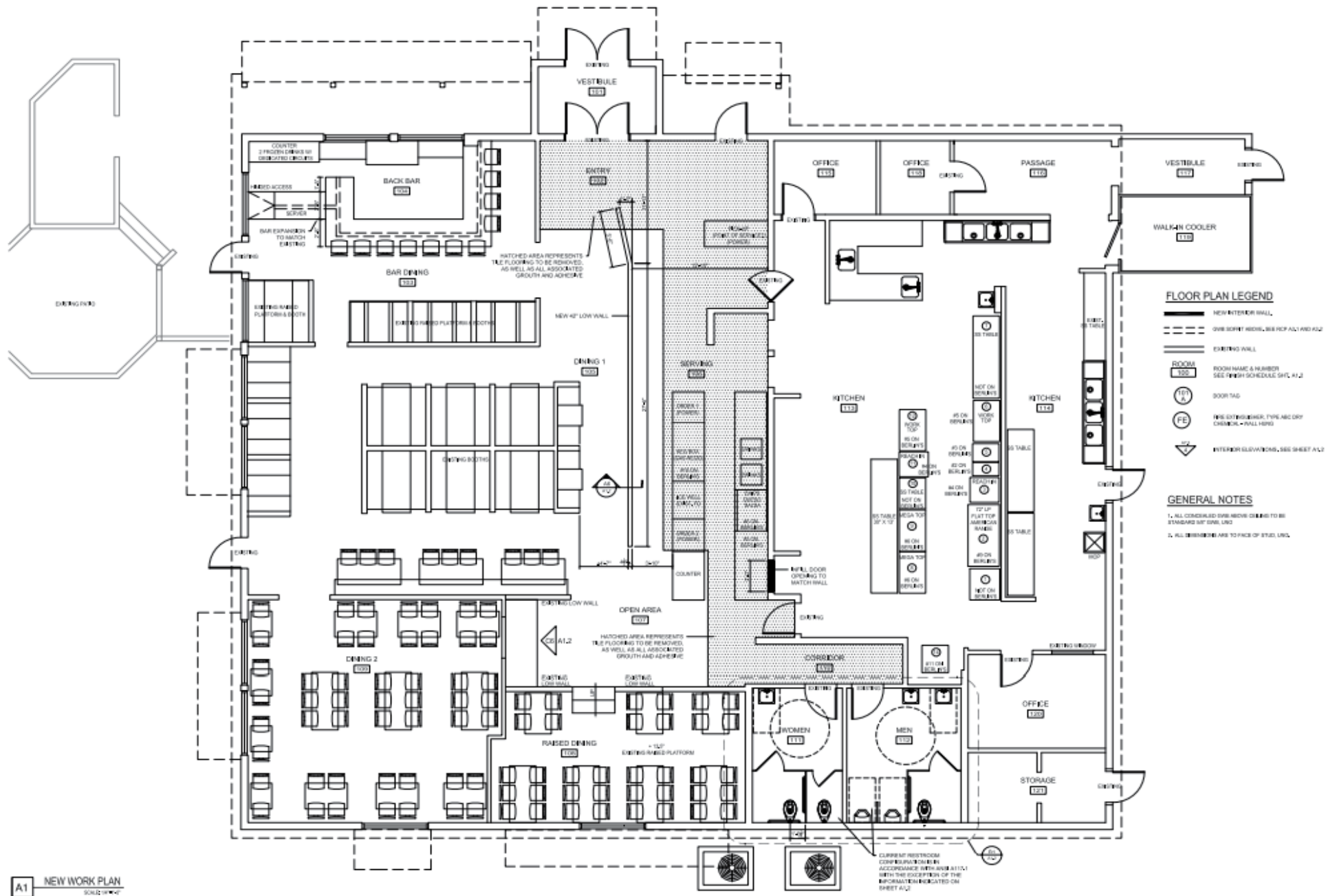







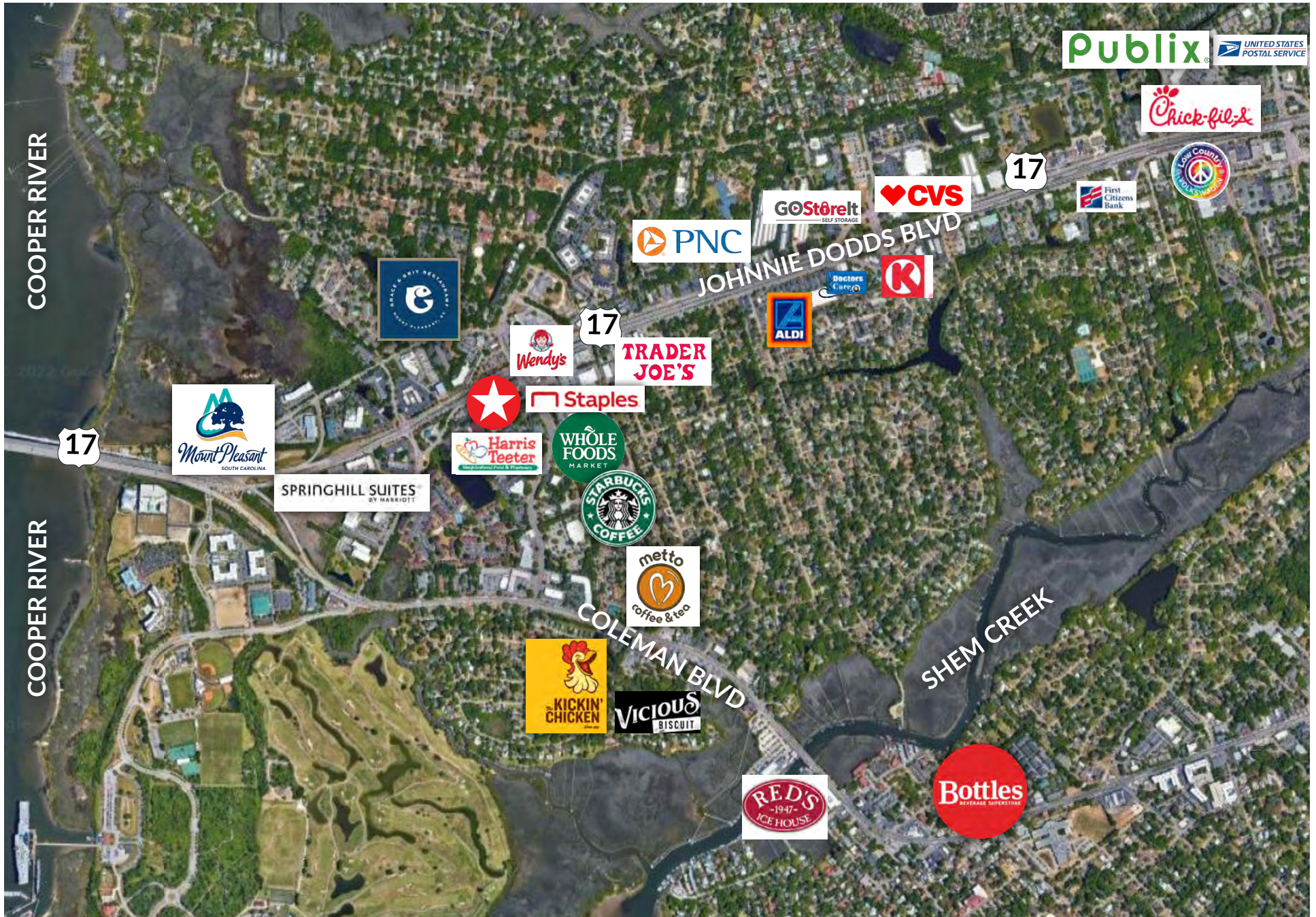





**5,727 SF STANDALONE  
RESTAURANT  
FOR SALE  
OR LEASE**

**341 JOHNNIE DODDS BLVD. | MT. PLEASANT SC**

**[www.landmark-enterprises.com](http://www.landmark-enterprises.com)**



**Jon Chalfie**  
VP of Brokerage  
843-345-6000



**Hailey Clifton**  
Associate  
843-300-5209



**Kesun Lee**  
Associate  
301-318-7217



**LANDMARK**  
ENTERPRISES  
COMMERCIAL REAL ESTATE

\*We obtained the information above from sources we believe to be reliable. However, we have not verified its accuracy and make no guarantee, warranty or representation about it. It is submitted subject to the possibility of errors, omissions, change of price, rental or other conditions, prior sale, lease or financing, or withdrawal without notice. We include projections, opinions, assumptions or estimates for example only, and they may not represent current or future performance of the property. You and your tax and legal advisors should conduct your own investigation of the property and transaction.